

SWITCH SCHEMATIC (MOMENTARY)

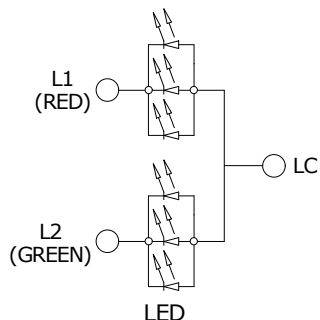

CIRCUIT LAYOUT

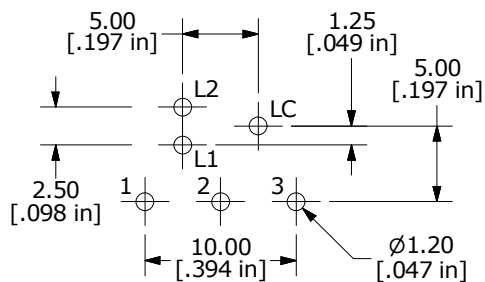
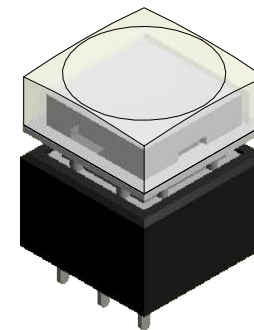
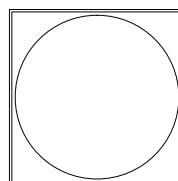

PCB MOUNTING

NOTES:

1. ALL DIMENSIONS IN MM
2. GENERAL TOLERANCE: X.X = ±0.4  
X.XX = ±0.25
3. TERM. NOS. FOR REFERENCE ONLY.
- ▲ 4. CONTACT RATING: 0.1A MAX. @ 28VDC
5. CONTACT MATERIAL: GOLD
6. ELECTRICAL LIFE: 200,000 Typical
7. OPERATING TEMP: -40°C to 85°C
8. OPERATING FORCE: 200 ± 100 gf
9. CONTACT RESISTANCE: 100 MILLI-OHM INITIAL TYP. MAX.
10. DIELECTRIC STRENGTH: 1000 VAC FOR 1 MINUTE
11. TRAVEL TO MAKE: 2.20mm ± 0.2
12. 2011/65/EU (ROHS) COMPLIANT
13. ▲ DENOTES CRITICAL PARAMETER
- ▲ 14. LED COLOR: RED: 3 CHIPS; 1.95VDC, @20mA TYP.  
GRN: 3 CHIPS; 2.1VDC, @20mA TYP.

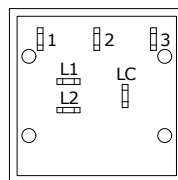
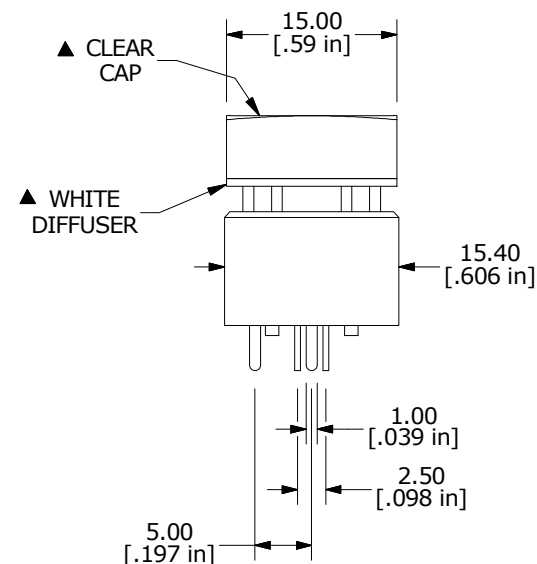
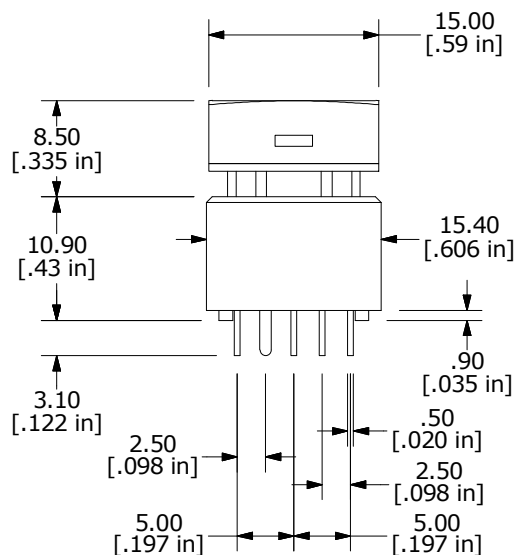

REV	PCR NO	DESCRIPTION	DATE	BY
G	22822	drawing update	4/26/17	MW
F	22339	UPDATED CONTACT RATING	6/7/16	MJR
E	22158	DRAWING UPDATE	2/18/16	MW
D	19720	UPDATE DRAWING	02/28/11	BMA

THE INFORMATION CONTAINED IN THIS DOCUMENT IS PROPRIETARY TO E-SWITCH AND IS NOT TO BE COPIED OR TRANSFERRED



TITLE ULP120AP1RSSCL1REDGRN				
SCALE	DATE	DR	DWG	REV
1.5:1	10/10/2007	BF	B800000	G