

This document, including the design, configuration and mechanical features revealed herein are the sole, confidential and proprietary property of Tru-Connector Corporation. Reproduction or use thereof, in whole or part, is prohibited without the prior written consent of Tru-Connector Corporation.

REV	DESCRIPTION	DATE	APPROVAL
/	ORIGINAL ISSUE	7/17/02	WWW

Electrical:

Impedance: 50 Ohms Nominal  
 Frequency Range: .05 to 40 GHz  
 Insertion Loss:  $.065 \times \sqrt{f \text{ (GHz)}}$  dB Max.  
 VSWR: .050 to 18GHz: 1.20:1  
 18 to 26.5 GHz: 1.25:1  
 26.5 to 40.0 GHz: 1.35:1

Mechanical:

Interfaces: Per MIL-STD-348

Material:

Insulator: Noryl  
 Center Contact: Beryllium Copper & Brass  
 Other metal parts: Stainless Steel

Finish:

Center Contact: Gold Plated  
 Other metal parts: Passivated

Environmental:

Temperature: -55°C to +100°C

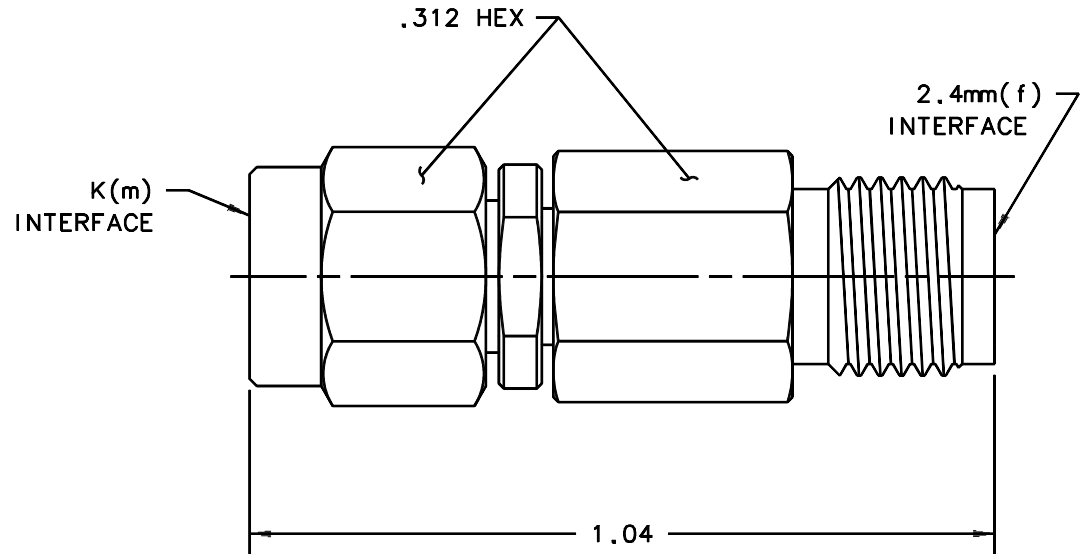

Notes:

1. Unless otherwise specified; all dimensions are reference only.

UNLESS OTHERWISE SPECIFIED:  
 DIMENSIONS ARE IN INCHES  
 CHAMFER FIRST THREAD 45°  
 DIMENSIONS BEFORE PLATING

TOLERANCES:  
 FRACTIONS: ±1/64  
 .XX ±.01  
 .XXX ±.005  
 ANGLES: ±1/2°  
 MACHINED SURFACES  $\sqrt{}$

THIRD ANGLE PROJECTION

DRAWN BY	DATE
Warren W.	6/25/02
ENG APPROVAL	DATE
TM	7/15/02
MFG APPROVAL	DATE
RL	7/17/02
OTHER APPROVAL	DATE
REFERENCE	



TRU-CONNECTOR CORPORATION  
 245 LYNNFIELD STREET  
 PEABODY, MASSACHUSETTS

TITLE			
CONNECTOR, COAXIAL, RF K(m) to 2.4mm(f) ADAPTER, STRAIGHT			
SIZE	CAGE CODE	DWG NO.	REV
A	92180	TRU-9737-GPX	/
CAD FILE: ADAPTER BETWEEN SERIES/STRAIGHT		SCALE 4X	SHEET 1 of 1