

PLEASE CHECK WWW.MOLEX.COM FOR LATEST PART INFORMATION

Part Number: [0357607310](#)
Status: **Active**
Description: Wire Splice, 10-12 AWG, Post-Tin Plating

Documents:

[Packaging Specification \(PDF\)](#) [Product Specification PS-35760-003 \(PDF\)](#)
[Drawing \(PDF\)](#) [RoHS Certificate of Compliance \(PDF\)](#)

General

Product Family	Splices
Series	35760
Crimp Quality Equipment	Yes
Mil-Spec	N/A
Product Name	N/A

Physical

Barrel Type	Open
Insulation	None
Material - Metal	Brass
Packaging Type	Reel
Temperature Range - Operating	-30°C to +105°C
Wire Insulation Diameter	3.5mm (.138")
Wire Size AWG	10, 12
Wire Size mm ²	4.00 - 6.00

Electrical

Voltage - Maximum	200V AC (RMS)/DC
-------------------	------------------

Material Info

Reference - Drawing Numbers

Product Specification	PS-35760-003
Sales Drawing	SD-35760-003

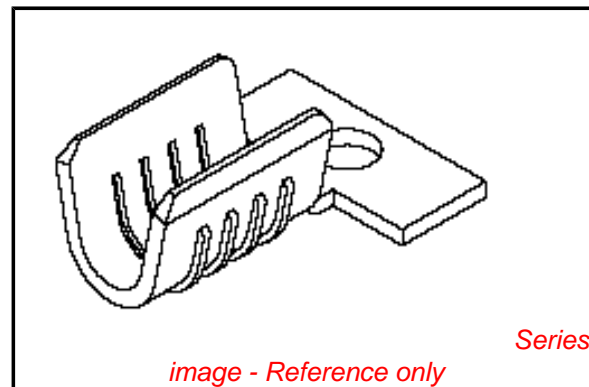

EU RoHS

**ELV and RoHS
Compliant**
**REACH SVHC
Contains SVHC: No**
**Halogen-Free
Status**
Halogen-Free

China RoHS



**Need more information on product
environmental compliance?**

Email productcompliance@molex.com
For a multiple part number RoHS Certificate of
Compliance, [click here](#)

Please visit the [Contact Us](#) section for any
non-product compliance questions.

Search Parts in this Series
[35760Series](#)

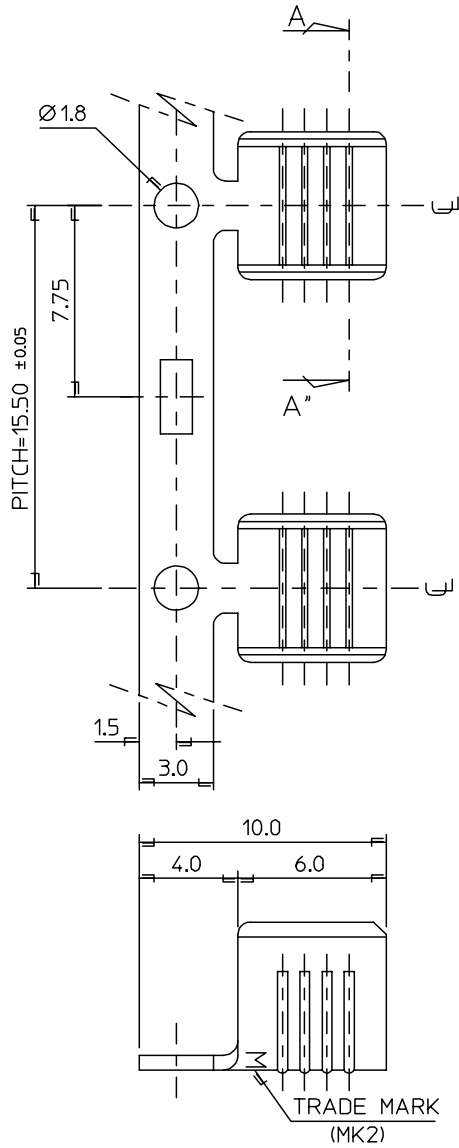

NOTES

1. MATERIAL : BRASS THICKNESS : 0.6mm
2. MATERIAL NO.

PART NO.	a	b	C	FINISH	WIRE RANGE	QUANTITY
35760-7300	6.0	6.0	R2.5	UNPLATED	4.0-6.0mm ²	2,000/REEL
35760-7310				POST PLATED TIN		
35760-7500	5.4	5.2	R2.2	UNPLATED	2.5-4.0mm ²	3,000/REEL
35760-7510				POST PLATED TIN		

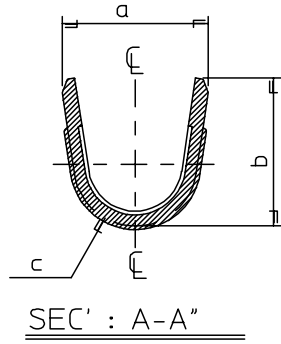

DWG. NO. SD-35760-003
 PROJECT NO.
 SIMILAR ITEM
 DO NOT SCALE DRAWING DIMENSION IN METRIC

ADDITION OF OPTION EC NDKOR2006-0064 DRWNSY/PARK 05/12/16 CHK: BC.YOON 05/12/16 APPR: SH.CHOI 05/12/16	QUALITY SYMBOLS MAJOR CRITICAL	GENERAL TOLERANCES: (UNLESS SPECIFIED)		SCALE 5:1	DESIGN UNITS <input checked="" type="checkbox"/> mm <input type="checkbox"/> INCH	THIRD ANGLE PROJECTION	DIMENSIONS: <input type="checkbox"/> mm <input type="checkbox"/> INCH <input checked="" type="checkbox"/> mm ONLY	SHT REV	
		4 PLACES ±0. ±. 3 PLACES ±0. ±. 2 PLACES ±0.20 ±. 1 PLACE ±0.30 ±.	DRAWN BY & DATE J.S.KANG 93/10/08	TITLE: WIRE SPLICE(M)		APPROVED BY & DATE C.W.LEE 93/10/08		MOLEX MOLEX INCORPORATED	
B	REV	DRAFT WHERE APPLICABLE MUST REMAIN WITHIN DIMENSIONS		CAD FILENAME SD35760.DGN	MATERIAL NO. SEE TABLE	DRAWING NO. SD-35760-003	THIS DRAWING CONTAINS INFORMATION THAT IS PROPRIETARY TO MOLEX INCORPORATED AND SHOULD NOT BE USED WITHOUT WRITTEN PERMISSION.		SIZE B