

Customer Information Sheet

DRAWING No.: C90-25042-1XXX

SHEET 2 OF 2

IF IN DOUBT - ASK

©

NOT TO SCALE

THIRD ANGLE PROJECTION

ALL DIMENSIONS IN mm

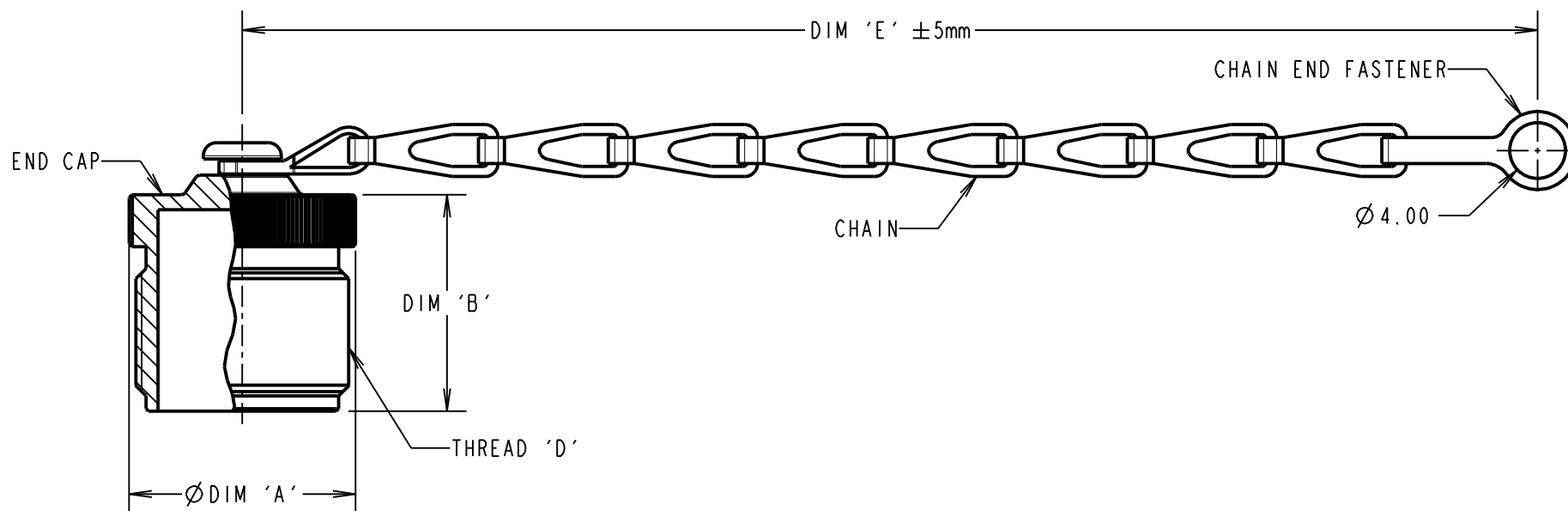

PART No.	DIM ϕ 'A' MAX	DIM 'B' MAX	THREAD 'D'	DIM 'E'
C90-25042-10SL	17.45	16.66	5/8-24UNEF-2A	101.60
C90-25042-12S	20.62	21.44	3/4-20UNEF-2A	114.30
C90-25042-14S	23.80	21.44	7/8-20UNEF-2A	114.30

SPECIFICATION:

MATERIAL:

END CAP = ALUMINIUM
 CHAIN & CHAIN END FASTENER = STAINLESS STEEL

FINISH:

END CAP = ZINC COBALT ALLOY, BLACK
 CHAIN & CHAIN END FASTENER: SS PASSIVATION
 ALL MATERIALS ARE ROHS COMPLIANT

MSP	3	19.07.17	20038
NAME	ISS.	DATE	C/NOTE
APPROVED:		M. PERREN	
CHECKED:		M. PLESTED	
DRAWN:		R. ADDE	
CUSTOMER REF.:			
ASSEMBLY DRG:			

HARWIN

www.harwin.com
 technical@harwin.com

THIS DRAWING AND ANY INFORMATION OR DESCRIPTIVE MATTER SET OUT HEREON ARE CONFIDENTIAL AND COPYRIGHT PROPERTY OF THE HARWIN GROUP AND MUST NOT BE DISCLOSED, LOANED, COPIED OR USED FOR MANUFACTURING, TENDERING OR FOR ANY OTHER PURPOSE WITHOUT THEIR WRITTEN PERMISSION.

TOLERANCES

X. = ± 1 mm
 X.X = ± 0.50 mm
 X.XX = ± 0.10 mm
 X.XXX = ± 0.01 mm
 ANGLES = $\pm 5^\circ$
 UNLESS STATED

MATERIAL:

SEE ABOVE

FINISH:

SEE ABOVE

S/AREA:

mm²

TITLE:

END CAP AND CHAIN

DRAWING NUMBER:

C90-25042-1XXX

SHT
 2
 OF
 2