



RECTIFIER DIODE

Reverse Voltage: 800 to 1600V
Forward Current: 60A

Features

- Low Leakage Current
- Low Forward Voltage
- 150°C Operating Junction Temperature
- Case Style TO-247AC
- RoHS Compliance

Applications

- Input rectification

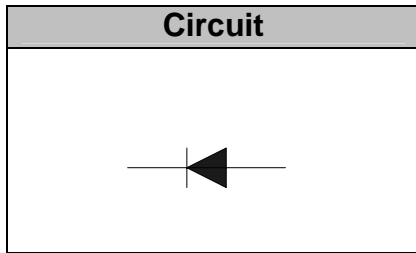

Module Type

TYPE	VRRM	VRSM
60EPS08	800V	900V
60EPS12	1200V	1300V
60EPS16	1600V	1700V

Maximum Ratings

Symbol	Conditions	Values	Units
I _{F(AV)}	T _c =98.5°C	60	A
I _{FSM}	t=10mS T _{vj} =45°C	1100	A
i ² t	t=10mS T _{vj} =45°C	6300	A ² s
Visol	a.c.50HZ;r.m.s.;1min	2500	V
T _{vj}		-40 to 150	°C
T _{stg}		-40 to 150	°C
T	Mounting Torque	1.5±15%	N.m
Weight	Approximate Weight	5.7	g

Thermal Characteristics

Symbol	Conditions	Values	Units
R _{th(j-c)}	Max. Thermal Resistance Junction to Case	0.35	°C/W
R _{th(c-s)}	Typical Thermal Resistance, Case to Heatsink	0.20	°C/W

Electrical Characteristics

Symbol	Conditions	Values			Units
		Min.	Typ.	Max.	
V _{FM}	T _j =25°C I _{FM} =30A	—	1.0	1.1	V
r _t	T _j =150°C		3.00	3.96	mΩ
V _{F(TO)}	T _j =150°C			0.74	V
I _{RD}	T _j =25°C V _R =VRRM	—	—	0.1	mA mA
	T _j =150°C V _R =VRRM	—	—	1.0	

Performance Curves

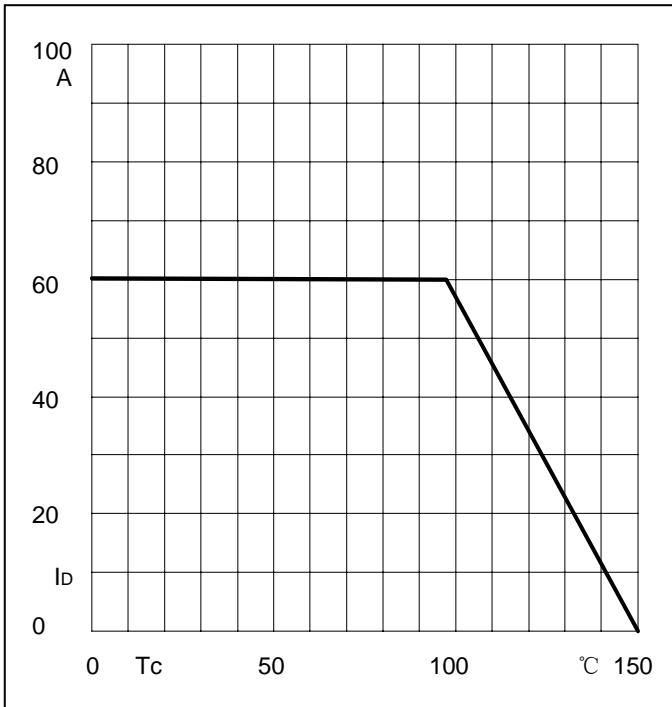

Fig1. Forward Current Derating Curve

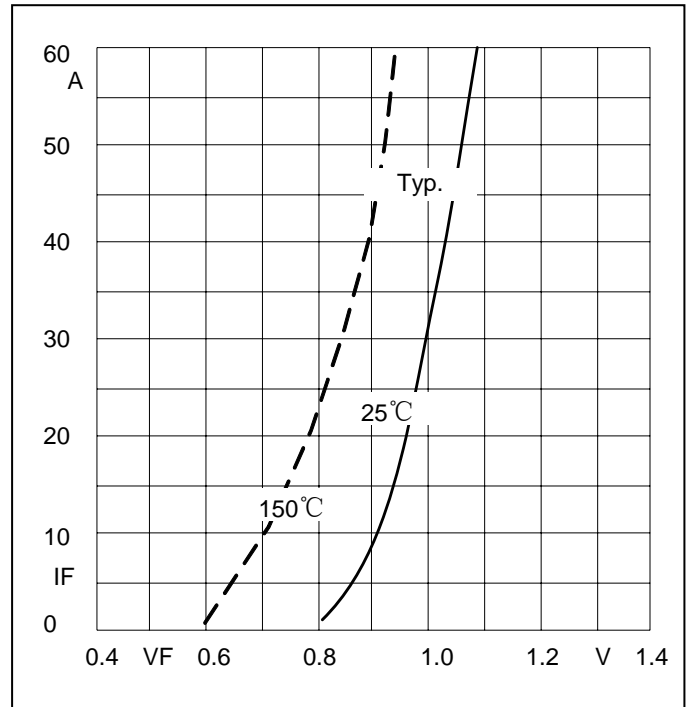

Fig2. Forward Characteristics

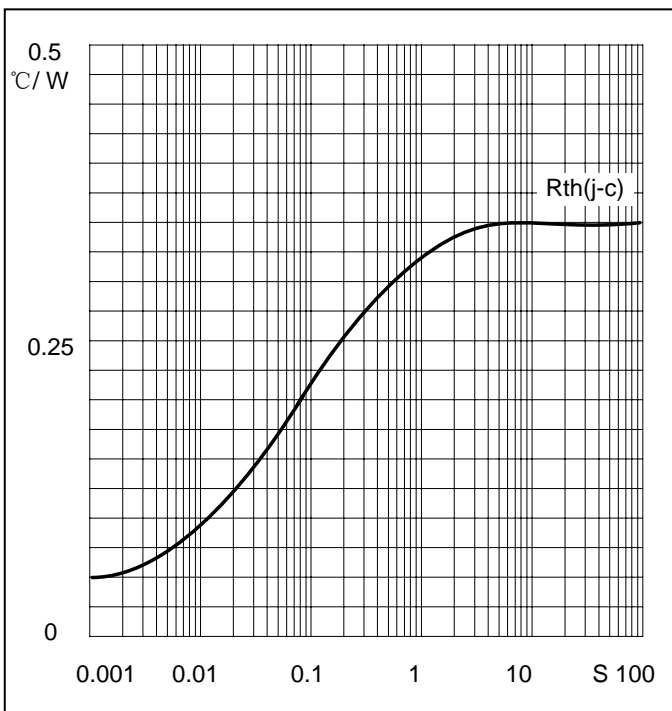

Fig3. Transient thermal impedance

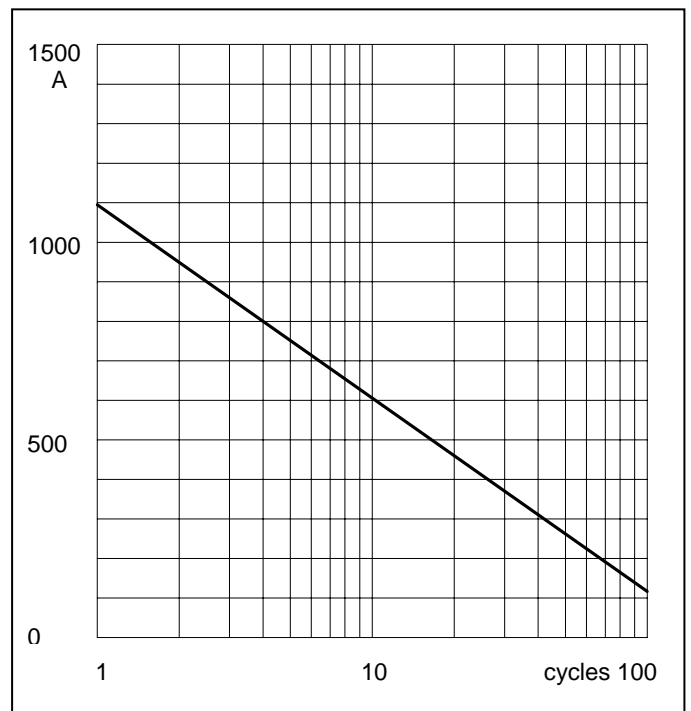
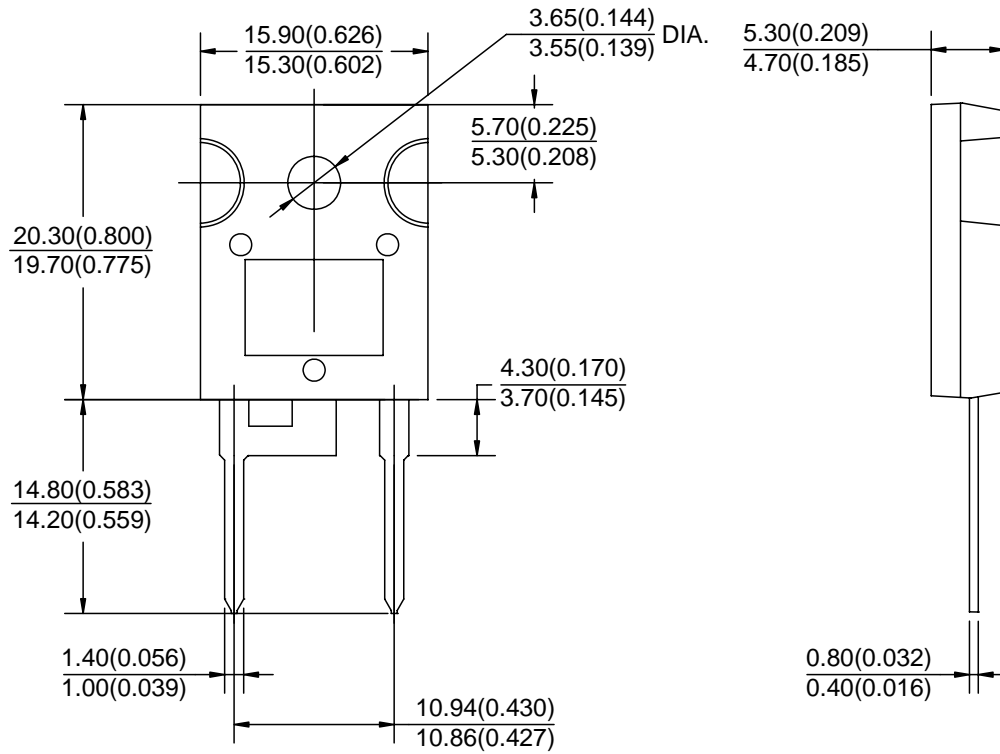

Fig4. Max Non-Repetitive Forward Surge Current

Package Outline Information

CASE: TO-247AC



Dimensions in mm (inches)