

36

3647

RAST 5 connectors, pitch 5.0 mm

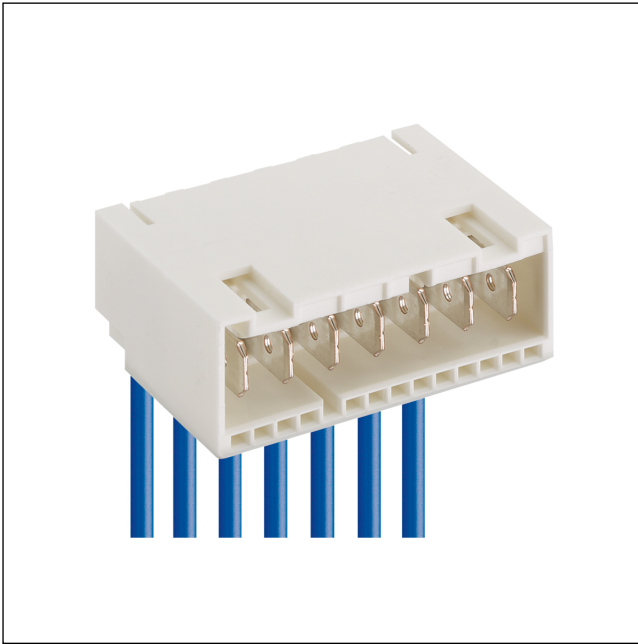

RAST 5 tab header, insulation displacement technology (IDT)

---

State: Active

---

Approvals:



36

3647

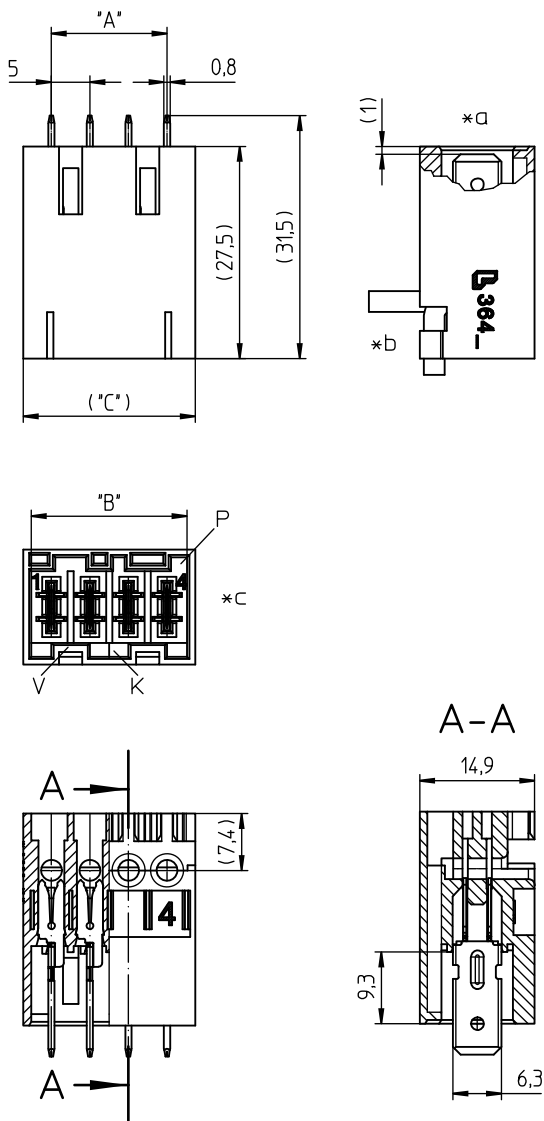

- \*a terminated connector
- \*b cable departure 90° or 180°
- \*c K = keying  
P = positioning  
V = space for lock

### Environmental conditions

Temperature range -40 °C/+130 °C<sup>1</sup>

<sup>1</sup> upper limit temperature (insulating body) RTI (electrical) of the UL Yellow Card

### Materials

Insulating body PA, V-2 according to UL94<sup>1</sup>

Contact tab CuSn, tin-plated

<sup>1</sup> component glow wire resistant (GWT 750 °C), testing acc. to IEC 60695-2-11, assessment acc. to IEC 60335-1 (flame < 2 s)

### Mechanical data

Contact tab 6.3 x 0.8 mm according to DIN 42644

Keying proposals at [www.lumberg.com](http://www.lumberg.com) 

### Connectable conductors for IDT area

Construction discrete conductor, notched flat cable 5.0 mm

Section min.

Section max.

Insulation diameter

Approved cables at [www.lumberg.com](http://www.lumberg.com) 

### Electrical data (at T<sub>amb</sub> 20 °C)

Contact resistance ≤ 5 mΩ

Rated current 6 A (0,75 mm<sup>2</sup>, T<sub>v</sub> 90 °C)  
10 A (0,75 mm<sup>2</sup>, T<sub>v</sub> 60 °C)

Rated voltage 250 V AC

Material group IIIa (IEC)/2 (UL) (CTI ≥ 250)

Creepage distance ≥ 4,7 mm

Clearance ≥ 4,2 mm



Insulation resistance > 10 GΩ

### Associated products

Counterparts

 3611  3615  3615-1



 3615-2  3615-3  3623

 3623 01 V01  3626  3628

 3680  3683  3686

 3687

Harnessing equipment

 HA364-ST  KHP364

36

3647

---

36

3647

Designation	Pole Number	PU (Pieces)	MDQ (Pieces)	Dimensions		
				A (mm)	B (mm)	C (mm)
3647 02	2	3000	300	5	10.2	12.3
3647 03	3	2100	2100	10	15.2	17.3
3647 04	4	1650	1650	15	20.2	22.3
3647 05	5	1350	2700	20	25.2	27.3
3647 06	6	1100	2200	25	30.2	32.3
3647 07	7	950	1900	30	35.2	37.3
3647 08	8	850	1700	35	40.2	42.3

Designation to be completed by further details (e.g. for keying, color or material options).

**Packaging:**

in bulk, in a cardboard box