

16

NES/J 135

Power supply connectors



Power supply plug, straight version, with solder eyes

State: Active

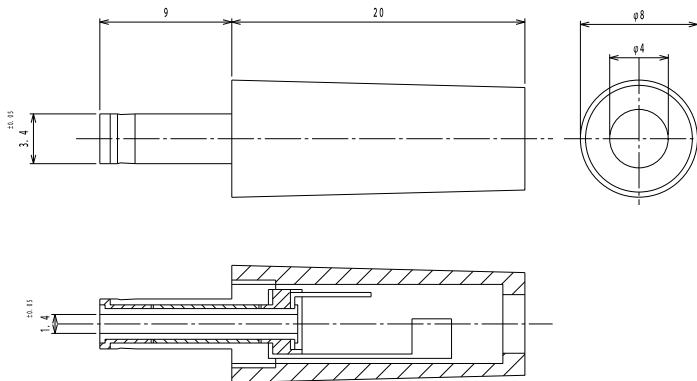

Environmental conditions

Temperature range -25 °C/+70 °C

Materials

Insulating body	PC
Contact	CuZn/CuSn, nickel-plated
Insulation	PVC/ebonite
Housing	ABS

Mechanical data

Outer diameter	3,4 mm
Inner diameter	1,4 mm

Connectable conductors for solder area

Cable diameter 4 mm

Electrical data (at T_{amb} 20 °C)

Rated current	0,5 A
Rated voltage	12 V DC
Rated impulse voltage	500 V/60 s
Insulation resistance	≥ 100 MΩ

Associated products

Counterparts
[☞ 1613 12](#) [☞ 1613 20](#) [☞ 1614 17](#)

16

NES/J 135

Designation	Pole Number	PU (Pieces)	MDQ (Pieces)
NES/J 135	2	100	500

Packaging:

in bulk, in a cardboard box or a plastic bag