

DETAILS

| | |
|------------------------|-----------------------|
| Product Number | CA14461_VERONICA-SQ-M |
| Family | Veronica |
| Type | Assembly |
| Color | clear |
| Diameter | 22,5x22,5 mm |
| Height | 12,2 mm |
| Style | square |
| Optic Material | PMMA |
| Holder Material | |
| Fastening | tape, pin |
| Status | production ready |
| ROHS Compliant | Yes |
| Date Updated | 30/11/2016 |

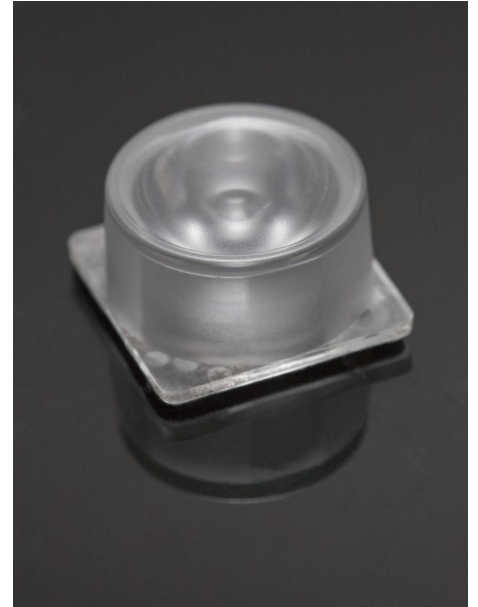

OPTICAL PROPERTIES

| LED | Viewing | Light | Efficiency | cd/lm | Connector |
|-------------------|---------|--------|------------|-------|-----------|
| | Angle | Beam | | | |
| XT-E | 27 deg | Medium | 87 % | 3.500 | - |
| XP-G2 | 30 deg | Medium | 89 % | 3.060 | - |
| XP-L | 40 deg | Medium | 91 % | 2.000 | - |
| XM-L | 37 deg | Medium | 92 % | 2.100 | - |
| XP-E2 | 25 deg | Medium | 94 % | 4.200 | - |
| XP-E | 28 deg | Medium | 93 % | 3.600 | - |
| XM-L2 | 38 deg | Medium | 91 % | 2.100 | - |
| XB-H | 29 deg | Medium | 91 % | 3.000 | - |
| XHP35 HD | 40 deg | Medium | 88 % | 1.900 | - |
| XHP35 HI | 33 deg | Medium | 88 % | 2.700 | - |
| XP-L2 | 37 deg | Medium | 87 % | 2.000 | - |
| H35C1 (LEMWA33) | 33 deg | Medium | 92 % | 2.700 | - |
| LUXEON MZ | 32 deg | Medium | 93 % | 2.700 | - |
| LUXEON R | 30 deg | Medium | 91 % | 3.000 | - |
| LUXEON Rebel | 26 deg | Medium | 92 % | 3.600 | - |
| LUXEON T | 30 deg | Medium | 93 % | 3.000 | - |
| LUXEON TX | 30 deg | Medium | 92 % | 3.200 | - |
| LUXEON Rebel ES | 27 deg | Medium | 91 % | 3.500 | - |
| LUXEON A | 30 deg | Medium | 91 % | 3.000 | - |
| NVSxx19B/NVSxx19C | 30 deg | Medium | 91 % | 2.900 | - |
| NCSxx19B | 23 deg | Medium | 92 % | 4.100 | - |
| NWSx229A | 39 deg | Medium | 89 % | 2.000 | - |
| Oslon Square PC | 29 deg | Medium | 91 % | 3.000 | - |
| Oslon Square EC | 28 deg | Medium | 91 % | 3.400 | - |
| Z8Y22P | 29 deg | Medium | 88 % | 2.900 | - |



PRODUCT DATASHEET
Veronica series
last update 30/11/2016

OPTICAL PROPERTIES

| LED | Viewing Angle | Light Beam | Effi- ciency | cd/lm | Connector |
|-----|------------------|---------------|-----------------|-------|-----------|
|-----|------------------|---------------|-----------------|-------|-----------|

Relative intensity of CA14461_VERONICA-SQ-M_(XT-E)

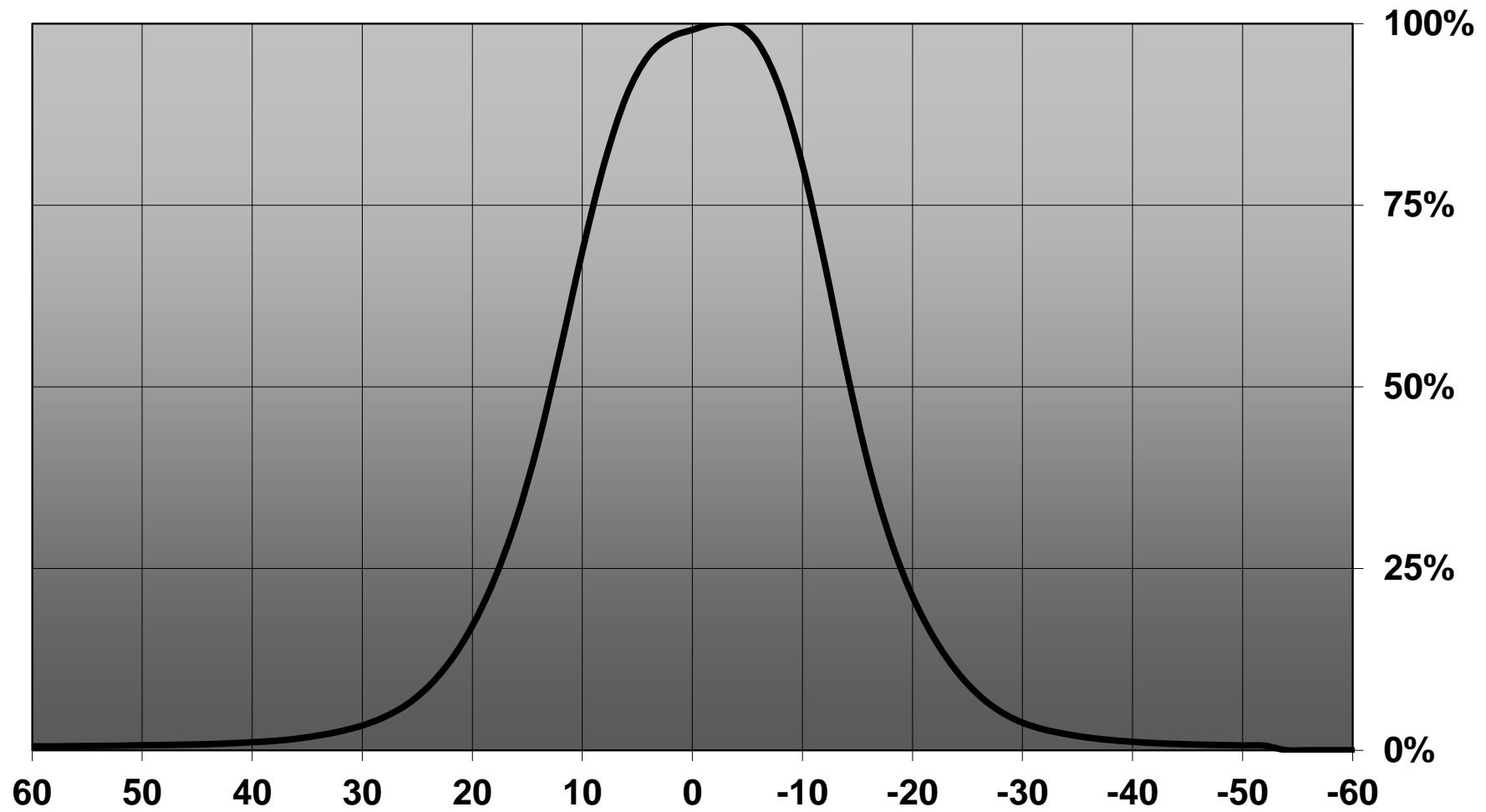

Relative intensity of CA14461_VERONICA-SQ-M_(XP-G2)

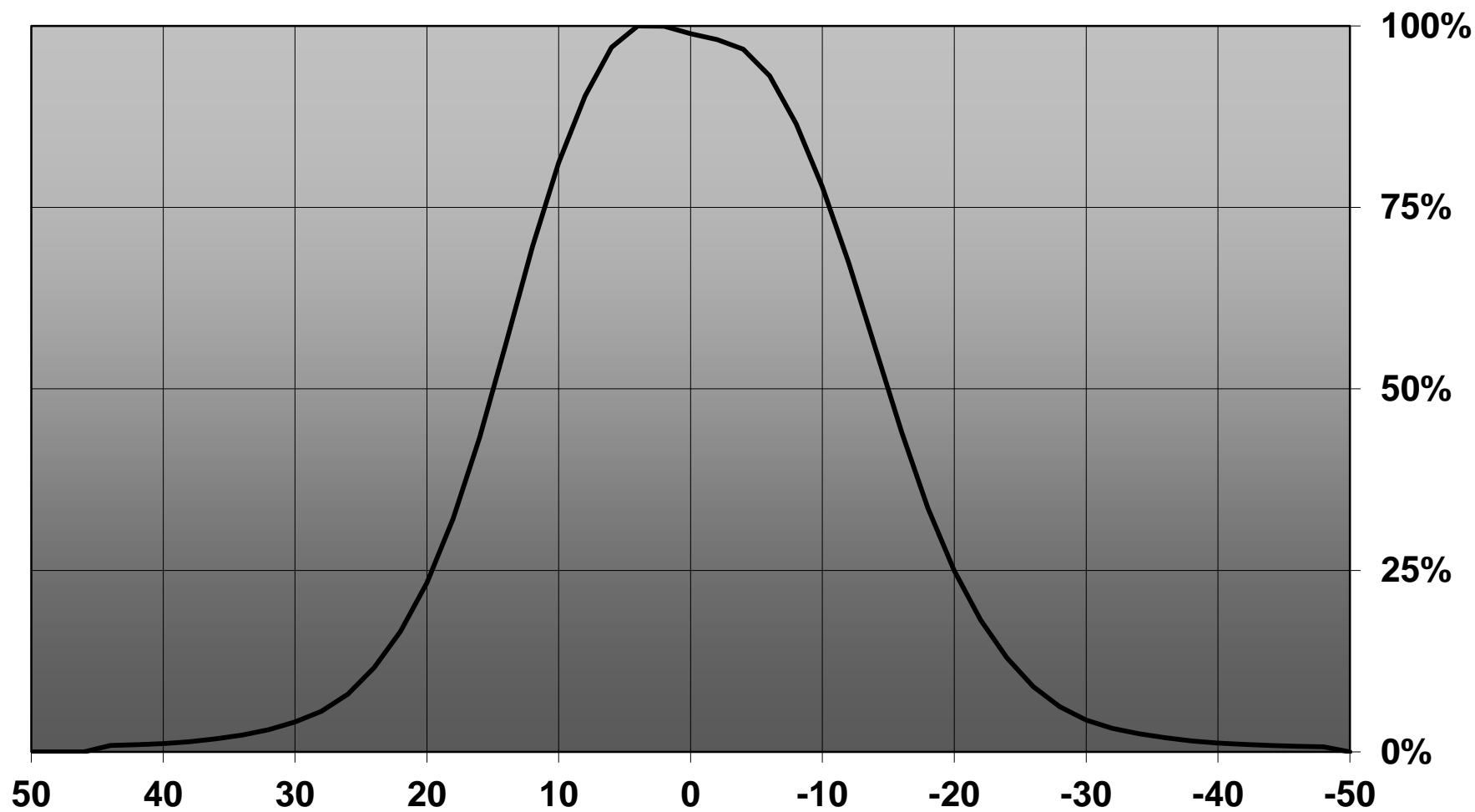

Relative intensity of CA14461_VERONICA-SQ-M_(XHP35_HD)

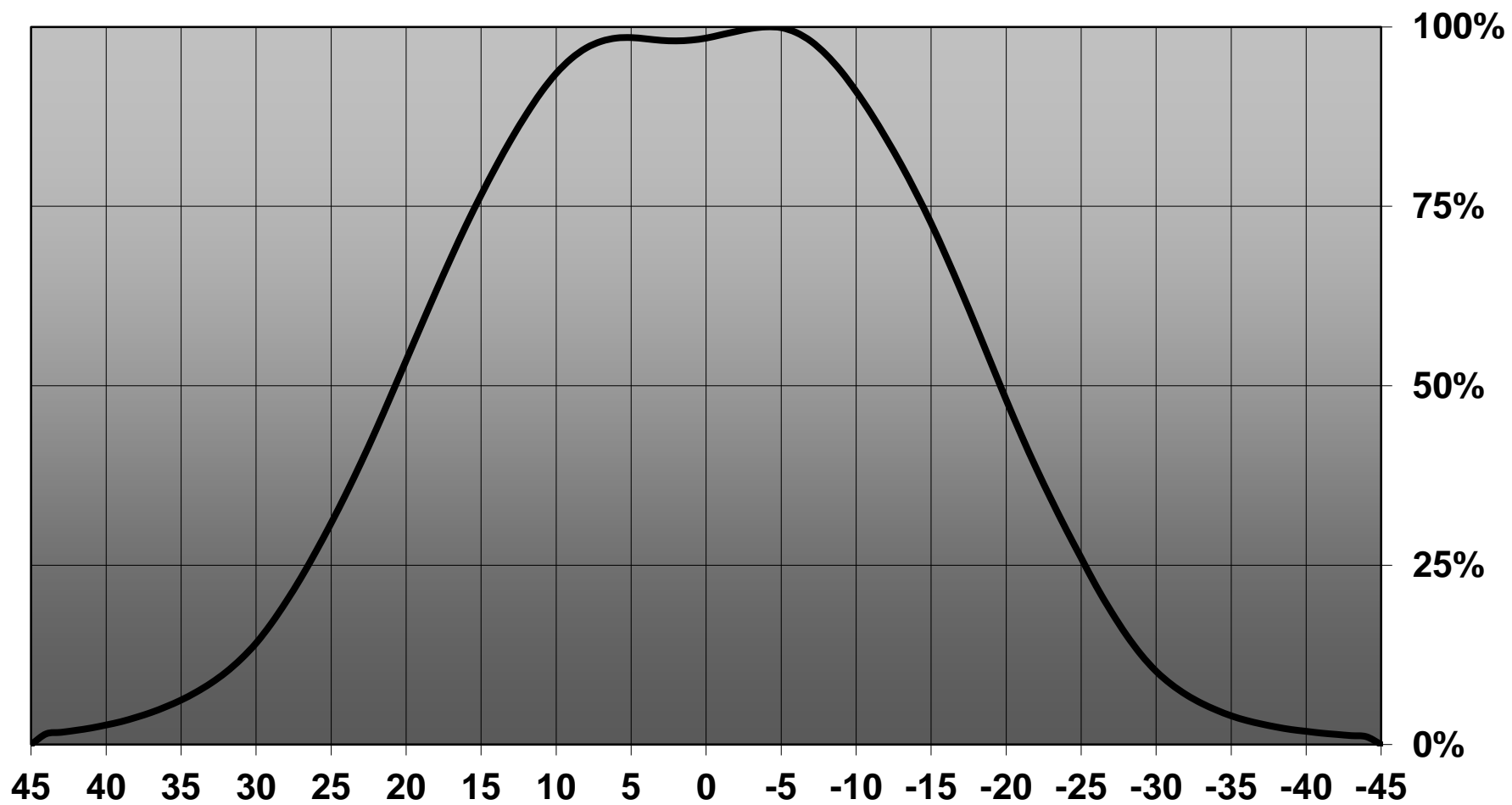

Relative intensity of CA14461_VERONICA-SQ-M_(XPH35_HI)

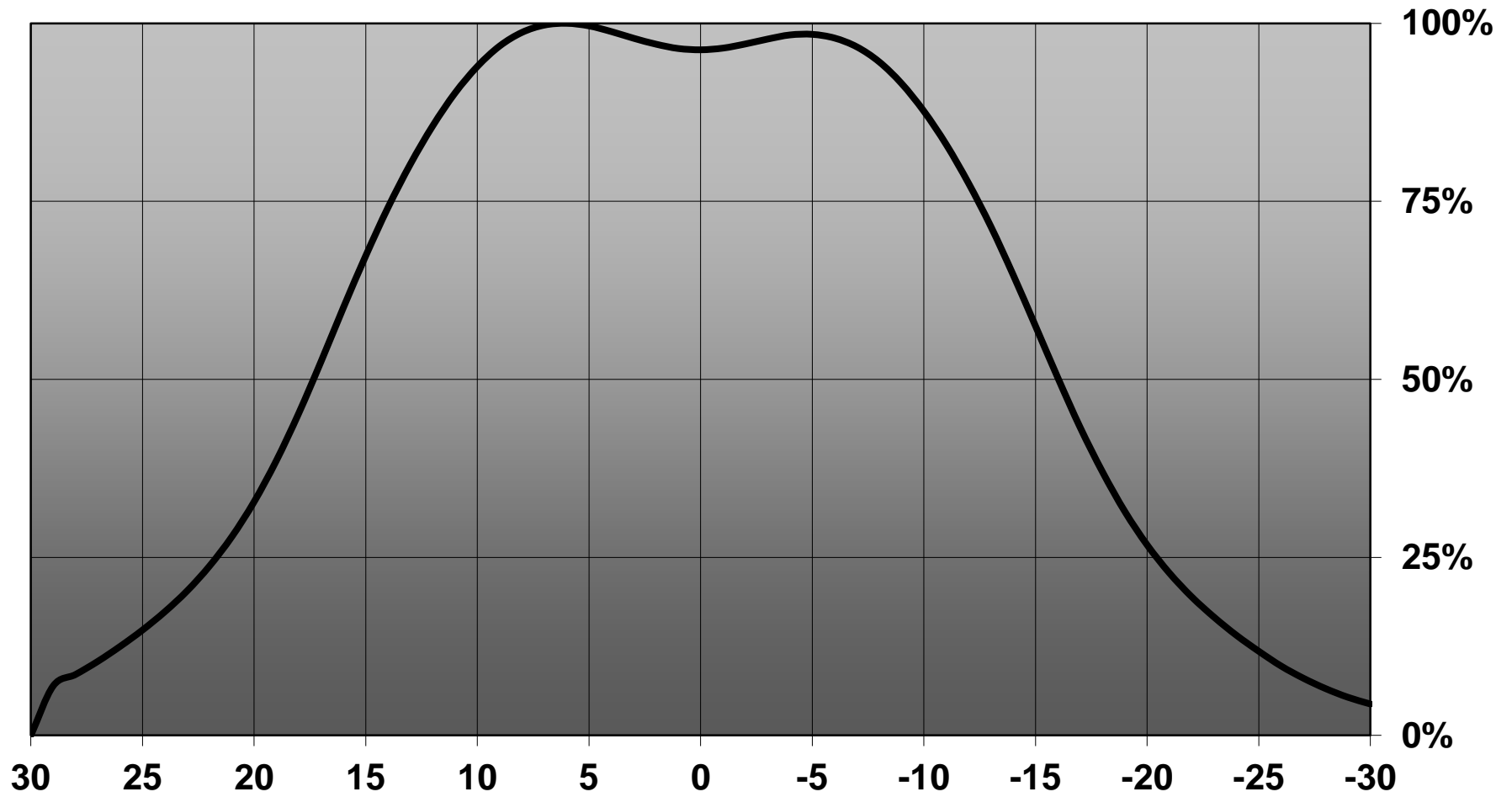

D

C

B

A

4

4

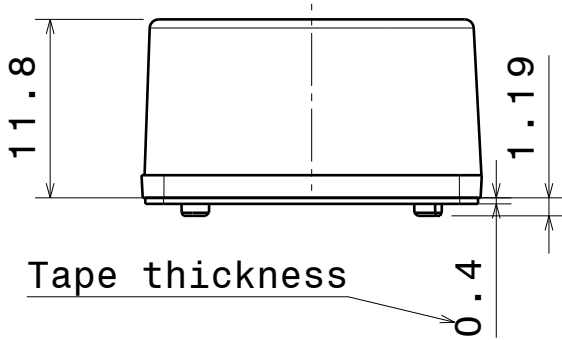

Tape thickness

Front view

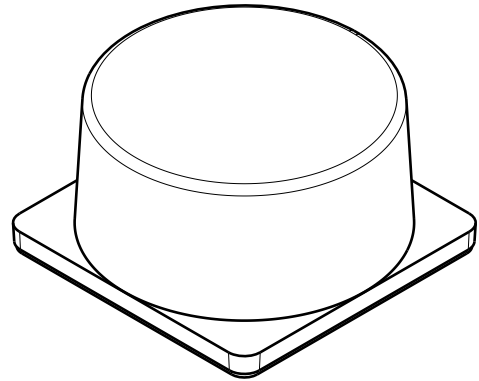

Isometric view

3

3

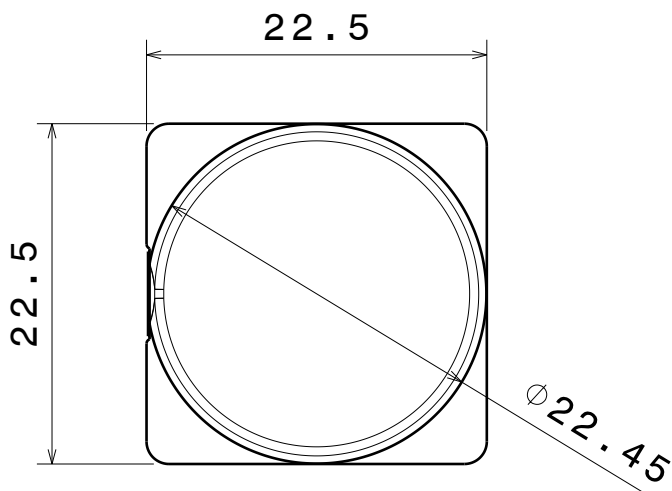

Top view

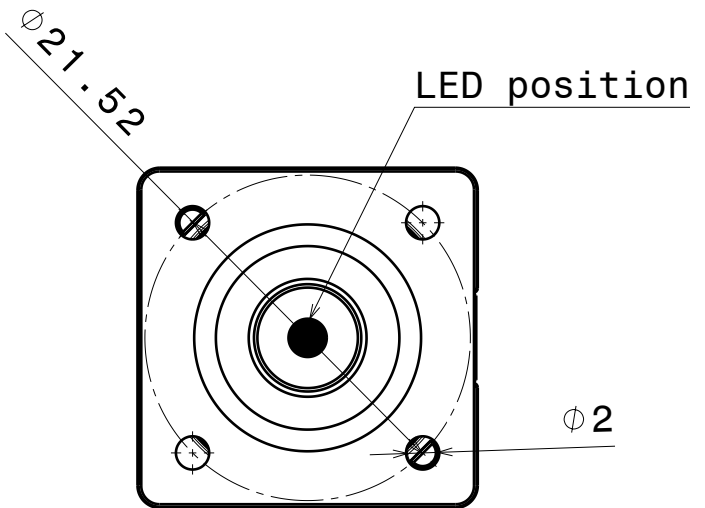

Bottom view

| INDEX | PART NO | DESCRIPTION | MATERIAL | COLOUR |
|-------|---------|------------------|----------|--------|
| 1 | C14448 | VERONICA-SQ-M | PMMA | clear |
| 2 | C13729 | VERONICA-SQ-TAPE | PU | black |

Tolerances if not otherwise shown
According to DIN ISO 2768-1
Linear measures: class C
According to DIN ISO 2768-2
Form and position: class L

LEDiL

Ledil Oy
Salorankatu 10
FIN 24240 SALO
Finland

THIRD ANGLE PROJECTION:

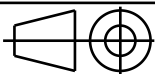

DRAWING TITLE

CA14461_VERONICA-SQ-M

This drawing is the property
of LEDiL Oy. It may not be
reproduced, copied or
communicated without a written
agreement with LEDiL Oy.

SIZE PART NUMBER

A4

CA14461

SCALE

2:1

WEIGHT

3,64 g

SHEET

1/1

D

A

1

1

Luminaire: LEDiL Oy CA14461_VERONICA-SQ-M_(XP-L)

Lamps: 1 x Cree_XP-L_(XPLAWT-0-7A3-U50-0H-0001)_102.988lm@250mA_P=0.724035W_I=0.2499A

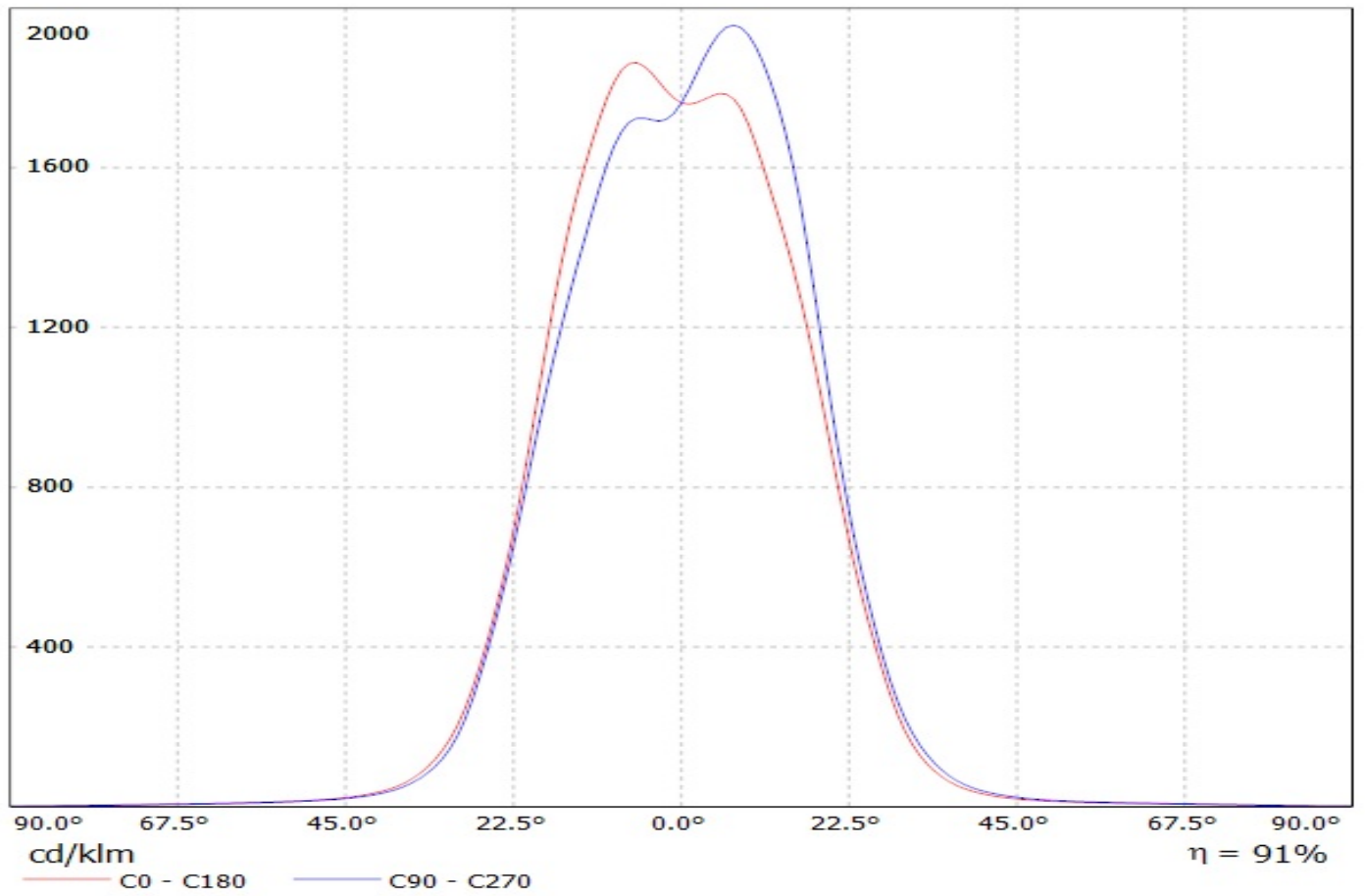

Luminaire: LEDiL Oy CA14461_VERONICA-SQ-M (Cree_XM-L)
Lamps: 1 x Cree_XM-L_90.3992lm@250mA_P=0.735056W_I=250mA

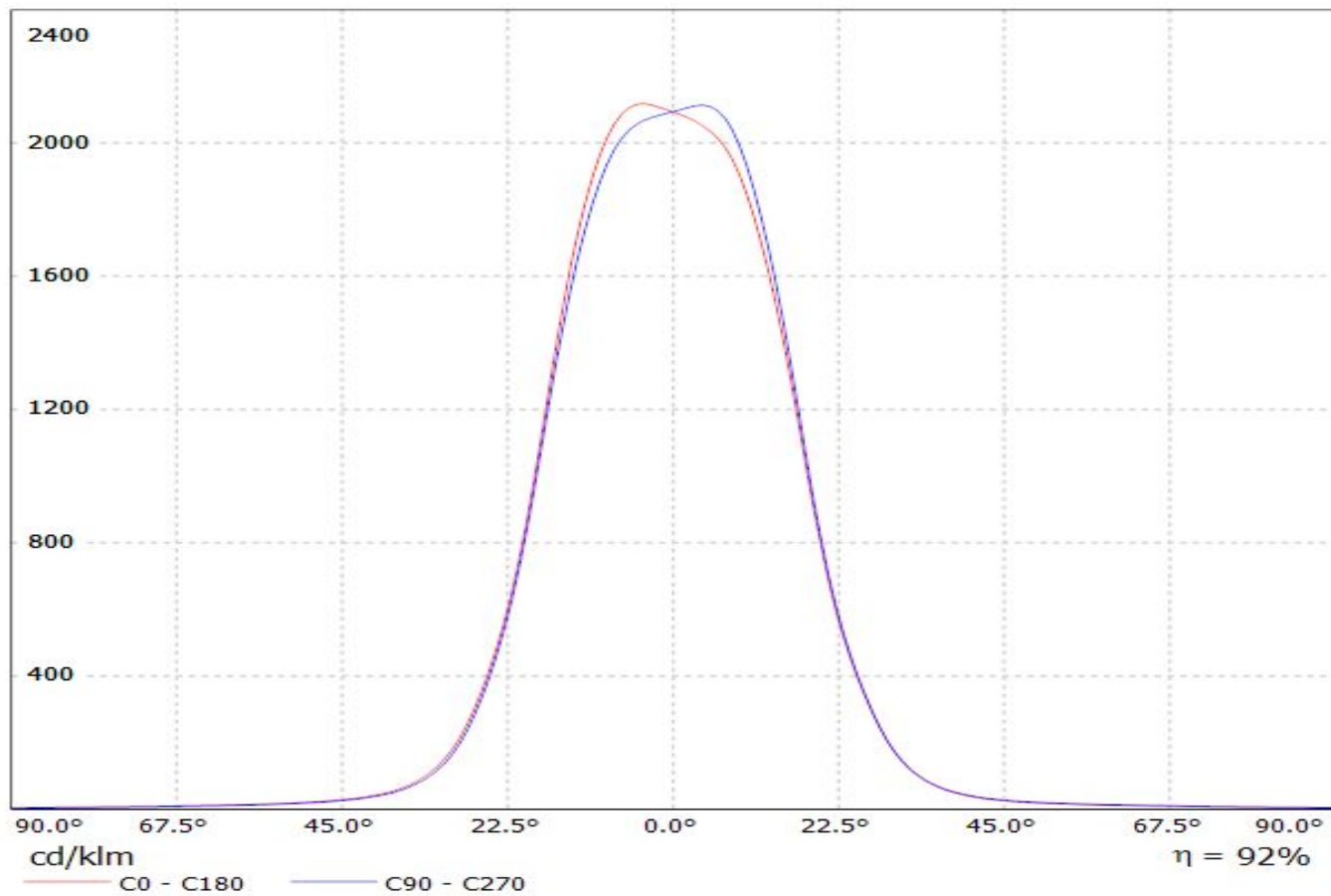

Luminaire: LEDiL Oy CA14461_VERONICA-SQ-M_(Cree_XP-E2)
Lamps: 1 x Cree_XP-E2_79.5831lm@250mA_P=0.754073W_I=250mA

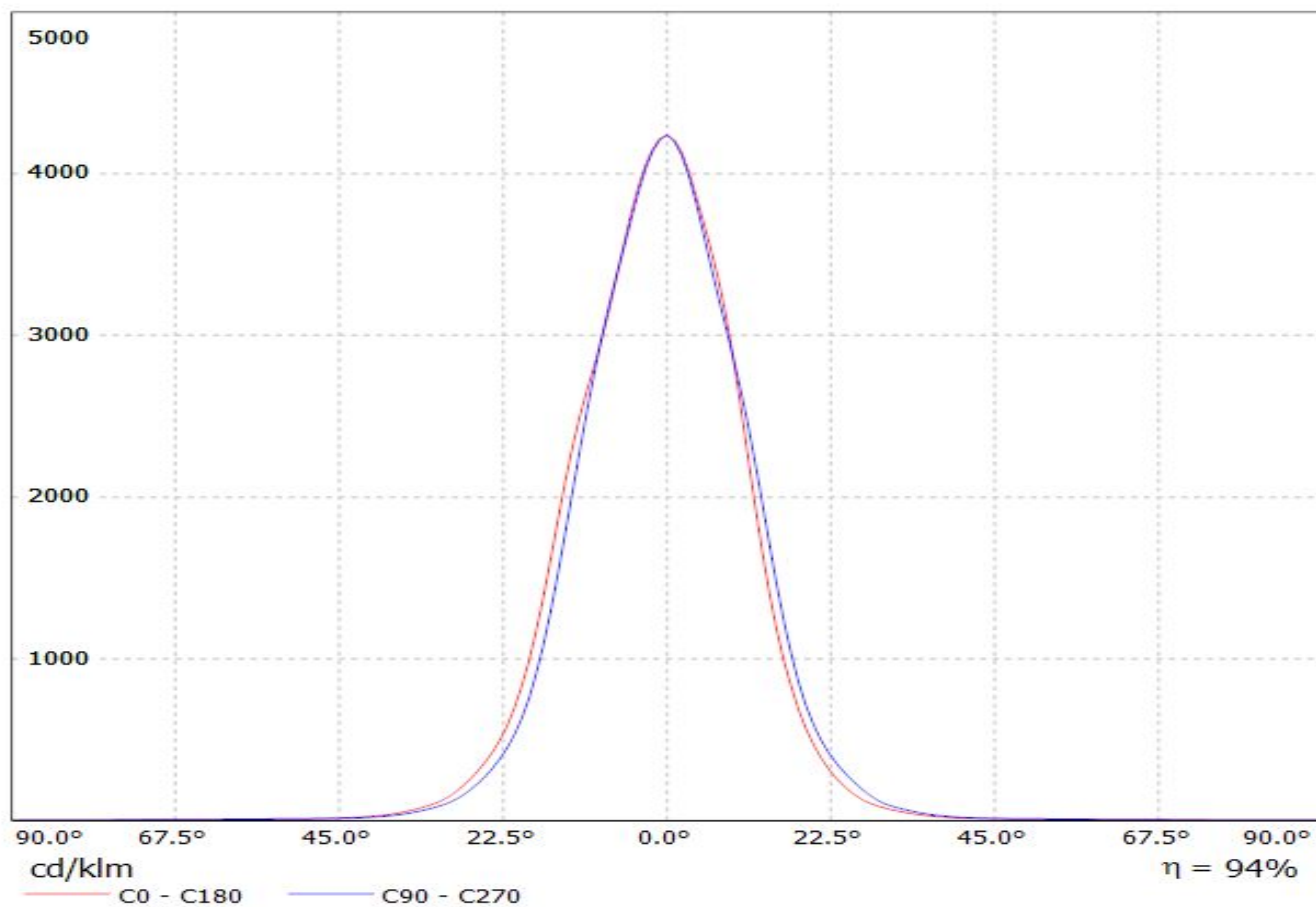

Luminaire: LEDiL Oy CA14461_VERONICA-SQ-M_(XP-E)

Lamps: 1 x Cree_XP-E_(XPEWHT-L1-3C0-Q5-0-06)_78.0735lm@250mA_P=0.803378W_I=0.2499A

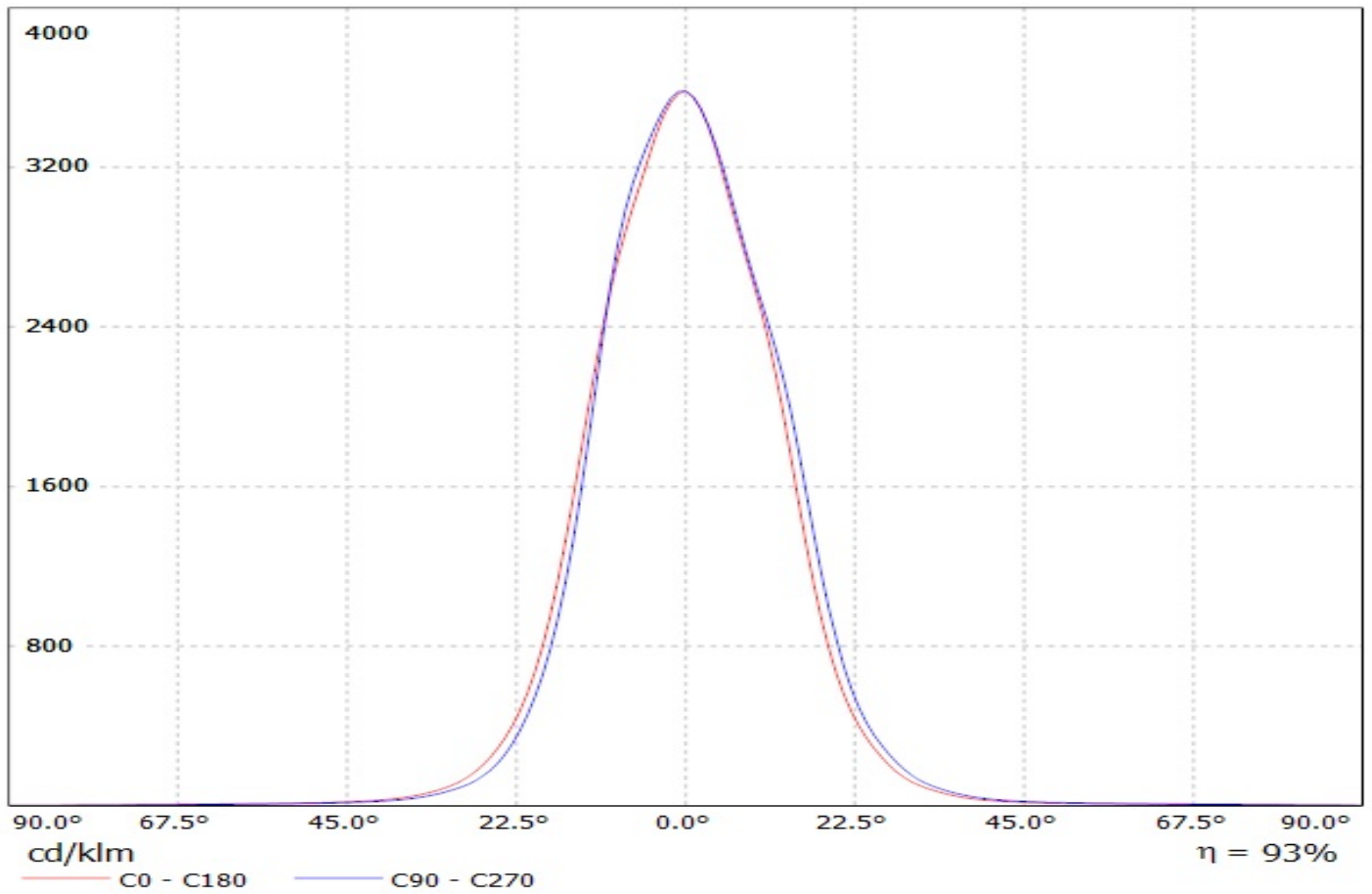

Luminaire: LEDiL Oy CA14461 VERONICA-SQ-M_(XM-L2)

Lamps: 1 x Cree_XM-L2_(XMLBWT-0-7B4-T30-0L-0001)_95.1239lm@250mA_P=0.734831W_I=0.2499A

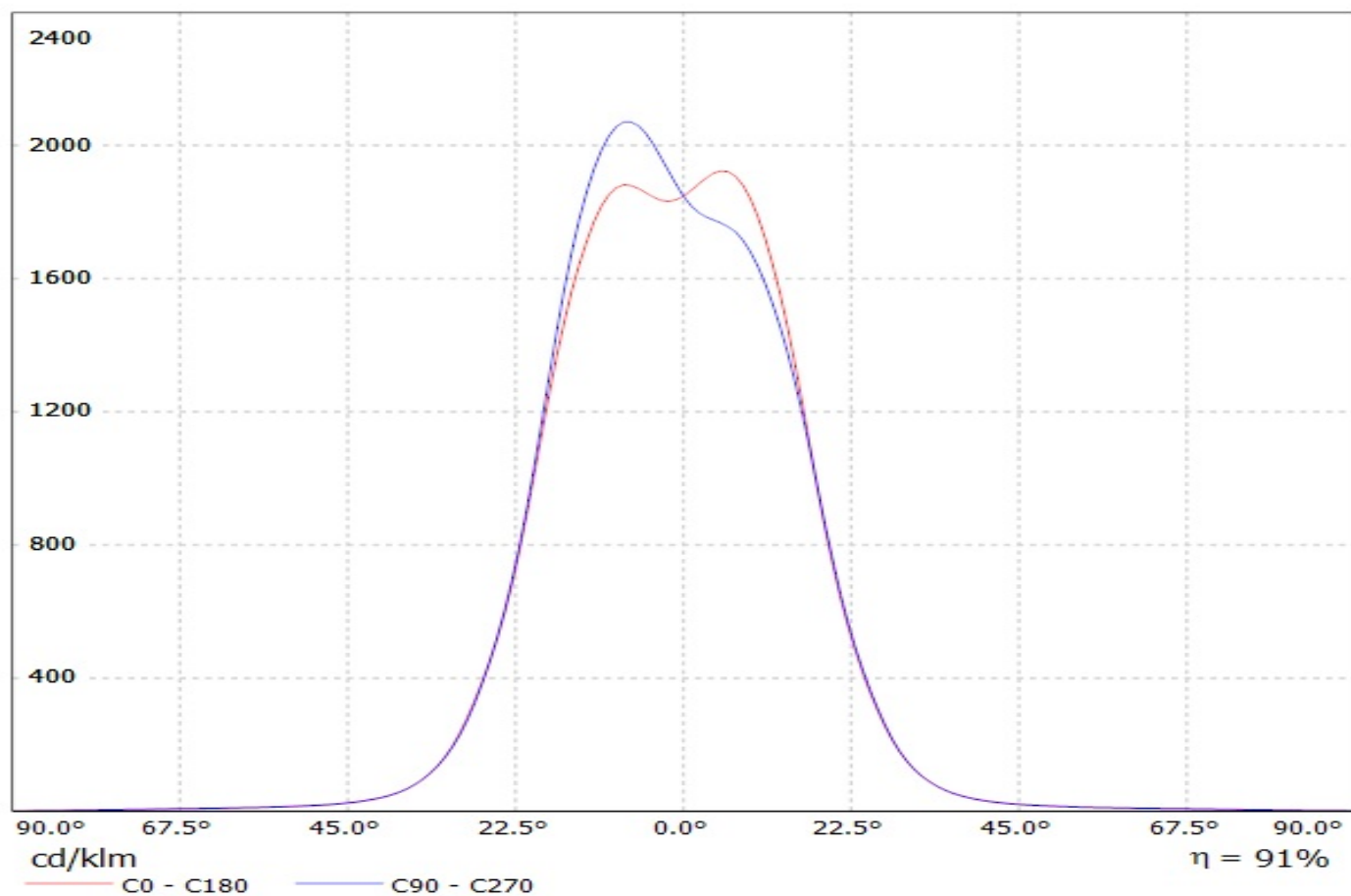

Luminaire: LEDiL Oy CA14461_VERONICA-SQ-M_(XB-H)

Lamps: 1 x Cree_XB-H_(XBHAWT-0-7C1-T30-0H-0001)_97.2452lm@250mA_P=0.755198W_I=0.2499A

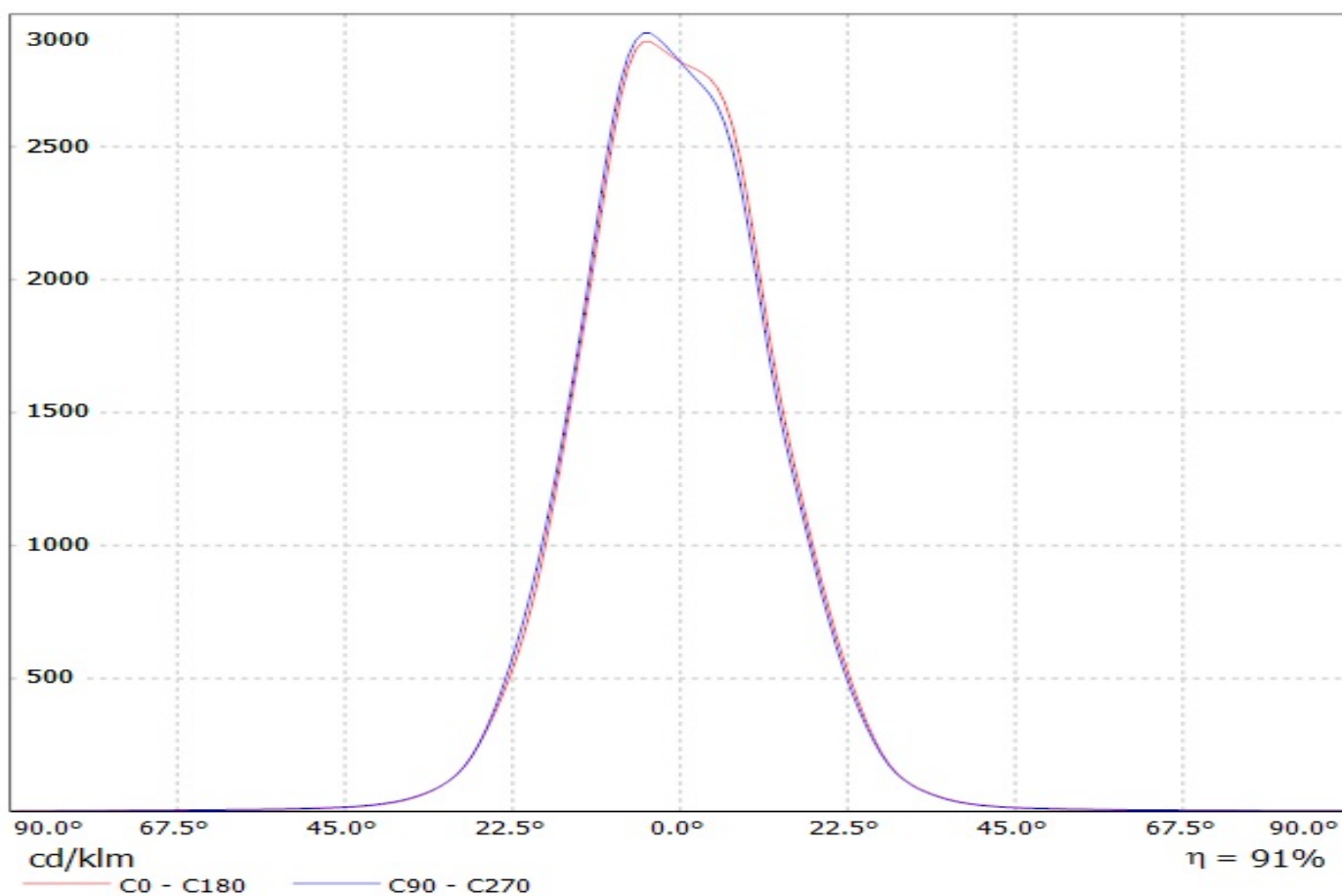

Luminaire: Ledil CA14461_VERONICA-SQ-M_(XP-L2)

Lamps: 1 x Cree_XP-L2_(XPLWT-00-0000-000HU630G)_115.868lm@250mA_P=0.717875W_I=0.25A

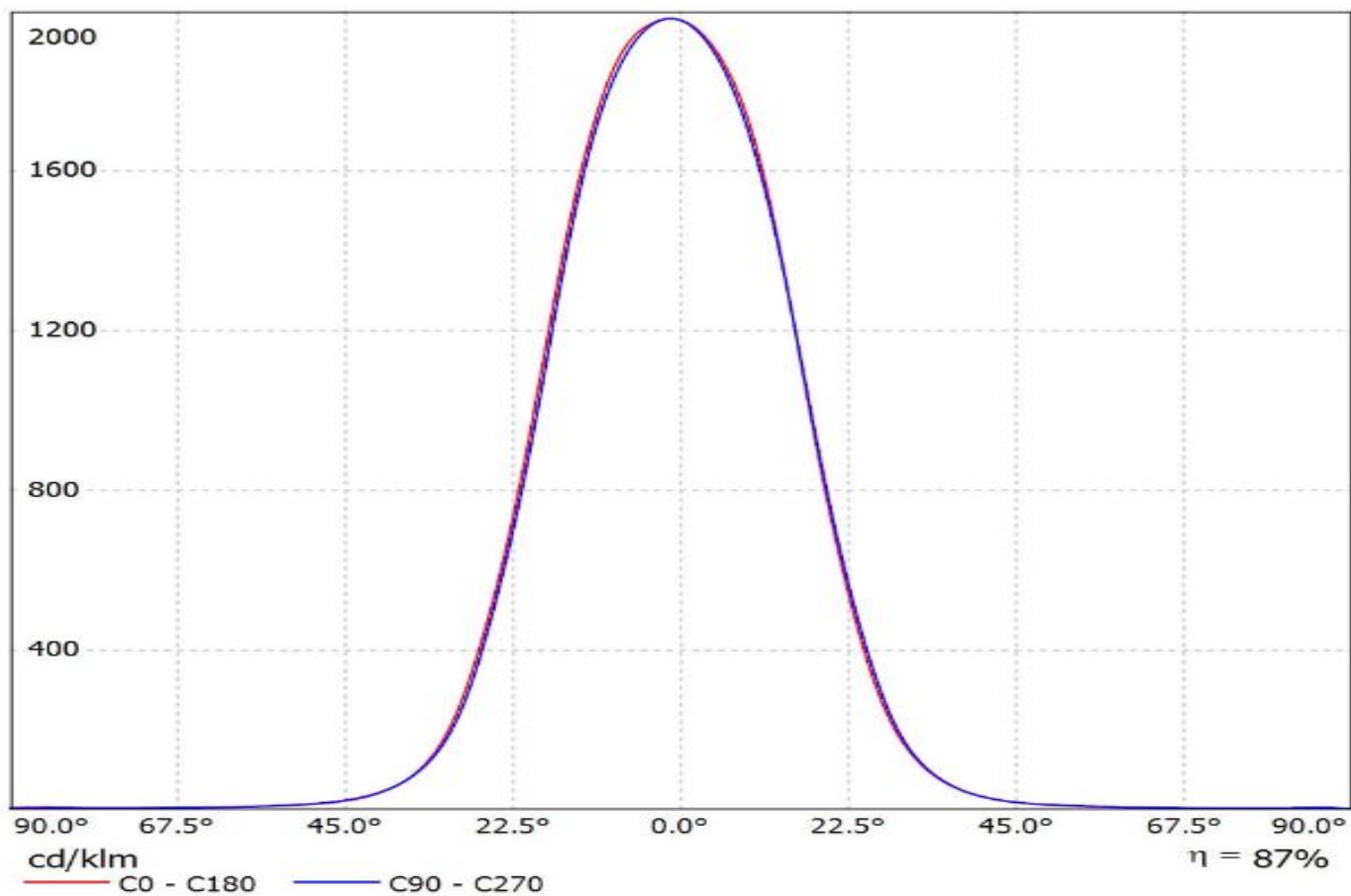

Luminaire: LEDiL Oy CA14461_VERONICA-SQ-M_(H35C1)

Lamps: 1 x LG_H35C1_(PKG5700K)_116.036lm@250mA_CCT=6235K_P=0.757272W_I=0.2499A

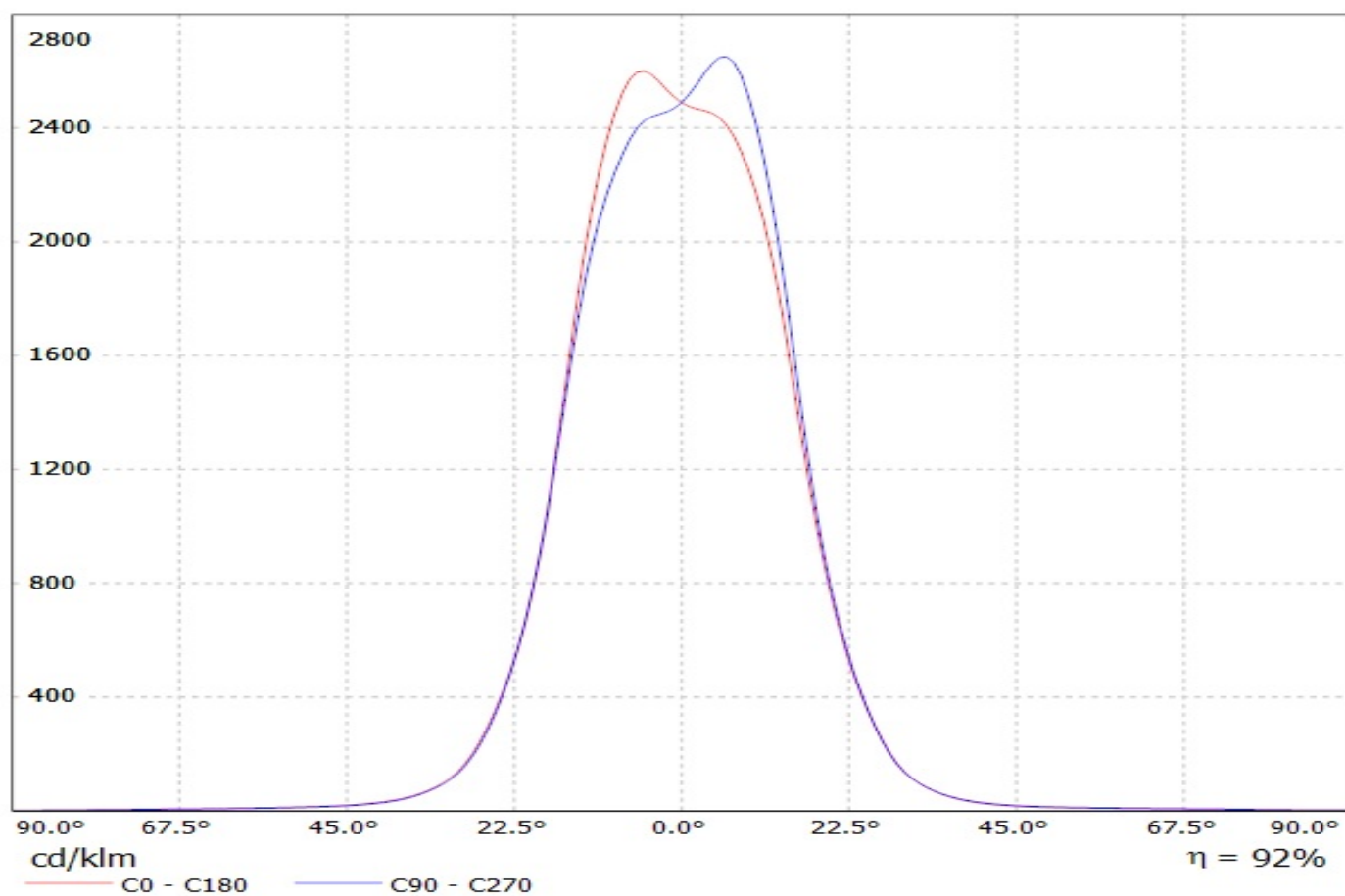

Luminaire: LEDiL Oy CA14461_VERONICA-SQ-M_(Luxeon_MZ)
Lamps: 1 x Philips_Lumileds_Luxeon_MZ_386.758lm@250mA_P=2.77489W_I=0.2499A

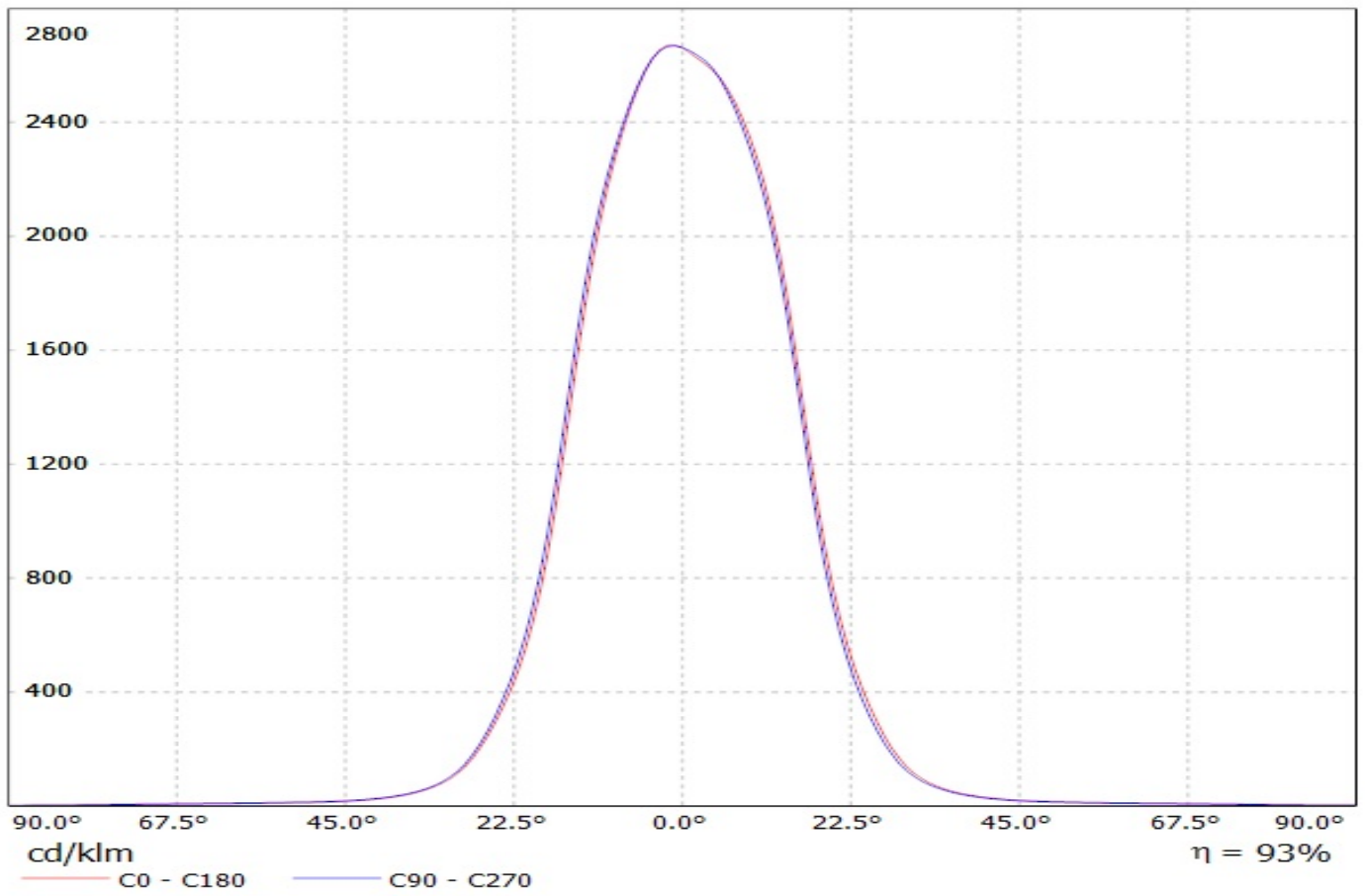

Luminaire: LEDiL Oy CA14461_VERONICA-SQ-M_(Luxeon_R)

Lamps: 1 x Philips_Lumileds_Luxeon_R_(LXA7-PW30)_74.1293lm@250mA_CCT=3049K_P=0.727484W_I=0.2499A

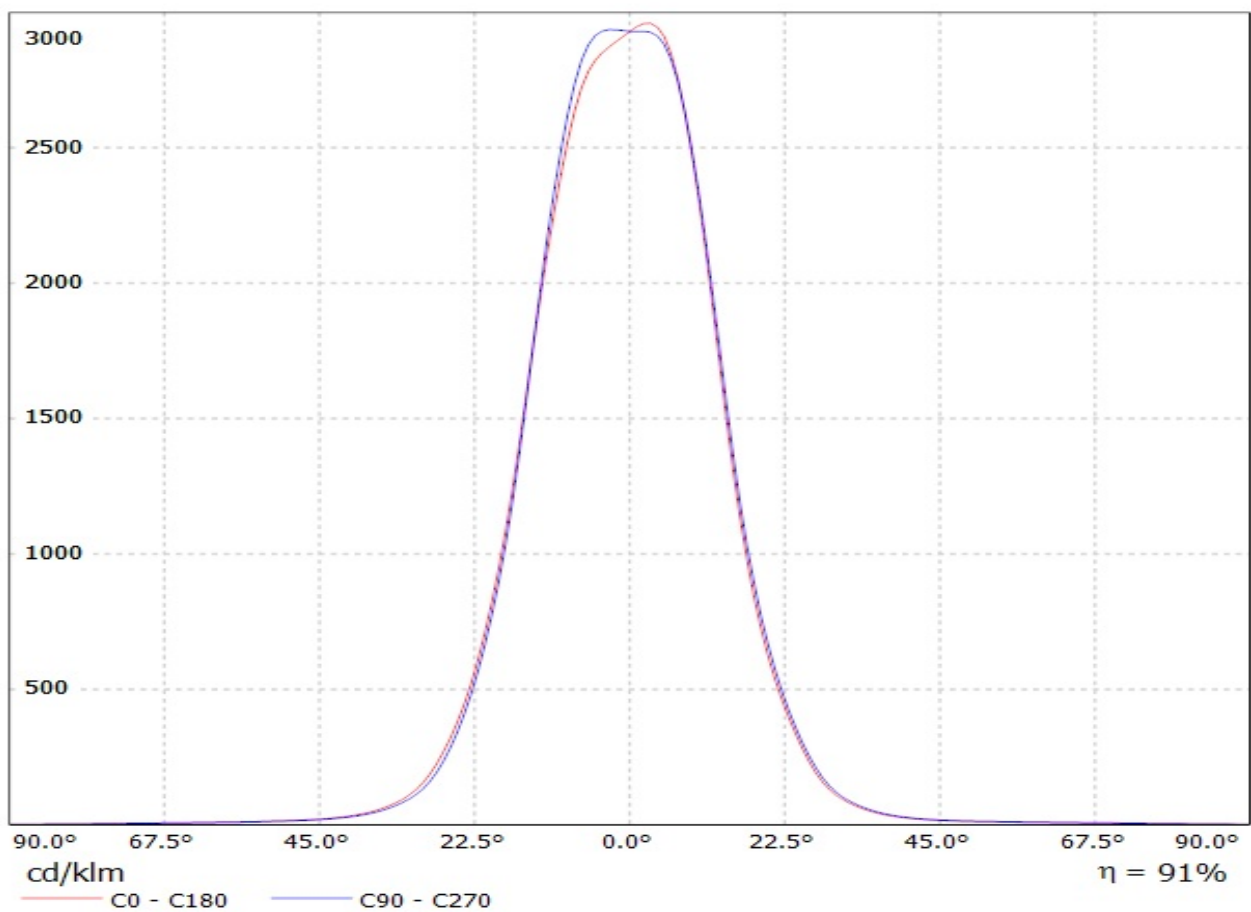

Luminaire: LEDiL Oy CA14461_VERONICA-SQ-M_(Luxeon_Rebel)

Lamps: 1 x Philips_Lumileds_Luxeon_Rebel_(LXM8-PW30)_61.1293lm@250mA_P=0.728758W_I=0.2499A

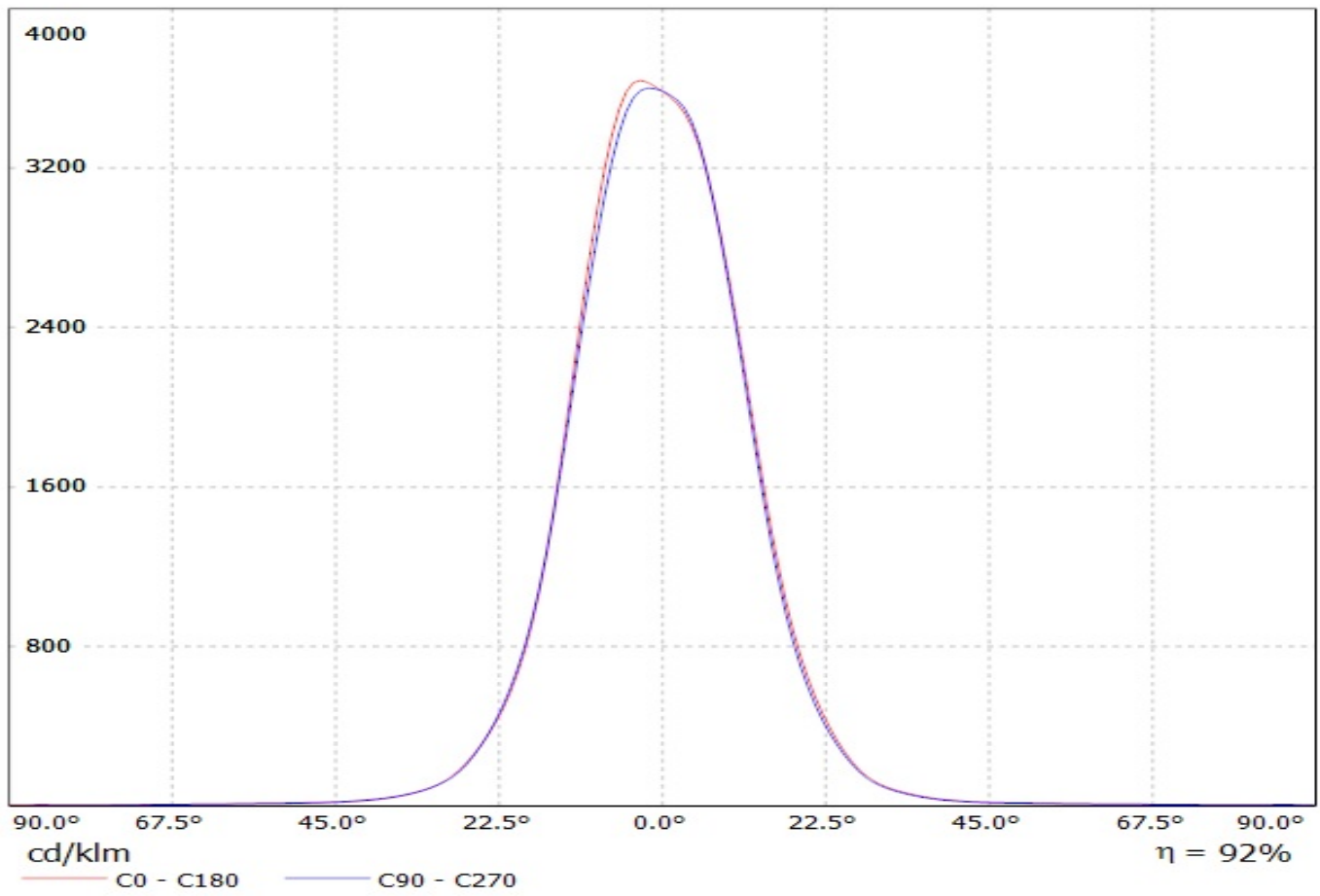

Luminaire: LEDiL Oy CA14461_VERONICA-SQ-M_(Luxeon_T)

Lamps: 1 x Philips_Lumileds_Luxeon_T_(LXH8-FW30-3)_72.2743lm@250mA_P=0.734231W_I=0.2499A

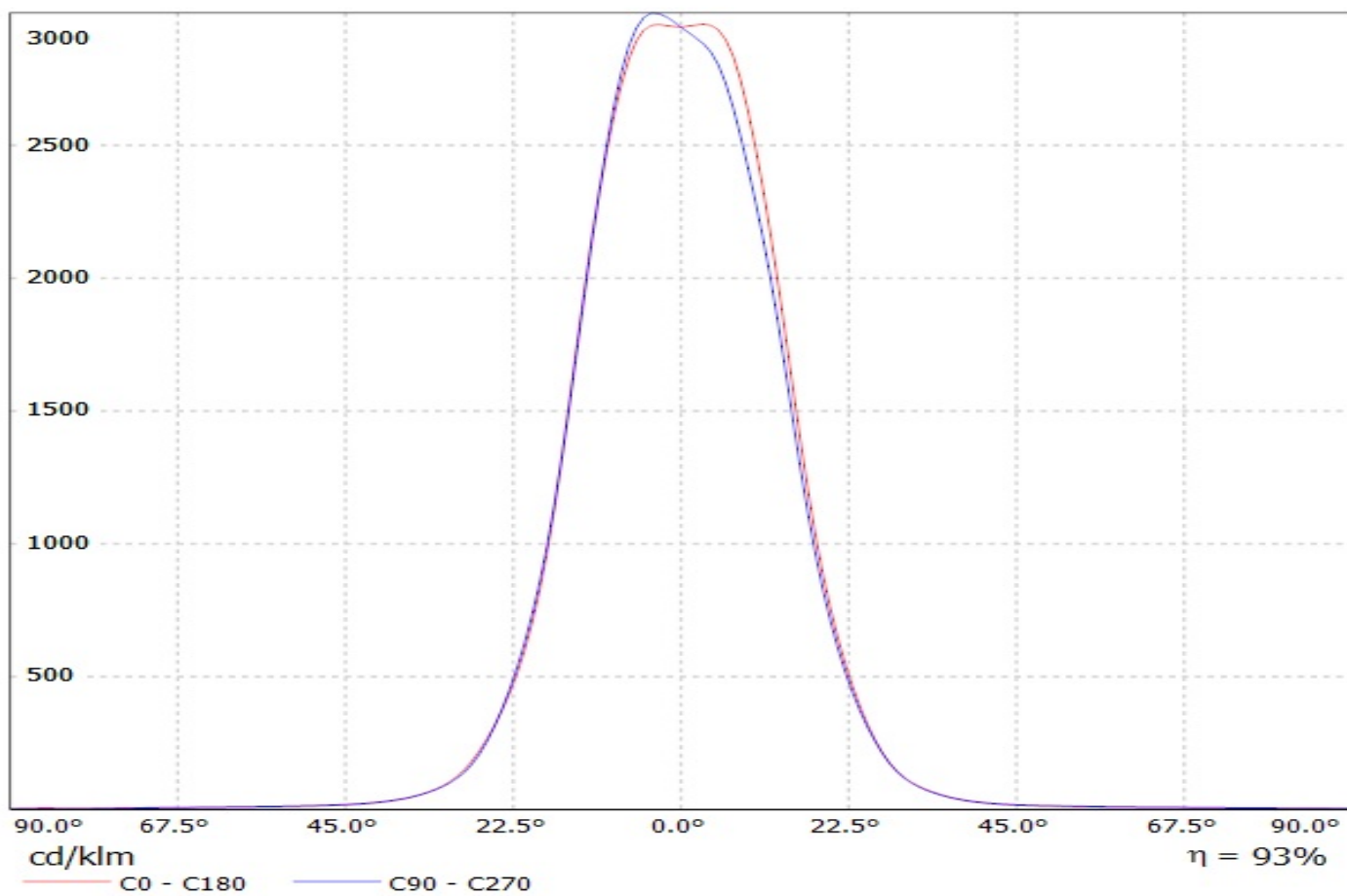

Luminaire: LEDiL Oy CA14461_VERONICA-SQ-M_(Luxeon_TX)

Lamps: 1 x Philips_Lumileds_Luxeon_TX_(L1T2-3585)_80.8039lm@250mA_CCT=3554K_P=0.740679W_I=0.2499A

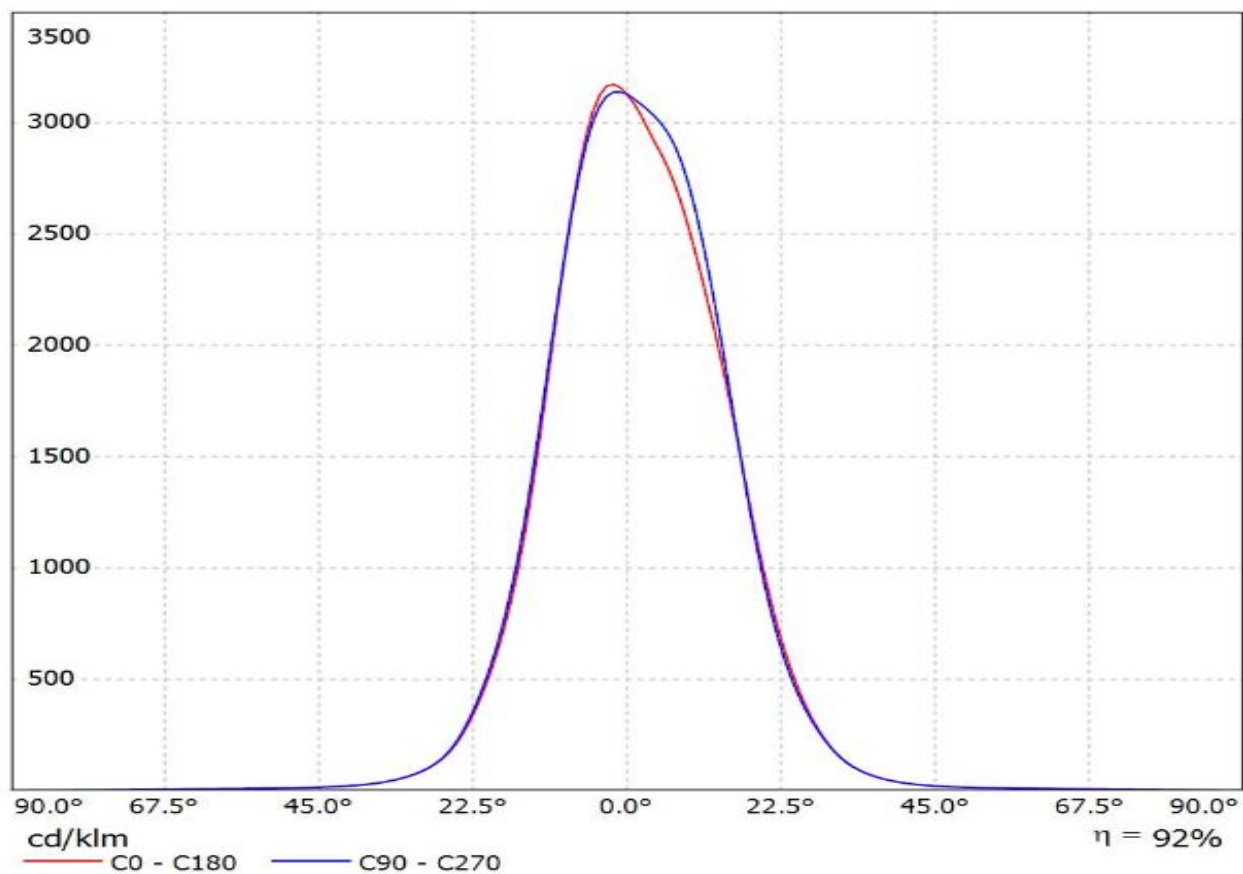

Luminaire: LEDiL Oy CA14461_VERONICA-SQ-M_(Luxeon_Rebel_ES)

Lamps: 1 x Philips_Lumileds_Luxeon_Rebel_ES_(LXML-PWC2)_89.4472lm@250mA_P=0.746101W_I=0.2499A

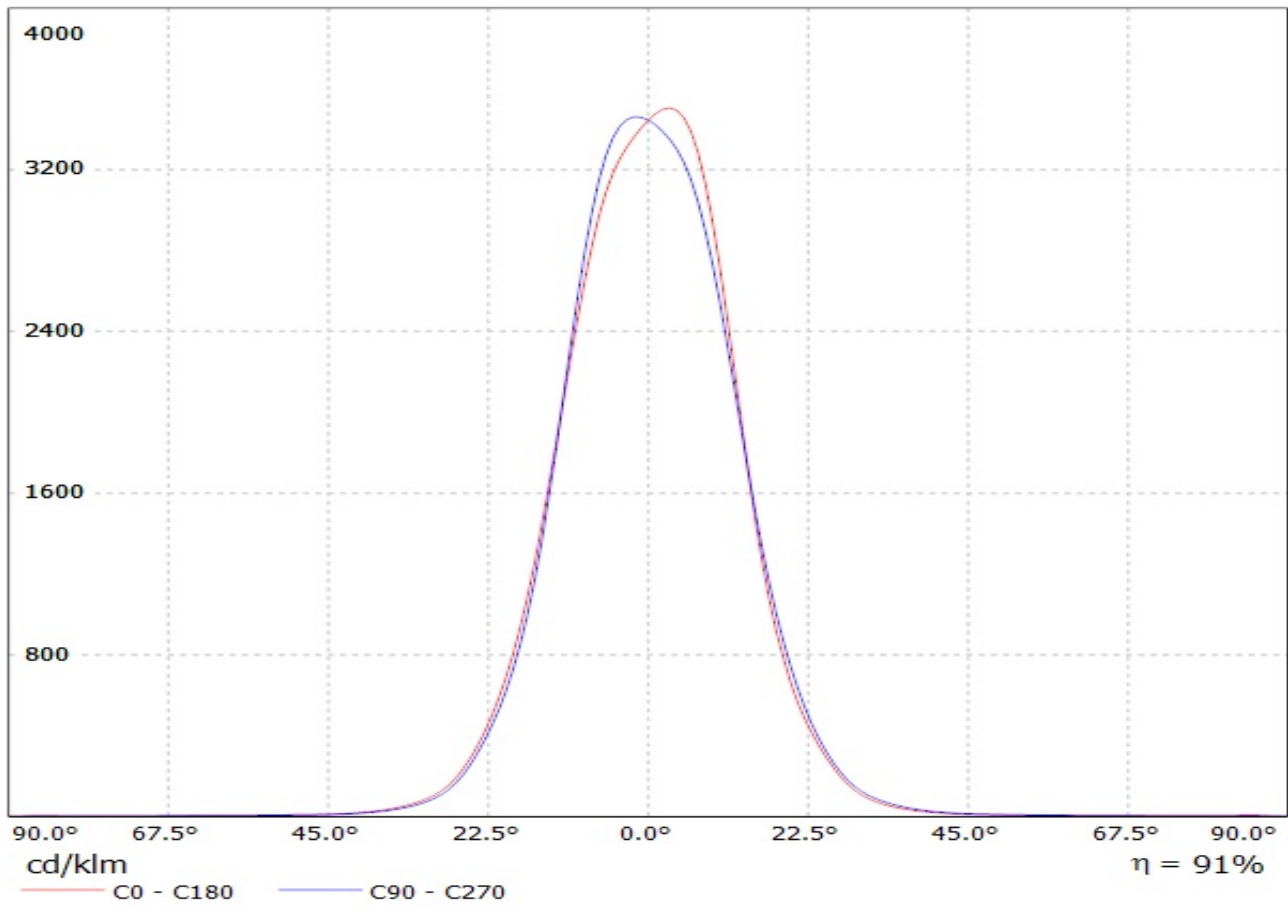

Luminaire: LEDiL Oy CA14461_VERONICA-SQ-M_(Luxeon_A)

Lamps: 1 x Philips_Lumileds_Luxeon_A_(LXH8-PW30)_65.8365lm@250mA_P=0.727284W_I=0.2499A

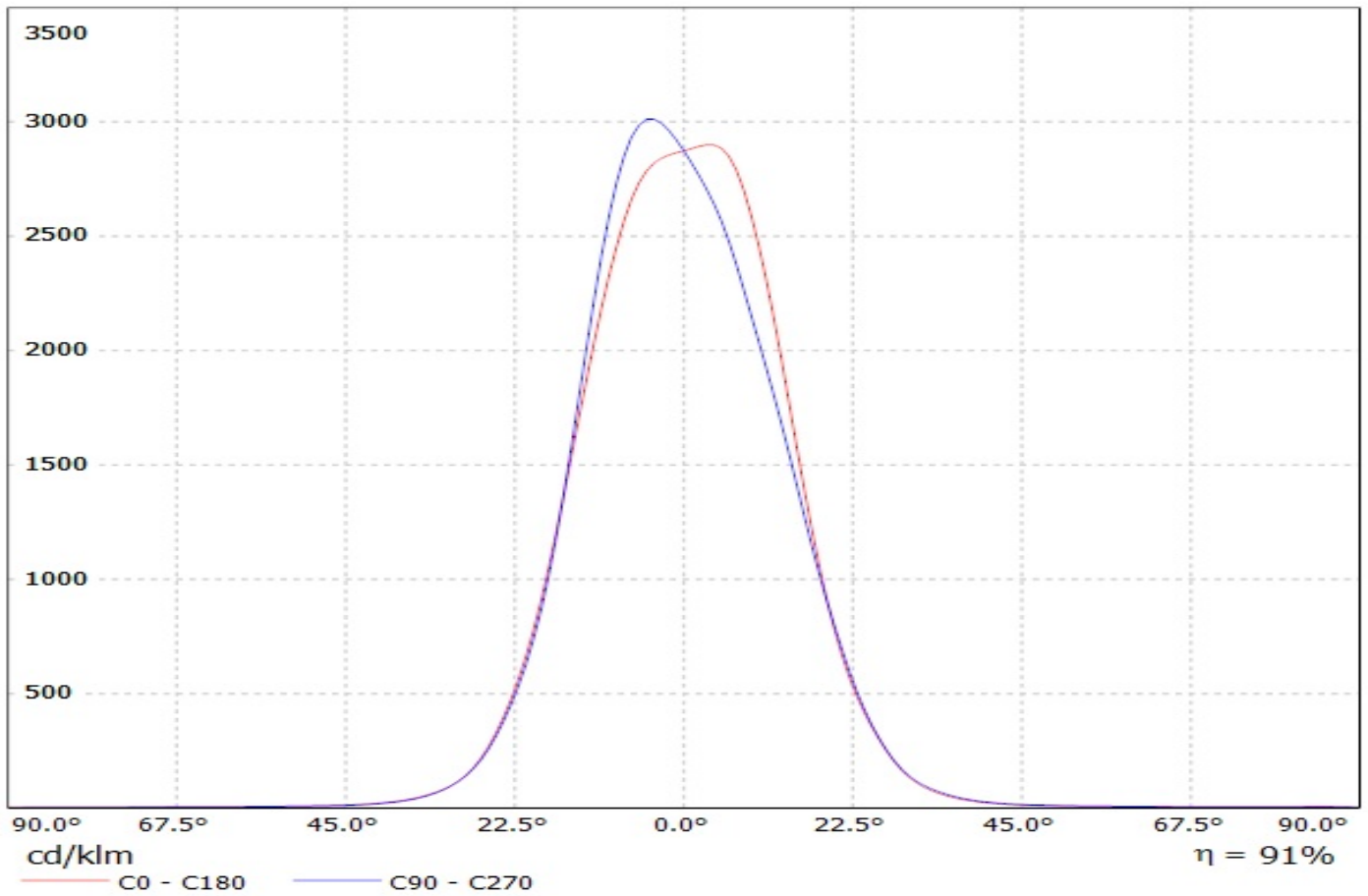

Luminaire: LEDiL Oy CA14461_VERONICA-SQ-M_(Nichia_NVsxx19B)
Lamps: 1 x Nichia_NVsxx19B_105.826lm@250mA_P=0.731182W_I=250mA

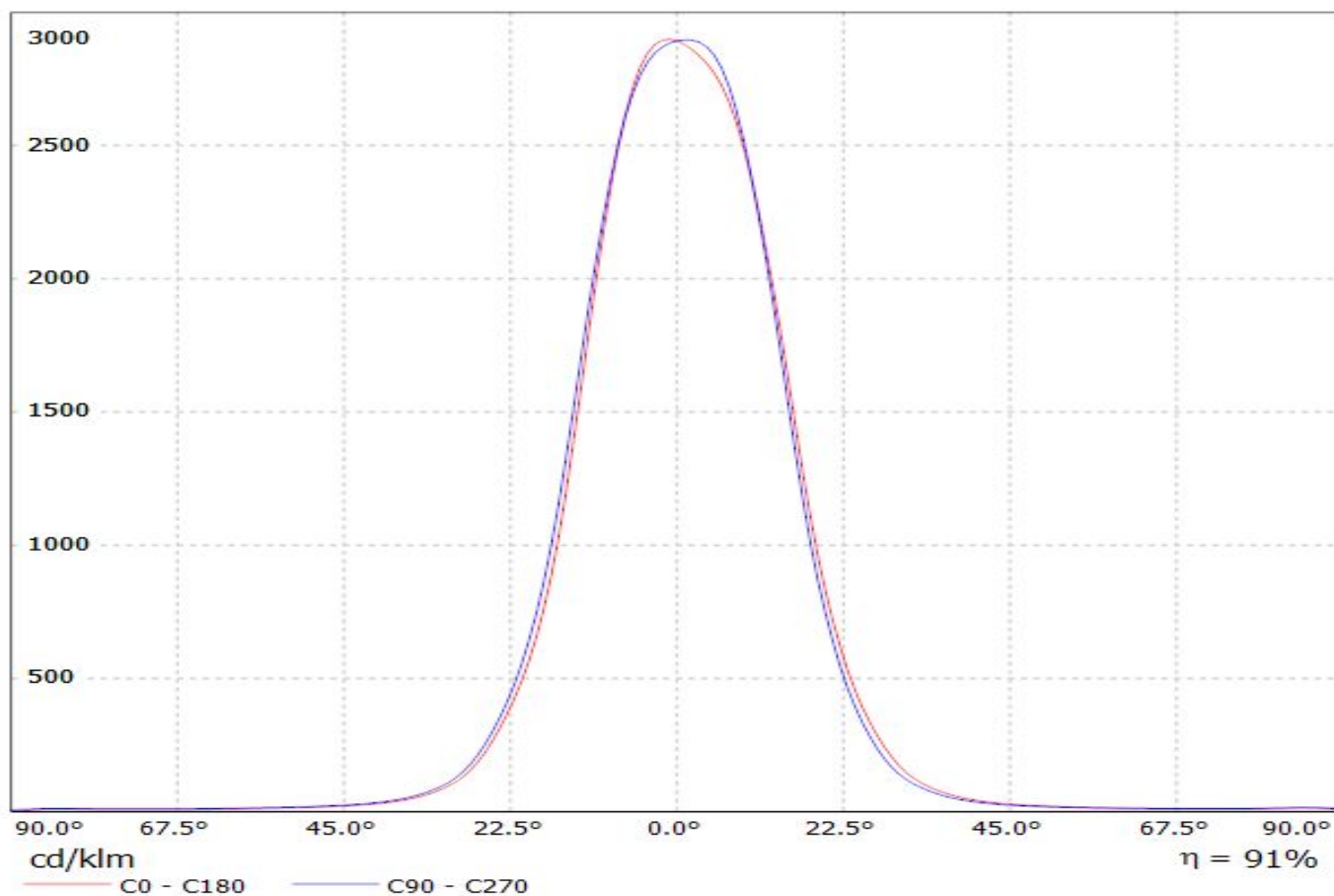

Luminaire: LEDiL Oy CA14461_VERONICA-SQ-M_(Nichia_NCSxx19B)
Lamps: 1 x Nichia_NCSxx19B_90.3281lm@250mA_P=0.795931W_I=250mA

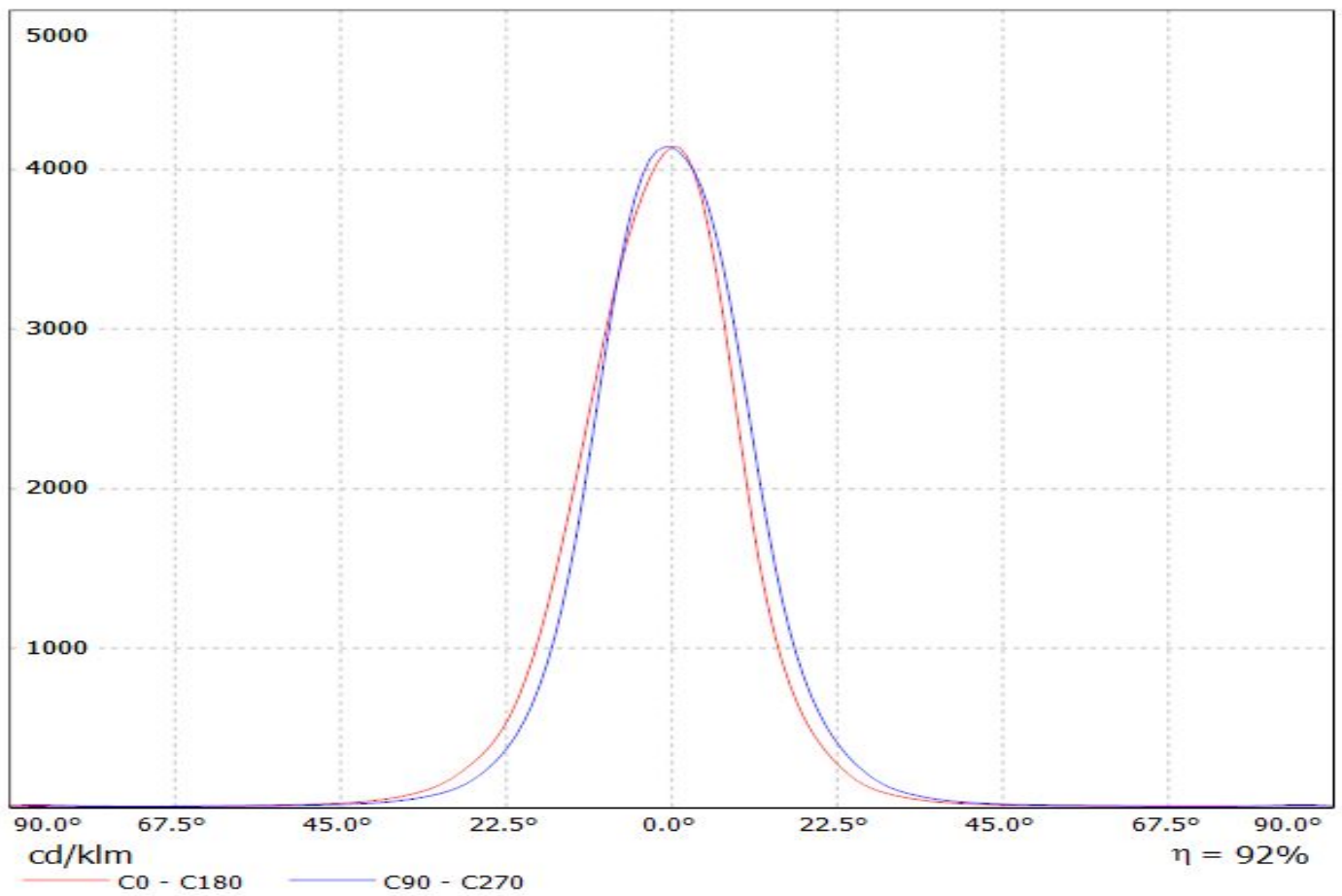

Luminaire: LEDiL Oy CA14442_VERONICA-SQ-W_(NWSL229AE)

Lamps: 1 x Nichia_NWSL229AE_120.54lm@250mA_P=0.7128W_I=0.250A

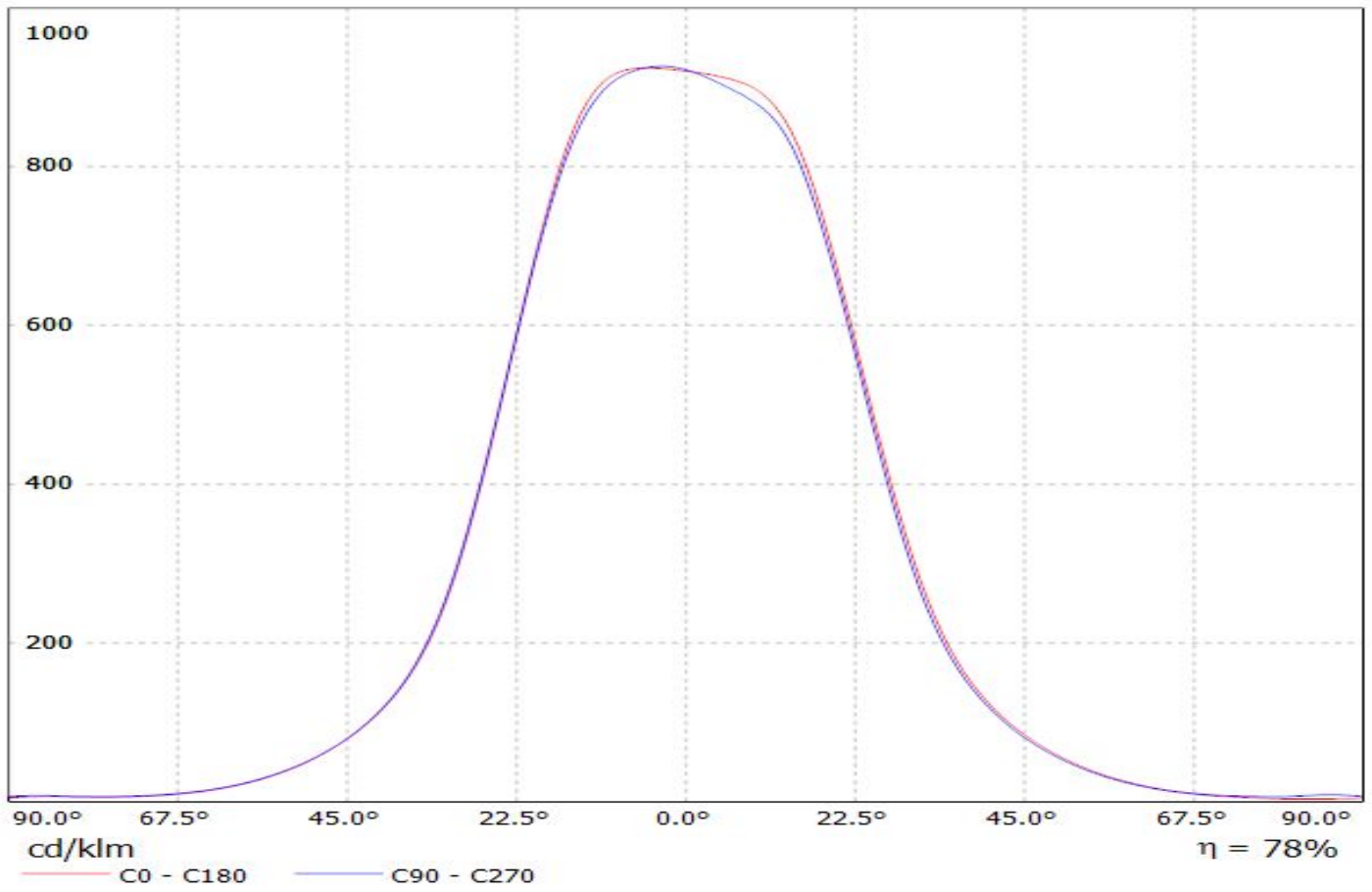

Luminaire: LEDiL Oy CA14461_VERONICA-SQ-M (Oslon_Square_PC)

Lamps: 1 x Osram_Oslon_Square-PC_(LCW_CQAR.PL-MSMV-5H71-1)_99.714lm@250mA_P=0.770717W_I=0.2499A

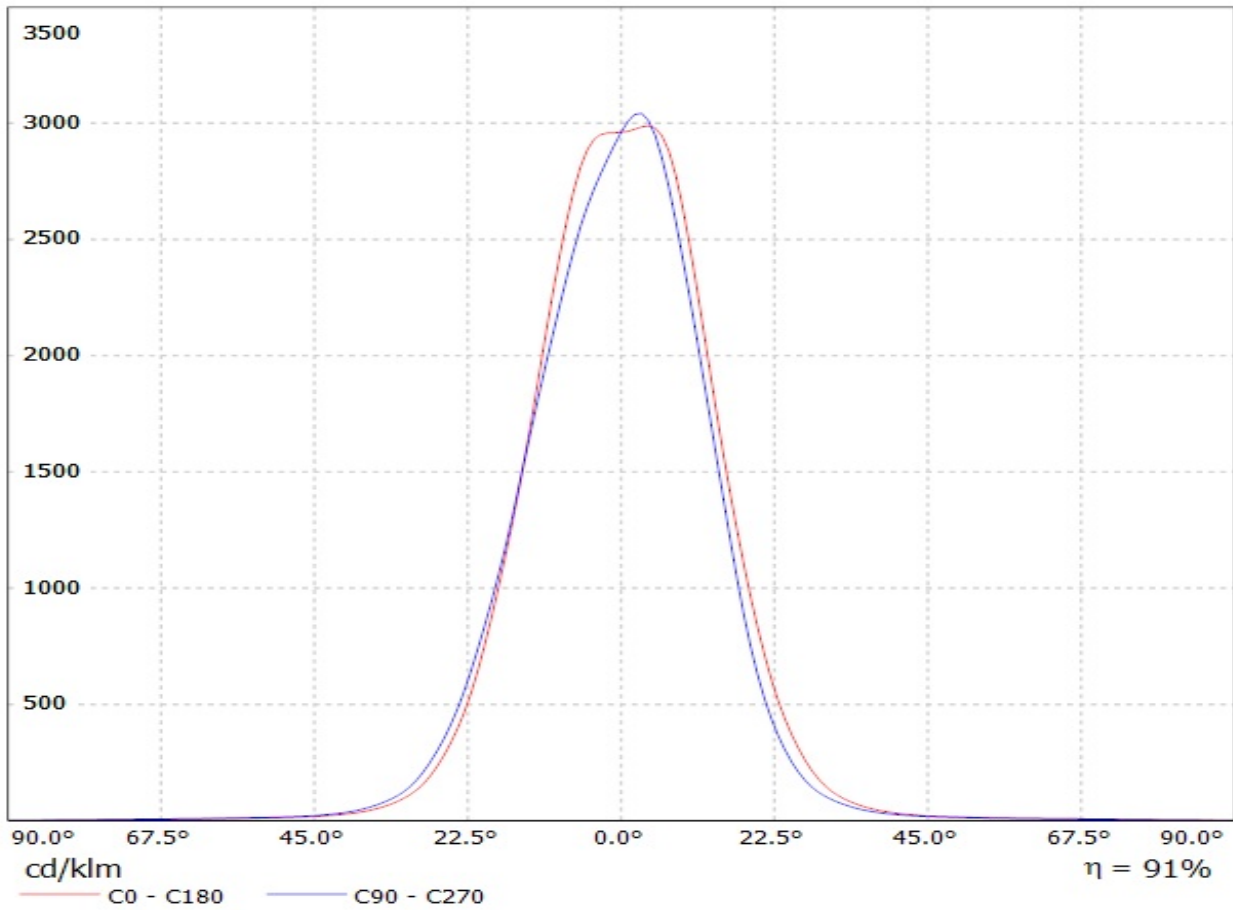

Luminaire: LEDiL Oy CA14461_VERONICA-SQ-M_(Oslon_Square_EC)

Lamps: 1 x Osram_Oslon_Square_EC_(GW_CSSRM1.EC)_85.3477lm@250mA_P=0.738904W_I=0.2499A

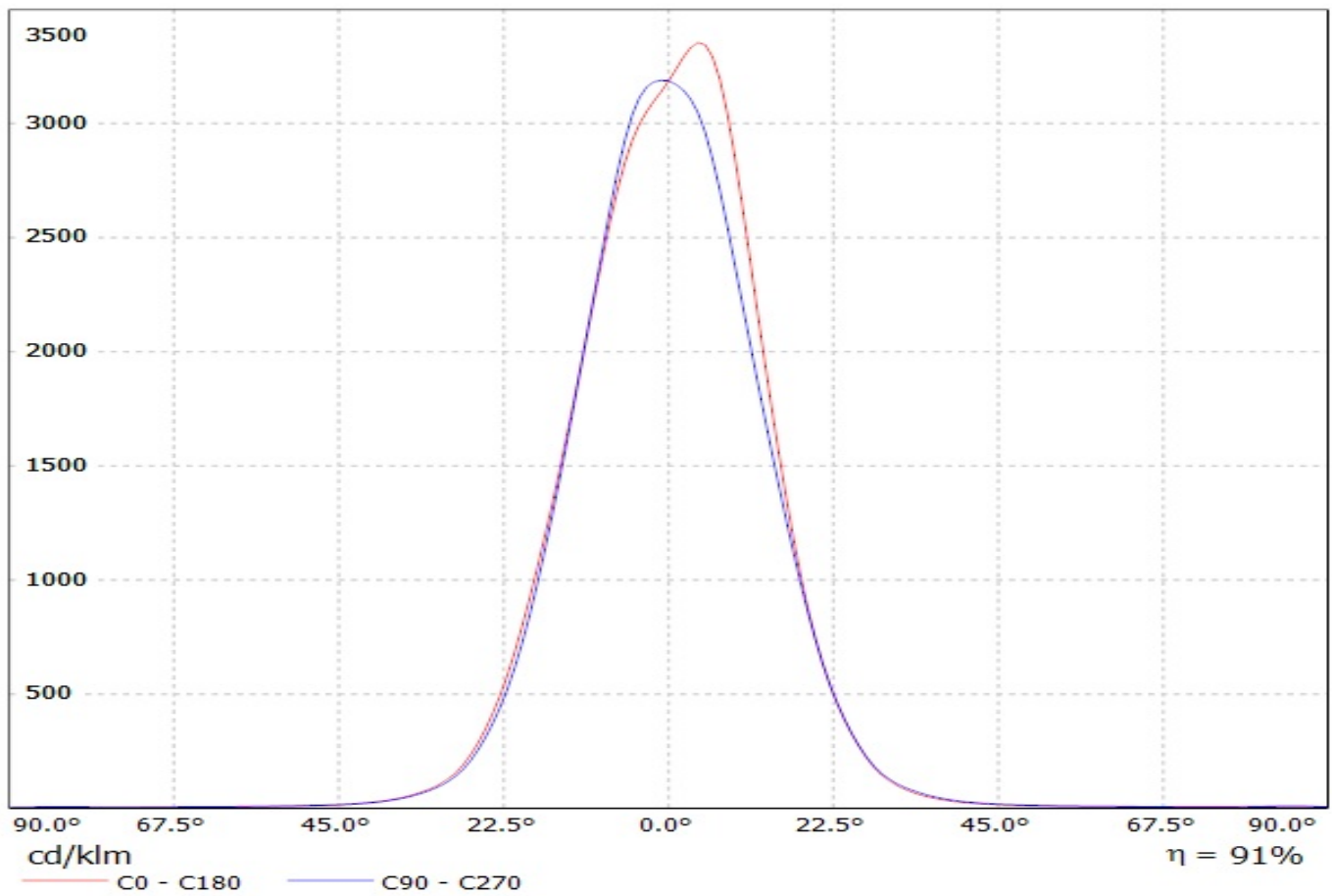

Luminaire: LEDiL Oy CA14461_VERONICA-SQ-M_(Z8Y22plus)

Lamps: 1 x Seoul_Z8Y22plus_(W6E2G)_125.652lm@250mA_P=0.69312W_I=0.250A

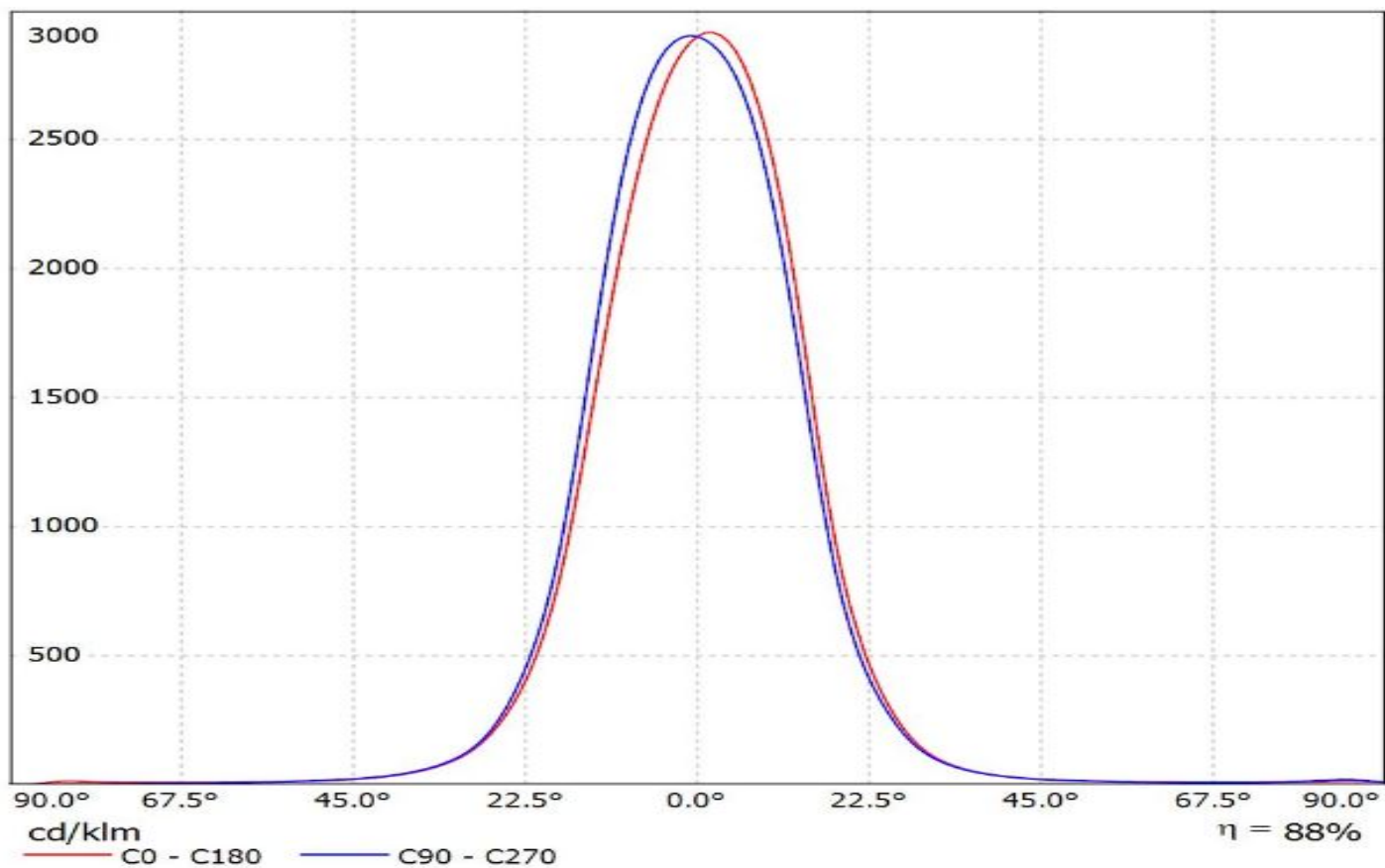

Luminaire: LEDiL Oy CA14461_VERONICA-SQ-M_(XP-L)

Lamps: 1 x Cree_XP-L_(XPLAWT-0-7A3-U50-0H-0001)_102.988lm@250mA_P=0.724035W_I=0.2499A

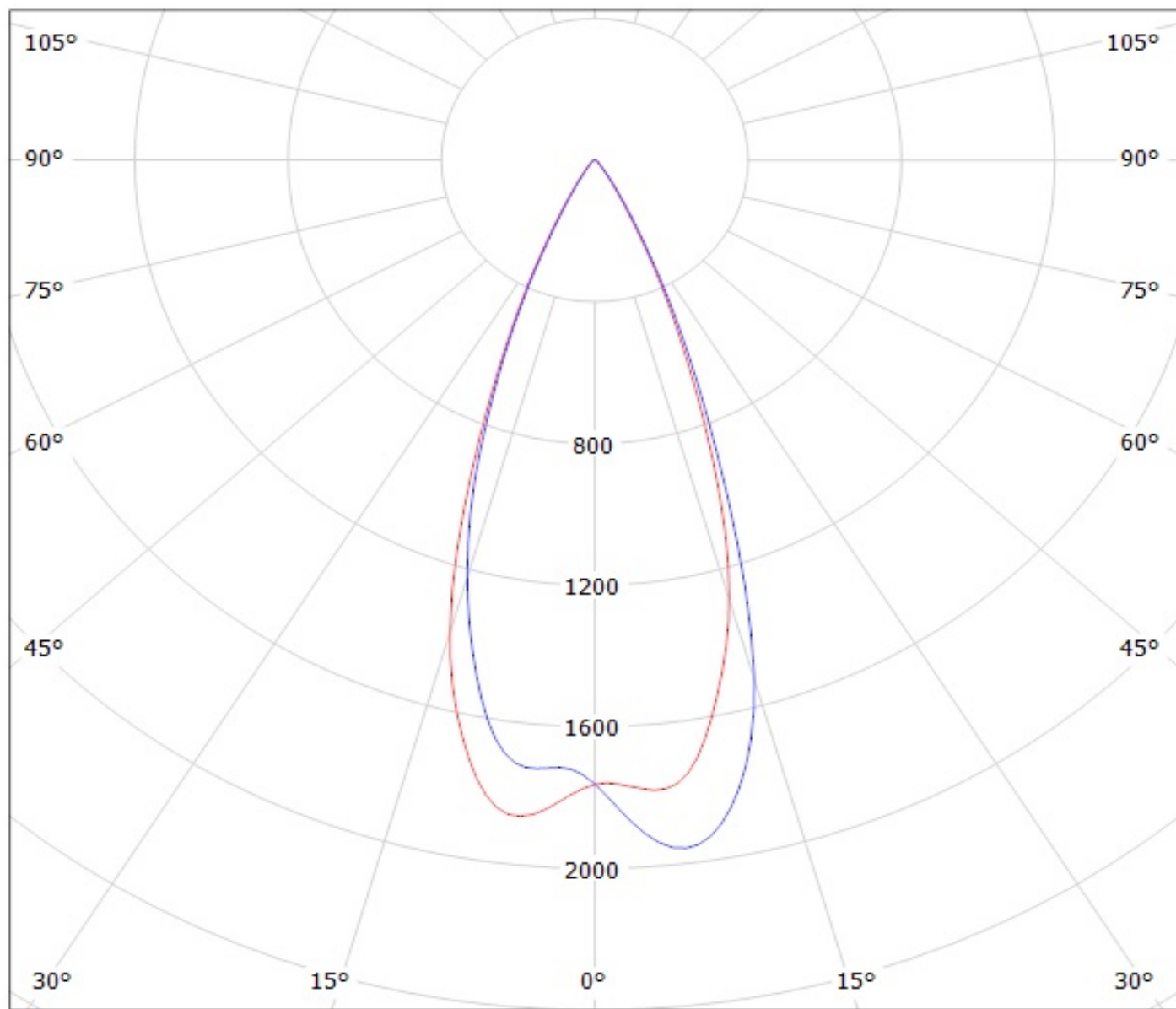

cd/klm

— C0 - C180 — C90 - C270

$\eta = 91\%$

Luminaire: LEDiL Oy CA14461_VERONICA-SQ-M_(Cree_XM-L)
Lamps: 1 x Cree_XM-L_90.3992lm@250mA_P=0.735056W_I=250mA

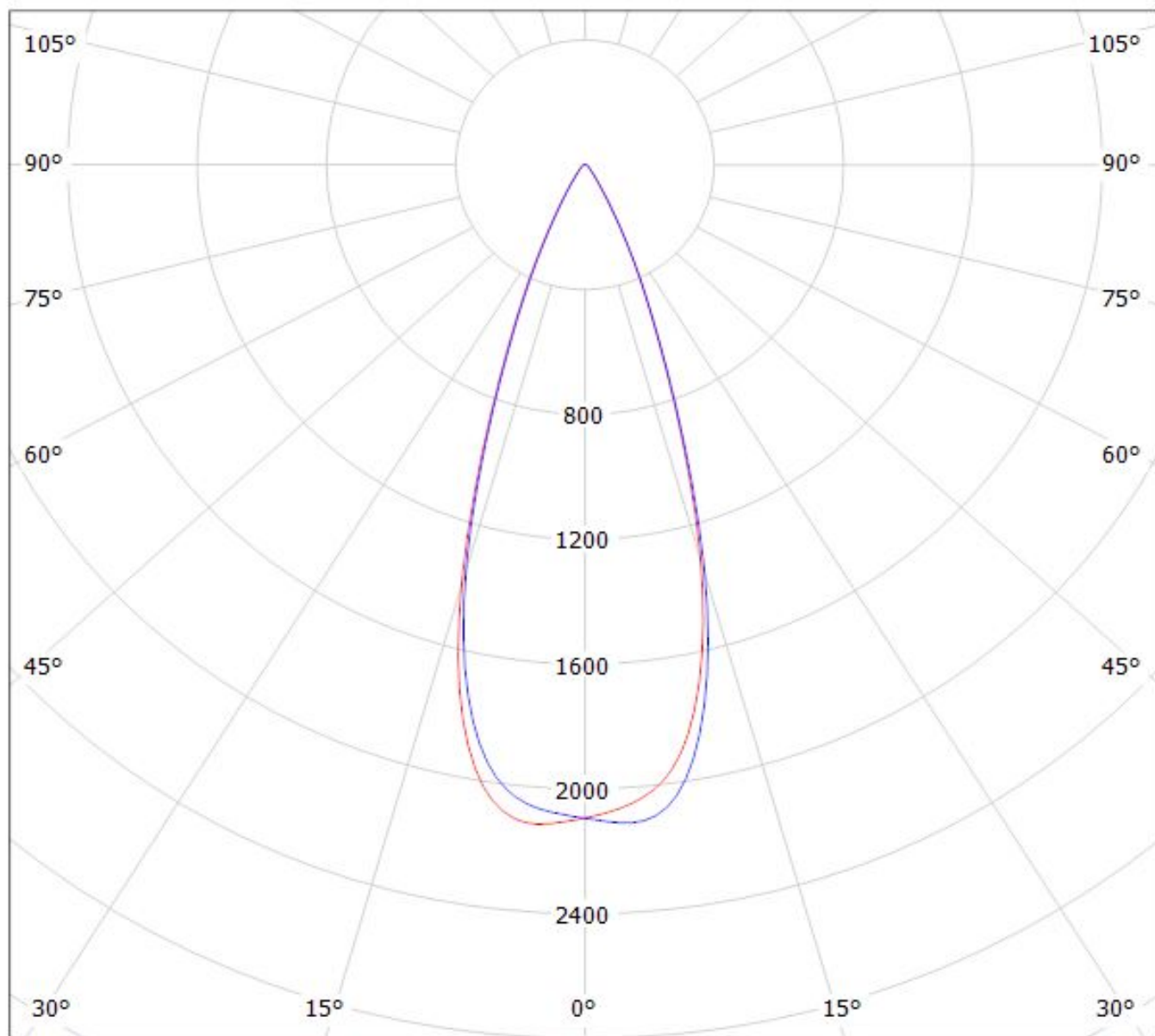

cd/klm

$\eta = 92\%$

— C0 - C180 — C90 - C270

Luminaire: LEDiL Oy CA14461_VERONICA-SQ-M_(Cree_XP-E2)
Lamps: 1 x Cree_XP-E2_79.5831lm@250mA_P=0.754073W_I=250mA

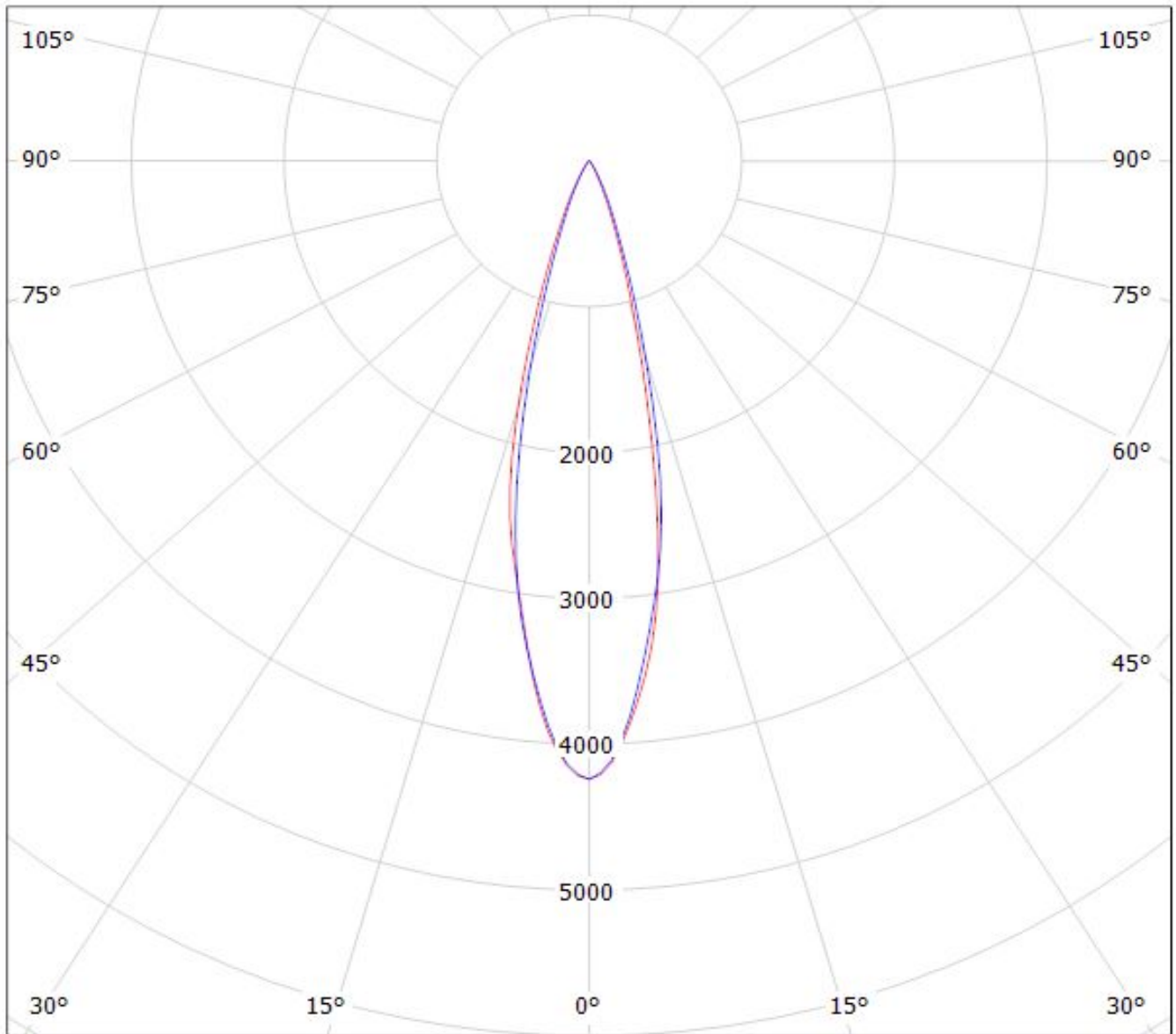

$\eta = 94\%$

cd/klm
— C0 - C180 — C90 - C270

Luminaire: LEDiL Oy CA14461_VERONICA-SQ-M_(XP-E)

Lamps: 1 x Cree_XP-E_(XPEWHT-L1-3C0-Q5-0-06)_78.0735lm@250mA_P=0.803378W_I=0.2499A

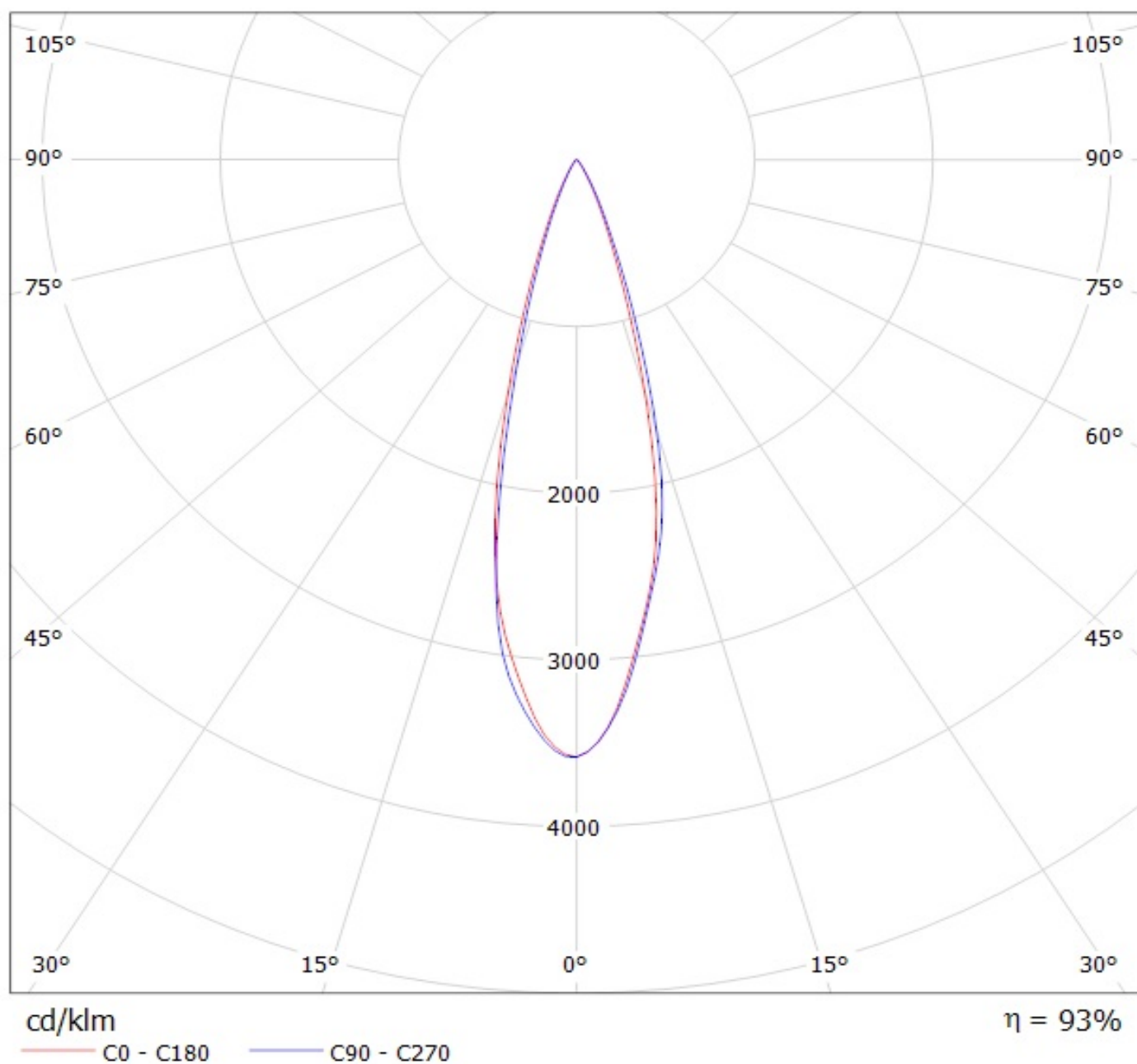

Luminaire: LEDiL Oy CA14461_VERONICA-SQ-M_(XM-L2)

Lamps: 1 x Cree_XM-L2_(XMLBWT-0-7B4-T30-0L-0001)_95.1239lm@250mA_P=0.734831W_I=0.2499A

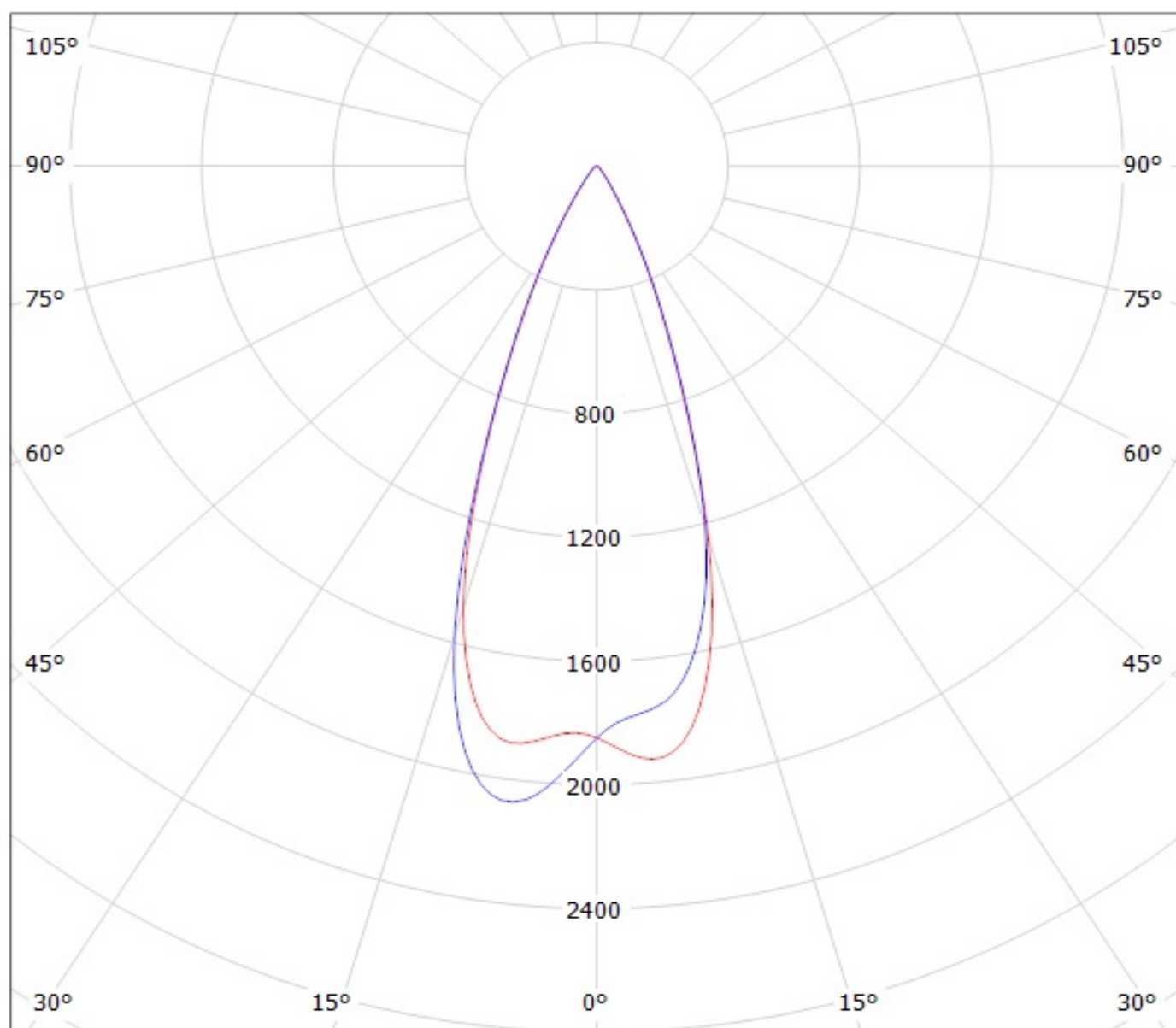

cd/klm

— C0 - C180 — C90 - C270

$\eta = 91\%$

Luminaire: LEDiL Oy CA14461_VERONICA-SQ-M_(XB-H)

Lamps: 1 x Cree_XB-H_(XBHAWT-0-7C1-T30-0H-0001)_97.2452lm@250mA_P=0.755198W_I=0.2499A

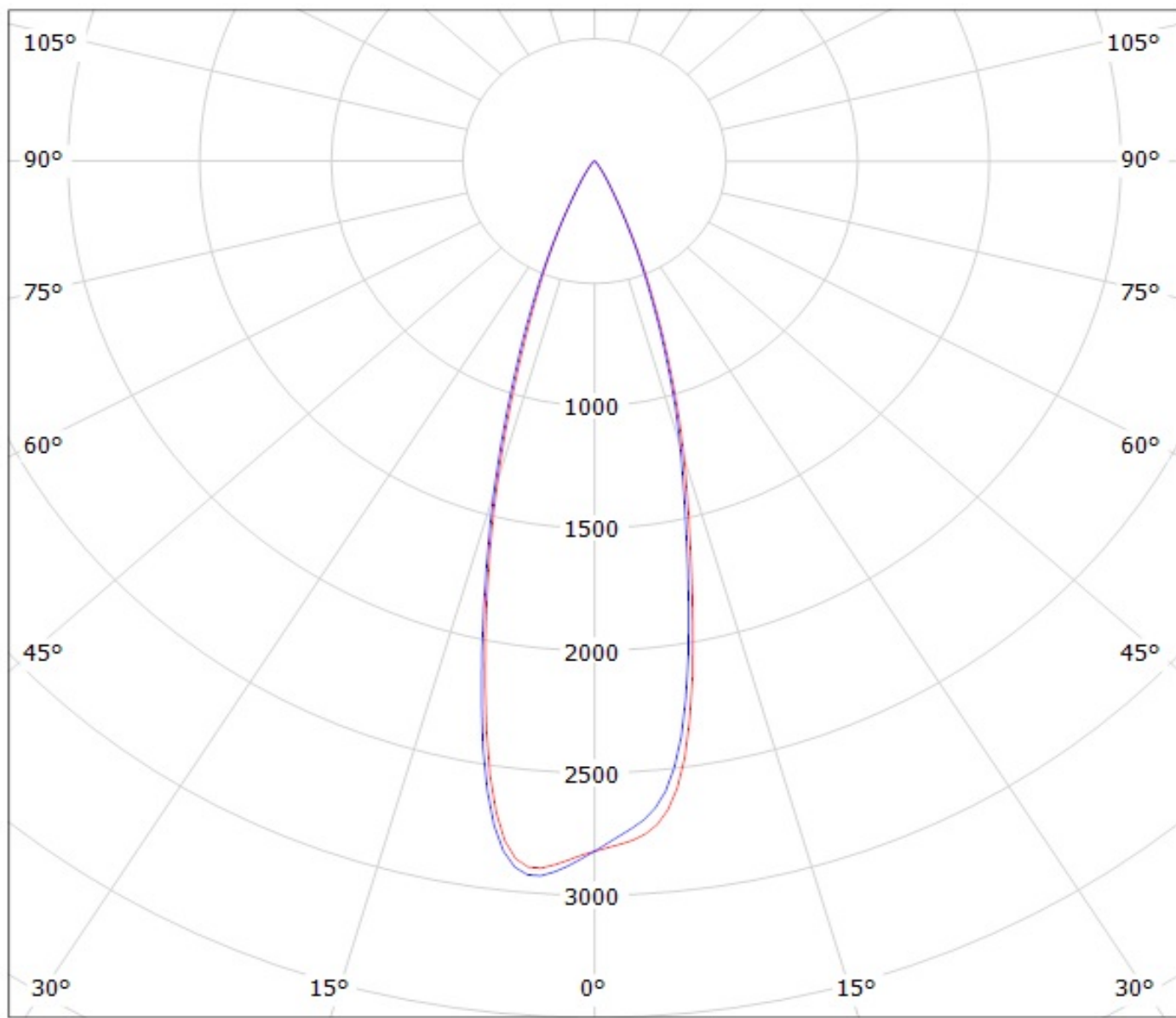

cd/klm

— C0 - C180

— C90 - C270

$\eta = 91\%$

Luminaire: Ledil CA14461_VERONICA-SQ-M (XP-L2)

Lamps: 1 x Cree_XP-L2 (XPLWT-00-0000-000HU630G)_115.868lm@250mA_P=0.717875W_I=0.25A

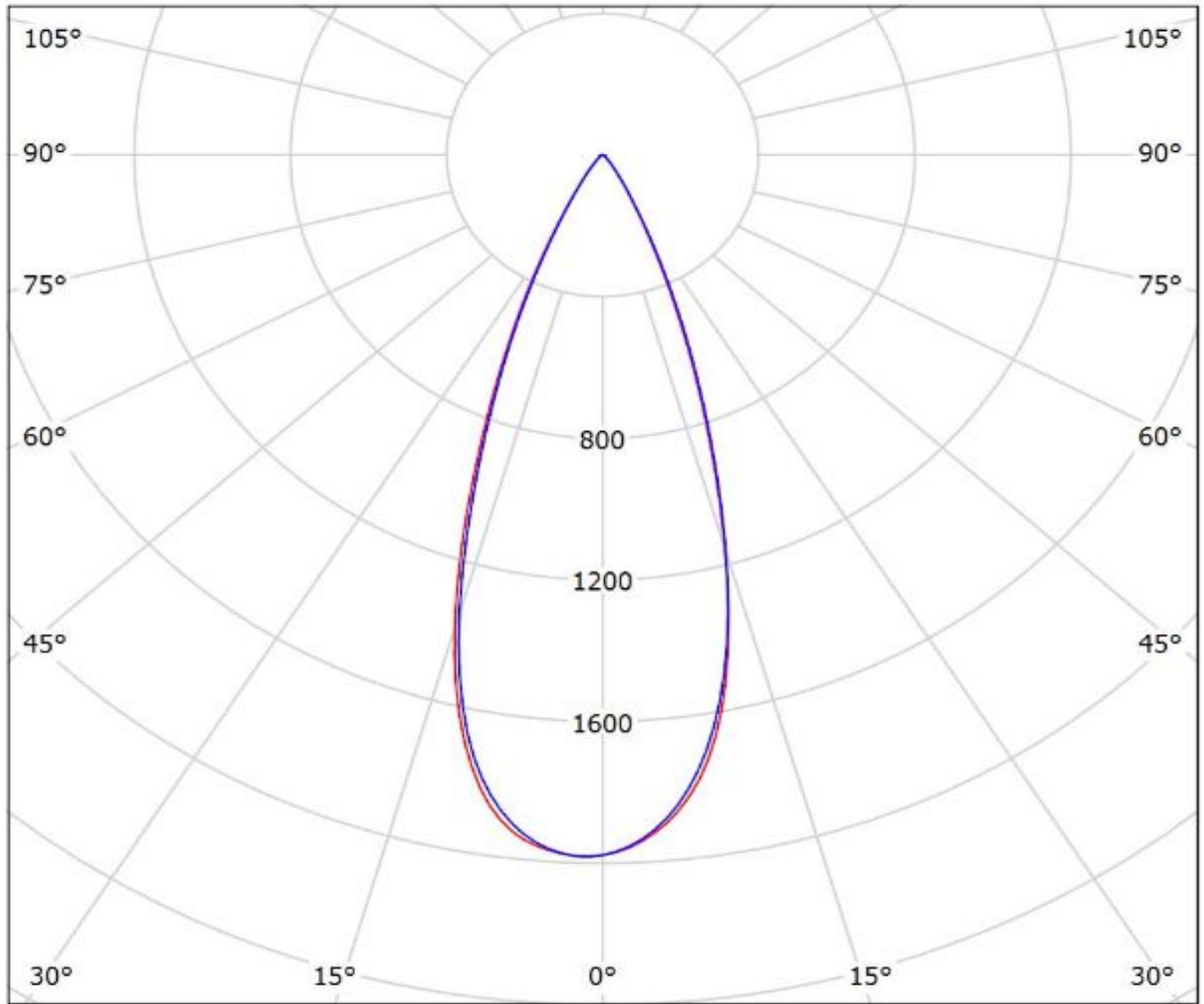

cd/klm

— C0 - C180 — C90 - C270

$\eta = 87\%$

Luminaire: LEDiL Oy CA14461_VERONICA-SQ-M_(H35C1)

Lamps: 1 x LG_H35C1_(PKG5700K)_116.036lm@250mA_CCT=6235K_P=0.757272W_I=0.2499A

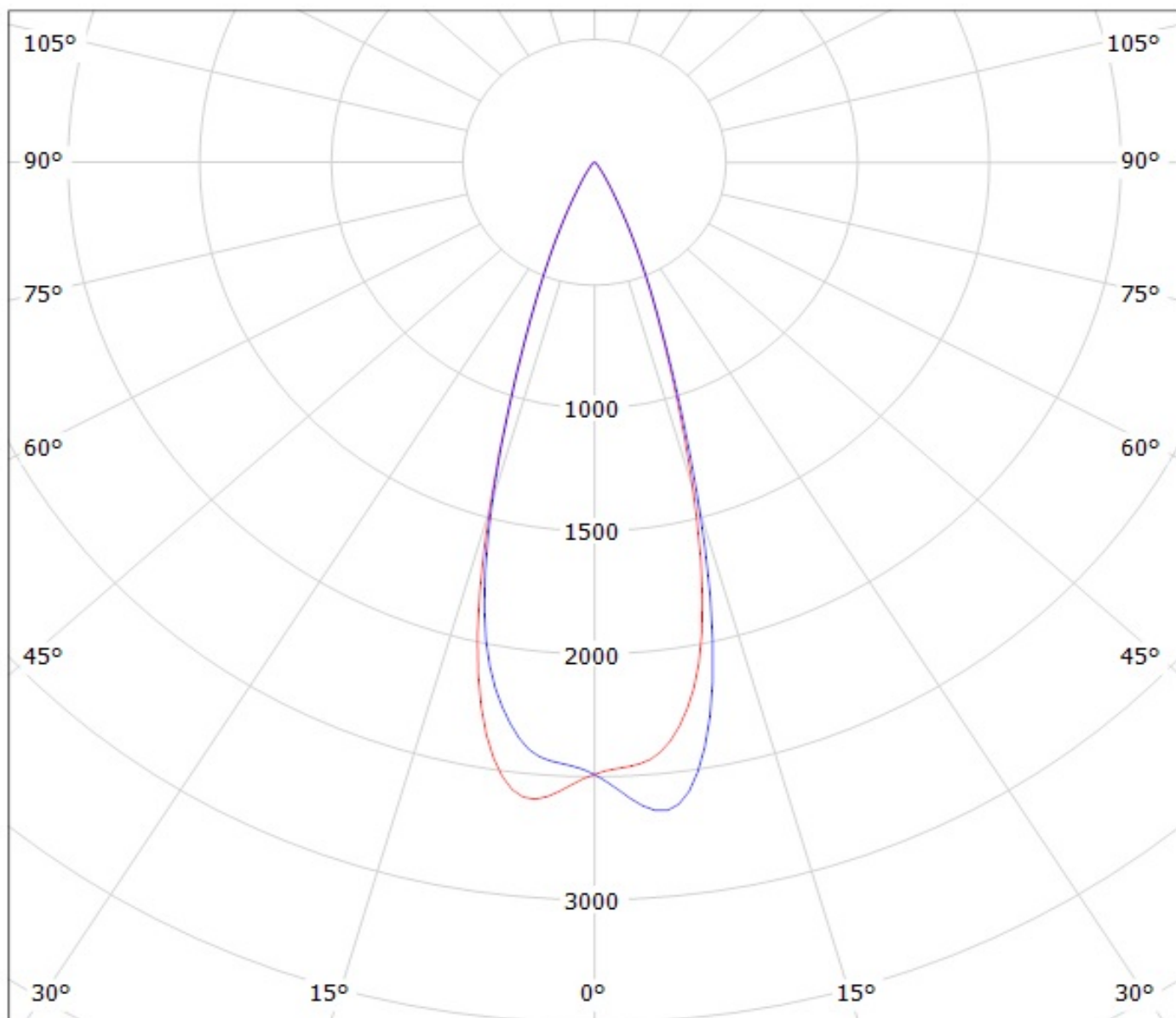

cd/klm

$\eta = 92\%$

— C0 - C180

— C90 - C270

Luminaire: LEDiL Oy CA14461_VERONICA-SQ-M_(Luxeon_MZ)

Lamps: 1 x Philips_Lumileds_Luxeon_MZ_386.758lm@250mA_P=2.77489W_I=0.2499A

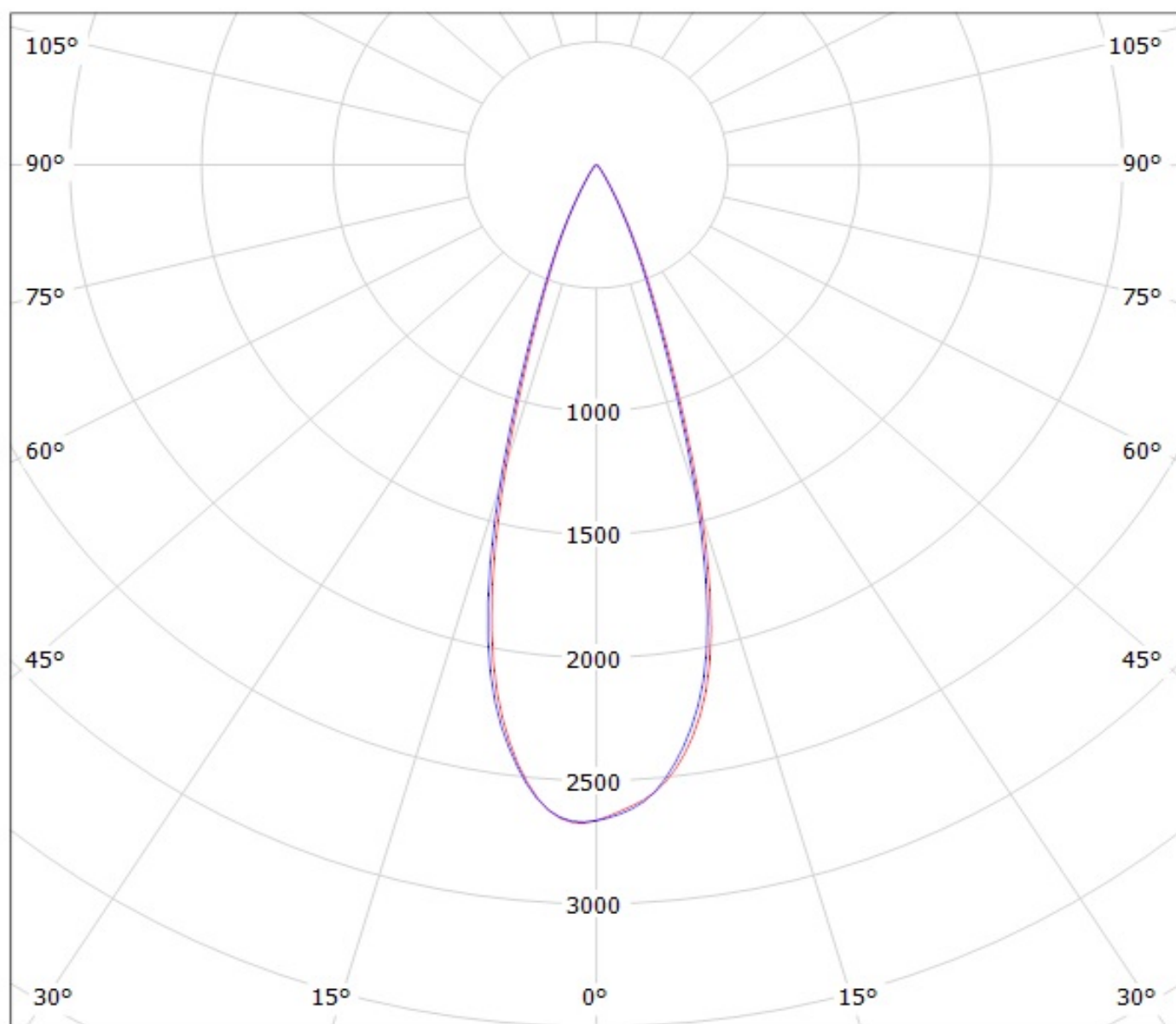

cd/klm

— C0 - C180

— C90 - C270

$\eta = 93\%$

Luminaire: LEDiL Oy CA14461_VERONICA-SQ-M_(Luxeon_R)

Lamps: 1 x Philips_Lumileds_Luxeon_R_(LXA7-PW30)_74.1293lm@250mA_CCT=3049K_P=0.727484W_I=0.2499A

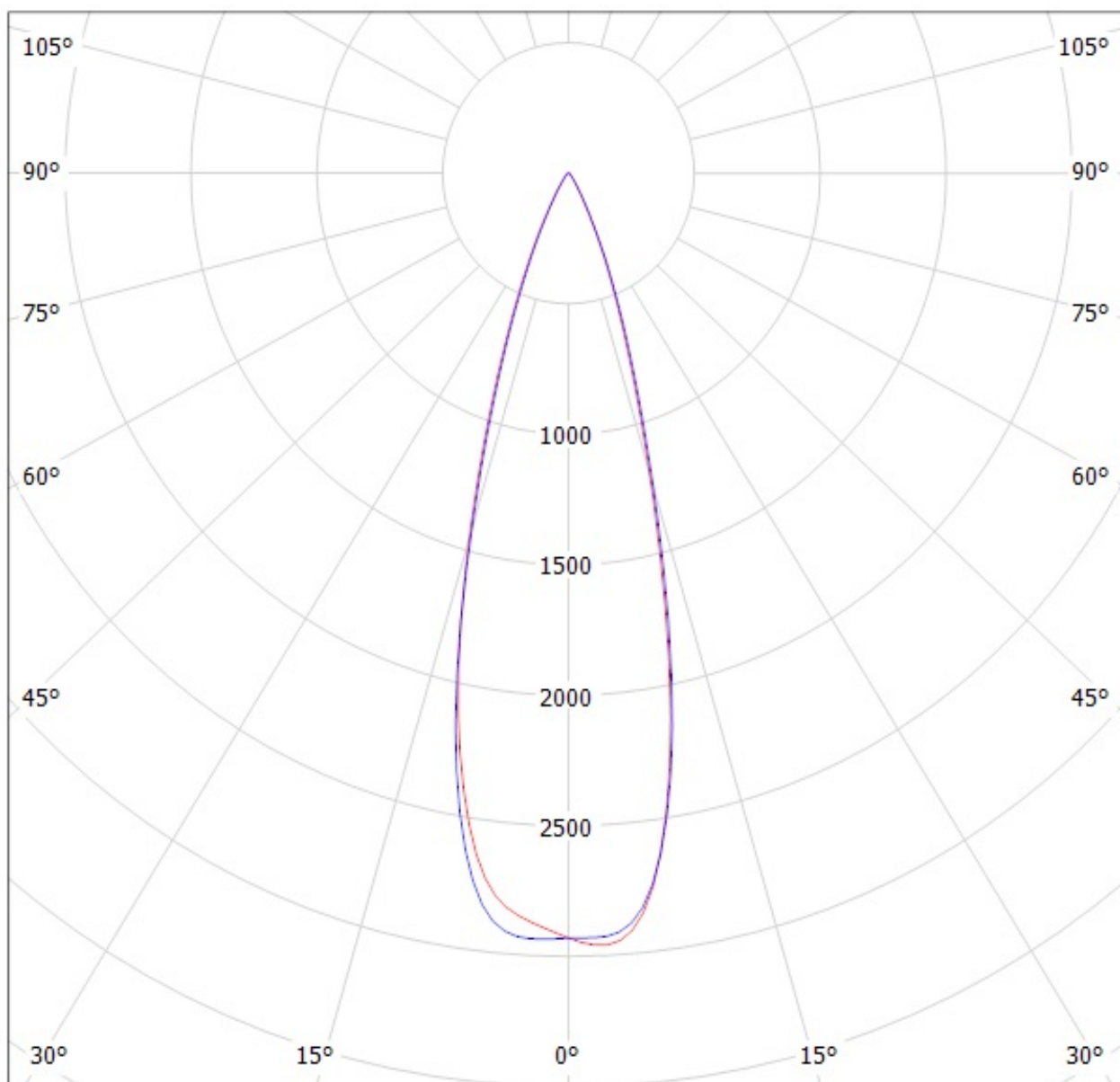

cd/klm

— C0 - C180

— C90 - C270

$\eta = 91\%$

Luminaire: LEDiL Oy CA14461_VERONICA-SQ-M_(Luxeon_Rebel)

Lamps: 1 x Philips_Lumileds_Luxeon_Rebel_(LXM8-PW30)_61.1293lm@250mA_P=0.728758W_I=0.2499A

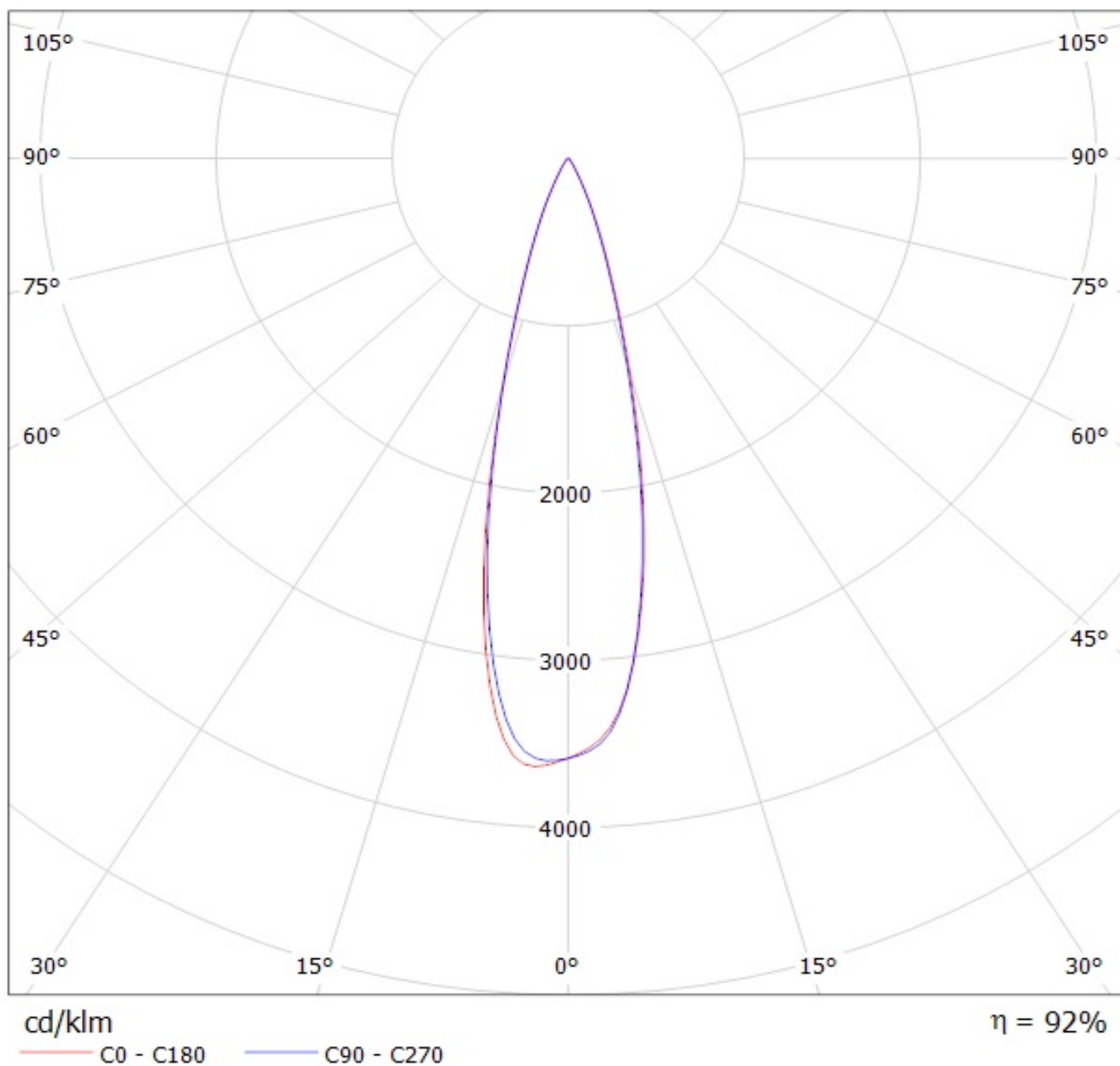

Luminaire: LEDiL Oy CA14461_VERONICA-SQ-M_(Luxeon_T)

Lamps: 1 x Philips_Lumileds_Luxeon_T_(LXH8-FW30-3)_72.2743lm@250mA_P=0.734231W_I=0.2499A

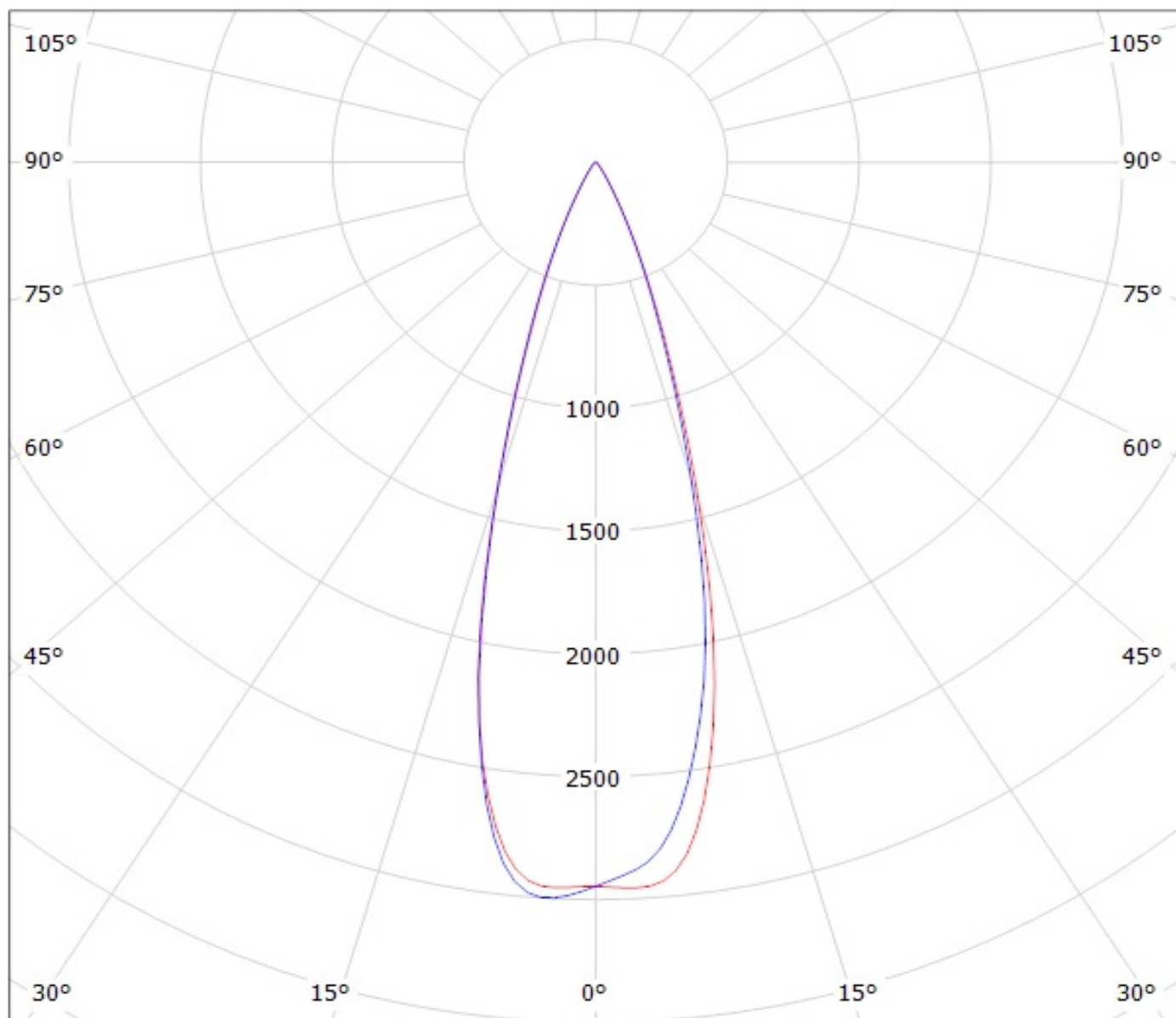

cd/klm

$\eta = 93\%$

— C0 - C180

— C90 - C270

Luminaire: LEDiL Oy CA14461_VERONICA-SQ-M_(Luxeon_TX)

Lamps: 1 x Philips_Lumileds_Luxeon_TX_(L1T2-3585)_80.8039lm@250mA_CCT=3554K_P=0.740679W_I=0.2499A

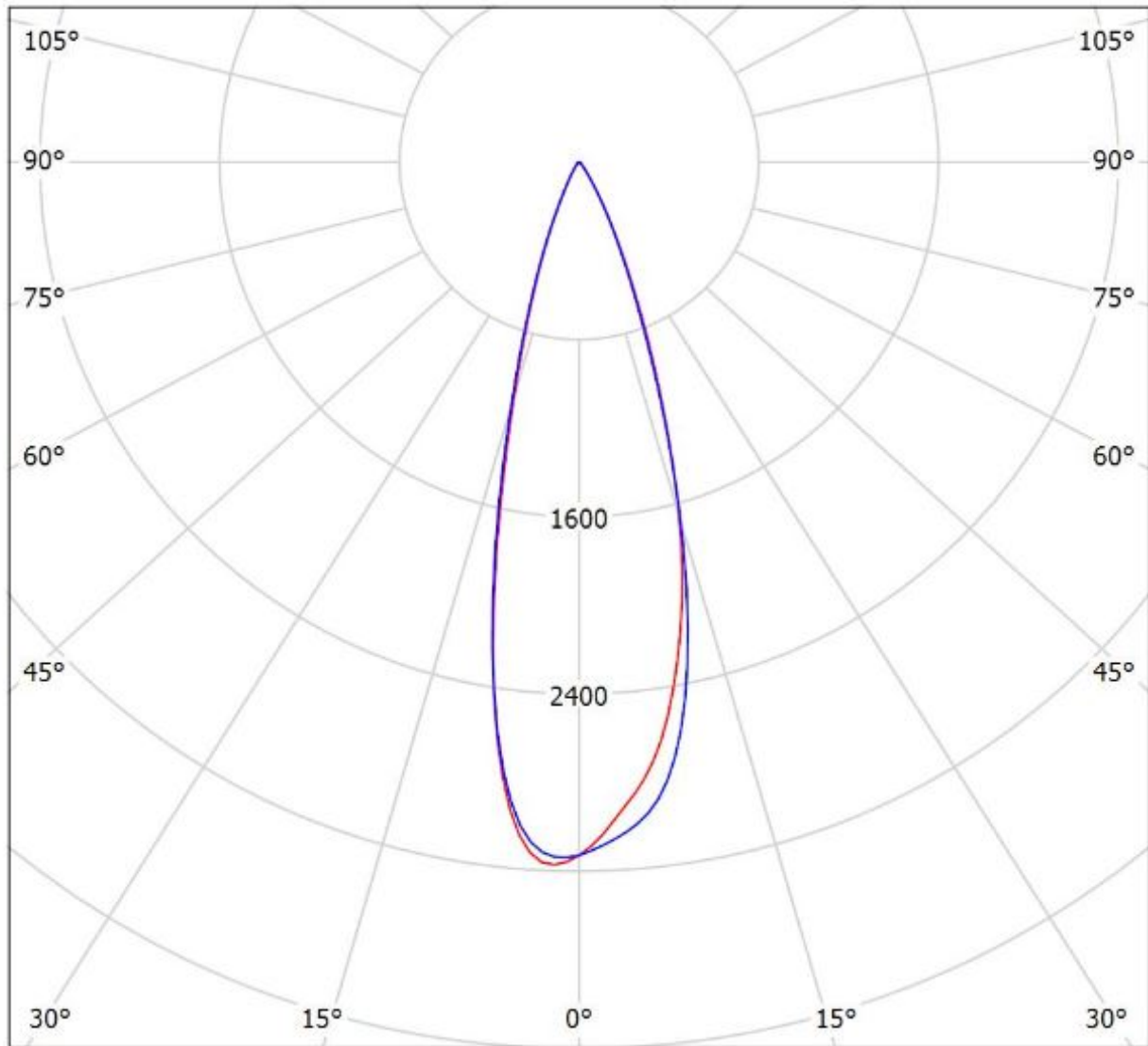

cd/klm

— C0 - C180 — C90 - C270

$\eta = 92\%$

Luminaire: LEDiL Oy CA14461_VERONICA-SQ-M_(Luxeon_Rebel_ES)

Lamps: 1 x Philips_Lumileds_Luxeon_Rebel_ES_(LXML-PWC2)_89.4472lm@250mA_P=0.746101W_I=0.2499A

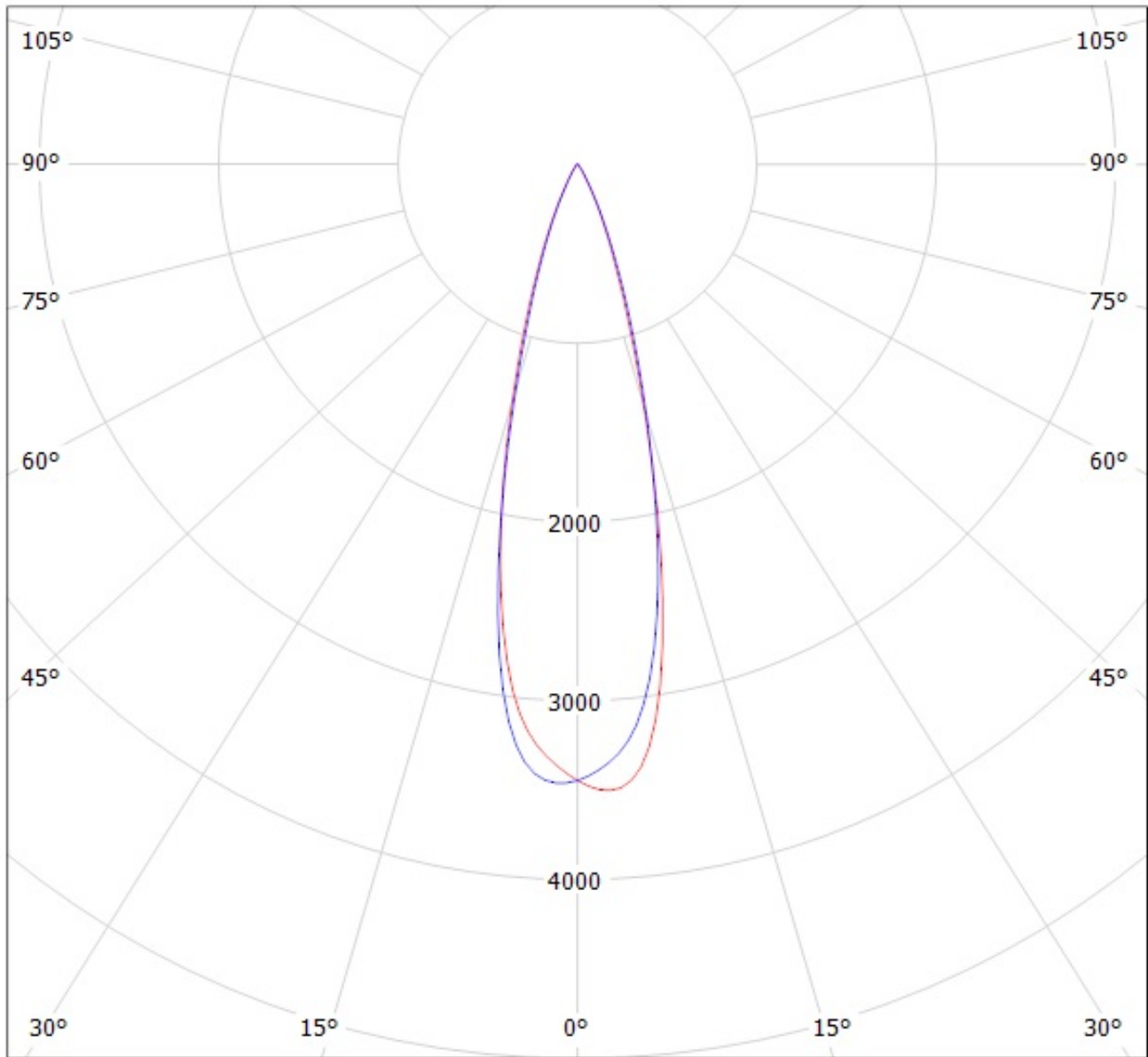

cd/klm

— C0 - C180

— C90 - C270

$\eta = 91\%$

Luminaire: LEDiL Oy CA14461_VERONICA-SQ-M_(Luxeon_A)

Lamps: 1 x Philips_Lumileds_Luxeon_A_(LXH8-PW30)_65.8365lm@250mA_P=0.727284W_I=0.2499A

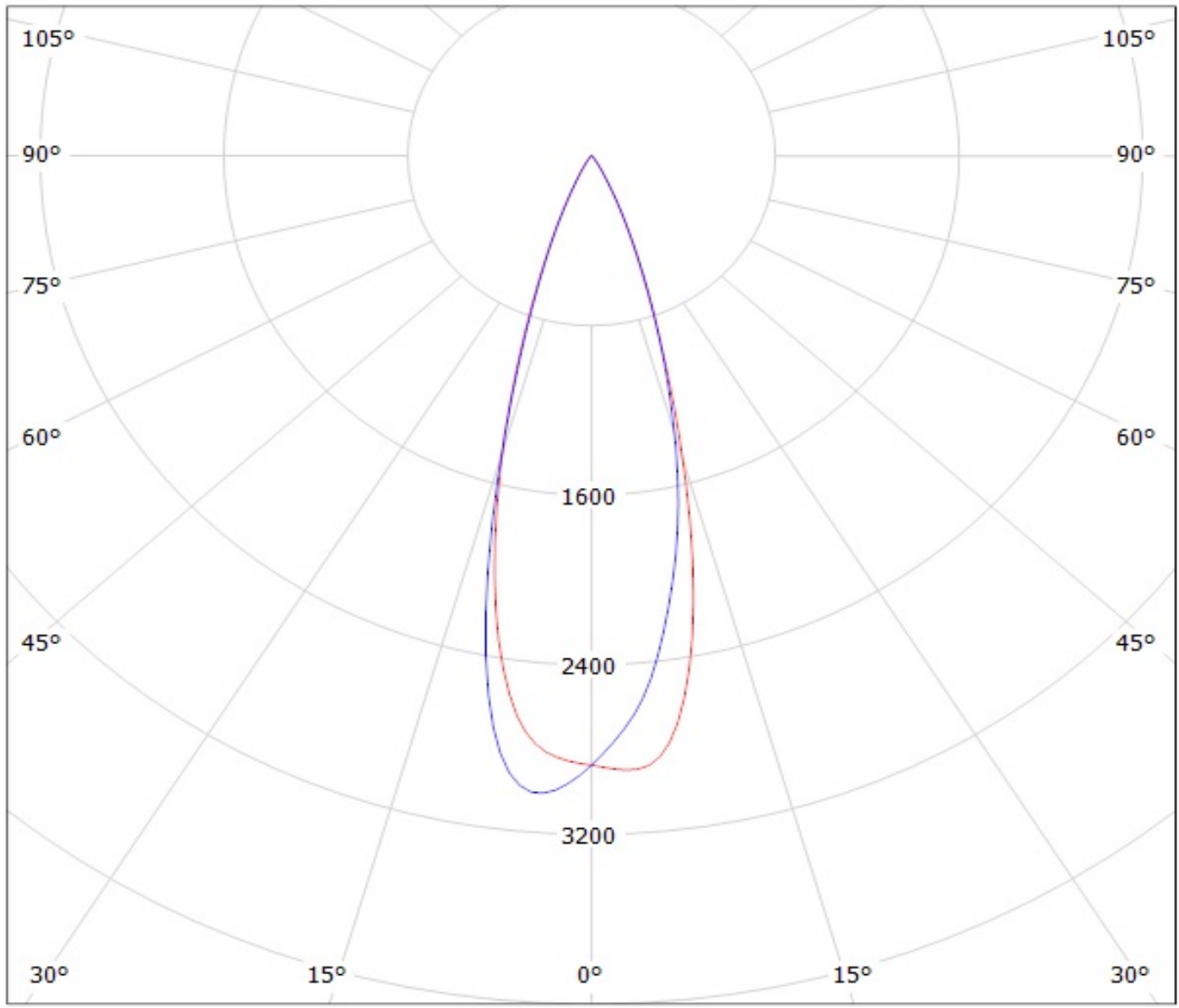

cd/klm

— C0 - C180 — C90 - C270

$\eta = 91\%$

Luminaire: LEDiL Oy CA14461_VERONICA-SQ-M_(Nichia_NVsxx19B)

Lamps: 1 x Nichia_NVsxx19B_105.826lm@250mA_P=0.731182W_I=250mA

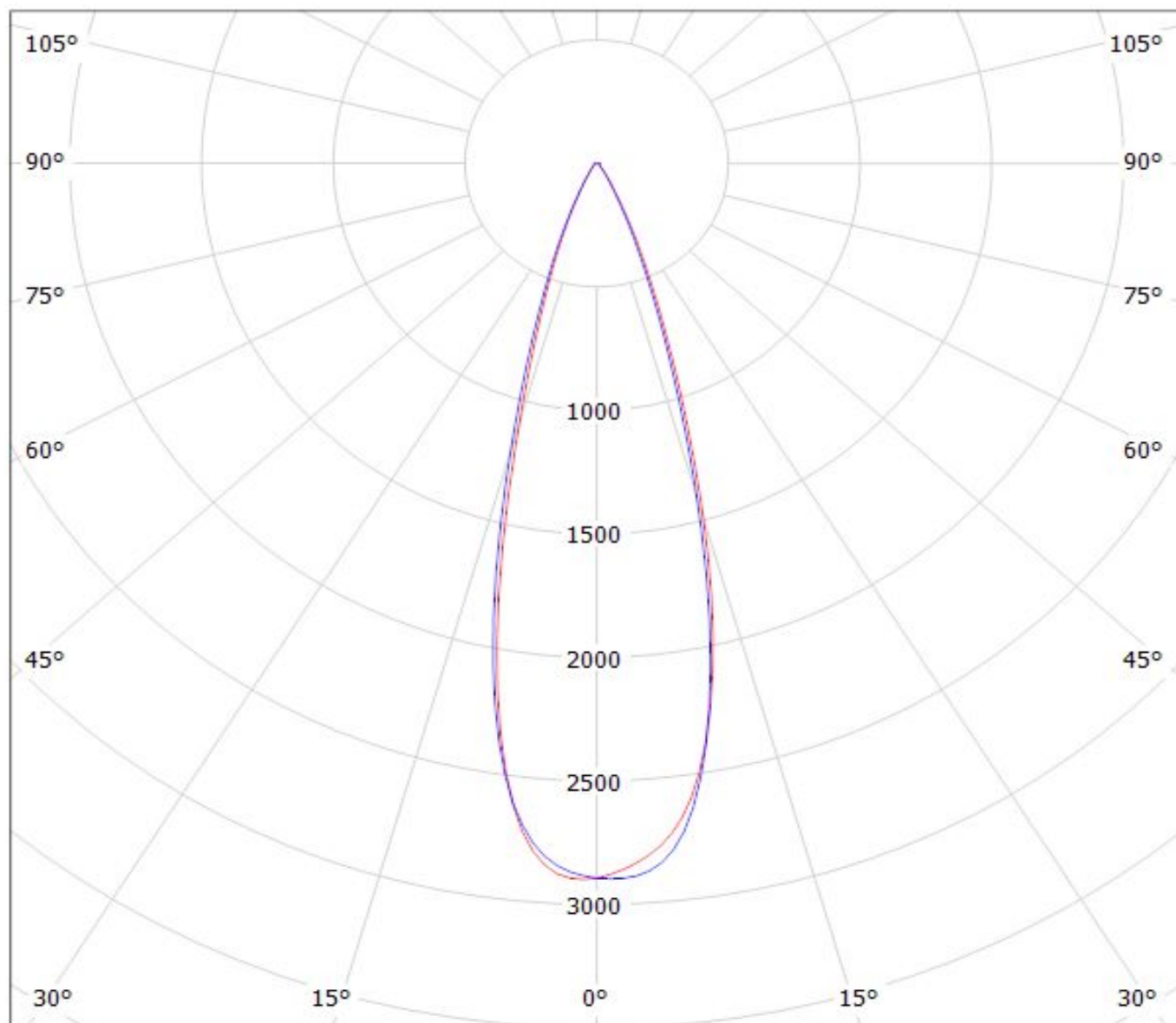

cd/klm

— C0 - C180

— C90 - C270

$\eta = 91\%$

Luminaire: LEDiL Oy CA14461_VERONICA-SQ-M_(Nichia_NCSxx19B)

Lamps: 1 x Nichia_NCSxx19B_90.3281lm@250mA_P=0.795931W_I=250mA

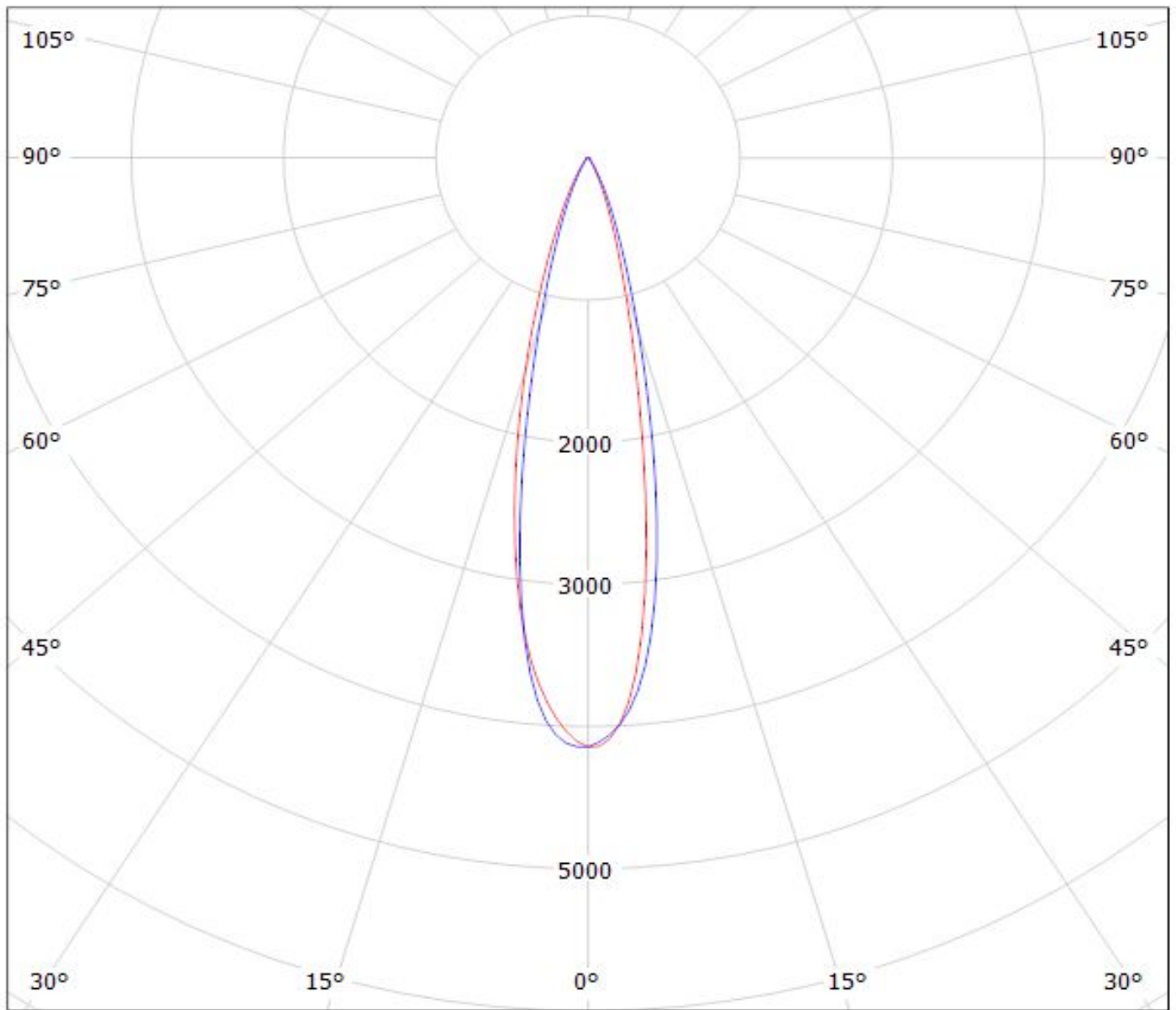

cd/klm

— C0 - C180

— C90 - C270

$\eta = 92\%$

Luminaire: LEDiL Oy CA14442_VERONICA-SQ-W_(NWSL229AE)

Lamps: 1 x Nichia_NWSL229AE_120.54lm@250mA_P=0.7128W_I=0.250A

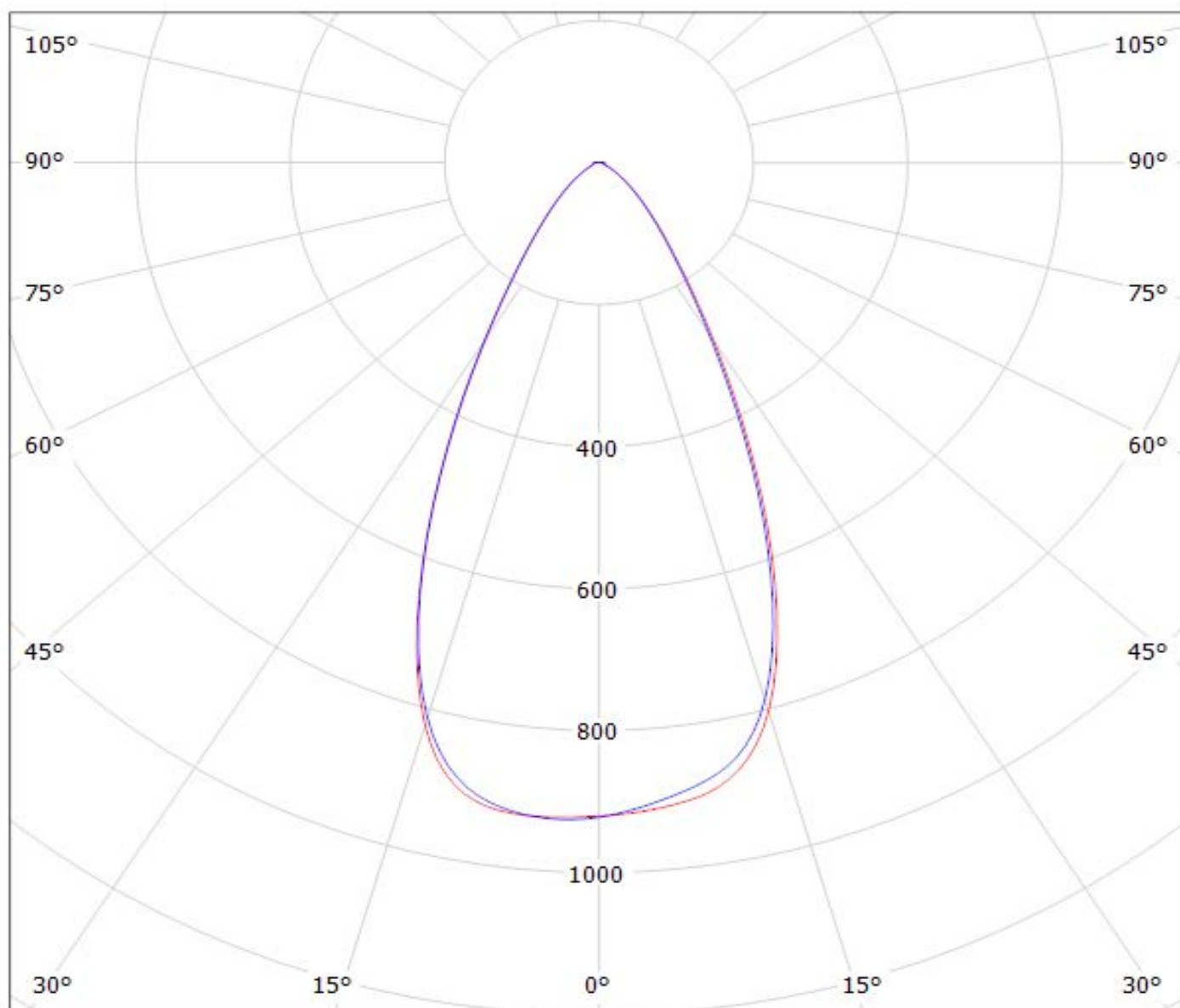

cd/klm

— C0 - C180

— C90 - C270

$\eta = 78\%$

Luminaire: LEDiL Oy CA14461_VERONICA-SQ-M_(Oslon_Square_PC)

Lamps: 1 x Osram_Oslon_Square-PC_(LCW_CQAR.PL-MSMV-5H71-1)_99.714lm@250mA_P=0.770717W_I=0.2499A

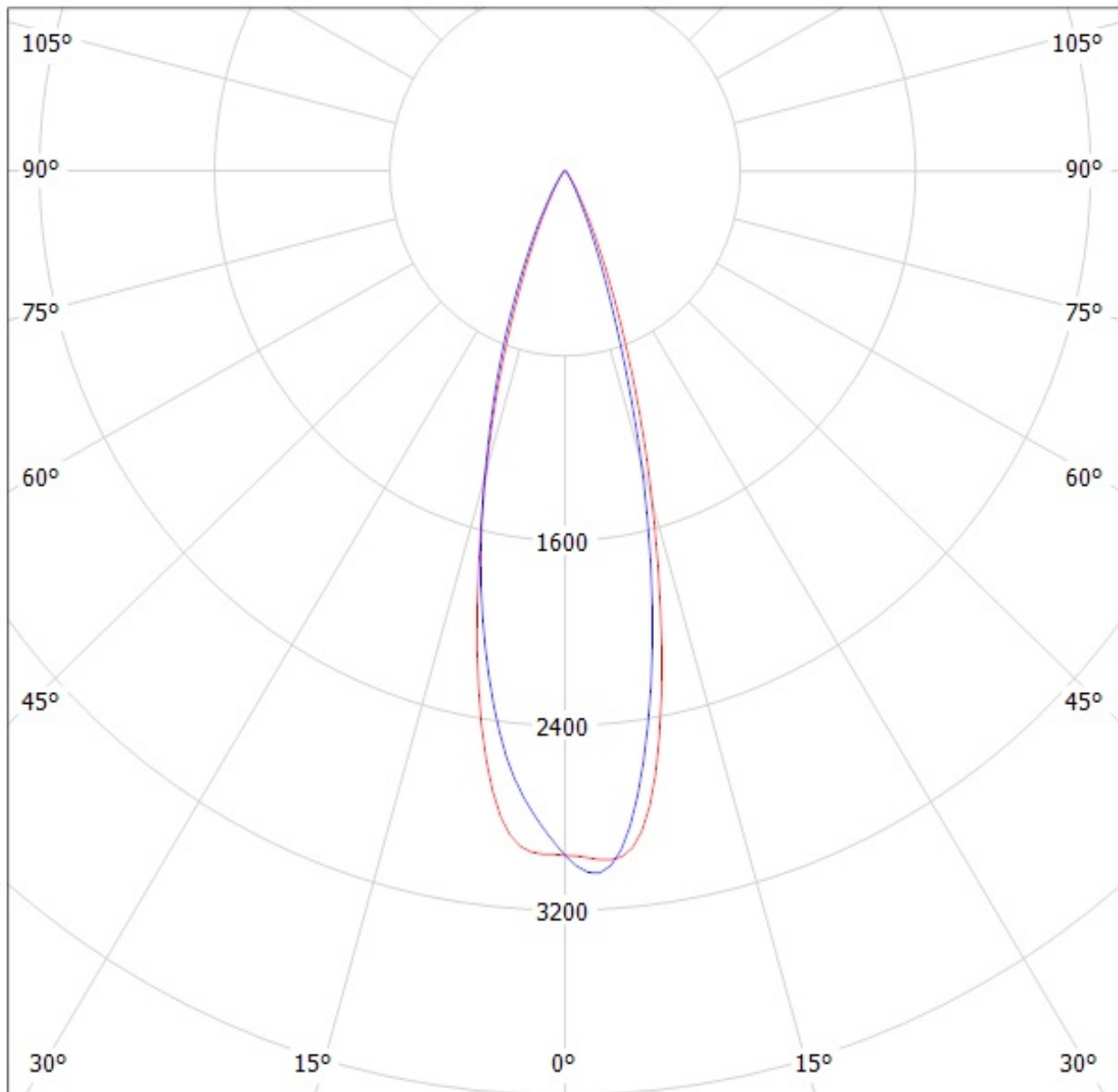

cd/klm

— C0 - C180

— C90 - C270

$\eta = 91\%$

Luminaire: LEDiL Oy CA14461_VERONICA-SQ-M_(Oslon_Square_EC)

Lamps: 1 x Osram_Oslon_Square_EC_(GW_CSSRM1.EC)_85.3477lm@250mA_P=0.738904W_I=0.2499A

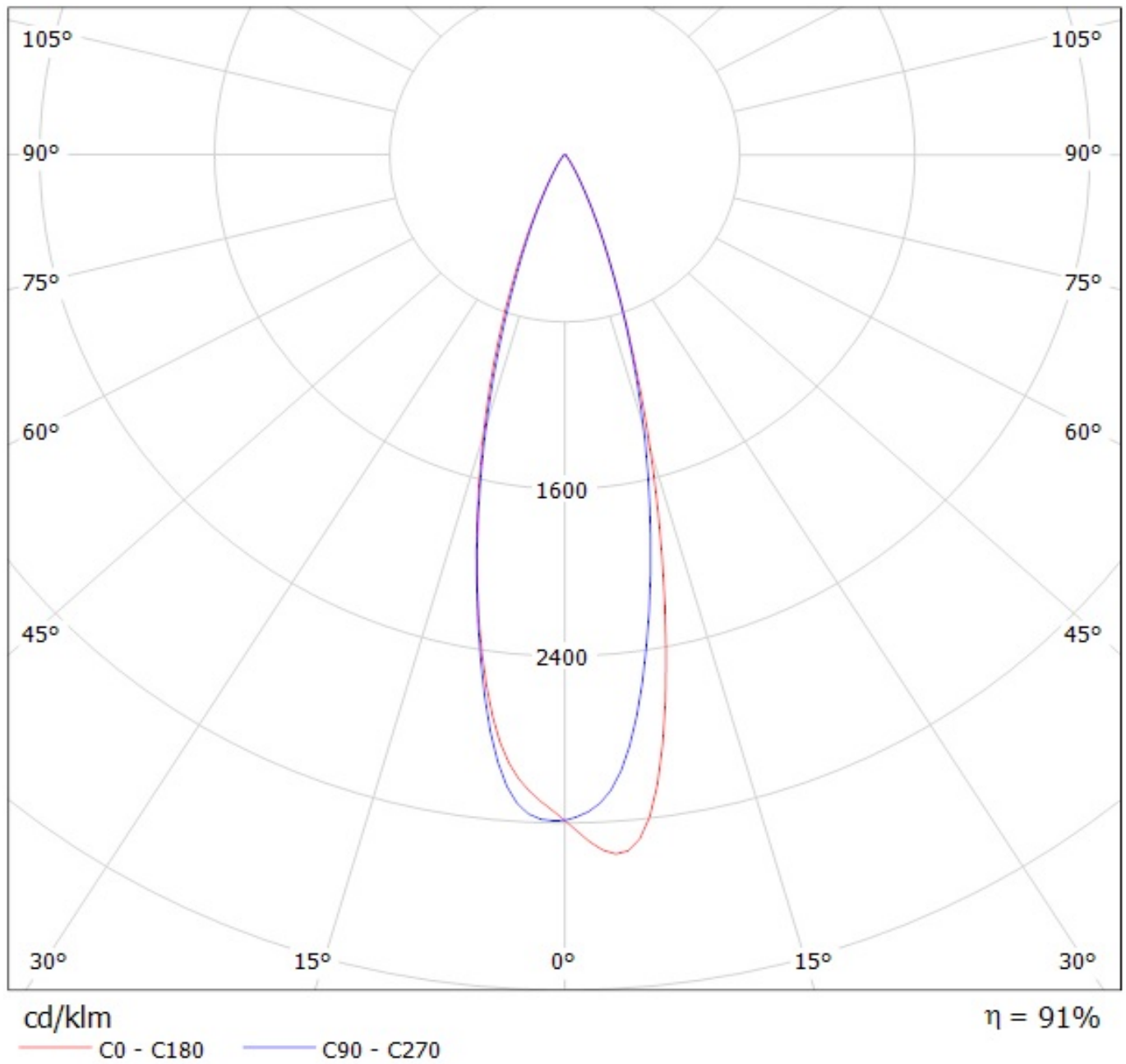

Luminaire: LEDiL Oy CA14461_VERONICA-SQ-M_(Z8Y22plus)

Lamps: 1 x Seoul_Z8Y22plus_(W6E2G)_125.652lm@250mA_P=0.69312W_I=0.250A

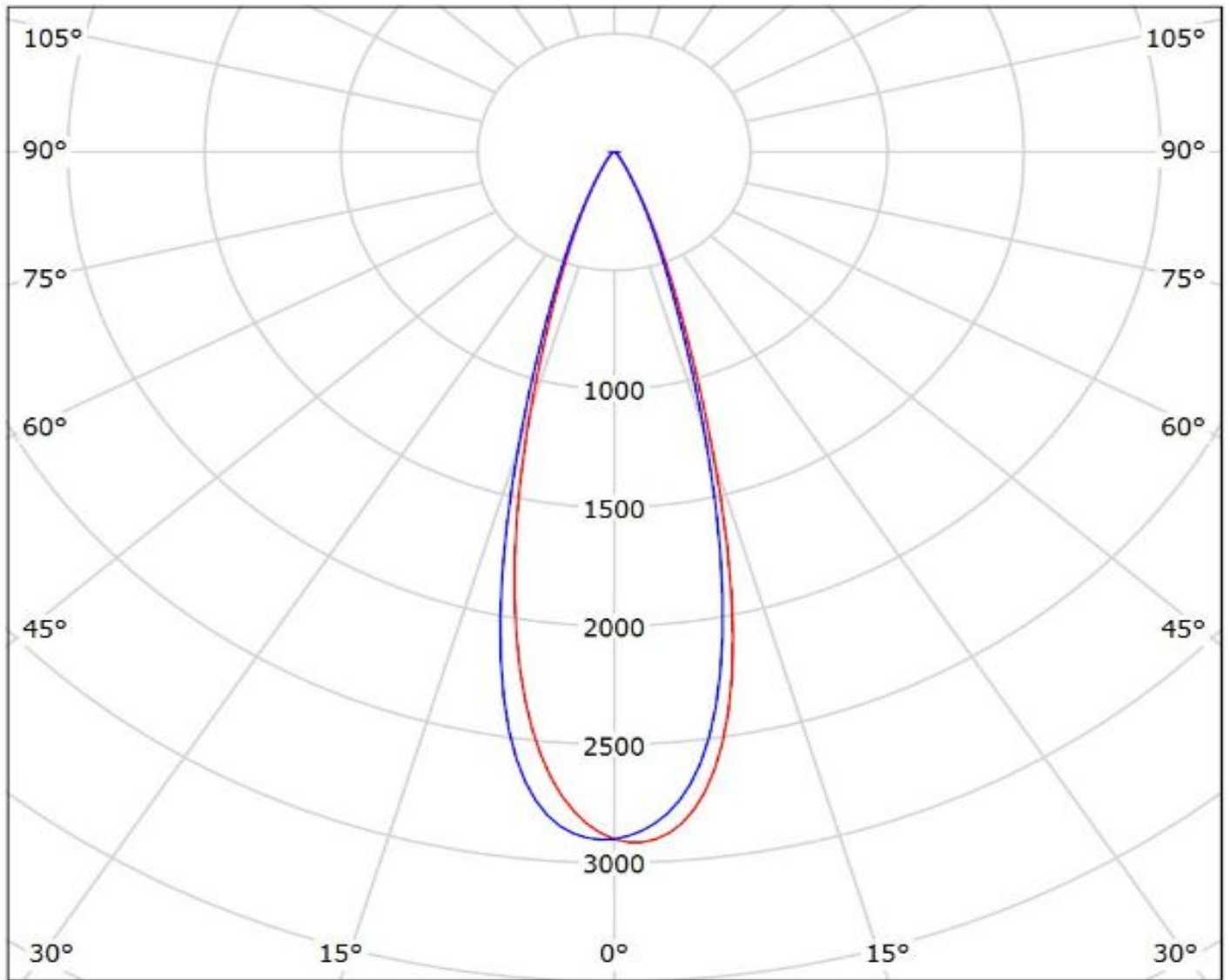

cd/klm

— C0 - C180 — C90 - C270

$\eta = 88\%$

NOTE: The typical divergence will be changed by different color, chip size and chip position tolerance. The typical total divergence is the full angle measured where the luminous intensity is half of the peak value.