

### 1. Dimensions:

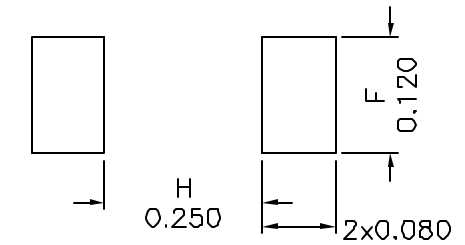

SUGGESTED LAND PATTERN

### 2. Schematic:

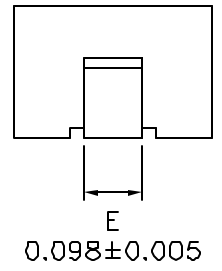
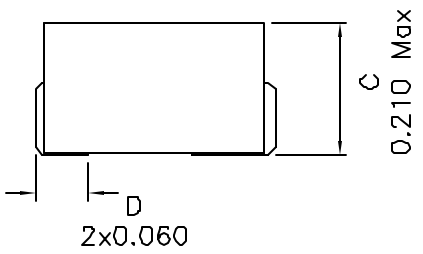
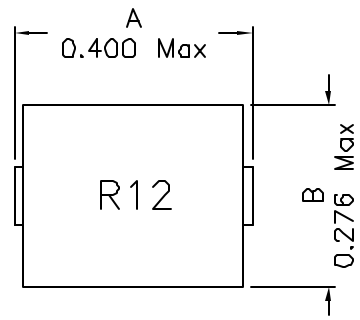
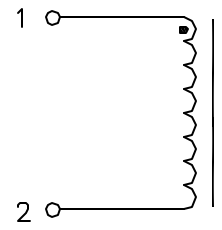

### 3. Electrical Specs:

OCL: Pins1-2 125nH±20% @2MHz, 0.1V  
 OCL: Pins1-2 90 Min @1MHz, 0.1V, 54Adc  
 Isat: 54Adc (Based on 40°C Temp Rise)  
 Irms: 47Adc (Based on 45°C Temp Rise)  
 DC Res.: Pins1-2 0.245 Ohms Max

Notes:

1. Solderability: Leads shall meet MIL-STD-202G, Method 208H for solderability.
2. Flammability: UL94V-0
3. ASTM oxygen index: > 28%
4. Insulation System: Glass F 155°C. UL file E15155B
5. Operating Temperature Range: All listed parameters are to be within tolerance from -40°C to +85°C
6. Storage Temperature Range: -55°C to +125°C
7. Aqueous wash compatible
8. SMD Lead Coplanarity: ±0.004"(0.102mm)
9. Electrical and mechanical specifications 100% tested
10. RoHS Compliant Component

DOC. REV: A/4

<b>XFMRs Inc</b> www.XFMRs.com		Title: INDUCTOR	
UNLESS OTHERWISE SPECIFIED TOLERANCES: .XXX ±0.010 Dimensions in INCH		P/N: XF100705-R12M	REV A
		DWN. Juan Mao	Nov-07-07
Scale 2.5:1 SHT 1 OF 1		CHK. YK Liao	Nov-07-07
		APP. MS	Nov-07-07