

Rev	AWO #	Description	Date	Appr
-		RELEASED	3/24/05	

APPROVED: _____
 DATE: _____ TITLE: _____

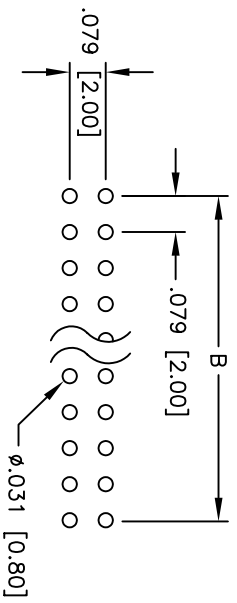

PCB LAYOUT

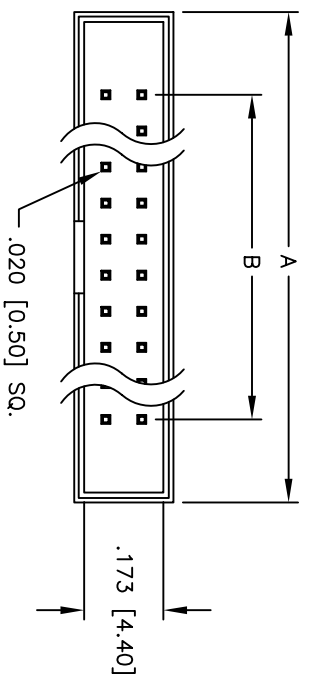
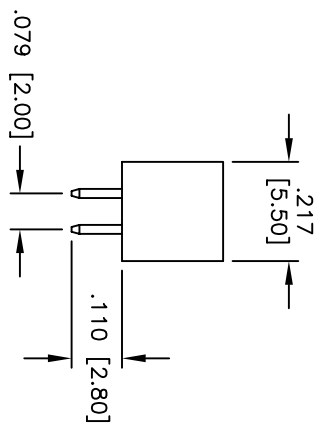
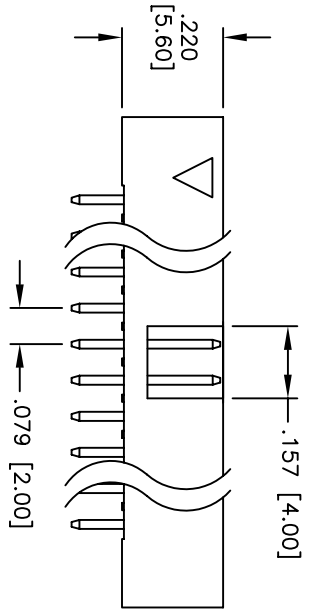

SPECIFICATIONS:

Material: Insulator: PBT, Glass filled, rated UL 94V-0

Insulator color: Black

Contacts: Brass

Plating:

Tin over Copper underplate overall

Electrical: Operating voltage: 250 VAC max.

Current rating: 1 Amp max.

Contact resistance: 20 mohms max. initial

Insulation resistance: 5,000 Mohms min.

Dielectric withstanding voltage: 1,000 VAC for 1 minute

Temperature Rating:

Operating temperature: -55°C to +105°C

Environmental:

Lead free, ROHS compliant

Recommended soldering temp: 230°C for 5 seconds



Positions: 8, 10, 14, 16, 20, 24, 26, 30, 34, 40, 44, 50, 60, 64
 A = .079 [2.00] x No. of Spaces + .362 [9.20]
 B = .079 [2.00] x No. of Spaces

UNLESS OTHERWISE SPECIFIED
 ALL DIMENSIONS ARE INCHES [MM]
 TOLERANCES: EXCEPT AS NOTED

INCHES	HOLES
.X ± .10	ØX ± .10
.XX ± .020	ØXX ± .015
.XXX ± .015	ØXXX ± .010

APPROVALS

DATE	DATE
SS	3/24/05

ADAM TECH
 909 Rahway Avenue, Union, NJ 07083
 Phone: 908-687-5000 Fax: 908-687-5710

TITLE: .079 [2.00] BOX HEADER, STRAIGHT, TIN PLATED, STANDARD SOLDER TAIL

DRAWN	CHECKED	APPROVED	SIZE	PART NO.	SCALE	SHEET	REV.
SS			X	2BHR-XX-VTA	NIS	1 OF 1	-