

Rev	AWO #	Description	Date	Appr
-		RELEASED	9/15/06	

APPROVED: _____
 DATE: _____ TITLE: _____

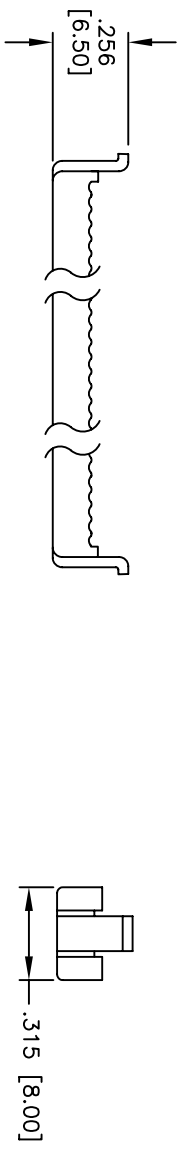
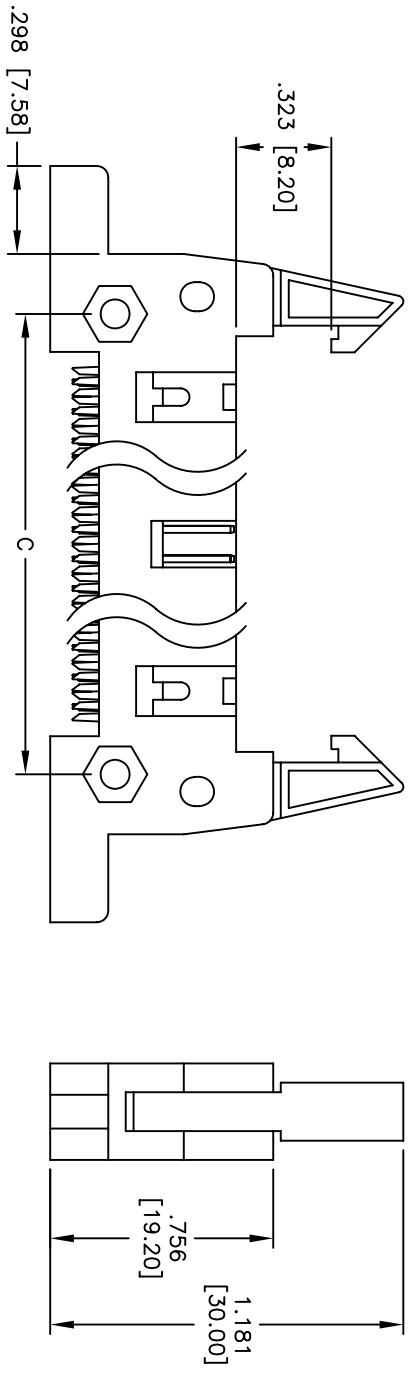
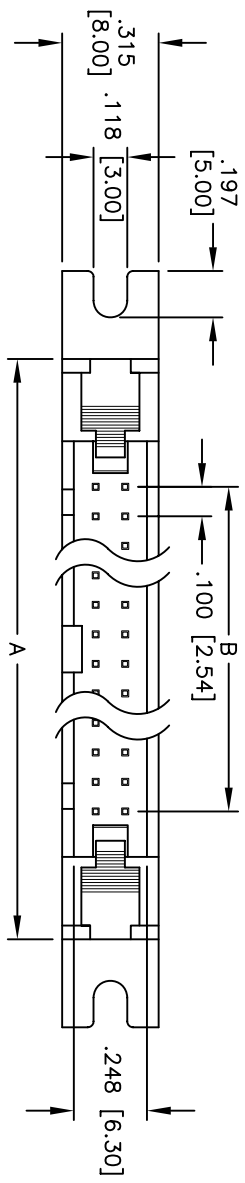

SPECIFICATIONS:

Material:
 Insulator: PBT, glass reinforced, rated UL 94V-0
 Insulator color: Gray
 Contacts: Phosphor Bronze
 Plating:
 Gold flash over Nickel underplate on mating area, Tin over Copper underplate on IDC area
Electrical:
 Operating voltage: 250 VAC max.
 Current rating: 3 Amp max.
 Contact resistance: 30 mohms max. initial
 Insulation resistance: 5,000 Mohms min.
 Dielectric withstanding voltage: 500 VAC for 1 minute
Mechanical:
 Recommended wire size: 28 AWG stranded
 Temperature Rating:
 Operating temperature: -55°C to +105°C
Environmental:
 Lead free, RoHS compliant

Positions: 10, 14, 16, 20, 24, 26, 30, 34, 40, 50, 60, & 64
 A = .100 [2.54] x No. of Positions per Row + .767 [19.47]
 B = .100 [2.54] x No. of Spaces
 C = .100 [2.54] x No. of Positions per Row + .360 [9.15]

UNLESS OTHERWISE SPECIFIED
 ALL DIMENSIONS ARE INCHES [MM]
 TOLERANCES: EXCEPT AS NOTED

INCHES	HOLES
.X ± .10	ØXX ± .10
.XX ± .020	ØXXX ± .015
.XXX ± .015	ØXXXX ± .010

APPROVALS: _____ DATE: _____

DRAWN	SS	9/15/06	TITLE	.100 x .100 IDC LATCH HEADER
CHECKED			LONG EJECTOR LATCHES, MTG EARS	
APPROVED			SIZE	PART NO.
			X	MHF-XX-SGL-E
			REF:	SCALE: NTS
				SHEET 1 OF 1

ADAM TECH

909 Railway Avenue, Union, NJ 07083
 Phone: 908-687-5000 Fax: 908-687-5710