

SCHEMATIC

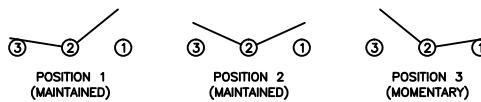

SPECIFICATIONS

FUNCTION:
1P2T ON-OFF-(ON)

RATINGS:
ANSI/UL 1054 and CAN/CSA C22.2 No. 55 (E194579):
16A 125VAC [cURus]
16A 250VAC [cURus]

CONTACT RESISTANCE:
Initial: 20mΩ Max.

INSULATION RESISTANCE:
100MΩ Min. at 500VDC

DIELECTRIC STRENGTH:
1,000VAC for 1 Minute

ELECTRICAL LIFE:
6,000 Cycles [cURus]

TEMPERATURE:
Operating: -20°C to 65°C

APPROVALS:
 RoHS COMPLIANT

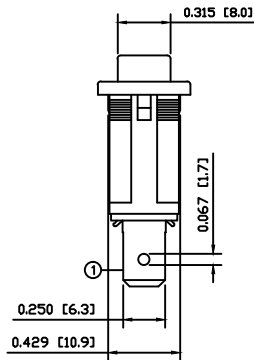
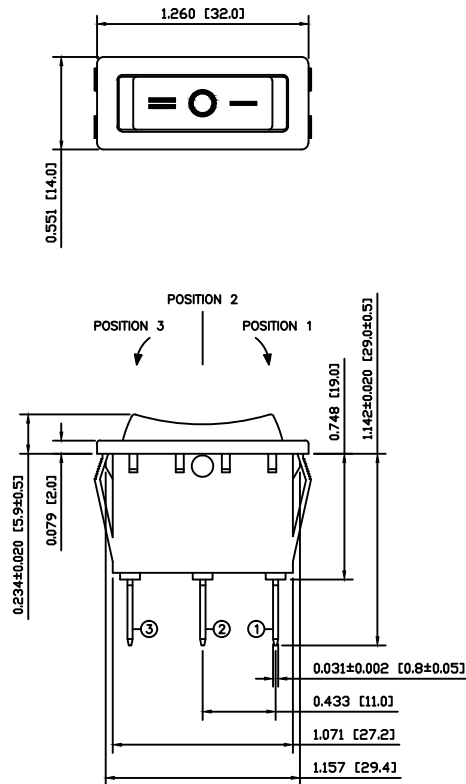

COLORS AND MARKINGS

BODY:
Black

ACTUATOR:
Black

MARKINGS:
I/O/II Vertical (S)

MARKING COLOR:
White

MATERIALS

BODY:
Polyamide 6/6 (PA66), UL94 V-2

ACTUATOR:
Polyamide 6/6 (PA66), UL94 V-2

SPRING:
Steel

CONTACTS:
Silver Plated Copper

TERMINALS:
Silver Plated Copper
Silver Plated Brass

SUGGESTED PANEL CUTOUT

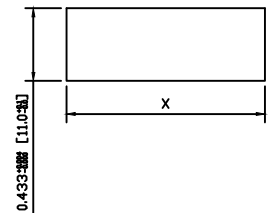

| PANEL THICKNESS | | X |
|-----------------|-------------|--------------|
| 0.030~0.049 | [0.75~1.25] | 1.181 [30.0] |
| 0.049~0.079 | [1.25~2.00] | 1.189 [30.2] |
| 0.079~0.118 | [2.00~3.00] | 1.201 [30.5] |

| | | | |
|----------------|------|-----------|-----|
| ACTUATOR | A | 06/06/26 | CAB |
| BODY | A | 06/06/26 | CAB |
| COLORS | A | 06/06/26 | CAB |
| MATERIALS | A | 06/07/27 | CAB |
| SPECIFICATIONS | | 6/30/2015 | MW |
| REFERENCE | REV. | DATE | BY |

THE INFORMATION CONTAINED IN THIS DOCUMENT IS PROPRIETARY TO E-SWITCH AND IS NOT TO BE COPIED OR TRANSFERRED

| | | | | | |
|------|---|------------------------|-------|-----------|----------|
| REV. | A | RELEASE FOR PRODUCTION | 21894 | 6/30/2015 | MW |
| | | DESCRIPTION | PCR | DATE | DRAWN BY |

| | |
|----------------------|--|
| DIMENSIONS | |
| INCHES [MILLIMETERS] | |
| GENERAL TOLERANCES | |
| ±0.008 [±0.2] / ±1* | |
| SCALE | |
| DRAWING NOT TO SCALE | |
| PROJECTION | |

| | | |
|-------------------|-----------|----------|
| | | |
| RB14CE112S | | |
| DRAWING NUMBER | DATE | REVISION |
| 14-RB14CE112S | 6/30/2015 | A |