

SCHMATIC

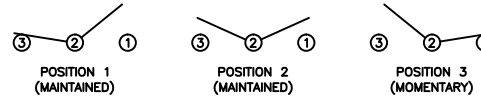

SPECIFICATIONS

FUNCTION:  
1P2T ON-OFF-(ON)

RATINGS:  
ANSI/UL 1054 and CAN/CSA C22.2 No. 55 (E194579):  
16A 125VAC [cURus]  
16A 250VAC [cURus]

CONTACT RESISTANCE:  
Initial: 20mΩ Max.

INSULATION RESISTANCE:  
100MΩ Min. at 500VDC

DIELECTRIC STRENGTH:  
1,000VAC for 1 Minute

ELECTRICAL LIFE:  
6,000 Cycles [cURus]

TEMPERATURE:  
Operating: -20°C to 65°C

APPROVALS:  
 RoHS COMPLIANT

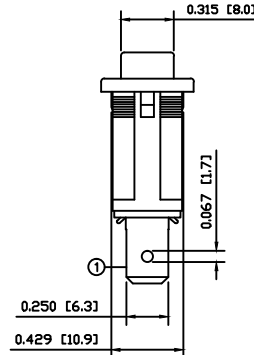
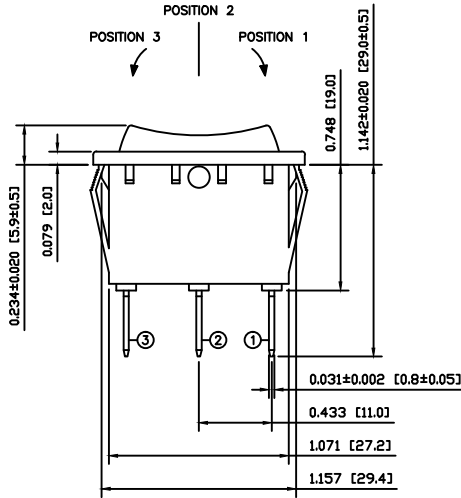
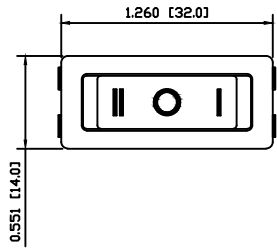

COLORS AND MARKINGS

BODY:  
Black

ACTUATOR:  
Black

MARKINGS:  
I/O/II Horizontal (9)

MARKING COLOR:  
White

MATERIALS

BODY:  
Polyamide 6/6 (PA66), UL94 V-2

ACTUATOR:  
Polyamide 6/6 (PA66), UL94 V-2

SPRING:  
Steel

CONTACTS:  
Silver Plated Copper

TERMINALS:  
Silver Plated Copper  
Silver Plated Brass

SUGGESTED PANEL CUTOUT

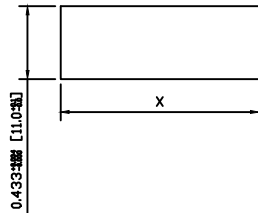

| PANEL THICKNESS         | X            |
|-------------------------|--------------|
| 0.030~0.049 [0.75~1.25] | 1.181 [30.0] |
| 0.049~0.079 [1.25~2.00] | 1.189 [30.2] |
| 0.079~0.118 [2.00~3.00] | 1.201 [30.5] |

|                |      |           |     |
|----------------|------|-----------|-----|
| ACTUATOR       | A    | 06/06/26  | CAB |
| BODY           | A    | 06/06/26  | CAB |
| COLORS         | A    | 06/06/26  | CAB |
| MATERIALS      | A    | 06/07/27  | CAB |
| SPECIFICATIONS |      | 6/30/2015 | MW  |
| REFERENCE      | REV. | DATE      | BY  |

THE INFORMATION CONTAINED IN THIS DOCUMENT IS PROPRIETARY TO E-SWITCH AND IS NOT TO BE COPIED OR TRANSFERRED.

|      |   |             |       |          |          |
|------|---|-------------|-------|----------|----------|
| REV. | A | DESCRIPTION | 21974 | 9/1/2015 | MW       |
|      |   |             | PCR   | DATE     | DRAWN BY |

|                    |                      |
|--------------------|----------------------|
| DIMENSIONS         | INCHES [MILLIMETERS] |
| GENERAL TOLERANCES | ±0.008 [±0.2] / ±1°  |
| SCALE              | DRAWING NOT TO SCALE |

|                |          |          |
|----------------|----------|----------|
|                |          |          |
| RB14CE1129     |          |          |
| DRAWING NUMBER | DATE     | REVISION |
| 14-RB14CE1129  | 9/1/2015 | A        |