

Features

- Built-in zener Di between collector gate VCL typ. 400V
- Built-in gate protection diode
- SMD PKG TO252
- Low saturated voltage
VCE(sat) Max. 1.4V (at VGE=10V, IC=5A)

Package



Applications

- Ignitor

Equivalent circuit

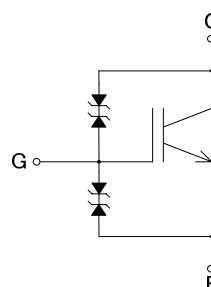

Absolute maximum ratings

(Ta=25°C)

Characteristic	Symbol	Rating	Unit
Collector to Emitter Voltage	VCES	CLAMPED	V
Gate to Emitter Voltage	VGE	±20	V
Continuous Collector Current	IC(DC)	15	A
Maximum Allowable Power Dissipation	PC	55 (Tc=25°C)	W
Operating Junction Temperature	Tj	150	°C
Storage Temperature	Tstg	-55 to +150	°C

Electrical characteristics

(Ta=25°C)

Characteristic	Symbol	Test Conditions	Limits			Unit
			MIN.	TYP.	MAX.	
Collector to Emitter Breakdown Voltage	V(BR)CES	IC= 2mA, VGE=0V	375	400	425	V
Gate to Emitter Breakdown Voltage	V(BR)GES	IG=±100μA, VCE=0V	±20			V
Emitter to Collector Breakdown Voltage	V(BR)ECS	IEC=10mA, VGE=0V	20			V
Collector to Emitter Leakage Current	ICES	VCE=300V, VGE=0V			100	μA
Gate to Emitter Leakage Curren	IGES	VGE=±20V, VCE=0V			±100	μA
Gate Threshold Voltage	VGE(th)	VCE= 10V, IC=1mA	1.4	1.8	2.2	V
Collector to Emitter Saturation Voltage	VCE(sat)	VGE=4.5V, IC= 5A		1.2	1.5	V
Collector to Emitter Saturation Voltage	VCE(sat)	VGE=10V, IC= 5A		1.1	1.4	V
Collector to Emitter Saturation Voltage	VCE(sat)	VGE=10V, IC= 10A		1.4	1.7	V
Input Capacitance	Cies	VCE=10V f=1.0MHz VGE=0V		700		pF
Output Capacitance	Coes			300		
Reverse Transfer Capacitance	Cres			220		
Self Clamped Inductive Switching Energy	ES/B	L=5mH, Rg=200Ω	150			mJ

The information included herein is believed to be accurate and reliable. However, SANKEN ELECTRIC CO., LTD assumes no responsibility for its use ; nor for any infringements of patents or other rights of third parties that may result from its use.

Characteristic Curves (Tc=25°C)

IC - VCE characteristics (typical)

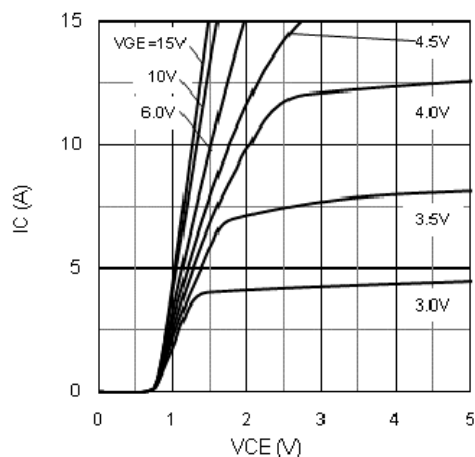

IC - VCE characteristics (typical)

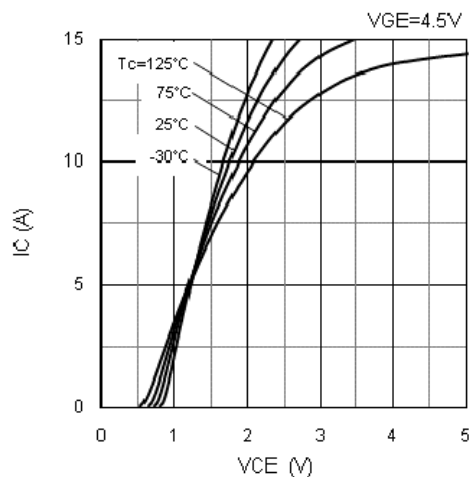

IC - VCE characteristics (typical)

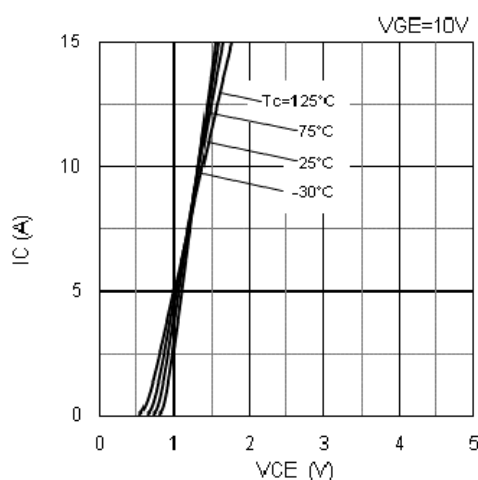

IC - VGE characteristics (typical)

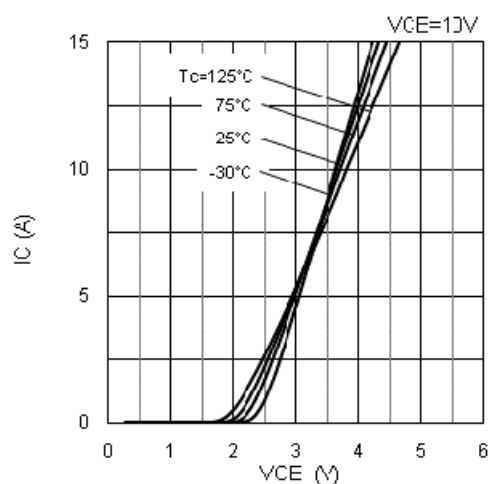

VCEs - Tc characteristics (typical)

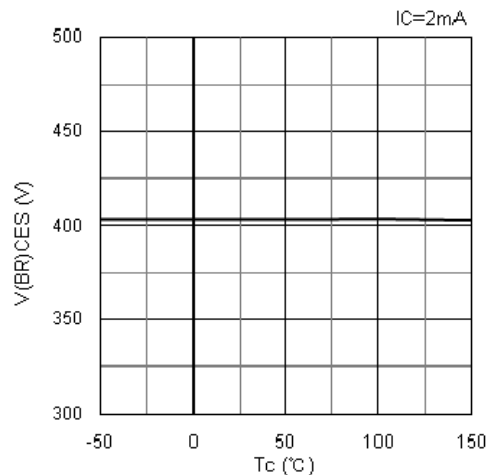

VCE - VGE characteristics (typical)

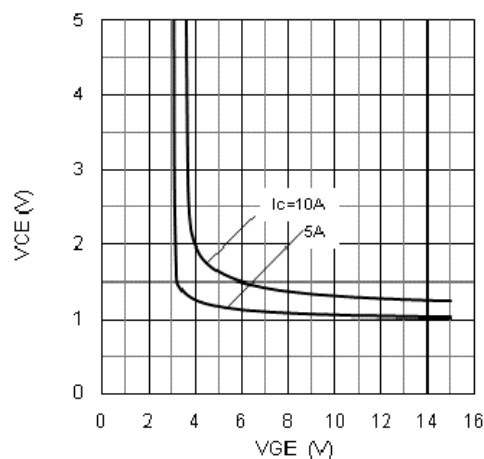

The information included herein is believed to be accurate and reliable. However, SANKEN ELECTRIC CO., LTD assumes no responsibility for its use ; nor for any infringements of patents or other rights of third parties that may result from its use.

Characteristic Curves (Tc=25°C)

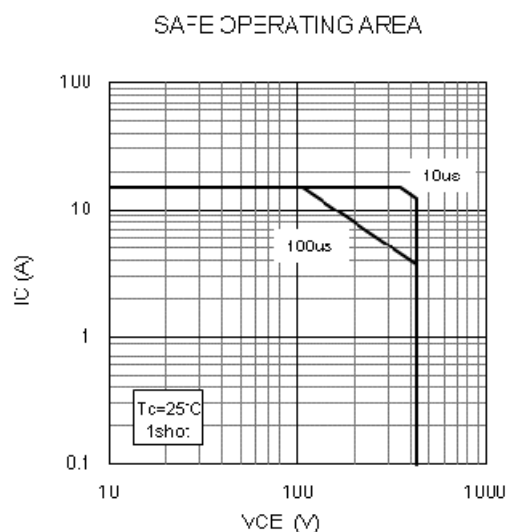
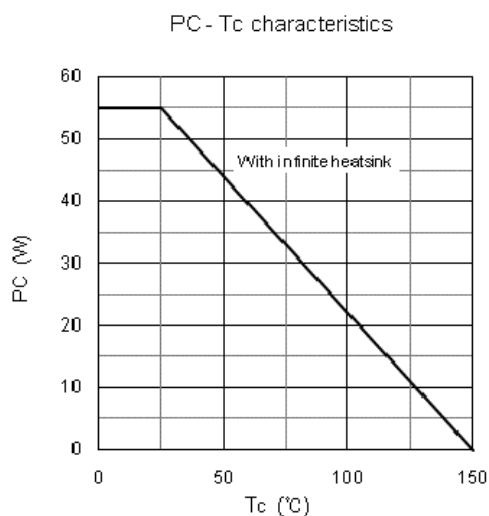
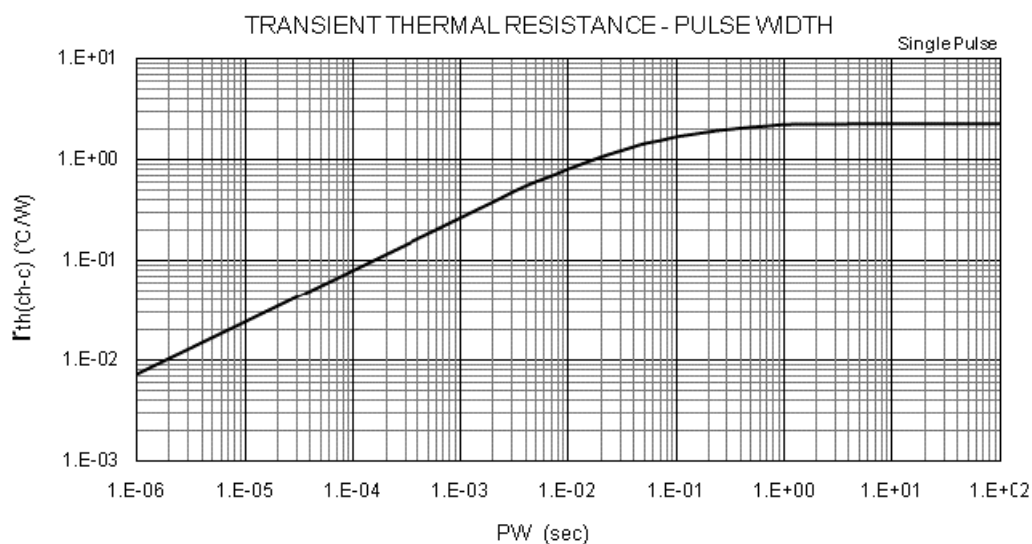
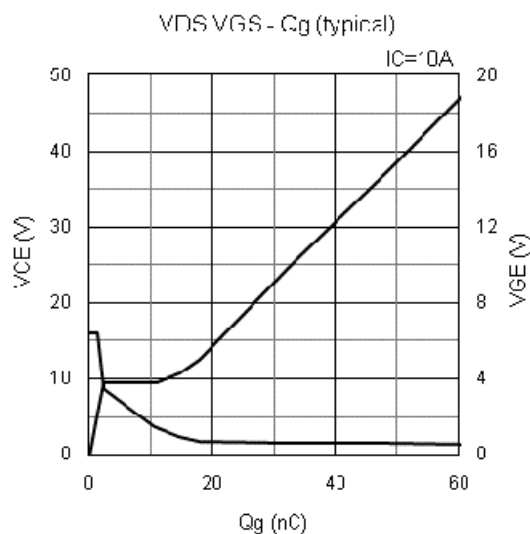
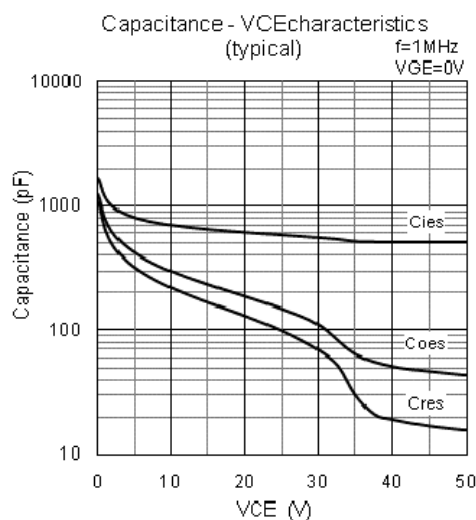

The information included herein is believed to be accurate and reliable. However, SANKEN ELECTRIC CO., LTD assumes no responsibility for its use ; nor for any infringements of patents or other rights of third parties that may result from its use.

Outline

TO252

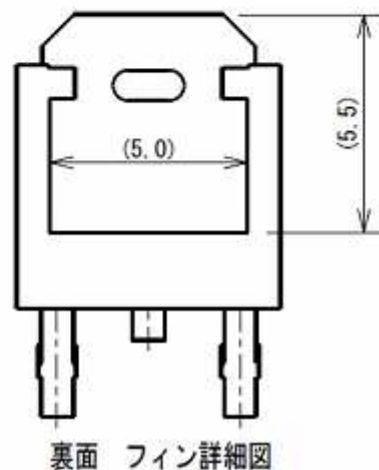
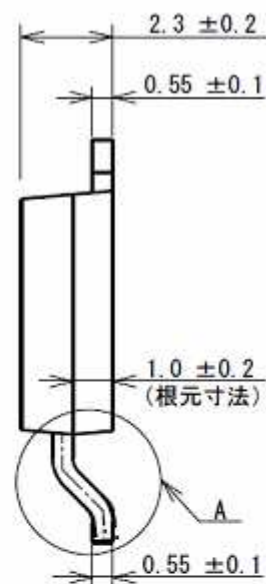
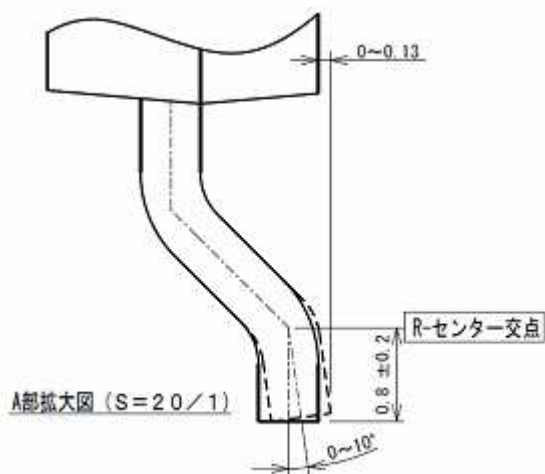
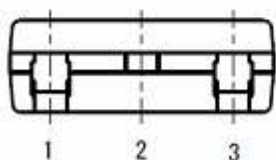
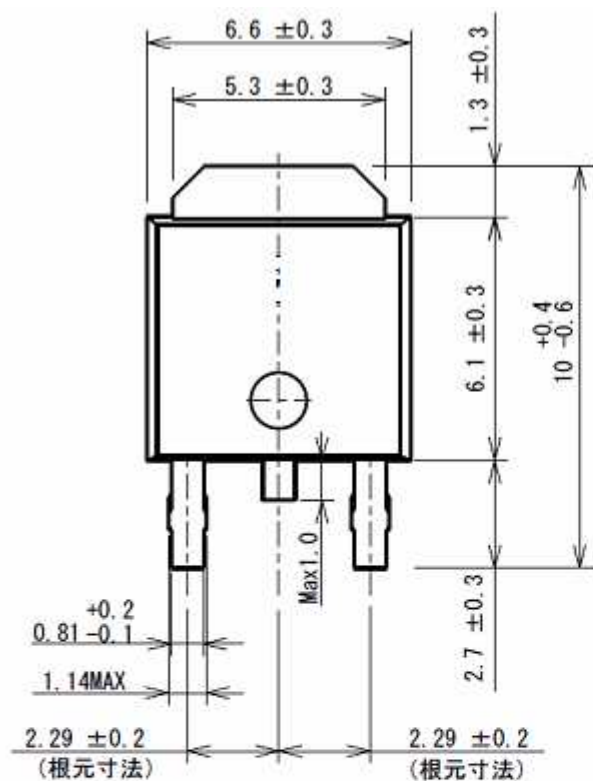

Weight Approx.0.33g

The information included herein is believed to be accurate and reliable. However, SANKEN ELECTRIC CO., LTD assumes no responsibility for its use ; nor for any infringements of patents or other rights of third parties that may result from its use.