

IEC Appliance Inlet C14, Snap-in Mounting, Front Side, Solder or Quick-connect Terminal



6100-4



**Description**

- Panel Mount :  
Snap-in version from front side
- 1 Function :
- Appliance Inlet , Pin temperature 70 °C , Protection class I
- Solder terminals or quick connect terminals

**Approvals**

- VDE Certificate Number: 40015595
- UL File Number: E96454

**Other versions on request**

- Other panel thickness
- Types for enhanced glow wire test requirements acc. IEC 60695-2-12 and -13 for the use in unattended household equipment acc. IEC 60335-1

**References**

- Alternative: protection class II version [6102-5](#)
- Alternative: version with line filter [5110](#); [5120](#)

**Weblinks**

[pdf-datasheet](#), [html-datasheet](#), [General Product Information](#), [RoHS](#), [CHINA-RoHS](#), [REACH](#), [Distributor-Stock-Check](#), [Accessories](#), [Detailed request for product](#)

**Technical Data**

|                           |   |                         |   |
|---------------------------|---|-------------------------|---|
| Ratings IEC               | 10A / 250VAC; 50Hz  | appliance inlet/-outlet | C14 acc. to IEC 60320-1, UL 60320-1, CSA C22.2 no. 60320-1 (for cold conditions) pin-temperature 70 °C, 10A, Protection Class I |
| Ratings UL/CSA            | 15A / 250VAC; 60Hz  |                         |   |
| Dielectric Strength       | > 2 kVAC between L-N<br>> 2 kVAC between L/N-PE (1 min/50Hz)      |                         |   |
| Allowable Operation Temp. | -25 °C to 70 °C   |                         |   |
| IP-Protection             | from front side IP 30 acc. to IEC 60529                           |                         |   |
| Insulation cover          | Suitable for appliances with protection class I acc. to IEC 61140 |                         |   |
| Terminal                  | Solder terminals or quick connect terminals                       |                         |   |
| Panel Thickness s         | Snap-in: 1/1.2/1.5/2.0/2.5/3 mm                                   |                         |   |
| Material: Housing         | Thermoplastic, black, UL 94V-0                                    |                         |   |

**Dimensions**

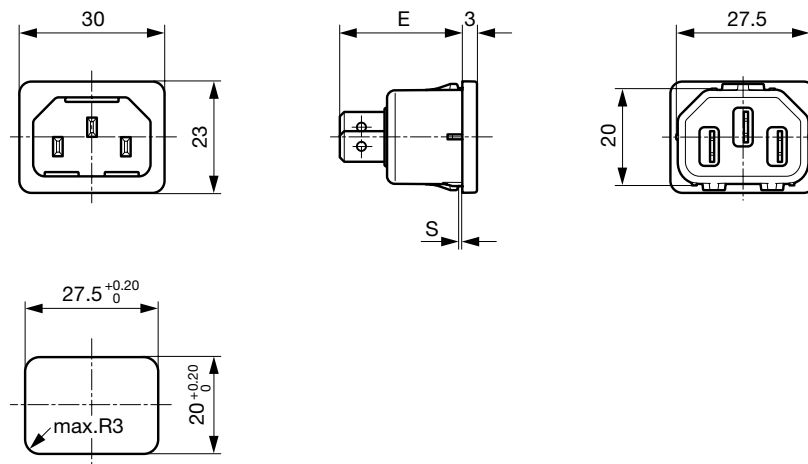

- E: Solder terminals 22.5 mm
- E: Quick connect terminals 25.5 mm
- S: 1.0; 1.2; 1.5; 2.0; 2.5; 3.0 mm

## All Variants

| Type   | Protection Class | Panel mounting | Panel Thickness<br>s [mm] | Terminal                             | Order Number |
|--------|------------------|----------------|---------------------------|--------------------------------------|--------------|
| 6100-4 | I                | Snap-in        | 1                         | Quick connect terminals 4.8 x 0.8 mm | 6100.4210    |
| 6100-4 | I                | Snap-in        | 1.2                       | Quick connect terminals 4.8 x 0.8 mm | 6100.4212    |
| 6100-4 | I                | Snap-in        | 1.5                       | Quick connect terminals 4.8 x 0.8 mm | 6100.4215    |
| 6100-4 | I                | Snap-in        | 1.6                       | Quick connect terminals 4.8 x 0.8 mm | 6100.4216    |
| 6100-4 | I                | Snap-in        | 2                         | Quick connect terminals 4.8 x 0.8 mm | 6100.4220    |
| 6100-4 | I                | Snap-in        | 2.5                       | Quick connect terminals 4.8 x 0.8 mm | 6100.4225    |
| 6100-4 | I                | Snap-in        | 3                         | Quick connect terminals 4.8 x 0.8 mm | 6100.4230    |
| 6100-4 | I                | Snap-in        | 1                         | Quick connect terminals 6.3 x 0.8 mm | 6100.4310    |
| 6100-4 | I                | Snap-in        | 1.2                       | Quick connect terminals 6.3 x 0.8 mm | 6100.4312    |
| 6100-4 | I                | Snap-in        | 1.5                       | Quick connect terminals 6.3 x 0.8 mm | 6100.4315    |
| 6100-4 | I                | Snap-in        | 2                         | Quick connect terminals 6.3 x 0.8 mm | 6100.4320    |
| 6100-4 | I                | Snap-in        | 2.5                       | Quick connect terminals 6.3 x 0.8 mm | 6100.4325    |
| 6100-4 | I                | Snap-in        | 3                         | Quick connect terminals 6.3 x 0.8 mm | 6100.4330    |
| 6100-4 | I                | Snap-in        | 1                         | Solder terminals 3.8 x 0.8 mm        | 6100.4110    |
| 6100-4 | I                | Snap-in        | 1.2                       | Solder terminals 3.8 x 0.8 mm        | 6100.4112    |
| 6100-4 | I                | Snap-in        | 1.5                       | Solder terminals 3.8 x 0.8 mm        | 6100.4115    |
| 6100-4 | I                | Snap-in        | 2                         | Solder terminals 3.8 x 0.8 mm        | 6100.4120    |
| 6100-4 | I                | Snap-in        | 2.5                       | Solder terminals 3.8 x 0.8 mm        | 6100.4125    |
| 6100-4 | I                | Snap-in        | 3                         | Solder terminals 3.8 x 0.8 mm        | 6100.4130    |

 Most Popular.

Availability for all products can be searched real-time: <http://www.schurter.com/Stock-Check/Stock-Check-SCHURTER>

Articles for enhanced glow wire test requirements acc. IEC 60695-2-12 and -13 can be ordered with ending ".15" (xxxx.xxxx.15). They are suitable for the use in unattended household equipment acc. IEC 60335-1.

**Packaging unit** 50 Pcs

## Accessories

## Description



**Wire Harness**  
Wire harness for SCHURTER products



**Assorted Covers**  
Rear Cover

0859.0048

4311.9401

4311.9402



**Cord retaining kits**  
Cord retaining strain relief

Flat head, Z

0888.0021

Countersunk, C

4700.0003

Mating Outlets/Connectors

Category / Description



[Appliance Outlet Overview complete](#)

|   |      |
|---|------|
| IEC Appliance Outlet F, Screw-on Mounting, Front Side, Solder Terminal                            | 4787 |
| IEC Appliance Outlet F, Snap-in Mounting, Front Side, Solder or Quick-connect Terminal            | 4788 |
| IEC Appliance Outlet F or H, Screw-on Mounting, Front Side, Solder, PCB or Quick-connect Terminal | 5091 |

[Appliance Outlet further types to 6100-4](#)

[Connector Overview complete](#)



|  |         |
|--|---------|
| 4782 Mounting: Power Cord, 3 x 1 mm <sup>2</sup> / 3 x 18 AWG, Cable, Connector: IEC C13     | 4782    |
| 4022 Mounting: Power Supply Cord, 3 x 1.5 mm <sup>2</sup> , Screw clamps, Connector: IEC C13 | 4022    |
| 4785 Mounting: Power Cord, 3 x 1 mm <sup>2</sup> / 3 x 18 AWG, Cable, Connector: IEC C13     | 4785    |
| 4300-06 Mounting: Power Cord, 3 x 1 mm <sup>2</sup> / 3 x 18 AWG, Cable, Connector: IEC C13  | 4300-06 |
| 4012 Mounting: Power Supply Cord, 3 x 1.5 mm <sup>2</sup> , Screw clamps, Connector: IEC C13 | 4012    |

[Connector further types to 6100-4](#) ...