



FEATURES

- 2" x 4" x 1.2" Open Frame
- Low Leakage Current
- BF Rated Outputs
- Remote Sense & Optional PFD
- 0.5W No Load Power Consumption



MODELS LIST

Product No. <sup>(1)</sup>	Output Voltage	Maximum Output Power <sup>(2)</sup>			
		@ Convection		@ 7.5 CFM	
		Current	Wattage	Current	Wattage
TMC150-S12	12V	8.35A	100W	12.5A	150W
TMC150-S15	15V	6.7A	100W	10A	150W
TMC150-S18	18V	5.56A	100W	8.34A	150W
TMC150-S24	24V	4.2A	100W	6.25A	150W
TMC150-S30	30V	3.34A	100W	5A	150W
TMC150-S36	36V	2.78A	100W	4.17A	150W
TMC150-S48	48V	2.1A	100W	3.13A	150W

Notes:  
 1. Add suffix F to the P/N to order units with PFD, e.g. TMC150-S24F.  
 2. 168W peak power with 10% duty cycle maximum for less than 15 seconds with the average output not to exceed the maximum power rating.

INPUT SPECIFICATIONS

Input Voltage Range ..... 90-264 VAC  
 Input Frequency ..... 47-63 Hz  
 Input Current ..... 1.7A rms @ 115 VAC,  
 0.85A rms @ 230 VAC  
 Inrush Current ..... 80A @ 115 VAC or 160A @ 230 VAC,  
 at 25°C cold start  
 Earth Leakage Current ..... 105 µA max. @ 264 VAC, 63 Hz

OUTPUT SPECIFICATIONS

Output Power Ratings ..... See table  
 Minimum Load ..... Not required  
 Tolerance ..... ±2%  
 Ripple and Noise\* ..... 1% Vp-p, 20 MHz bandwidth  
 Remote Sense ..... Compensates cable losses up  
 to 0.5V  
 Overvoltage Protection ..... Set at 112-140% of its nominal  
 output voltage  
 Overcurrent Protection ..... Protected to short-circuit  
 conditions  
 Temperature Coefficient ..... ±0.04%/°C max.  
 Transient Response ..... Max. excursion of 4% or better on  
 all models, recovering to 1% of  
 final value within 500 µs after a  
 25% step load change  
 No Load Power Cons. ....<0.5W w/o PFD, <1W with PFD

\* Measured with a 10µF tantalum capacitor in parallel with a 0.1µF ceramic capacitor at rated line voltage and load ranges.

GENERAL SPECIFICATIONS

Switching Frequency ..... 133 kHz typical  
 Power Factor ..... 0.98 typical, with active PFC  
 Efficiency ..... 87% typical @ 115 VAC,  
 89% typical @ 230 VAC  
 Hold-up Time ..... 10 ms min. @ 120 VAC  
 Operating Altitude ..... 5,000 meters max.  
 Line Regulation ..... ±0.5% max. @ full load  
 Operating Temperature ..... 0°C to +70°C  
 Derating ..... Derate from 100% @ +50°C  
 linearly to 50% @ +70°C,  
 applicable to convection and  
 forced-air cooling conditions  
 Storage Temperature ..... -40°C to +85°C  
 Relative Humidity ..... 5% to 95% non-condensing  
 Withstand Voltage ..... 4,000 VAC, input-output (2 MOPP)  
 1,500 VAC, input-ground (1 MOPP)  
 1,500 VAC, output-ground  
 MTBF ..... 250 kHrs minimum at full load,  
 25°C ambient, calculated per  
 MIL-HDBK-217F

STANDARDS & COMPLIANCES

EN55011, EN55022 ..... Class B conducted, Class A radiated  
 FCC ..... Class B conducted, Class A radiated  
 VCCI ..... Class B conducted, Class A radiated  
 EN61000-3-2 ..... Harmonic distortion, Class A & D  
 EN61000-3-3 ..... Line flicker  
 EN61000-4-2 ..... ESD, ±8 KV air and ±6 KV contact  
 EN61000-4-3 ..... Radiated immunity, 3V/m  
 EN61000-4-4 ..... Fast transient/burst, ±2 KV  
 EN61000-4-5 ..... Surge, ±1 KV diff., ±2 KV com.  
 EN61000-4-6 ..... Conducted immunity, 3 Vrms  
 EN61000-4-8 ..... Magnetic field immunity, 3A/m  
 EN61000-4-11 ..... Voltage dips immunity,  
 30% reduction for 500ms,  
 60% reduction for 100ms,  
 >95% reduction for 10ms  
 Safety Standards ..... IEC/EN 60601-1 (3<sup>rd</sup> Edition),  
 ANSI/AAMI ES 60601-1:2005,  
 CSA C22.2 No. 60601-1:08;  
 UL/IEC/EN 60950-1 (2<sup>nd</sup> Edition),  
 CSA C22.2 No. 60950-1 (2<sup>nd</sup> Edition)  
 Agency Approvals ..... UL, cUL, TUV, CB, CE  
 Other Compliance ..... RoHS

### MECHANICAL SPECIFICATIONS

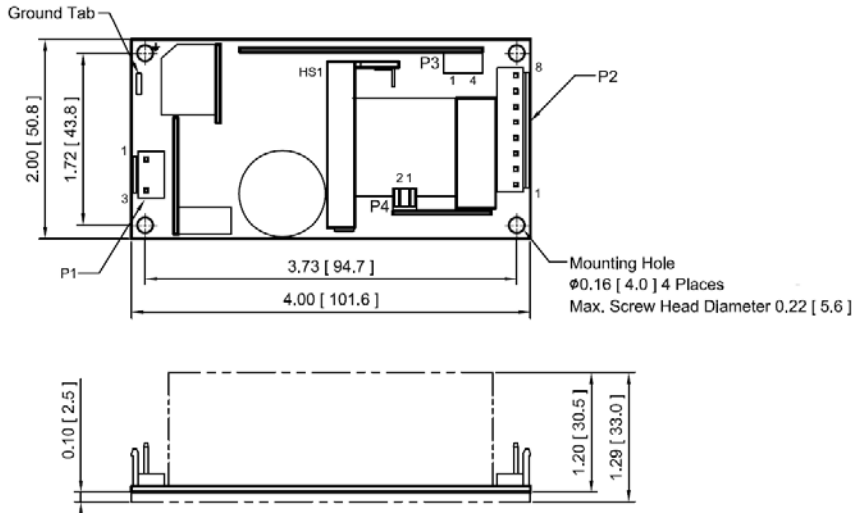

#### Notes:

1. Dimensions: inches [mm]
2. Tolerance: 0.02 [0.5] maximum
3. Connector P1: JST header P/N B3P-VH, mating with JST housing P/N VHR-3N or equivalent.
4. Connector P2: JST header P/N: B8P-VH, mating with JST housing P/N VHR-8N or equivalent.
5. Connector P3: JST header B4B-PH-K-S (LF) (SN), mating with JST housing PHR-4 or equivalent.
6. Connector P4: JST header B2B-PH-K-S (LF) (SN), mating with JST housing PHR-2 or equivalent.
7. Ground Tab: 0.25 [6.35] x 0.032 [0.8] faston connector.
8. Weight: 200 grams (0.44 lb.) approx.

### INPUT & OUTPUT CONNECTORS

CONNECTOR	PIN	FUNCTION
P1	1	AC Neutral
	2	Void
	3	AC Live
P2	1	Common Return
	2	
	3	
	4	
	5	+Vout
	6	
	7	
	8	
P3	1	Common Return
	2	PFD (Optional)
	3	-V Sense
	4	+V Sense
P4	1	Fan Return (Isolated)
	2	+12V DC Fan 0.5A Max.