

THIS DOCUMENT IS THE PROPERTY OF KEYSTONE ELECTRONICS CORP. AND SHALL NOT BE REPRODUCED, DISTRIBUTED OR USED AS A BASIS FOR MANUFACTURE WITHOUT PRIOR WRITTEN PERMISSION FROM KEYSTONE ELECTRONICS CORP.

MOUNTING DETAIL

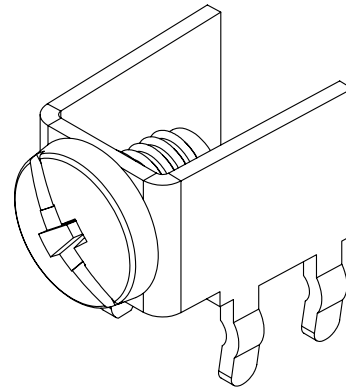

M4 x 0.7 x 6.35 L
CAPTIVE SCREW

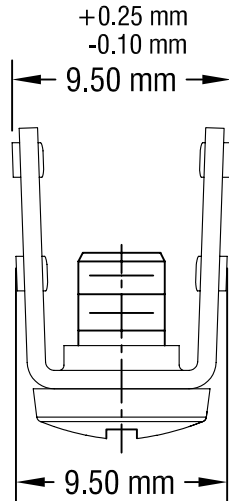
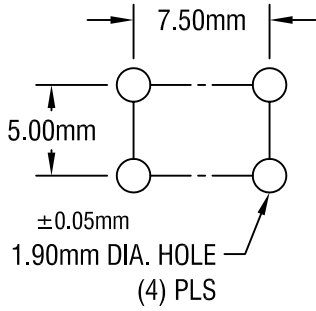
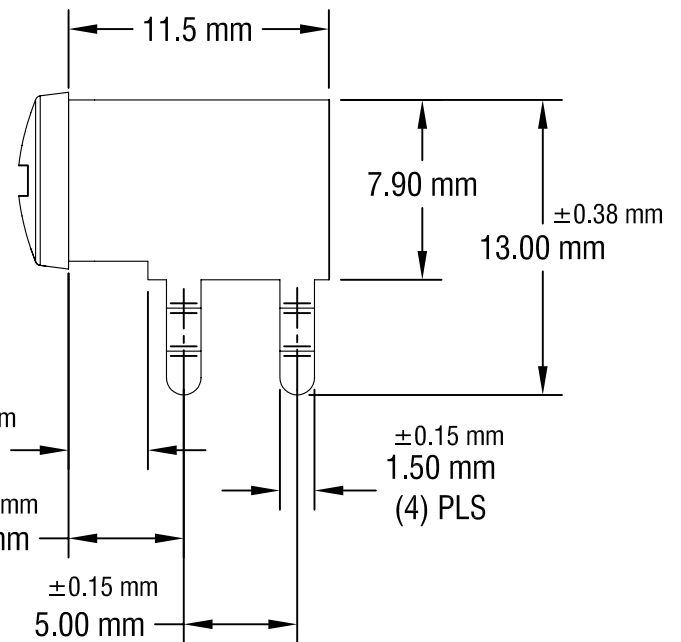
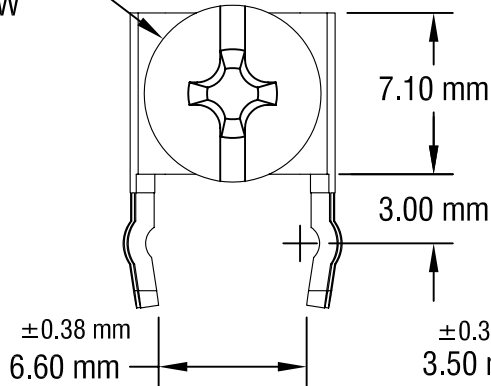

NOTE:

1. TERMINAL:

MAT'L - 0.81mm TH'K BRASS, TIN PLATE

SCREW : ONE (1) M4 x 0.7 x 6.35mm L.

MAT'L - BRASS, NICKEL PLATE

2. ALL DIMENSIONS ARE IN MILLIMETERS.

KEYSTONE ELECTRONICS CORP.

www.keyelco.com • ASTORIA, N.Y. 11105-2017 • Tel (718) 956-8900

PART NAME

PC METRIC SCREW TERMINAL WITH SCREW

MATERIAL

AS NOTED

FINISH

AS NOTED

DRN BY

NT

DATE

7.03.08

APP'D

LN

SCALE

3X

11.18.08

CHANGE AS PER ECN 08-181

A

TOLERANCES

INCH [MM]

CODE

DWG NO.

DECIMAL

± [± .025]

C

ANGULAR ± 1°

UNLESS OTHERWISE SPECIFIED

7794

DATE

DESCRIPTION

REV.