

Rev	AWO #	Description	Date	Appr
-		RELEASED	1/4/11	

APPROVED: \_\_\_\_\_  
 DATE: \_\_\_\_\_ TITLE: \_\_\_\_\_

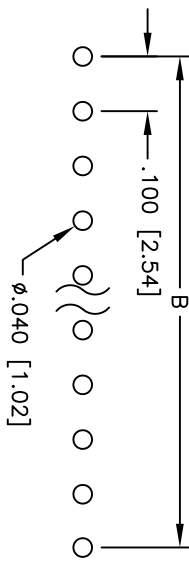

RECOMMENDED  
PCB LAYOUT

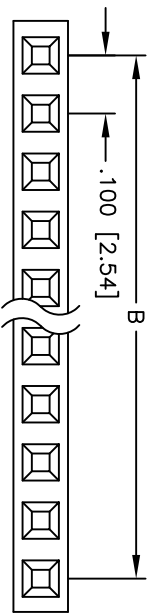
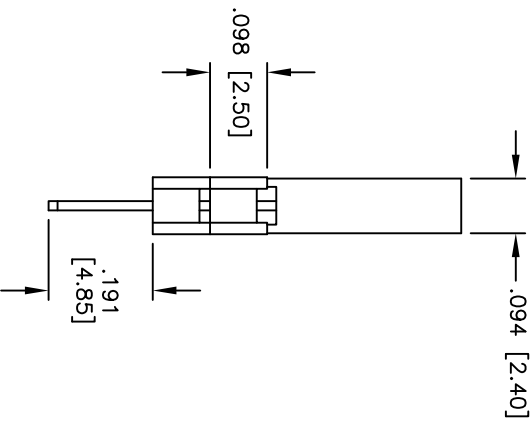
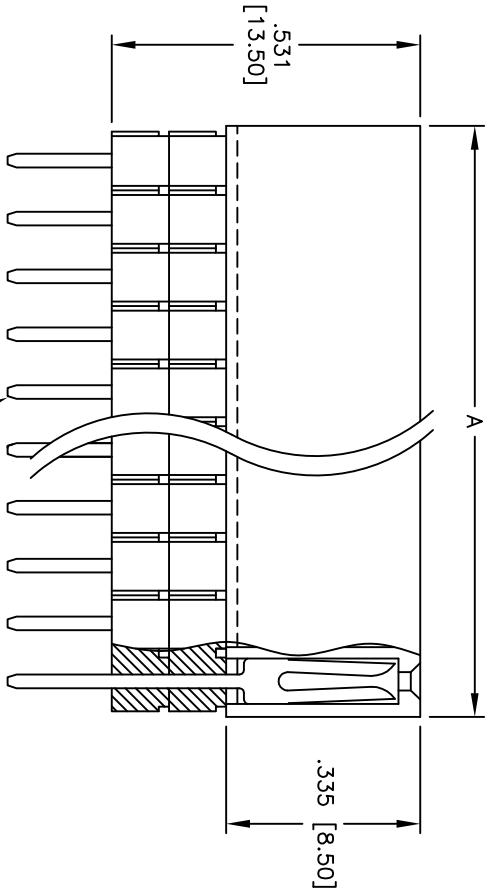

SPECIFICATIONS:  
 Material: PBT, glass reinforced, rated UL 94V-0  
 Insulator color: Black  
 Contacts: Brass  
 Plating: Gold flash over Nickel underplate overall

Electrical:  
 Operating voltage: 250 VAC max.  
 Current rating: 3 Amps max.  
 Contact resistance: 20 mohms max. initial  
 Insulation resistance: 5,000 Mohms min.  
 Dielectric withstanding voltage: 1,000 VAC for 1 minute

Temperature Rating:  
 Operating temperature: -40°C to +105°C  
 Environmental:  
 Lead free, RoHS compliant  
 Recommended soldering temp: 235°C for 5 seconds

Positions: 01 thru 40  
 A = .100 [2.54] x No. of Positions + .020 [0.50]  
 B = .100 [2.54] x No. of Spaces

**ADAM TECH**

909 Railway Avenue, Union, NJ 07083  
 Phone: 908-687-5000 Fax: 908-687-5710

TITLE  
 .100 [2.54] SINGLE ROW RECEPTACLE STRIP  
 ELEVATED SOCKET, 2 INSULATORS

UNLESS OTHERWISE SPECIFIED ALL DIMENSIONS ARE INCHES [MM]		TOLERANCES: EXCEPT AS NOTED	
.X	± .10	ØXX	± .10
.XX	± .020	ØXXX	± .015
.XXX	± .015	ØXXXX	± .010
APPROVALS			
DRAWN	AY	DATE	1/4/11
CHECKED	VW	DATE	1/4/11
APPROVED		DATE	

SIZE PART NO. RSE1-2-XX-G-191

REF: S00039T SCALE: NTS SHEET 1 OF 1

