

Rev	AWO #	Description	Date	Appr
-		RELEASED	8/24/10	

APPROVED: _____
 DATE: _____ TITLE: _____

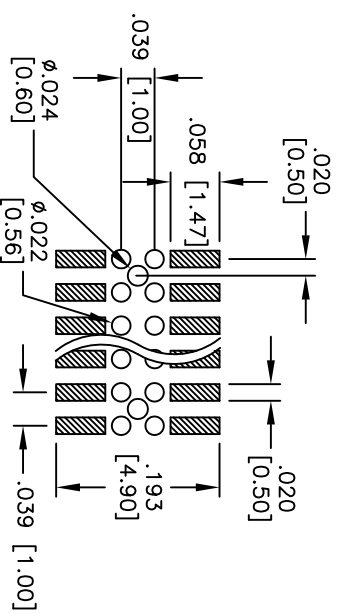

RECOMMENDED PCB LAYOUT
(FOR BOTTOM ENTRY)

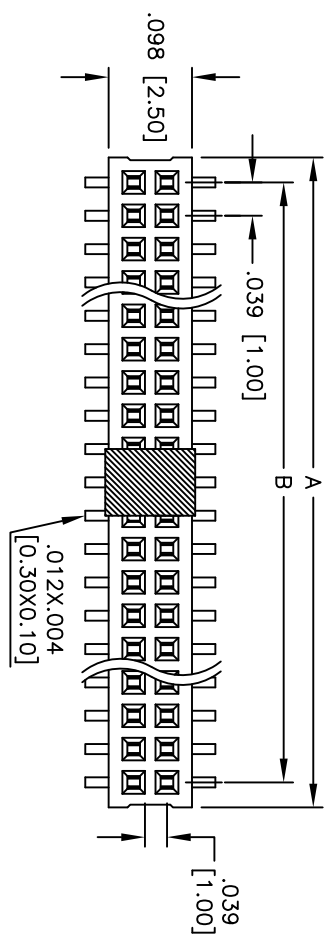
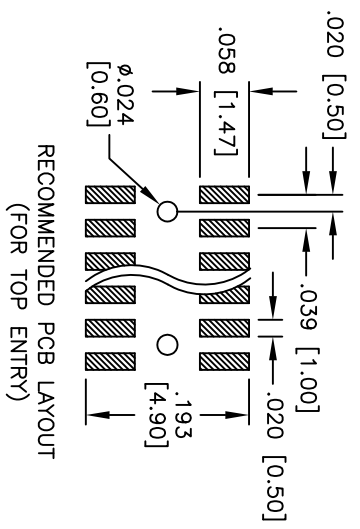
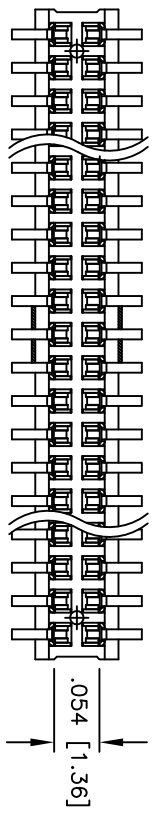
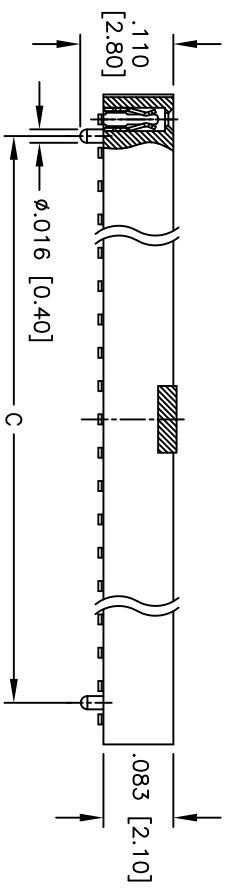

RECOMMENDED PCB LAYOUT
(FOR TOP ENTRY)

PACKAGED ON TAPE & REEL

Positions: 8 thru 100
 A = .039 [1.00] x No. of Positions Per Row + .020 [0.50]
 B = .039 [1.00] x No. of Spaces
 C = .039 [1.00] x No. of Spaces - .039 [1.00]

ADAM TECH

909 Railway Avenue, Union, NJ 07083
 Phone: 908-687-5000 Fax: 908-687-5710

TITLE: .039 [1.00] DUAL ROW FEMALE MICRO HEADER
 GOLD PLATED, SURFACE MOUNT

SPECIFICATIONS:
 Material: Insulator: Hi-temp thermoplastic, rated UL 94V-0
 Insulator color: Black
 Contacts: Phosphor Bronze
 Plating: Gold Flash over Nickel underplate overall.
 Electrical:
 Current rating: 1 Amp max.
 Contact resistance: 20 mohms max.
 Insulation resistance: 500 Mohms min.
 Dielectric withstanding voltage: 200 VAC for 1 minute
 Temperature Rating:
 Operating temperature: -40°C to +105°C
 Environmental:
 Lead free, RoHS compliant
 Recommended soldering temp: 260°C for 5 seconds



UNLESS OTHERWISE SPECIFIED ALL DIMENSIONS ARE IN INCHES [MM]		TOLERANCES: EXCEPT AS NOTED	
INCHES		HOLDS	
.X	± .10	ØX	± .10
.XX	± .020	ØXXX	± .015
.XXX	± .015	ØXXXX	± .010
APPROVALS		DATE	
DRAWN	DRY	8/24/10	
CHECKED			
APPROVED			
SIZE	PART NO.	REF:	SHEET 1 OF 1
X	MRS2-A-XX-U-SMT-P-PP-T/R	S00032T	
SCALE:	N/A		