

# High Voltage Diodes - Surface Mount

150mA - 500mA • 70ns

## ELECTRICAL CHARACTERISTICS AND MAXIMUM RATINGS

| Part Number | Working Reverse Voltage<br>(V <sub>rwm</sub> ) | Average Rectified Current<br>(I <sub>o</sub> ) |          | Reverse Current @ V <sub>rwm</sub><br>(I <sub>r</sub> ) |       | Forward Voltage<br>(V <sub>f</sub> ) |       | 1 Cycle Surge Current<br>t <sub>p</sub> =8.3ms<br>(I <sub>fsm</sub> ) | Repetitive Surge Current<br>(I <sub>frm</sub> ) | Reverse Recovery Time<br>(3)<br>(T <sub>rr</sub> ) | Thermal Impd.<br>θ <sub>J-L</sub> | Junction Cap.<br>@50VDC<br>@1kHz<br>(C <sub>j</sub> ) | Markings |
|-------------|--|--|----------|---|-------|--------------------------------------|-------|---|---|--|-----------------------------------|---|----------|
|             |  | 55°C(1)  | 100°C(2) | 25°C  | 100°C | 25°C                                 | 25°C  | 25°C  | 25°C  | 25°C   | 25°C                              | 25°C  |          |
|             |  | Volts  | mA       | mA  | µA    | µA                                   | Volts | mA  | Amps  | Amps   | ns                                | °C/W  |          |
| SXF6521     | 2000   | 500  | 250      | 0.5   | 20    | 3.0                                  | 500   | 25  | 5   | 70   | 7.0                               | 8.0   | 6521     |
| SXF6523     | 3000   | 250  | 125      | 0.5   | 20    | 5.0                                  | 250   | 15  | 3   | 70   | 7.0                               | 4.0   | 6523     |
| SXF6525     | 5000   | 150  | 75       | 0.5   | 20    | 7.0                                  | 150   | 10  | 2   | 70   | 7.0                               | 3.0   | 6525     |

(1)TC=55°C (2)TC=100°C (3)I<sub>f</sub>=125mA, I<sub>r</sub>=250mA, I<sub>rr</sub>=63mA \*Op. Temp.= -65°C to +175°C Stg. Temp.= -65°C to +200°C



| Part               | A                         | B                         | C              |
|--------------------|---------------------------|---------------------------|----------------|
| SXF6521            | .240 ±.010<br>(6.10 ±.25) | .200 ±.005<br>(5.08 ±.13) | .130<br>(3.30) |
| SXF6523<br>SXF6525 | .280 ±.010<br>(7.11 ±.25) | .240 ±.005<br>(6.10 ±.13) | .170<br>(4.32) |

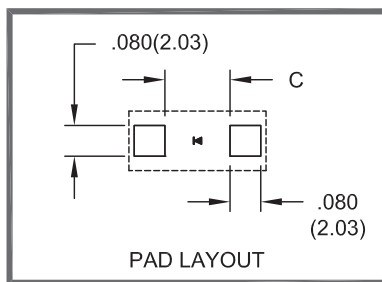

Tolerance:  
.XXX ±.005

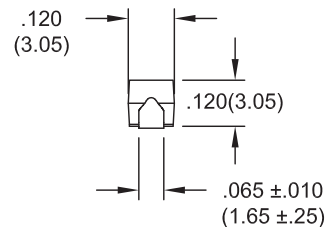
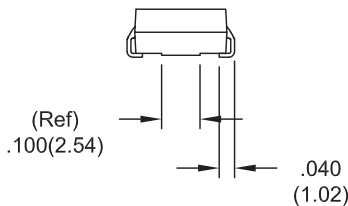
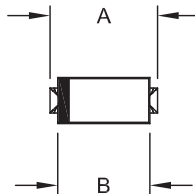

Dimensions: In. (mm) • All temperatures are ambient unless otherwise noted. • Data subject to change without notice.



Voltage Multipliers Inc.

8711 W. Roosevelt Ave.  
Visalia, CA 93291 USA

Tel: 559.651.1402  
Fax: 559.651.0740

[www.voltagemultipliers.com](http://www.voltagemultipliers.com)  
[www.highvoltagepowersupplies.com](http://www.highvoltagepowersupplies.com)

# SXF6521 SXF6523 SXF6525

1

