



SW12550E(12V55AH)



Specifications

Nominal Voltage	12V	
Rated capacity (10hour rate)	55 Ah	
Dimensions	Total Height	229 mm (9.02 inches)
	Height	211 mm (8.31 inches)
	Length	230 mm (9.10 inches)
	Width	138 mm (5.43 inches)
Weight Approx	18.0 Kg (39.6 lbs)	

Characteristics

Capacity 25°C(77°F)	10 hour rate(5.5A)	55.0 AH
	5 hour rate(8.8A)	44.0 AH
	1 hour rate(30.3A)	30.3 AH
Internal Resistance	1.5 hour discharge to 10.5V	22 A
	Full charged Battery at 25°C(77°F)	6 mΩ
Capacity affected by Temperature (10hour rate)	40°C(104°F)	102%
	25°C(77°F)	100%
	0°C(32°F)	85%
	-15°C(5°F)	65%
Self-Discharge at 25°C(77°F)	Capacity after 3 month storage	91%
	Capacity after 6 month storage	82%
	Capacity after 12 month storage	64%
Terminal	T9, T16	
Charge (constant Voltage)	Cycle	Initial Charging Current less than 13.75 A Voltage 14.10-14.40V
	Float	Voltage 13.50-13.80V

Outer dimensions (mm)

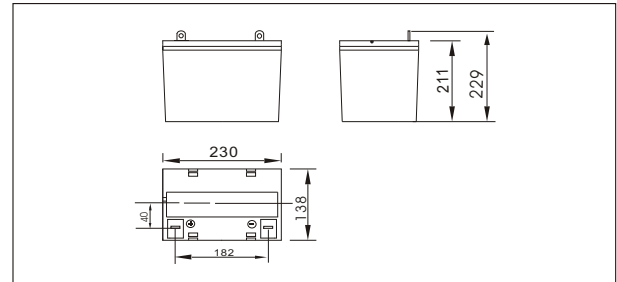

Terminal Type (mm)

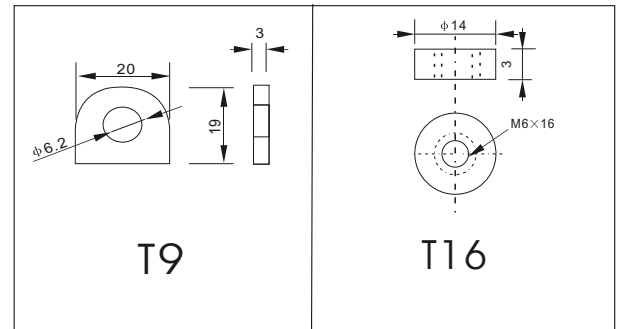

Discharge Curves 25°C(77°F)

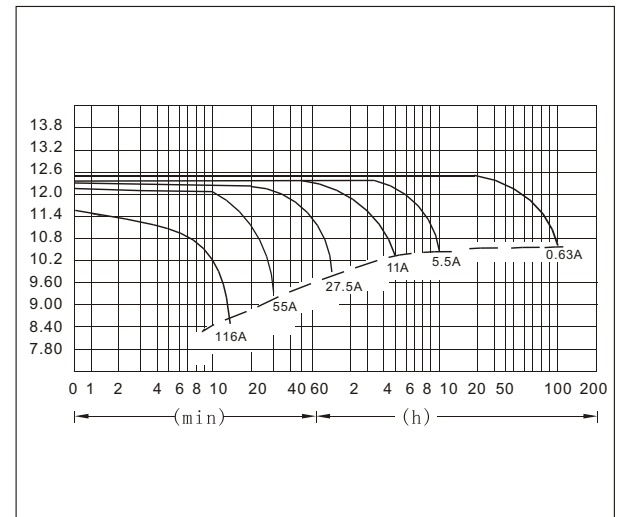

Constant Current(Amp) and Constant Power(Watt) Discharge Table at 25°C(77°F)

Time	10min	30min	1h	3h	4h	5h	8h	10h	20h	50h	100h	
9.60V	A	116	63	33	14.1	11.0	9.1	6.4	5.8	3.12	1.30	0.67
	W	1289	672	382	164	127	105	74	67	36.1	15.5	7.9
10.20V	A	113	61	31.0	13.8	10.7	8.9	6.3	5.6	3.04	1.25	0.65
	W	1239	665	359	159	124	103	72	65	35.2	14.9	7.7
10.50V	A	108	58	30	13.4	10.6	8.8	6.2	5.5	3.00	1.23	0.63
	W	1201	628	348	155	122	102	72	64	34.8	14.7	7.5
10.80V	A	101	56	29	13.1	10.4	8.6	6.1	5.4	2.97	1.21	0.63
	W	1154	604	333	152	120	100	70	64	34.6	14.4	7.5
11.10V	A	92	52	27	12.7	10.1	8.4	5.9	5.23	2.82	1.19	0.61
	W	1135	600	324	151	119	99	70	62	33.6	14.1	7.2