

Metal Core SMD Power Inductors (MCOIL(TM) MD series)

MDKK2020T150MM

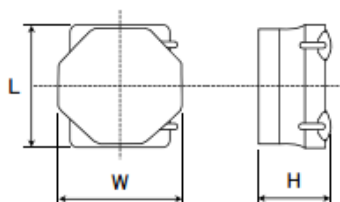

■ Features

- Item Summary
15 μ H(\pm 20%), 550mA, 480mA
- Lifecycle Stage
Mass Production
- Standard packaging quantity (minimum)
Taping 2500pcs

■ Products characteristics table

| | |
|---|------------------------|
| CaseSize (EIA/JIS) | -/2020 |
| Inductance | 15 μ H(\pm 20%) |
| Inductance Measuring Frequency | 1MHz |
| Rated Current -Saturation Current | 550mA |
| Rated Current -Temperature Rise Current | 480mA |
| DC Resistance (max) | 1.18 Ω |
| Avg. of DC Resistance | 1.02 Ω |
| RoHS Compliance | Yes |
| Halogen Free | Yes |
| Soldering Method | Reflow |

■ External Dimensions

| | |
|---|----------------|
| L | 2mm \pm 0.15 |
| W | 2mm \pm 0.15 |
| H | 1mm max |

■ Recommended Land Patterns

【推奨ランドパターン】
実装上の注意
・実装仕様を確認の上ご使用ください。よろしくお願いたします。
・本製品のはんだ付けはリフローはんだ工法に限ります。

【Recommended Land Pattern】
Surface Mounting
*Mounting and soldering conditions should be checked beforehand.
*Applicable soldering process to these products is reflow soldering only.

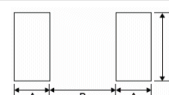

Metal Core SMD Power Inductors (MCOIL_W, MD series)

| Type | A | B | C |
|------|------|------|------|
| 1616 | 0.50 | 0.60 | 1.65 |
| 2020 | 0.65 | 0.70 | 2.00 |
| 3030 | 0.80 | 1.40 | 2.70 |
| 4040 | 1.20 | 1.60 | 3.70 |
| 5050 | 1.50 | 2.10 | 4.00 |

unit:mm

2015.02.25

The data is reference only. Electrical characteristics vary depending on environment or measurement condition.
TAIYO YUDEN reserves the right to make change to the Date at any time without notice.
Before making final selection, please check product specification.