

SD

1205-77-7 (SHT 1 OF 2)

## REVISIONS

ISSUE	CHANGES
0	ER 38383 HVN 08/17/01
1	CN 38437 E TML 12/06/01
2	CN 39971 C DRK 06/18/07

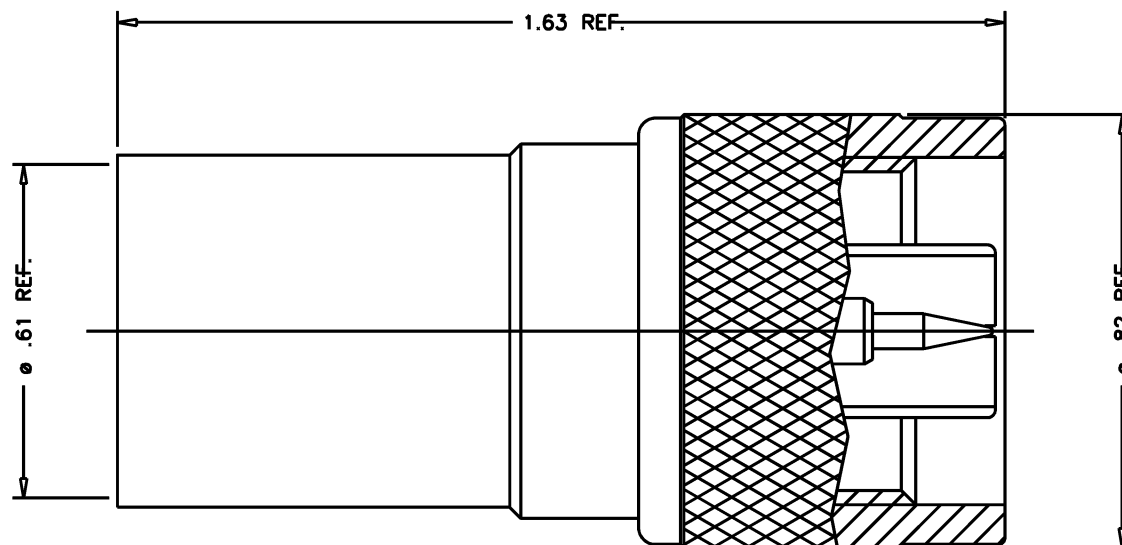

STAMP: BELDEN NM600  
YRWK(DATE CODE)

## NOTES:

- FOR USE WITH BELDEN RF 600 CABLE.
- FOR CABLING INSTRUCTIONS SEE 3-781.
- FOR CRIMPING USE DIE CD600 OR KTH-2288.
- INTERFACE PER MIL-STD-348, FIG. 304-1.
- CRIMP SLEEVE AND CENTER CONTACT TO BE SUPPLIED UNASSEMBLED.
- MATERIALS:

INSULATOR: TEFLON, ASTM-D4894.  
GASKET: SILICONE RUBBER, A-A-59588.  
K-GRIP SLEEVE: COMMERCIAL BRONZE, ASTM-B140.  
C-RING: PHOSPHOR BRONZE, ASTM-B103.  
OUTER CONTACT: BER. COP., ASTM-B196.  
ALL OTHER METAL PARTS: BRASS, ASTM-B16.

## 7. FINISHES:

CENTER CONTACT: GOLD PLATE, ASTM-B488.  
OUTER CONTACT: SILVER PLATE, ASTM-B700.  
ALL OTHER METAL PARTS: NICKEL.

## 8. ELECTRICAL CHARACTERISTICS:

NOMINAL IMPEDANCE: 50 OHMS.  
WORKING VOLTAGE: 1000 VRMS.  
FREQUENCY RANGE: DC TO 11 GHZ.

SCALE 4:1

APPROX SURFACE AREA

BELDEN ONLY

USED ON

REF: EOR 933

PLUG, N

DRAWN DRK DATE 07/02/07

DESIGN HVN DATE 12/20/00

APPR. DATE

A Winchester Electronics Company

1205-77-7 (SHT 1 OF 2)

SD