

8	7	6	5	4	3	2	1
---	---	---	---	---	---	---	---

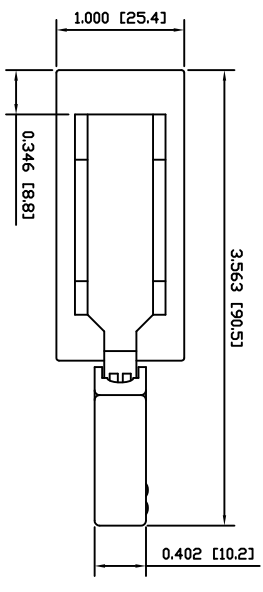

COLORS

BODY:
Black

ACTUATOR:
Black

LOOK:
None

SPECIFICATIONS

FUNCTION:
2P1T OFF-(ON)

RATINGS:
24A 125VAC
12A 250VAC
2HP 125/250VAC

OPERATING FORCE:
2.0kgf±0.5kgf at Highest Point

ELECTRICAL LIFE:
50,000 Cycles

TEMPERATURE:
Operating: 0°C to 55°C

APPROVALS:
RoHS
COMPLIANT

MATERIALS

LOWER BODY:
Phenolic (FR), UL94 V-0

UPPER BODY:
Polyamide 6/6 (PA66), UL94 V-0

ACTUATOR:
Polyamide 6/6 (PA66), UL94 V-0

ACTUATOR RIVET:
Copper

ACTUATOR LINK:
Polyamide 6/6 (PA66), UL94 V-0

PLATE:
Polyamide 6/6 (PA66), UL94 V-0

SEAL:
Nitrile Butadiene Rubber (NBR), UL94 V-0

CONTACT HOLDER:
Polyamide 6/6 (PA66), UL94 V-0

MAIN SPRING:
Steel

SLIDERS:
Steel

MOBILE CONTACTS:
Silver Plated Brass

CONTACT SPRINGS:
Steel

CONTACTS:
Silver Alloy Clad Copper

TERMINALS:
Silver Polished Brass

TERMINAL SCREWS:
Steel

TERMINAL HARDWARE:
Steel

GREASE:
Silicone Based Grease

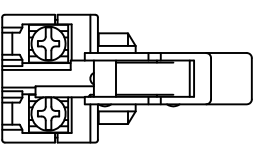
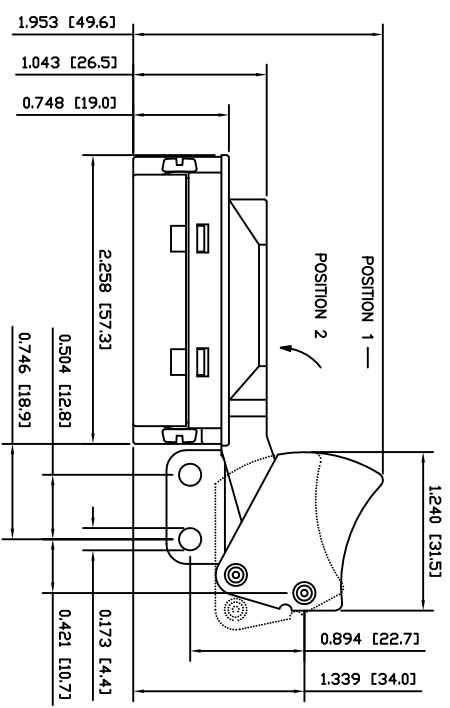

SCHEMATIC

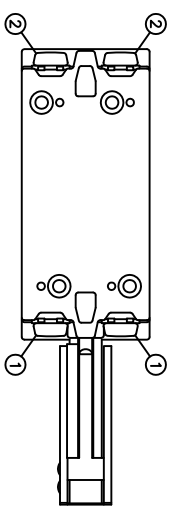
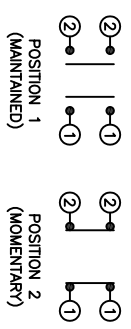

E SWITCH

LAMB INDUSTRIES

HY38-6E8-021-000

THE INFORMATION CONTAINED IN THIS DOCUMENT IS PROPRIETARY TO E-SWITCH AND IS NOT TO BE COPIED OR TRANSMITTED		A	INITIAL RELEASE DESCRIPTION	21298	11/26/13	EPB	SCALE	THERM NUMBER	DATE	REVISION
8	7	6	5	4	3	2	±0.012 [±0.3] / ±.1"	34-HY386E8021000	NOVEMBER 8, 2013	A