

## My-Com precision switches

## MY-COM D250/S35

## dimension drawing

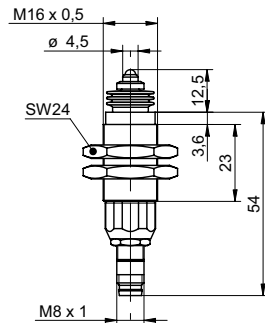

## general data

repeat accuracy	< 0,001 mm
activating force	250 cN
mech. pre-run / overrun	1 mm / 1 mm approx.
measurement type	contact with medium
direction of approach	frontal and lateral approach

## electrical data

DC voltage max.	15 VDC
switch. current DC max.	2 mA
AC voltage max.	24 VAC
switch. current AC max.	50 mA
output circuit	break function (NC) mechanical

## mechanical data

activating pin	hardened steel
housing material	browned brass
dimension	16 mm
type	cylindrical threaded
housing length	66 mm
connection types	connector M8

## ambient conditions

operating temperature	-20 ... +75 °C
protection class	IP 67

## photo



## connection diagram

