

25mm [0.98in] 25mm [0.98in]

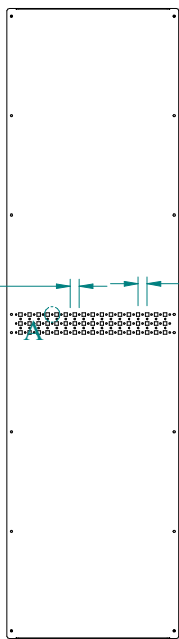

REAR VIEW

23mm [0.9in]

L.S VIEW

423mm [16.65in]

TOP VIEW

475mm [18.7in]

872mm [34.31in]

1743mm [68.63in]

FRONT VIEW

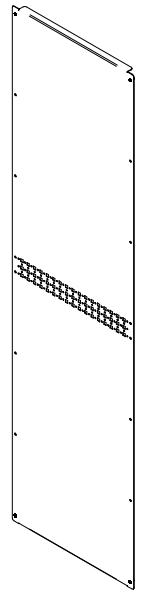

ISOMETRIC VIEW

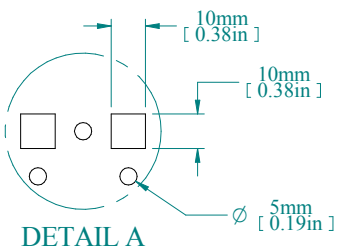

DETAIL A

PART NUMBERS	
HSIP206	14 GAUGE GALVANIZED STEEL

NOTES
Unpainted Allows installation of 19" mounting rails including center support Hammond Website for Additional Accessories

Data subject to change without notice. Isometric drawing not to scale.



**HAMMOND
MANUFACTURING™**

www.hammondmfg.com

PART NO. HSIP206