

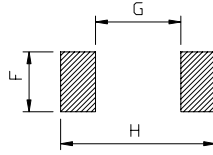

## DELTA P/N : MPT1045-H1 Series

### Mechanical dimensions

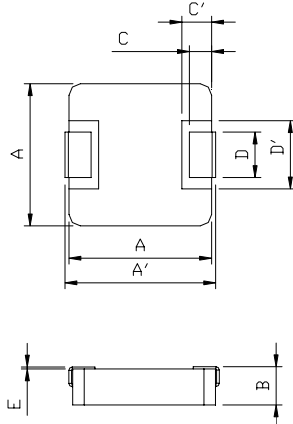

Unit : mm		
	1R0	2R2 / 3R3 / 4R7 5R6 / 6R8
A'	11.15 ± 0.35	10.85 ± 0.35
A	10 ± 0.3	
B	4.3 ± 0.2	
C	2.0 ± 0.5	
C'	2.5 ± 0.1	
D	3.0 ± 0.5	
D'	5.0 ± 0.2	
E	0~0.15	
F	4.1	
G	5.4	
H	13.6	

### Electrical Characteristics

Part No.	Lo @0A (uH) ± 20%	Ir(Adc)	Isat(Adc)	DCR (mΩ)	
				TYP.	MAX
MPT1045-1R0H1	1.0	22.0	34.0	2.7	3.2
MPT1045-2R2H1	2.2	14.0	16.0	5.8	7.0
MPT1045-3R3H1	3.3	11.0	14.5	11.0	13.2
MPT1045-4R7H1	4.7	10.0	13.0	13.2	15.0
MPT1045-5R6H1	5.6	8.5	10.5	16.0	18.5
MPT1045-6R8H1	6.8	7.5	9.5	21.5	24.0

#### NOTES:

- (1) All test data is referenced to 25°C ambient.
- (2) Ir is the DC current which cause the surface temperature of the part increase approximate 40°C
- (3) Isat is the DC current which cause the inductance drop approximate 30% of Lo.
- (4) Operating temperature range -55°C to 125°C. (The part temperature should be kepted under 125°C when the worse operating condition apply on it. Circuit design, component placement, PWB tracesize and thickness, airflow and other cooling provision may affect the part temperature. Part temperature should be verified in the end application.)
- (5) The rated current is depended on Ir and Isat which one is lower.