

RECOMMEND P.C.B. LAYOUT

PANEL THICKNESS	X
0.75-1.25 (0.030-.049)	19.2 (0.756)
1.25-2.0 (0.049-.079)	19.4 (0.764)
2.0-3.0 (0.079-.118)	19.8 (0.780)

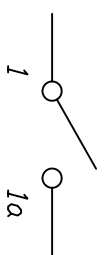
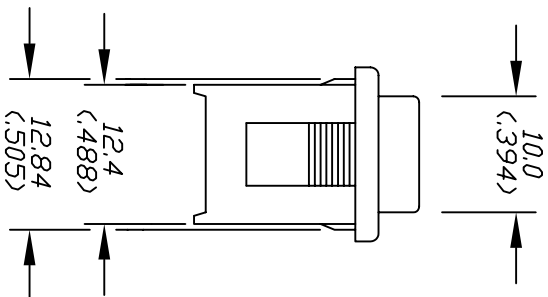

CIRCUIT: SPST
CONTACT CONFIGURATION

NOTES:

1. ALL DIMENSIONS IN MM (INCH)
2. GENERAL TOLERANCE: 0.0=±0.4
0.00=±0.25
3. TERM. NOS. FOR REF. ONLY
4. RATING: 15A 125VAC; 6A 250VAC

A	10624	RELEASED FOR PRODUCTION	5/11/00	MM
REV.	ECN No.	DESCRIPTION	DATE	CHKD

TITLE		R1966AWHTWHTWC - Wire Crimp		
SCALE	DATE	DR	DWG	REV
1.5:1	5/11/00	MM	M301116	A



THE INFORMATION CONTAINED IN THIS DOCUMENT IS PROPRIETARY TO E-SWITCH AND IS NOT TO BE COPIED OR TRANSFERRED