

# Control and signalling units Ø 22

Harmony® style 4  
 Pushbuttons, switches and pilot lights, with chromium plated metal bezel  
 Completed units with contacts

1

**Pushbuttons, spring return**  
 ZB4-BA● + ZB4-BZ●●● + ZBE-●●●

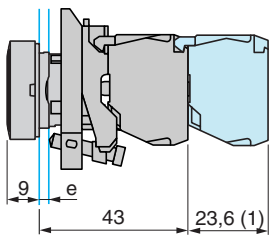

ZB4-BL● + ZB4-BZ●●●

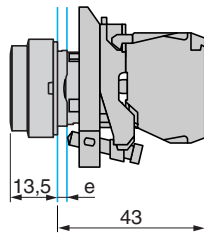

Common face view

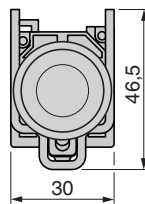

ZB4-BP● + ZB4-BZ●●●

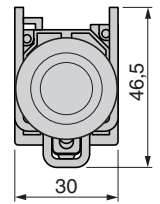
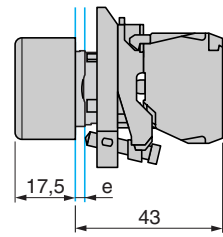

**Mushroom head pushbuttons, spring return**  
 ZB4-BC2 + ZB4-BZ●●●

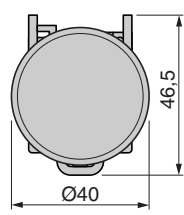
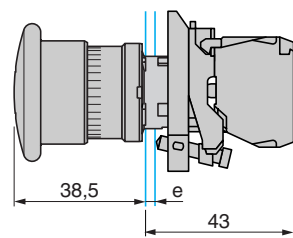

**Double-headed pushbuttons, spring return**  
 ZB4-BL●●●● + ZB4-BZ●●●

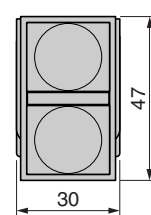
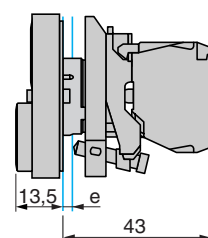

e: panel thickness 1 to 6 mm.

(1) Additional row of contacts or double contact.

**Emergency stop and mushroom head pushbuttons**

ZB4-BT4 + ZB4-BZ●●●,  
 ZB4-BT84 + ZB4-BZ●●●

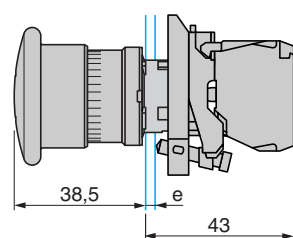

ZB4-BS54 + ZB4-BZ●●●,  
 ZB4-BS844 + ZB4-BZ●●●

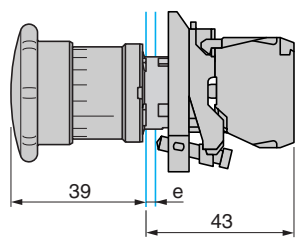

ZB4-BS514 + ZB4-BZ●●●,  
 ZB4-BS944 + ZB4-BZ●●●

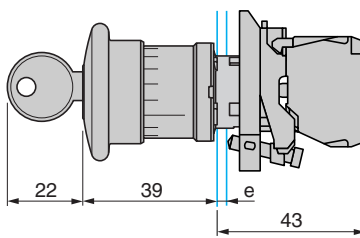

Common face view

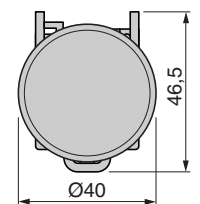

e: panel thickness 1 to 6 mm.

**Selector switches**

**Standard handle operator**  
 ZB4-BD●● + ZB4-BZ●●●

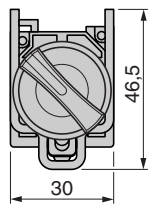
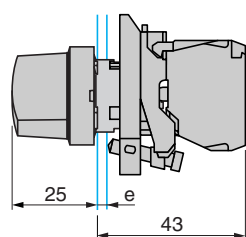

**Long handle operator**  
 ZB4-BJ●● + ZB4-BZ●●●

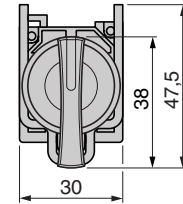
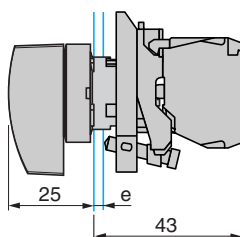

**Key switches**

ZB4-BG●● + ZB4-BZ●●●

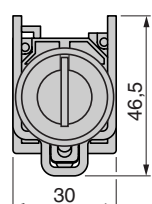
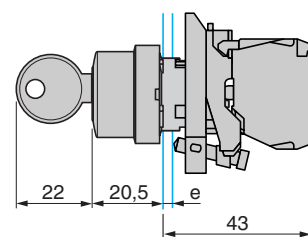

**Heads for toggle switches**

ZB4-BD●8

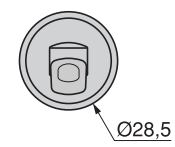
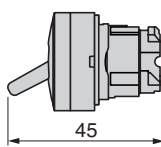

e: panel thickness 1 to 6 mm.

**General:**  
 pages 1/2 to 1/7

**Characteristics:**  
 pages 1/8 to 1/11

**References:**  
 pages 1/12 to 1/47

# Control and signalling units Ø 22

Harmony® style 4

Pushbuttons, switches and pilot lights, with chromium plated metal bezel

Completed units with light functions with and without contacts

**Pilot lights**  
Integral LED

ZB4-BVB●/BVG●/BVM● + ZB4-BV0●●

**Direct supply**

ZB4-BV6 + ZB4-BV0●

**Via integral transformer**

ZB4-BV3, 4 + ZB4-BV0●

Common face view

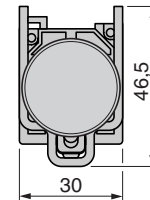
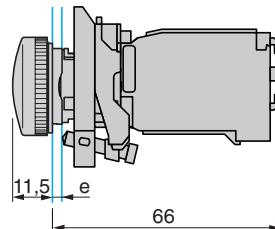
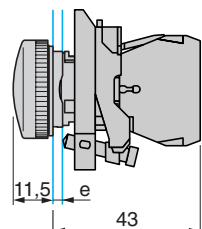
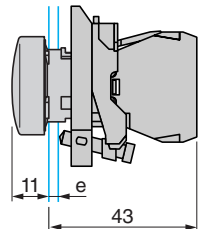

e: panel thickness 1 to 6 mm.

**Illuminated pushbuttons**

Integral LED

ZB4-BW0●●● + ZB4-BW3●●  
+ ZBE-●●●

**Direct supply**

ZB4-BW0●● + ZB4-BW3●

**Via integral transformer**

ZB4-BW0●● + ZB4-BW3●

Common face view

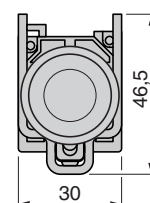
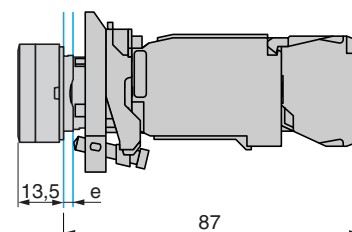
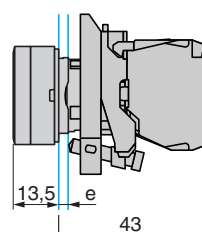
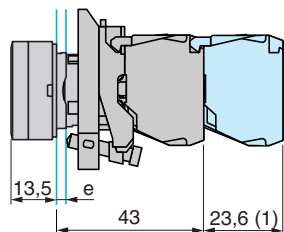

**Double-headed pushbuttons with pilot light**

Integral LED

ZB4-BW0●●● + ZB4-BW8●●●●●

**Illuminated selector switches**

Integral LED

ZB4-BK1●●● + ZB4-BW0●●●

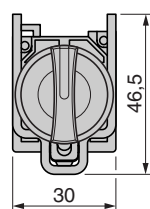
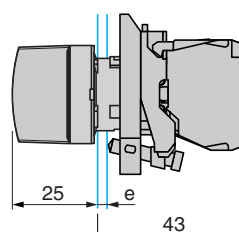
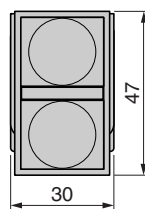
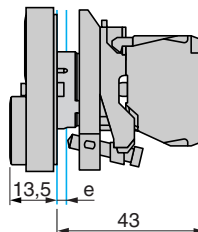

e: panel thickness 1 to 6 mm.

(1) Additional row of contacts or double contact.

**Support panel cut-out for pushbuttons, switches and pilot lights (1)**

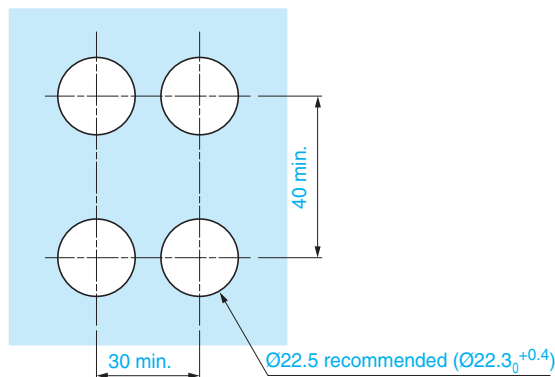

(1) Fixing centres for pushbuttons, switches and pilot lights fitted with Faston connector terminals: 32 x 45 mm.

# Control and signalling units Ø 22

Harmony® style 4  
 Pushbuttons, switches and pilot lights, with chromium plated metal bezel  
 Sub-assemblies, ZB4-B: contact functions

1

**Heads for pushbuttons, spring return**  
 ZB4-BA●, BA●●●, ZB4-BA●8

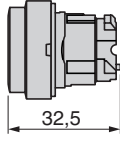
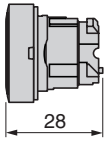

ZB4-BA●4  
 ZB4-BA●6

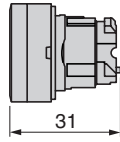

Common face view

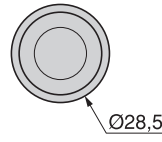

ZB4-BP●●  
 ZB4-BP●S

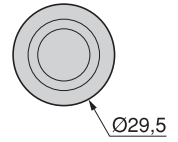
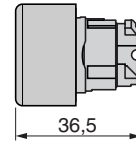

ZB4-	a
BP●●	36,5
BP●S	33

**Heads for double-headed pushbuttons, spring return**  
 ZB4-BA81●●, ZB4-BA82●●

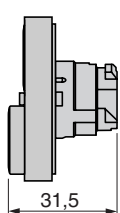
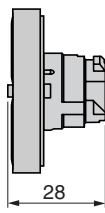

Common face view

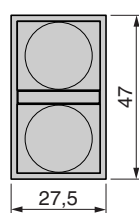

ZB4-BA91●●,  
 ZB4-BA92●●

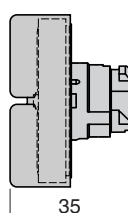

ZB4-BL93●●,  
 ZB4-BL94●●

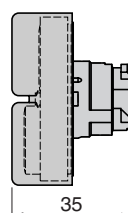

Common face view

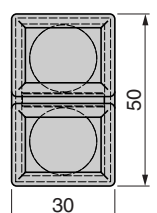

**Heads for pushbuttons "Push-push to release"**  
 ZB4-BH0●, ZB4-BH●

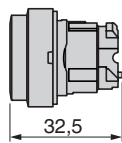
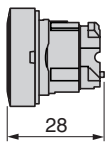

Common face view

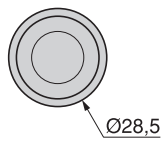

**Mushroom head**  
 ZB4-BC●4

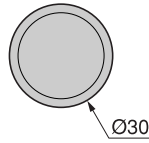
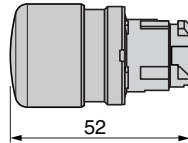

ZB4-BC●, BR●

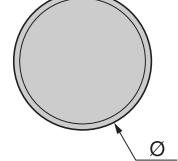
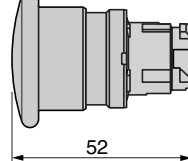

ZB4-	Ø
BC●	40
BR●	60

**Mushroom heads for pushbuttons, latching**  
 Push-pull  
 ZB4-BT●, BT●4

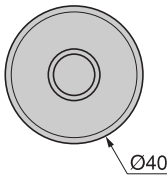
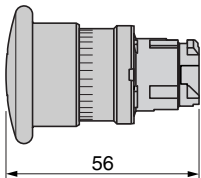

ZB4-BX2, BX4

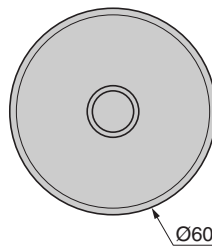
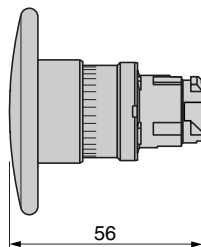

ZB4-BR●16

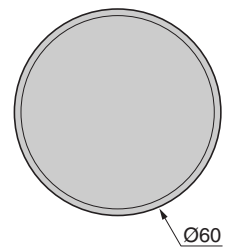
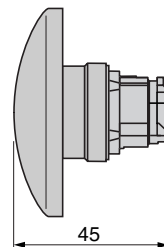

**Turn to release**  
 ZB4-BS4●, BS834

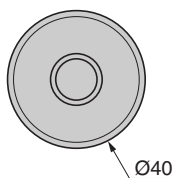
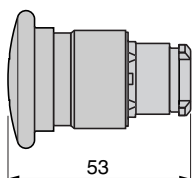

ZB4-BS5●, BS844, BS6●

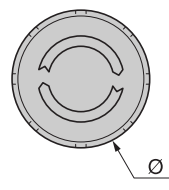
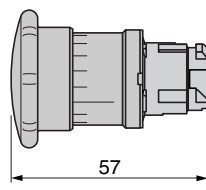

ZB4-	Ø
BS5●, BS844	40
BS6●	60

# Control and signalling units Ø 22

Harmony® style 4

Pushbuttons, switches and pilot lights, with chromium plated metal bezel

Sub-assemblies, ZB4-B: contact functions

**Mushroom heads for pushbuttons, latching (continued)**

Key release

ZB4-BS7●, BS934

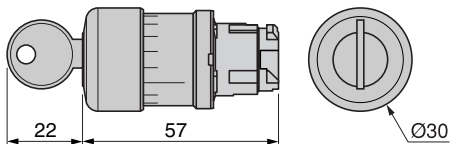

ZB4-BS1●, BS2●, BS944, BS964

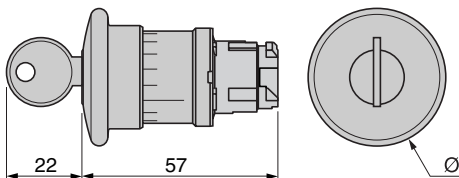

ZB4-	Ø
BS1●, BS944	40
BS2●, BS964	60

**Heads for selector switches**

Standard handle

ZB4-BD●, BD0●M



Long handle

ZB4-BJ●, BD0●M

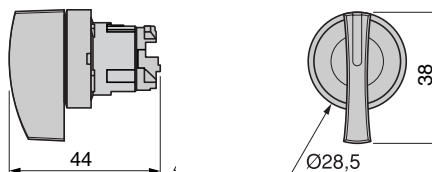

Knurled knob

ZB4-BD●9



Key switches

ZB4-BG●, BG0●, BG0●M

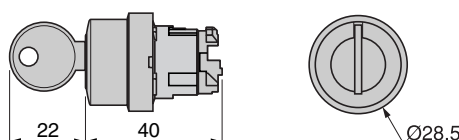

**Bodies for pushbuttons and switches**

Screw clamp terminal connections

ZB4-BZ10●, BZ141

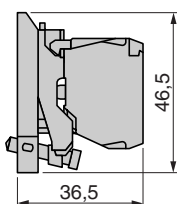

Plug-in connector

ZB4-BZ10●4, BZ1414

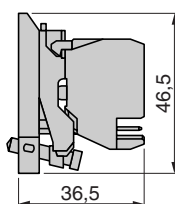

# Control and signalling units Ø 22

Harmony® style 4  
 Pushbuttons, switches and pilot lights, with chromium plated metal bezel  
 Sub-assemblies, ZB4-B: light functions with and without contacts

1

**Heads for pilot lights, with light source**

**Integral LED**  
 ZB4-BV0●3, BV0●3S

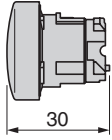

**Incandescent, neon or LED**  
 ZB4-BV0●, BV0●S

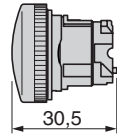

Common  
 face view

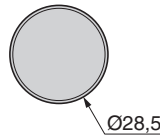

**Bodies for pilot lights, screw clamp terminal connections**

**Integral LED**  
 ZB4-BV●●

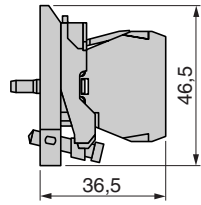

**Direct supply, for BA 9s bulb**  
 ZB4-BV6

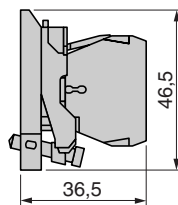

**Via integral transformer, for BA 9s bulb**  
 ZB4-BV●, BV●D●

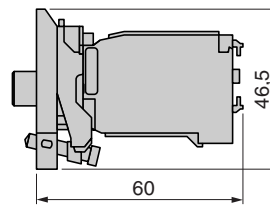

**Bodies for pilot lights, plug-in connector**

**Integral LED**  
 ZB4-BV●●4

