

SD

1203-24-9

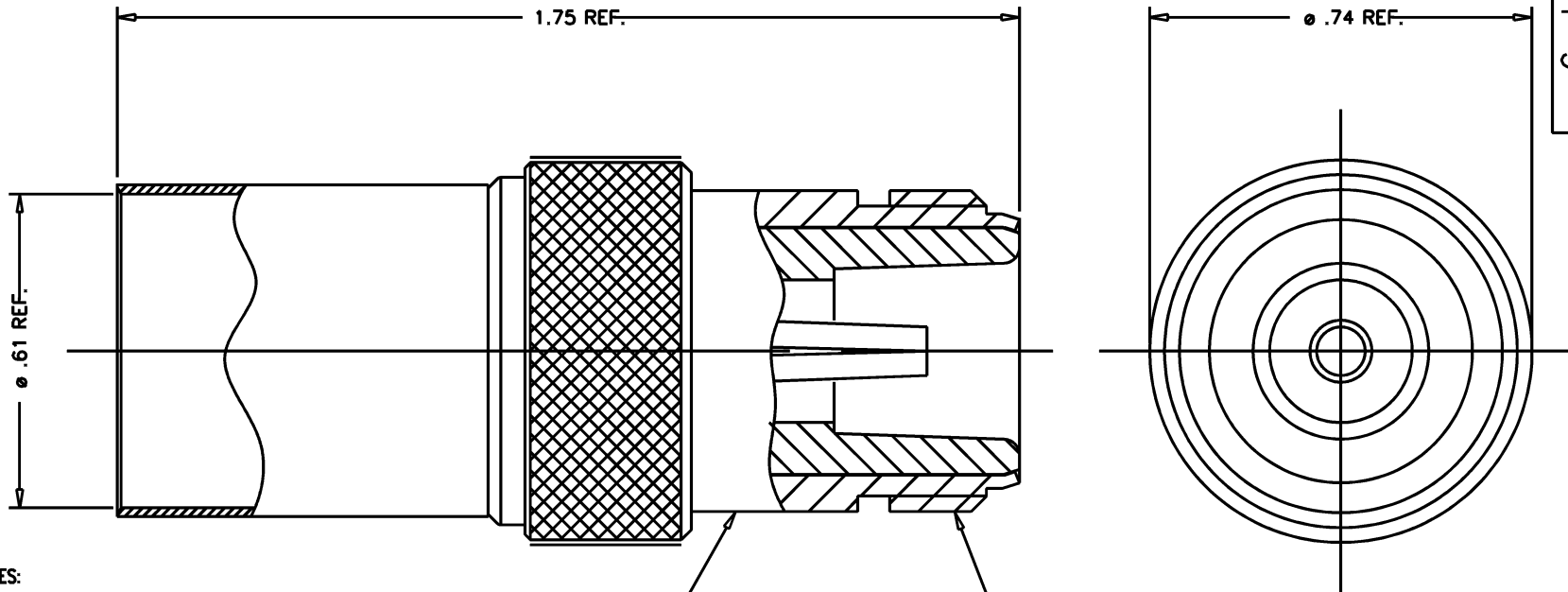

NOTES:

1. FOR USE WITH LMR 600 CABLE.
2. FOR CABLING INSTRUCTIONS SEE CP-480.
3. FOR CRIMPING USE DIE KTH-2259.
4. INTERFACE PER MIL-STD-348, FIG. 304-2.
5. CRIMPING SLEEVE AND CENTER CONTACT TO BE SUPPLIED UNASSEMBLED.
6. MATERIALS:
 INSULATOR: TEFLON, ASTM-D4894
 K-GRIP SLEEVE: COMMERCIAL BRONZE, ASTM-B135
 ALL OTHER METAL PARTS: BRASS, ASTM-B16.
7. FINISHES:
 CENTER CONTACT: GOLD PLATE, ASTM-B488.
 ALL OTHER METAL PARTS: NICKEL OR WHITE BRONZE PLATE.
 FOR NICKEL PLATING, ORDER PART NUMBER AS SHOWN. FOR WHITE BRONZE PLATING,
 ADD "MJ3" SUFFIX TO THE PART NUMBER SHOWN, FOR EXAMPLE 1203-24-9 MJ3.
8. ELECTRICAL CHARACTERISTICS:
 NOMINAL IMPEDANCE: 50 OHMS.
 WORKING VOLTAGE: 1000 VRMS.
 FREQUENCY RANGE: DC TO 11 GHZ.

STAMP: KINGS 1203-24-9
 YRWK (DATE CODE)
 (SEE NOTE 7)

5/8-24UNEF-2A THREAD

REVISIONS

ISSUE	CHANGES
0	ER 38188 HVN 01/22/01
1	CN 38377 A HVN 08/14/01
2	CN 39971 C DRK 06/18/07

SCALE	4:1	
APPROX SURFACE AREA	WAS E-19741	
USED ON		
REF:	1203-23-9	
N, JACK (LMR600)		
DRAWN	HVN	DATE 2/19/00
DESIGN	HVN	DATE 2/19/00
APPR.		DATE

A Winchester Electronics Company

SD

1203-24-9