

RECOMMENDED P.C.B. LAYOUT
(TOLERANCE:±0.05)

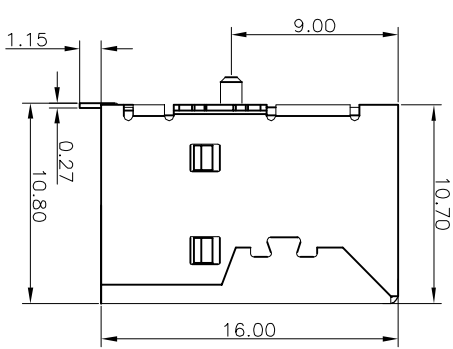
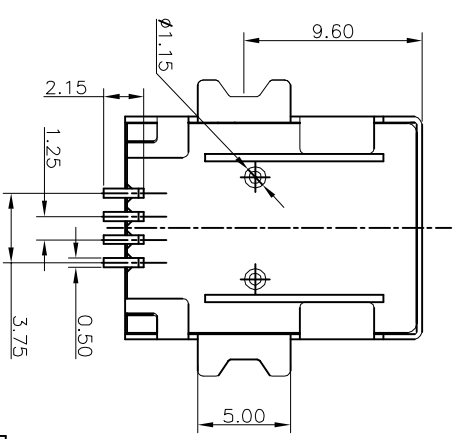

- NOTES:**
- Material:
 - Housing: PA6T+30%GF UL94V-0, Color White
 - Shell: Brass
 - Contact :Phosphor Bronze
 - FINISH:
 - Contact Area: Selective 30u"Au
Solder Area: Tin Plated
 - MECHANICAL:
 - Mating Force:3.57kgf Max.
 - Umating Force:1.02kgf Min
 - Durability:1500 cycles Min
 - ELECTRICAL:
 - Current Rating:1.5A
 - Dielectric Strength:500V AC FOR 1 MINUTE
 - Contact Resistance:30mΩ Max
 - Insulation Resistance:1000 MΩ Min
 - Operating temperature: -55°C TO +85°C
 - PACKING: Tray

RoHS compliant

Scale	Free	Customer-No.	
TOLERANCE		Date	Name
.X	±0.30	18.02.2014	Ray
.XX	±0.20	Approved	18.02.2014
.XXX	±0.10		Ray
DIM	TOL	ASSMANN WSW-No.	
X.°	±5°	A-USB/2-B/SMT	
Angle	TOL	Drawing-No.	ASS 6299 CO
UNIT	mm	Replace	rev00
			SHEET



1	2	3	4	5	6	7
1	2	3	4	5	6	7
H	G	F	E	D	C	B
H	G	F	E	D	C	B
H	G	F	E	D	C	B