

1

2

3

4

5

6

7

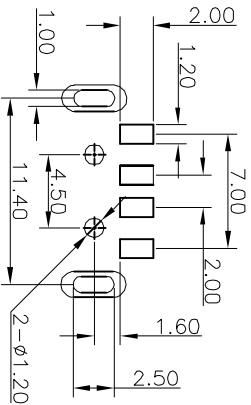
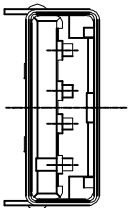
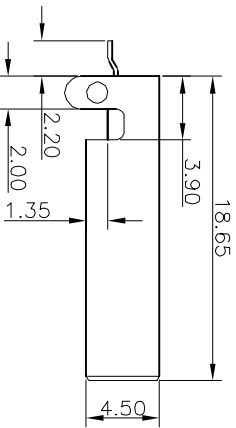
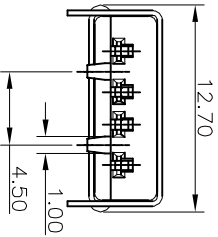
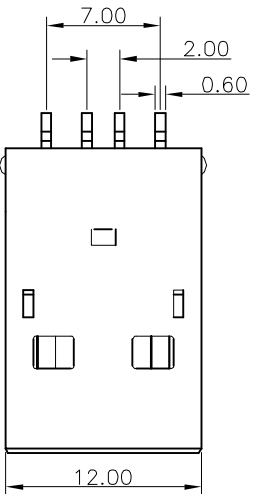

RECOMMENDED P.C.B LAYOUT

**NOTES:**

- 1. Material:
  - 1.1 Housing: PBT+30%GF UL94V-0, Color White
  - 1.2 Cover: PBT +30%GF UL94V-0, Color White
  - 1.3 Shell: SPCC
  - 1.4 Contact :Phosphor Bronze
- 2. FINISH:
  - 2.1 Contact Area: Selective 30u"Au
  - Solder Area: Tin Plated
  - Under: Ni Plated
- 3. MECHANICAL:
  - 3.1 Mating Force: 3.57kgf Max.
  - 3.2 Unmating Force: 1.02kgf Min
  - 3.3 Durability: 1500 cycles Min
- 4. ELECTRICAL:
  - 4.1 Current Rating: 1.5A
  - 4.2 Dielectric Strength: 500V AC FOR 1 MINUTE
  - 4.3 Contact Resistance: 30mΩ Max
  - 4.4 Insulation Resistance: 1000 MΩ Min
- 5. Operating temperature: -55°C TO +85°C
- 6. PACKING: Tray

**RoHS compliant**

Scale	Free	Customer-No.	
TOLERANCE			
.X	±0.30	Drawn	10.06.2014
.XX	±0.20	Approved	10.06.2014
.XXX	±0.10	Ray	
DIM TOL			
X. °	±5°	ASSMANN WSW-No. A-USB/2-A-LP-SMT	
Angle	TOL	Drawing-No.	ASS 6379 CO
UNIT	mm	Replace	rev00
Id.		SHEET	



1

2

3

4

5

6

7

A H G F E D C B A