

In addition to the standard types, additional versions as well as laser lettering are available on request. Starting with catalogue page 36 you will find an overview of the various designs.



MCS 19 Actuator Varnished



MCS 19 Housing Varnished



MCS 19 PI

Characteristics

Mounting Diameter [mm]	19	19	19
Housing Material	Zinc Diecasting	Zinc Diecasting, red varnished	Zinc Diecasting
Actuator Material	Stainless Steel, red varnished	Stainless Steel	Stainless Steel
Illumination	non-illuminated	non-illuminated	Point Illumination
Accessories	All switches are supplied with nut and o-ring seal.		

Order Number

Terminal			
Pins	1241.2877.3	1241.2873.3	
Pins with Soldering Aid	1241.2878.3	1241.2874.3	o
Clip for Pins	1241.2879.3	1241.2875.3	
Illumination			
red			1241.2855
green			1241.2856
yellow			1241.2857
blue			1241.2859
red / green			1241.2858

Drawing

A Illumination Area
 B Actuating Area
 C Width Across Flats
 E Pins
 F Pins with Soldering Aid
 G Clip for Pins

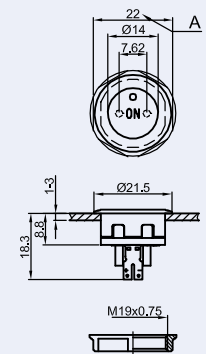
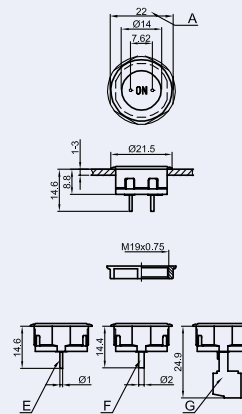
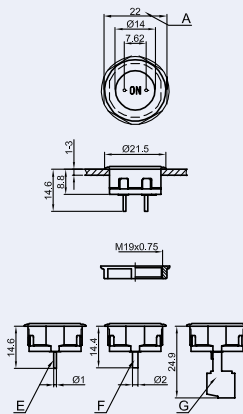

o Standard version