

GDBAS70

SURFACE MOUNT, SCHOTTKY BARRIER DIODE VOLTAGE 70V, CURRENT 70mA

Description

The GDBAS70 is designed for high speed switching applications, circuit protection and voltage clamping. Extremely low forward voltage reduces conduction loss. Miniature surface mount package is excellent for hand held and portable applications where space is limited.

Package Dimensions

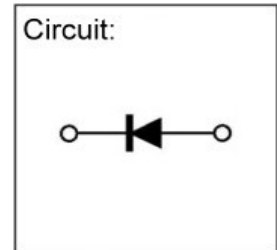
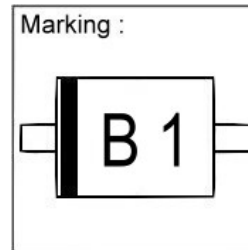
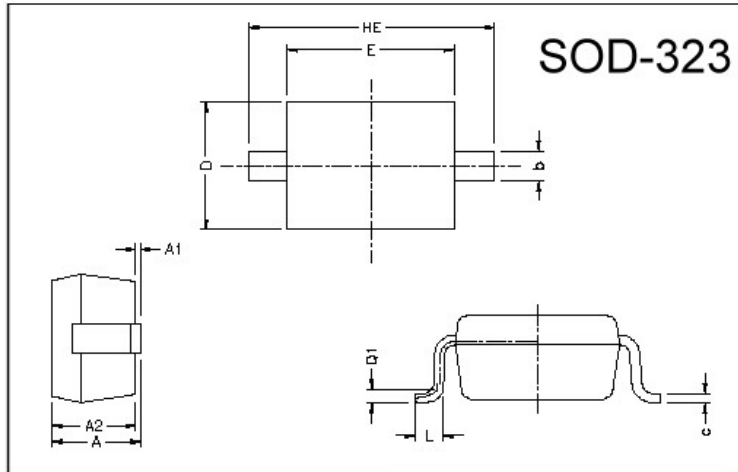

REF.	Millimeter		REF.	Millimeter	
	Min.	Max.		Min.	Max.
A	0.85	1.05			
A1	0	0.10	L	0.20	0.40
A2	0.80	1.00	b	0.25	0.40
D	1.15	1.45	c	0.10	0.18
E	1.60	1.80			
HE	2.30	2.70	Q1	0.15 BSC.	

Absolute Maximum Ratings at TA = 25°C

Parameter	Symbol	Ratings	Unit
Operating Junction Temperature	Tj	+125	°C
Storage Temperature	Tstg	-65 ~ +125	°C
Maximum Repetitive Peak Reverse Voltage	VRRM	70	V
Maximum Average Forward Rectified Current	Io	70	mA
Non- Repetitive Peak Forward Surge Current @ tp ≤ 1.0s	IFSM	100	mA
Thermal Resistance Junction to Ambient Air	RθJA	445	°C/W
Total Power Dissipation	PD	225	mW

Electrical Characteristics (at TA = 25°C unless otherwise noted)

Parameter	Symbol	Min.	Typ.	Max.	Unit	Test Conditions
Reverse Breakdown Voltage	V(BR)R	70	-	-	V	IR=10μA
Forward Voltage	VF	-	-	410	mV	IF1=1mA
		-	-	750		IF1=10mA
		-	-	1000		IF2=15mA
Reverse Leakage Current	IR	-	-	100	nA	VR1=50V
		-	-	10	uA	VR2=70V
Total Capacitance	CT	-	-	2.0	pF	VR=0V, f=1MHz
Reverse Recover Time	Trr	-	-	5.0	ns	IF=IR=10mA, RL=100Ω, Irr=1mA

Characteristics Curve

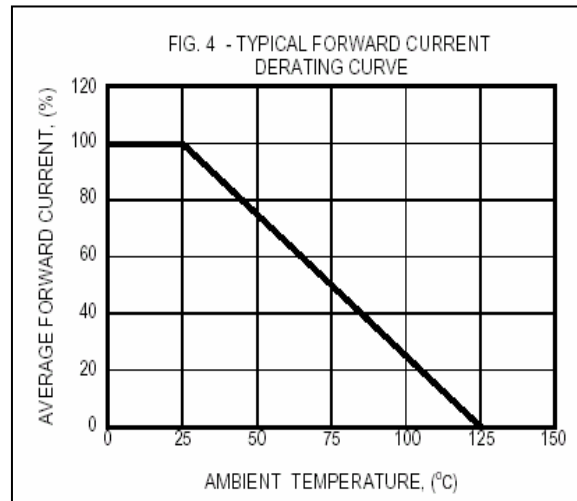
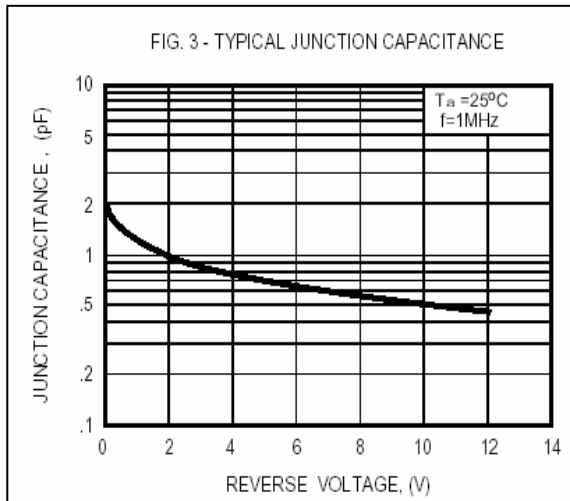
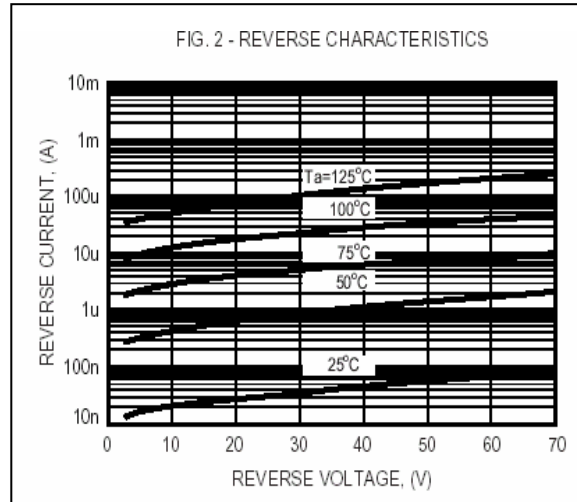
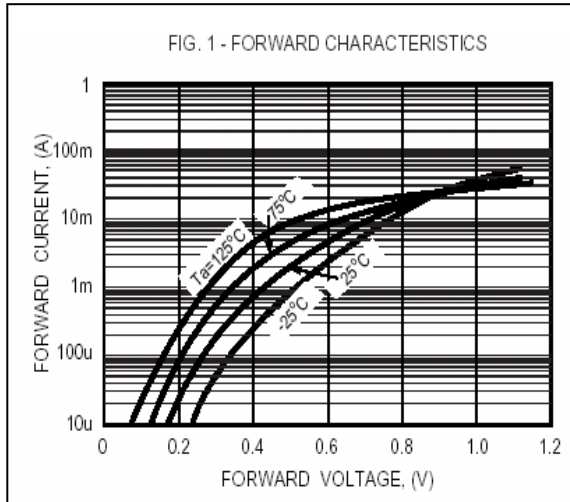

Important Notice:

- All rights are reserved. Reproduction in whole or in part is prohibited without the prior written approval of GTM.
- GTM reserves the right to make changes to its products without notice.
- GTM semiconductor products are not warranted to be suitable for use in life-support Applications, or systems.
- GTM assumes no liability for any consequence of customer product design, infringement of patents, or application assistance.

Head Office And Factory:

- **Taiwan:** No. 17-1 Tatung Rd. Fu Kou Hsin-Chu Industrial Park, Hsin-Chu, Taiwan, R. O. C.
- TEL : 886-3-597-7061 FAX : 886-3-597-9220, 597-0785
- **China:** (201203) No.255, Jang-Jiang Tsai-Lueng RD. , Pu-Dung-Hsin District, Shang-Hai City, China
- TEL : 86-21-5895-7671 ~ 4 FAX : 86-21-38950165