

30 Amp

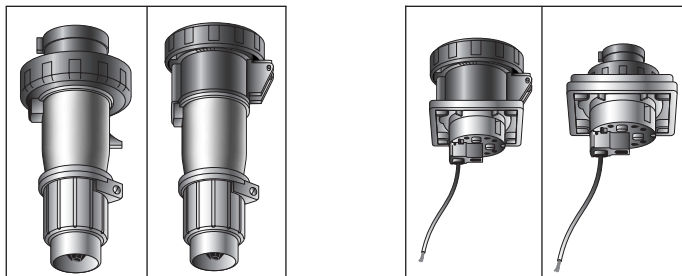

IP67 Shown



Poles & Wires	Configuration			Voltage/ Color Coding	Plug	Connector	Cable O.D. Range Inches	Receptacle*	Inlet*	
	Receptacle/ Connector	Plug/ Inlet	Clock Hour							
WATERTIGHT IP67	2P3W			4h	125	RS330P4W	RS330C4W	.675-.91	RS330R4W	RS330B4W
	2P3W			6h	250	RS330P6W	RS330C6W	.675-.91	RS330R6W	RS330B6W
	2P3W			7h	480	RS330P7W	RS330C7W	.675-.91	RS330R7W	RS330B7W
	3P4W			12h	125/250	RS430P12W	RS430C12W	.675-.91	RS430R12W	RS430B12W
	3P4W			9h	3Ø250	RS430P9W	RS430C9W	.675-.91	RS430R9W	RS430B9W
	3P4W			7h	3Ø480	RS430P7W	RS430C7W	.675-.91	RS430R7W	RS430B7W
	3P4W			5h	3Ø600	RS430P5W	RS430C5W	.675-.91	RS430R5W	RS430B5W
	4P5W			9h	3ØY120/208	RS530P9W	RS530C9W	.675-.91	RS530R9W	RS530B9W
	4P5W			7h	3ØY277/480	RS530P7W	RS530C7W	.675-.91	RS530R7W	RS530B7W
	4P5W			5h	3ØY347/600	RS530P5W	RS530C5W	.675-.91	RS530R5W	RS530B5W

IP44 Construction: No screw collars on male devices; female devices have flap covers only.

SPLASHPROOF IP44	2P3W			4h	125	RS330P4S	RS330C4S	.675-.91	RS330R4S	RS330B4S
	2P3W			6h	250	RS330P6S	RS330C6S	.675-.91	RS330R6S	RS330B6S
	2P3W			5h	277	RS330P5S	RS330C5S	.675-.91	RS330R5S	RS330B5S
	3P4W			12h	125/250	RS430P12S	RS430C12S	.675-.91	RS430R12S	RS430B12S
	3P4W			9h	3ph.250	RS430P9S	RS430C9S	.675-.91	RS430R9S	RS430B9S
	4P5W			9h	3ph.120/208	RS530P9S	RS530C9S	.675-.91	RS530R9S	RS530B9S

*See Page 81 for back box/mounting options.

UL Listing E2630, E47956
UL Classification E205590

Liquidtight Conduit Adapter Kit

3LTK4C50	30A 3 & 4W 1/2" NPT
3LTK4C10	30A 3 & 4W 1" NPT
3LTK4C75	30A 3 & 4W 3/4" NPT
3LTK5C75	30A 5W 3/4" NPT
3LTK5C10	30A 5W 1" NPT