

SMS Flame Retardant

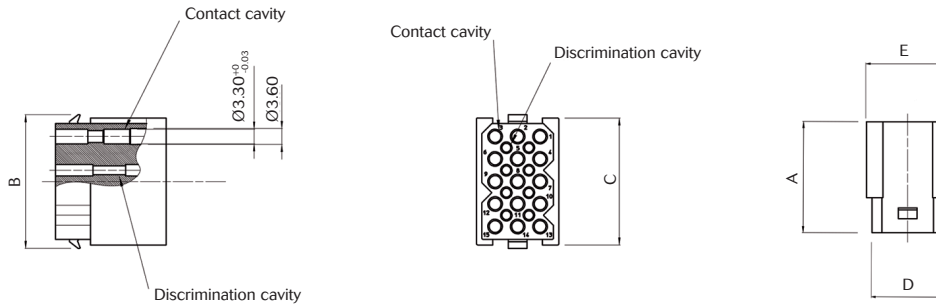

Cable receptacle without strain relief hood



Part numbers	Number of contact cavities	Number of discrimination cavities	A	B	C	D	E
SMS2RD3	2	0	25.0	9.9	8.4	11.1	14.1
SMS3RD3	3	0		9.9	8.4	16.2	18.6
SMS4RD3	4	0		9.9	8.4	21.2	23.7
SMS6RD3	6	2		15.0	13.4	16.2	18.6
SMS9RD3	9	4		20.0	18.5	16.2	18.6
SMS12RD3	12	6		25.1	23.6	16.2	18.6
SMS15RD3	15	8		30.2	28.7	16.2	18.6
SMS18RD3	18	10		35.3	33.8	16.2	18.6
SMS24RD3	24	15		35.3	33.8	21.2	23.7
SMS36RD3	36	24		25.1	23.6	46.6	49.1

Cable plug without strain relief hood

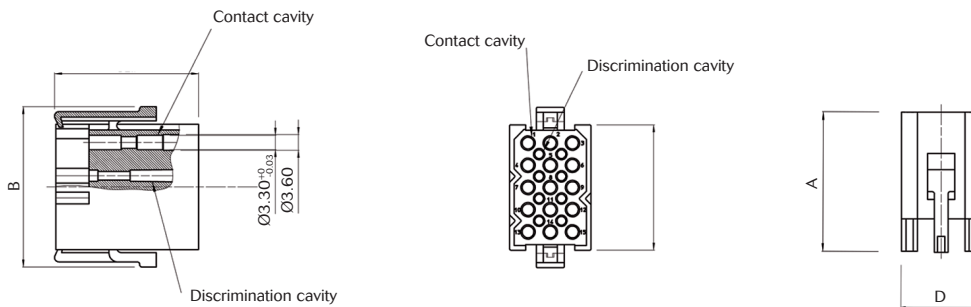

Part numbers	Number of contact cavities	Number of discrimination cavities	A	B	C	D
SMS2PD3	2	0	32.7	16.4	8.4	14.1
SMS3PD3	3	0		16.4	8.4	18.6
SMS4PD3	4	0		16.4	8.4	23.7
SMS6PD3	6	2		21.5	13.4	18.6
SMS9PD3	9	4		26.7	18.5	18.6
SMS12PD3	12	6		31.7	23.6	18.6
SMS15PD3	15	8		36.7	28.7	18.6
SMS18PD3	18	10		41.8	33.8	18.6
SMS24PD3	24	15		41.8	33.8	23.7
SMS36PD3	36	24		31.7	23.6	49.1