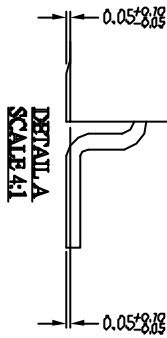
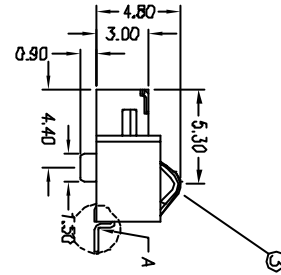
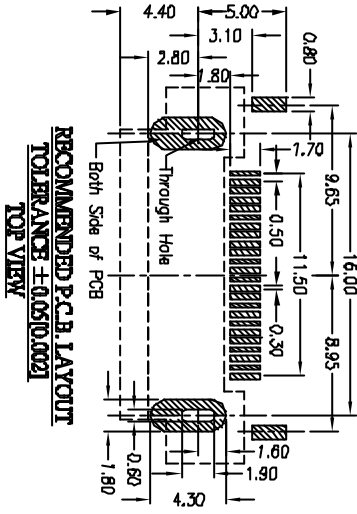
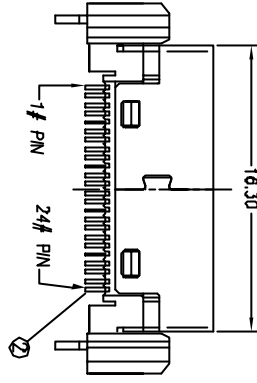
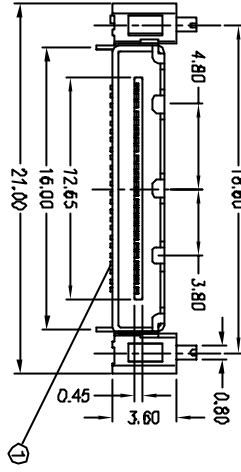
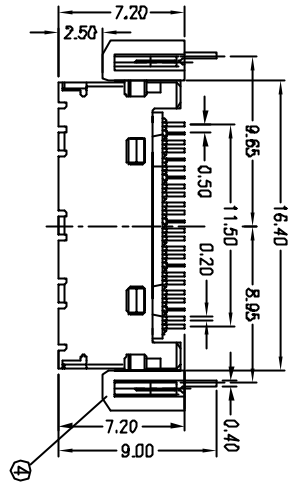

FIGURE NO.
SEE NOTES



NOTES:

- 1.0 RATED CURRENT: 0.5 Amps MIN. FOR SIGNAL PIN, 1.5 Amps MIN. FOR BATTERY PIN.
- 1.1 RATED VOLTAGE : 150 VAC (RMS)
- 1.3 OPERATING TEMPERATURE: -35°C to +85 °C
- 2.0 MECHANICAL CHARACTERISTICS: SEE PROD. SPEC.
- 3.0 MATERIALS : SEE TABLE A.
- 4.0 FINISHED : SEE TABLE A.
- 5.0 OTHERS: SEE PROD. SPEC.
- 5.1 PRODUCT SPECIFICATION : GS-12-257.
- 5.2 PACKAGING SPECIFICATION : GS-14-885.
- 5.3 PRODUCT NUMBERING CODE : 10032080-A024.

TABLE A

| ITEM | PART NAME | QTY/EA | MATERIAL | NOTES |
|------|--------------|--------|-----------------|--|
| 4 | HOUSING | 1 | LCP BLACK | HIGH TEMPERATURE RESIN U194V-0 RATED BLACK |
| 3 | BATTERY PINS | 2 | COPPER ALLOY | C/F PLATED OVER 40U" NICKEL |
| 2 | SIGNAL PINS | 24 | COPPER ALLOY | C/F PLATED OVER 40U" NICKEL |
| 1 | SHIELD | 1 | STAINLESS STEEL | 100U" Sn-Pb OVERALL 50U" NICKEL |

| mat'l. code | tolerances unless otherwise specified | CUSTOMER COPY | title | product family | MOBILE | code | |
|-------------|---------------------------------------|---------------|----------|-----------------------------|--------------|---------|----------|
| lit | ecm no | dr | date | linear | projection | scale | |
| A | 103-0308 | J.C | 11/29/03 | .XX ±.25 or .XXX ±.10 | MM | N/A | |
| sheet | revision | sheet | sheet | engr | JASON HSU | 9/30/03 | A4 |
| Index | sheet | sheet | sheet | chr | STERLING LIN | 9/30/03 | 10032080 |
| | | | | appd | JAMES HSU | 9/30/03 | 1 of 1 |

ACAD

code code
22526