



Pb Free Plating Product

ARD22 thru ARD24

Glass Passivated Ultrafast Recovery Rectifier Diodes

Features

- ★ Fast switching for high efficiency
- ★ Low forward voltage drop
- ★ High current capability
- ★ Low reverse leakage current
- ★ High surge current capability

Application

- ★ Automotive Environment|DC Motor Control
- ★ Plating Power Supply|UPS
- ★ Amplifier and Sound Device System etc..

Mechanical Data

- ★ Case: Molded plastic TO-220 Isolated Package
- ★ Epoxy: UL 94V-0 rate flame retardant
- ★ Terminals: Solderable per MIL-STD-202 method 208
- ★ Polarity: " S" " R" " U" Type(As marked)
- ★ Mounting position: Any
- ★ Weight: 2.2 gram approximately

ELECTRICAL CHARACTERISTICS

Parameter Type No.	Absolute Maximum Ratings					Electrical Characteristics (Ta=25°C)							Others		
	V _{RM} (V)	I _F (AV) (A) With Heatsink	I _{FSM} (A) 50Hz Half-cycle Sinewave Single Shot	T _J (°C)	T _{stg} (°C)	V _F (V) max per element	I _F (A)	I _R (mA) V _R =V _{RM} max per element	I _R (H) (mA) V _R =V _{RM} , Ta=100°C max per element	t _{rr} (1) (ns) I _F /I _{RP} (mA)	t _{rr} (2) (ns) I _F /I _{RP} (mA)	R _{th} (j-c) (°C/W)	Mass (g)	Fig.	
ARD22S ARD22R ARD22U	200	10.0	65	-40 to +150		0.98	5.0	0.25	1.0	40	30	100/200	4.0	2.1	A
ARD23S ARD23R ARD23U	300		70			1.30		0.1	0.5						
ARD24S ARD24R ARD24U	400							0.2	0.2						

External Dimensions

(Unit: mm) (Full-mold)

Flammability:
UL94V-0 or Equivalent

Fig. A

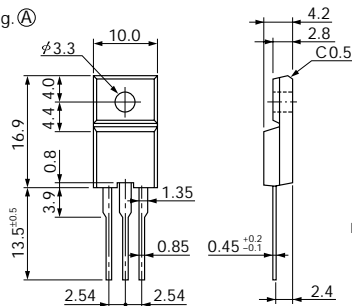

Part Number Suffix: "S" "R" "U"

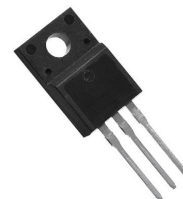
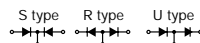

TO-220FH/TO-220FG

ITO-220AB/TO-220F/TO-220FH/TO-220FG
TO-220 Fully Isolated/Insulated Plastic Package

RATINGS AND CHARACTERISTIC CURVES (ARD22 thru ARD24)

ARD22S/ARD22R/ARD22U

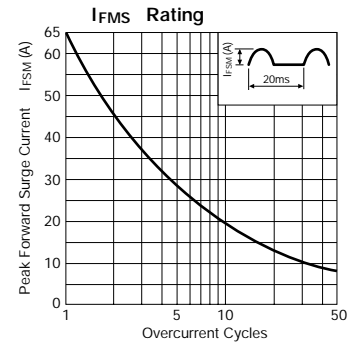
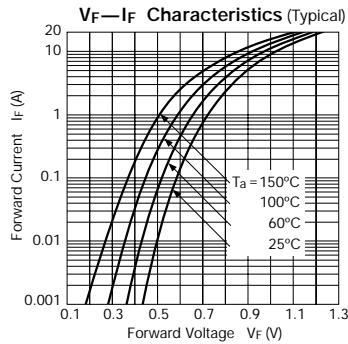
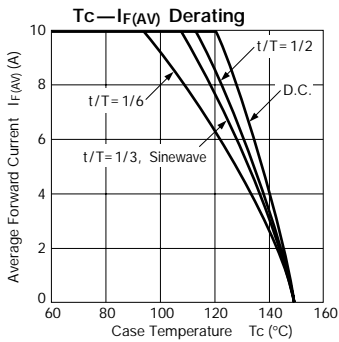

ARD23S/ARD23R/ARD23U

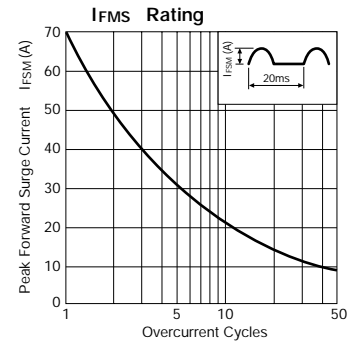
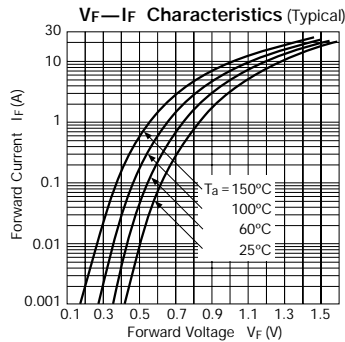
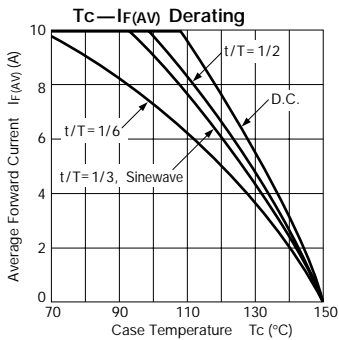

ARD24S/ARD24R/ARD24U

