

Color-Keyed®

Heavy Duty Battery Connectors

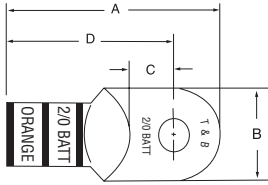

BAL1038



Color-Keyed Starter Lugs – Tin Plated

Cat. No.	Bulk Cat. No.	SAE Cable Size and Color	Stud Size	A ±.04	B ±.02	C ±.02	D ±.02	Pkg. Qty.	Bulk Pkg. Qty.	Color Key
BAL414	273-31852-1	4 Gauge	¼	140	52	40	115	10	100	Grey
BAL4516	273-31852-2	4 Gauge	5/16	145	61	36	114	10	100	Grey
BAL438	273-31852-3	4 Gauge	¾	145	61	36	114	10	100	Grey
BAL2516		2 Gauge	5/16	159	69	40	125	10		Green
BAL238	273-31852-4	2 Gauge	¾	178	67	55	140	10	100	Green
BAL212	273-31852-5	2 Gauge	½	177	76	54	140	10	100	Green
BAL1516		1 Gauge	5/16	183	76	49	150	10		Green
BAL138	273-31852-6	1 Gauge	¾	185	75	55	150	10	100	Pink
BAL112	273-31852-7	1 Gauge	½	220	75	75	170	10	100	Pink
BAL10516		1/0 Gauge	5/16	192	83	50	150	10		Black
BAL1038	273-31852-8	1/0 Gauge	¾	193	83	55	155	10	100	Black
BAL1012	273-31852-9	1/0 Gauge	½	197	88	53	153	10	100	Black
BAL20516		2/0 Gauge	5/16	206	93	50	160	10		Orange
BAL2038	273-31852-10	2/0 Gauge	¾	211	93	55	165	10	100	Orange
BAL2012	273-31852-11	2/0 Gauge	½	211	93	55	165	10	100	Orange
BAL30516		3/0 Gauge	5/16	216	103	55	165	10		Purple
BAL3038	273-31852-12	3/0 Gauge	¾	203	103	55	165	10	100	Purple
BAL3012	273-31852-13	3/0 Gauge	½	235	103	75	185	10	100	Purple
BAL40516		4/0 Gauge	5/16	240	113	59	184	10		Yellow
BAL4038	273-31852-14	4/0 Gauge	¾	228	112	55	190	10	100	Yellow
BAL4012	273-31852-15	4/0 Gauge	½	260	112	75	210	10	100	Yellow

Material: High conductivity copper.
Finish: Electro-tin plated.
Installing Tools: TBM5-SV or TBM5V.



BAC1038

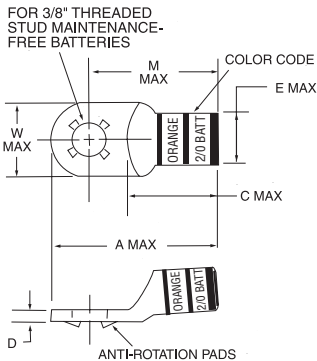

Stackable Battery Connector – Lead Plated

Cat. No.	Bulk Cat. No.	SAE Cable Size and Color	A ±.040	M ±.020	W ±.020	C ±.020	E ±.010	Stud Size	Pkg. Qty.	Bulk Pkg. Qty.	Color Key
BAC438	273-31853-1	4 Gauge	1.455	1.143	.615	.750	.365	¾	10	100	Grey
BAC238	273-31853-2	2 Gauge	1.775	1.400	.675	.850	.467	¾	10	100	Green
BAC138	273-31853-3	1 Gauge	1.875	1.500	.750	.950	.521	¾	10	100	Pink
BAC1038	273-31853-4	1/0 Gauge	1.925	1.550	.825	1.000	.571	¾	10	100	Black
BAC2038	273-31853-5	2/0 Gauge	2.110	1.645	.930	1.100	.632	¾	10	100	Orange
BAC3038	273-31853-6	3/0 Gauge	2.025	1.650	1.025	1.100	.701	¾	10	100	Purple
BAC4038	273-31853-7	4/0 Gauge	2.275	1.900	1.125	1.350	.766	¾	10	100	Yellow

Material: High conductivity copper.
Finish: Electro-tin plated.
Installing Tools: TBM5-SV or TBM5V.