

Push Button Switches



Round



Square



Rectangular



Round:

Mounting Dimensions



Bottom View

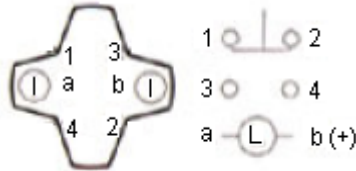

Dimensions

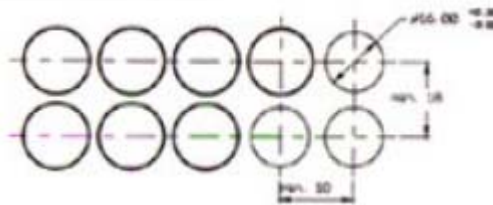

Dimensions : Millimetres

Square:

Mounting Dimensions



Bottom View



Dimensions

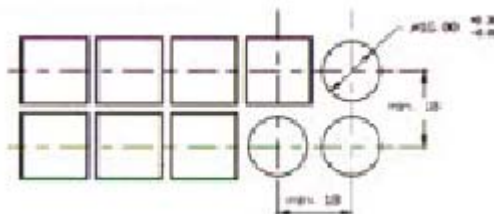

Dimensions : Millimetres

Rectangular:

Mounting Dimensions

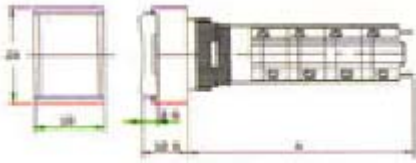

Bottom View



Dimensions

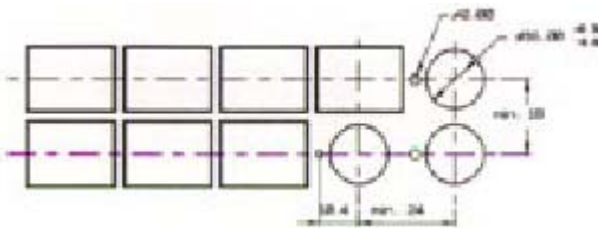

Dimensions : Millimetres

Specifications:

Switch system	: Each contact block has one double break snap action switching mechanism.
Switch mode	: Momentary or alternate action, 1 to 4 poles.
Contact material	: Soldering type-silver is standard; : Socket type-pin with golden plating.
Body material	: High-grade temperature thermoplastic. : Contact housing moulded in electrical high-grade thermosetting plastic.
Operating travel	: 3.0mm.
Actuating force	: 2 to 5N depending on number of contact block.
Mechanical lifetime	: >2 million operations.
Electric rating	: 250V ac, 5A, 125V ac, 8A, 250V dc, 0.2A and 24V dc, 6A.

Specification Table

Type	Description	Part Number
Round	Switch, SPDT, MOM, Round, 18mm	D16-LMR1-1AB
	Switch, DPDT, MOM, Round, 18mm	D16-LMR1-2AB
	Switch, SPDT, Latching, Round, 18mm	D16-LAR1-1AB
	Switch, DPDT, Latching, Round, 18mm	D16-LAR1-2AB
Square	Switch, SPDT, MOM, 18 x 18mm	D16-LMS1-1AB
	Switch, DPDT, MOM, 18 x 18mm	D16-LMS1-2AB
	Switch, SPDT, Latching, 18 x 18mm	D16-LAS1-1AB
	Switch, DPDT, Latching, 18 x 18mm	D16-LAS1-2AB
Rectangular	Switch, SPDT, MOM, 18 x 24mm	D16-LMT1-1AB
	Switch, DPDT, MOM, 18 x 24mm	D16-LMT1-2AB
	Switch, SPDT, Latching, 18 x 24mm	D16-LAT1-1AB
	Switch, DPDT, Latching, 18 x 24mm	D16-LAT1-2AB

Push Button Switches



Part Number Explanation:

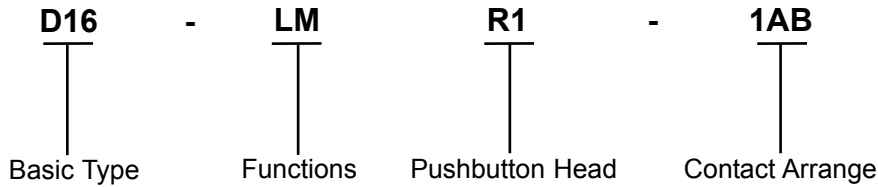

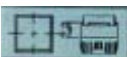
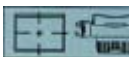
- Basic Type** : D16 = ϕ 16mm.
- Functions** : LM = Soldering type pushbutton switches with momentary action,
LA = Soldering type pushbutton switches with alternate action.
- Pushbutton Head** :
- R1 S1 T1
- 

- Contact Arrange** : 1AB = 1 NO + 1 NC, 2AB = 2 NO + 2 NC.

Round (Concave)



Part Number Table

Description	Part Number
Lens, Blue, Round, 18mm, For D16	50-001-01
Lens, Green, Round, 18mm, For D16	50-001-02
Lens, Orange, Round, 18mm, For D16	50-001-03
Lens, Red, Round, 18mm, For D16	50-001-04
Lens, White, Round, 18mm, For D16	50-001-05
Lens, Yellow, Round, 18mm, For D16	50-001-06
Lens, Blue, 18 x 18mm, For D16	50-003-01
Lens, Green, 18 x 18mm, For D16	50-003-02
Lens, Orange, 18 x 18mm, For D16	50-003-03
Lens, Red, 18 x 18mm, For D16	50-003-04
Lens, White, 18 x 18mm, For D16	50-003-05
Lens, Yellow, 18 x 18mm, For D16	50-003-06