

Verpackt in Gurtverpackung
Tape on Reel Packaging
Verpackungseinheit: 400 Stück
Packaging unit: 400 pcs

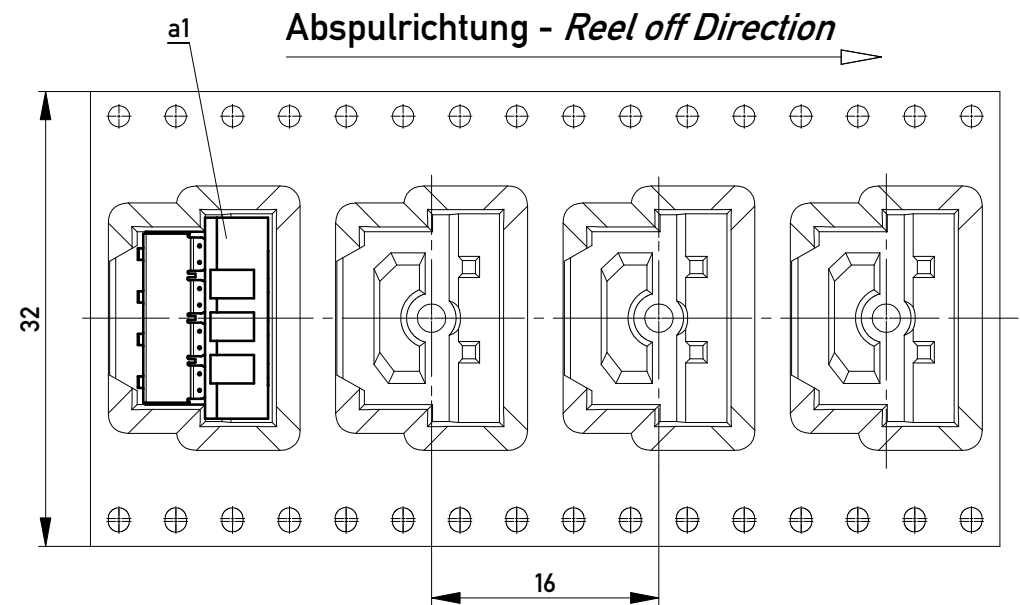

Leiterplatten-Layout Vorschlag / PCB-Layout Proposal

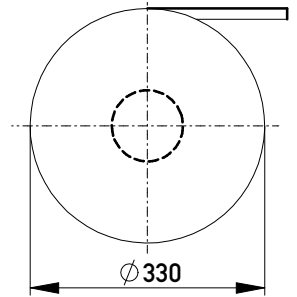
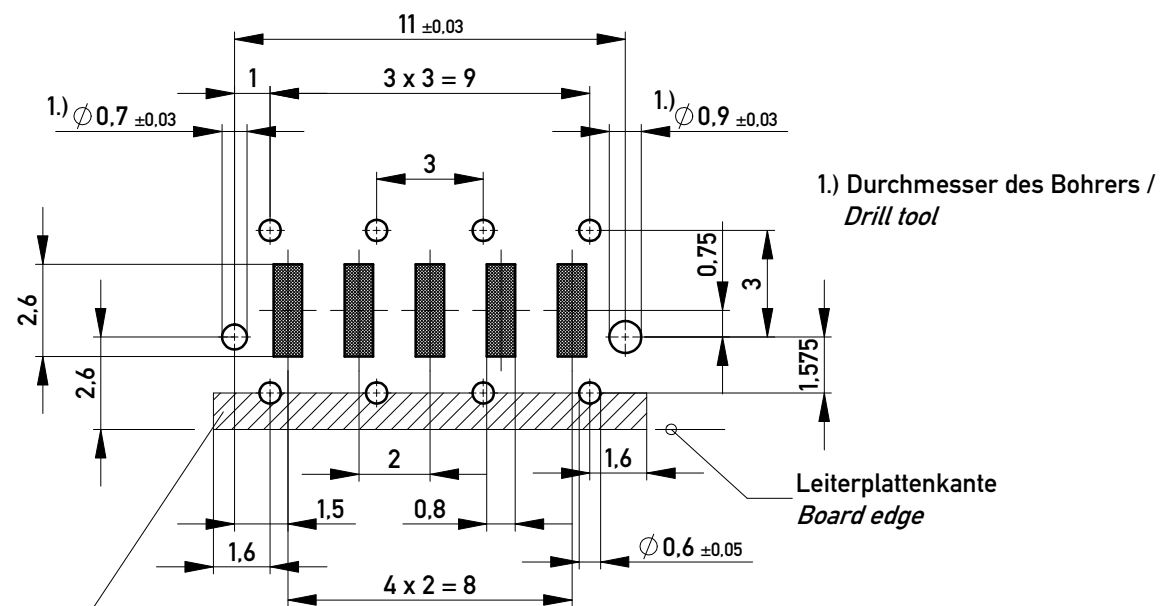

Schirmblechauflagefläche berücksichtigen.
keine Durchkontaktierungen oder Leitungen möglich!
Consider shielding contact area, no vias or traces possible!

Anforderungsstufe 1
Performance Level 1

Kontaktbereich vergoldet
Mating Area gold plating

Anschlussbereich verzinkt 4-6 µm
Terminal Area 4-6 µm tin plating

Koplanarität der Anschlüsse ≤ 0,1 mm
Coplanarity Area of Termination ≤ 0,1 mm

BlindMate SMD/THR

Information:	Tolerances	<p>All Dimensions in mm</p>	Scale	5:1	
	<p>All rights reserved. Only for Information. To ensure that this is the latest version of this drawing, please contact one of the ERNI companies before using.</p>		<p>Subject to modification without prior notice. Drawing will not be updated.</p> www.ERNI.com	Designation	
			MSpeed Messerl. 90° PM MSpeed male 90° PM		
			100500100004		K A3
			Class	MSPPM	

Copyright by ERNI GmbH
Proprietary notice pursuant to ISO 16016 to be observed.