

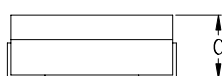

DELTA P/N : HCB1380 Series

Mechanical dimensions

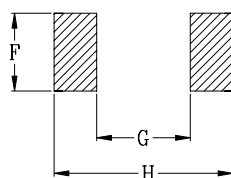
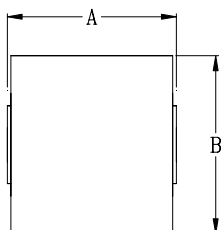

PCB LAYOUT

Dimensions (Unit : mm)

	0.26m	0.53m	0.32m	0.165m
A	13.0 MAX			13.3 MAX
B	13.0 MAX			
C	8.0 MAX			8.2 MAX
D	5.0		5.3	5.0
E	2.5			2.5
F	5.8			5.8
G	7.1			7.5
H	13.2			13.5

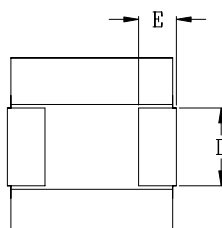

Electrical Characteristics

Delta P/N	L ¹ (nH)	Li (nH)	DCR (mΩ)	Isat ² (A)	Ir ³ (A)
HCB1380-211	210	180	0.26 ± 9.4%	71	50
HCB1380-261	260	200		60	
HCB1380-321	320	216		50	
HCB1380-361	360	260		40	
HCB1380-441H	440	288		32	
HCB1380-211H	210	180	0.53 ± 11.5%	71	35
HCB1380-261H	260	200		60	
HCB1380-321H	320	216		50	
HCB1380-361H	360	260		40	
HCB1380-441H	440	288		32	
HCB1380-211H1	210	180	0.32 ± 9.4%	71	45
HCB1380-261H1	260	200		60	
HCB1380-321H1	320	216		50	
HCB1380-361H1	360	260		40	
HCB1380-441H1	440	288		32	
HCB1380-211L	210	180	0.165 ± 10%	71	68
HCB1380-261L	260	200		60	
HCB1380-321L	320	216		50	
HCB1380-361L	360	260		40	
HCB1380-441L	440	288		32	

1. Tolerance of inductance : ± 20%
2. Isat is the DC current which cause the inductance drop to Li
3. Ir is the DC current which cause the surface temperature of the part increase approximately 40 .
4. Operating temperature: -40 to 125 (Self-temperature rise included).