

Specification Status: Released

Maximum Electrical Rating

Voltage: 9.0V_{DC}
Short Circuit Current: 40A

Notes:

1. All terminations are Tin plated.
2. Drawing not to scale

Marking: E

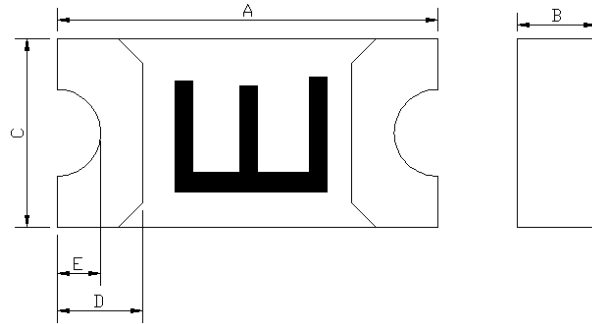

TABLE I. DIMENSIONS:

	A		B		C		D		E
	MIN	MAX	MIN	MAX	MIN	MAX	MIN	MAX	MIN
mm:	1.40	1.80	0.35	0.75	0.60	1.00	0.10	0.50	0.075
in:	(0.055)	(0.071)	(0.013)	(0.030)	(0.023)	(0.039)	(0.004)	(0.020)	(0.003)

TABLE II. PERFORMANCE RATINGS:

CURRENT RATINGS**								TIME TO TRIP**	RESISTANCE VALUES	TRIPPED-STATE POWER DISSIPATION**	
AMPERES AT 0°C		AMPERES AT 25°C		AMPERES AT 60°C		AMPERES AT 85°C		SECONDS AT 25°C, 1.0A MAX	OHMS AT 25°C	WATTS AT 25°C, 9.0V	
HOLD	TRIP	HOLD	TRIP	HOLD	TRIP	HOLD	TRIP		MIN	MAX*	MAX
0.18	0.45	0.16	0.40	0.11	0.28	0.07	0.17	0.1	1.00	4.20	0.5

* Maximum resistance is measured 1 hour after reflow.

** Values specified were determined using PCB's with 0.030"x1.0 ounce copper traces.

Agency Recognitions: UL, CSA
Reference Documents: PS300
Precedence: This specification takes precedence over documents referenced herein.
Effectivity: Reference documents shall be the issue in effect on the date of invitation for bid.
Caution: Operation beyond the rated voltage or current may result in rupture, electrical arcing or flame.

Materials Information

ROHS Compliant

ELV Compliant

Pb-Free

Halogen Free*

Directive 2002/95/EC
Compliant

Directive 2000/53/EC
Compliant



* Halogen Free refers to: Br≤900ppm, Cl≤900ppm, Br+Cl≤1500ppm.