

Flush and extended pushbuttons

Non-illuminated

Momentary and maintained

8

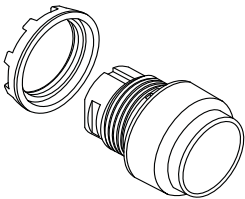
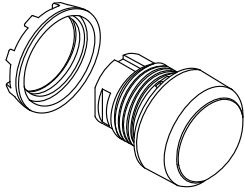

Bezel in black plastic as standard

Bezel in metal:

Replace '1' in the:

Cat No. MPX-1 0X

Ref Code 1SFA 611XXX R 1XXX

3 for metal bezel

4 for grey plastic

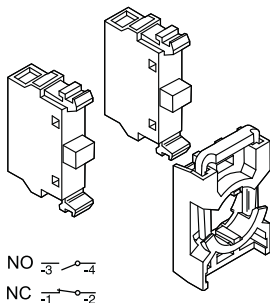

Operator ...

Description	Catalog No.	Ref. Code
with flush button		
Momentary		
Red	MP1-10R	1SFA 611 100 R1001
Green	MP1-10G	1SFA 611 100 R1002
Yellow	MP1-10Y	1SFA 611 100 R1003
Blue	MP1-10L	1SFA 611 100 R1004
White	MP1-10W	1SFA 611 100 R1005
Black	MP1-10B	1SFA 611 100 R1006
Clear	MP1-10C	1SFA 611 100 R1008
Maintained ①		
Red	MP2-10R	1SFA 611 101 R1001
Green	MP2-10G	1SFA 611 101 R1002
Yellow	MP2-10Y	1SFA 611 101 R1003
Blue	MP2-10L	1SFA 611 101 R1004
White	MP2-10W	1SFA 611 101 R1005
Black	MP2-10B	1SFA 611 101 R1006
Clear	MP2-10C	1SFA 611 101 R1008

with extended button

Momentary		
Red	MP3-10R	1SFA 611 102 R1001
Green	MP3-10G	1SFA 611 102 R1002
Yellow	MP3-10Y	1SFA 611 102 R1003
Blue	MP3-10L	1SFA 611 102 R1004
White	MP3-10W	1SFA 611 102 R1005
Black	MP3-10B	1SFA 611 102 R1006
Clear	MP3-10C	1SFA 611 102 R1008
Maintained ①		
Red	MP4-10R	1SFA 611 103 R1001
Green	MP4-10G	1SFA 611 103 R1002
Yellow	MP4-10Y	1SFA 611 103 R1003
Blue	MP4-10L	1SFA 611 103 R1004
White	MP4-10W	1SFA 611 103 R1005
Black	MP4-10B	1SFA 611 103 R1006
Clear	MP4-10C	1SFA 611 103 R1008

Contact blocks, and holder

Blocks	Catalog No.	Ref. Code
1 NO with holder	MCBH-10	1SFA 611 605 R1101
1 NC with holder	MCBH-01	1SFA 611 605 R1110
2 NO with holder	MCBH-20	1SFA 611 605 R1102
2 NC with holder	MCBH-02	1SFA 611 605 R1120
1 NO + 1 NC with holder	MCBH-11	1SFA 611 605 R1111
1 NO without holder	MCB-10	1SFA 611 610 R1001
1 NC without holder	MCB-01	1SFA 611 610 R1010
Holder for 3 blocks	MCBH-00	1SFA 611 605 R1100

Ordering example

Requested: A modular pushbutton, momentary, with red flush button and one NO contact.

Ref.: 1 piece of MP1-10R + 1 piece of MCBH-10

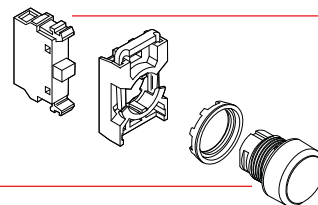

① No contact block in the center position

Flush and extended pushbuttons

Illuminated

Momentary and maintained

Bulb max 1.2 W

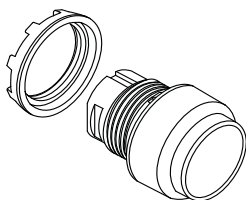
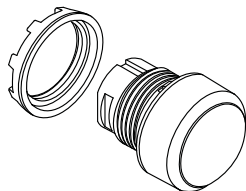

Bezel in black plastic as standard
Bezel in metal:
 Replace '1' in the:
 Catalog No. MPX-1 0X
 Ref. Code 1SFA611XXX R 1XXX
3 for metal bezel
4 for grey plastic bezel

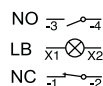
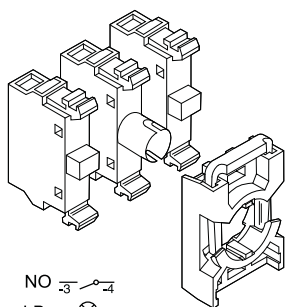

Operator ...

Description	Catalog No.	Ref. Code
with flush button		
Momentary ①		
Red	MP1-11R	1SFA 611 100 R1101
Green	MP1-11G	1SFA 611 100 R1102
Yellow	MP1-11Y	1SFA 611 100 R1103
Blue	MP1-11L	1SFA 611 100 R1104
White	MP1-11W	1SFA 611 100 R1105
Clear	MP1-11C	1SFA 611 100 R1108
Maintained ①②		
Red	MP2-11R	1SFA 611 101 R1101
Green	MP2-11G	1SFA 611 101 R1102
Yellow	MP2-11Y	1SFA 611 101 R1103
Blue	MP2-11L	1SFA 611 101 R1104
White	MP2-11W	1SFA 611 101 R1105
Clear	MP2-11C	1SFA 611 101 R1108
with extended button		
Momentary ①		
Red	MP3-11R	1SFA 611 102 R1101
Green	MP3-11G	1SFA 611 102 R1102
Yellow	MP3-11Y	1SFA 611 102 R1103
Blue	MP3-11L	1SFA 611 102 R1104
White	MP3-11W	1SFA 611 102 R1105
Clear	MP3-11C	1SFA 611 102 R1108
Maintained ①②		
Red	MP4-11R	1SFA 611 103 R1101
Green	MP4-11G	1SFA 611 103 R1102
Yellow	MP4-11Y	1SFA 611 103 R1103
Blue	MP4-11L	1SFA 611 103 R1104
White	MP4-11W	1SFA 611 103 R1105
Clear	MP4-11C	1SFA 611 103 R1108

Contact blocks, lamp block and holder ②

Blocks	Catalog No.	Ref. Code
1 NO + 1 LB with holder	MCBH-101	1SFA 611 605 R1201
1 NC + 1 LB with holder	MCBH-011	1SFA 611 605 R1210
2 NO + 1 LB with holder	MCBH-201	1SFA 611 605 R1202
2 NC + 1 LB with holder	MCBH-021	1SFA 611 605 R1220
1 NO + 1 NC + 1 LB with holder	MCBH-111	1SFA 611 605 R1211
1 NO without holder	MCB-10	1SFA 611 610 R1001
1 NC without holder	MCB-01	1SFA 611 610 R1010
Lamp block for 2 W, max 230 V AC/DC bulb or LED	MLB-1	1SFA 611 620 R1001
Holder for 3 blocks	MCBH-00	1SFA 611 605 R1100

Ordering example

Requested: A modular pushbutton, maintained and illuminated with green flush button and one NO + one NC contact.

Ref.: 1 piece of MP2-11G + 1 piece of MCBH-111
 Bulb - see accessories

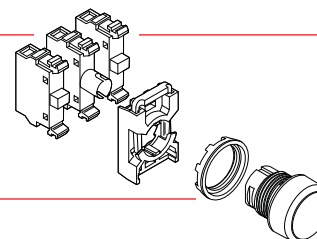

- ① No contact block in the center position
- ② Lamp block MLB-1. Bulb not included. For other lamp blocks see Accessories.
- ③ Bulb max 1.2 W, not included.