

-A: ALIGNMENT PIN OPTION SHOWN

No OF POSITIONS  
-020, -040, -060  
\*-080, \*-100 (PER ROW)

LEAD STYLE  
-01 .1280[3.251]

## PLATING SPECIFICATION

PLATING THICKNESSES ARE FOR SIGNAL PINS ONLY. FOR GROUND PLANE THICKNESSES, SEE PP-T-1G2-XX-X. (SEE NOTES 8, 11 & 13)

-F: 3μ" SELECTIVE GOLD CONTACT, MATTE TIN TAIL (USE C-126-21-F, T-1G2-01-F)

-L: 10μ" SELECTIVE GOLD CONTACT, MATTE TIN TAIL (USE C-126-21-L, T-1G2-01-L)

-H: 30μ" GOLD CONTACT, 3μ" GOLD TAIL (USE C-126-21-H, T-1G2-01-G)

-C: 50μ" ELECTRO POLISHED SELECTIVE GOLD CONTACT, MATTE TIN TAIL (USE C-126-21-C, T-1G2-01-L)

-STL: 30μ" SELECTIVE GOLD CONTACT, TIN LEAD (90/10 ±5%) TAILS (USE C-126-21-STL, T-1G2-01-STL)

-FTL: 3μ" SELECTIVE GOLD CONTACT, TIN LEAD (90/10 ±5%) TAILS (USE C-126-21-FTL, T-1G2-01-FTL)

-LTL: 10μ" SELECTIVE GOLD CONTACT, TIN LEAD (90/10 ±5%) TAILS (USE C-126-21-LTL, T-1G2-01-LTL)

-S: 30μ" SELECTIVE GOLD CONTACT, MATTE TIN TAIL (USE C-126-21-S, T-1G2-01-L)

\* SEE NOTE 12

## OPTION

-A: ALIGNMENT PINS (USE QSE-20-XX-D-XX-A)

NA WITH -LC OPTION

-LC: LOCKING CLIPS(SEE NOTE 14) (USE LC-08-TM-01, )

NA WITH -A OPTION

-GP: GUIDE POSTS (SEE FIG 3, SHT 2) (USE QSE-20-01-D-XX-X-GP)

(T & R PACKAGING: 40 POS MAX)

-K: POLYIMIDE FILM (USE K-DOT-.325-.450-.005, SEE FIG 2, SHT 2)

-TR: TAPE & REEL (60 POS MAX) (40 POS MAX -GP OPTION)

-FL: FRICTION LOCKS (SEE FIG 4, SHT 2)

(NOT AVAILABLE WITH -GP)

-RT1: RETENTION OPTION (MUST USE -A OPTION)

(USE QSE-20-01-D-XX-A-RT1 & SUB-SC-05-01-FF)

(SEE FIG 5, SHT 2)

(NOT AVAILABLE WITH -LC, -GP, OR -FL)

(NOT AVAILABLE WITH -100 POS)

-L: LATCHING OPTION (40 POS MAX)

(SEE FIG 6, SHT3)

(MUST USE -A OPTION)

(NOT AVAILABLE WITH -LC, -GP, -FL, OR -RT1)

## ROW SPECIFICATION

-D: DOUBLE

(USE QSE-20-XX-D-XX)

No OF BANKS

AY

C-126-21-XXX  
(SEE NOTE 13)

$.1280^{+.0030}_{-.0010}$  [3.251<sup>+0.076</sup><sub>-0.025</sub>]  
(SEE NOTE 6 & 7)

SEE TABLE 1

SECTION "A"- "A"

## NOTES:

1. Ⓢ REPRESENTS A CRITICAL DIMENSION.
2. MIN CONTACT RETENTION: 8 OZ
3. MIN GROUND PLANE RETENTION: 8 OZ
4. PARTS ARE MOLDED TO POSITION.
5. DELETED.
6. MAX VARIANCE: .002[0.51].
7. DIMENSION APPLIES TO CONTACTS & GROUND PLANE.
8. -L PLATING CAN BE SUBSTITUTED FOR -F PLATING, -G PLATED GROUND PLANE CAN BE SUBSTITUTED FOR -F PLATED GROUND PLANE.
9. GROUND PLANE PRESS HEIGHT MUST BE .003 [0.08] LESS THAN THE MAX HEIGHT OR .001 [0.03] GREATER THAN THE MINIMUM HEIGHT OF THE SOCKETS.
10. S-103 RETENTION: 1 LB MIN IN BODY.
11. MAY SUB C-126-01-XXX FOR C-126-21-XXX.
12. FOR NEW APPLICATIONS REQUIRING THESE POSITIONS, PLEASE CONTACT SAMTEC INTERCONNECT PROCESSING GROUP.
13. FOR -080, -100 POSITIONS USE C-269-11-XXX. DO NOT SUB C-126.
14. DUE TO THE HIGH AMOUNT OF INSERTION FORCE NEEDED, THE -LC OPTION IS NOT COMPATIBLE WITH AUTO PLACEMENT. SAMTEC RECOMMENDS MANUAL PLACEMENT FOR ALL ASSEMBLIES WITH THE -LC OPTION.
15. SIDE WALLS ARE RIBBED AS NECESSARY TO CONTROL BOW.

FIG 1  
QSE-060-01-XXX-D-LC SHOWN

TABLE 1

No OF POS	COPLANARITY INCLUDING GP
-020 THRU -040	.0040[.102]
-060 THRU -100	.0060[.152]

UNLESS OTHERWISE SPECIFIED, DIMENSIONS ARE IN INCHES.

TOLERANCES ARE:

DECIMALS

.XX: ±.01[.3]

.XXX: ±.005[.13]

.XXXX: ±.0020[.051]

ANGLES

2°

## PROPRIETARY NOTE

THIS DOCUMENT CONTAINS INFORMATION CONFIDENTIAL AND PROPRIETARY TO SAMTEC, INC. AND SHALL NOT BE REPRODUCED OR TRANSFERRED TO OTHER DOCUMENTS OR DISCLOSED TO OTHERS OR USED FOR ANY PURPOSE OTHER THAN THAT WHICH IT WAS OBTAINED WITHOUT THE EXPRESSED WRITTEN CONSENT OF SAMTEC, INC.

MATERIAL:

DO NOT SCALE DRAWING

INSULATOR: LCP, COLOR: BLACK, UL 94 VO

CONTACT: PHOS BRONZE

GROUND PLANE: PHOS BRONZE

SHEET SCALE: 2:1

DESCRIPTION:

.8mm DOUBLE ROW HS SOCKET ASSEMBLY

DWG. NO.

QSE-XXX-01-XXX-D-XXX

BY: ERIC M

05/20/1999

SHEET 1 OF 3

**samtec**

520 PARK EAST BLVD, NEW ALBANY, IN 47150  
PHONE: 812-944-6733 FAX: 812-948-5047  
e-Mail: info@SAMTEC.com code 55322

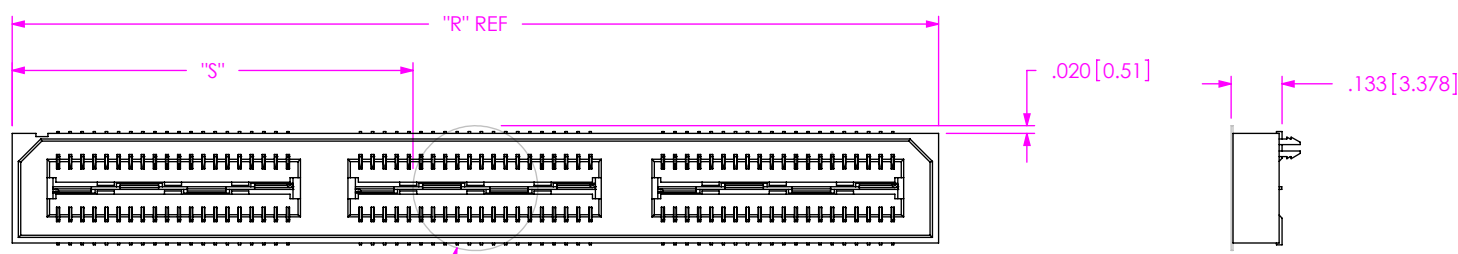

FIG 2  
-K: POLYIMIDE FILM PAD  
[ K-DOT-.325-.450-.005]

NOTE: "R" = ((No OF POSITIONS / 20) x .7875[20.003]) + .050[1.27]  
WITH -GP OPTION: "R" = ((No OF POSITIONS / 20) x .7875[20.003]) + .429[10.90] REF  
"S" = (("R" - .325[8.26]) / 2) ±.020[.51]

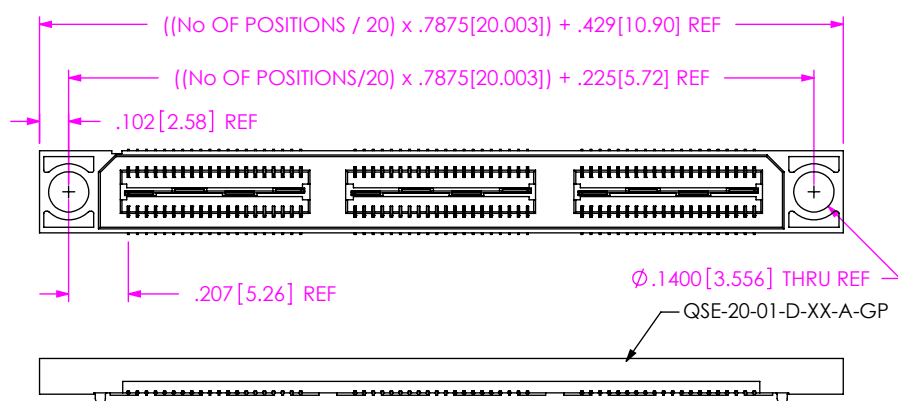

FIG 3  
-GP OPTION  
(SAME AS FIG. 1, UNLESS OTHERWISE STATED)  
[AVAILABLE ON LEAD STYLE -01 & -01-A ONLY]  
(40 POS. MAX WITH T & R PACKAGING)

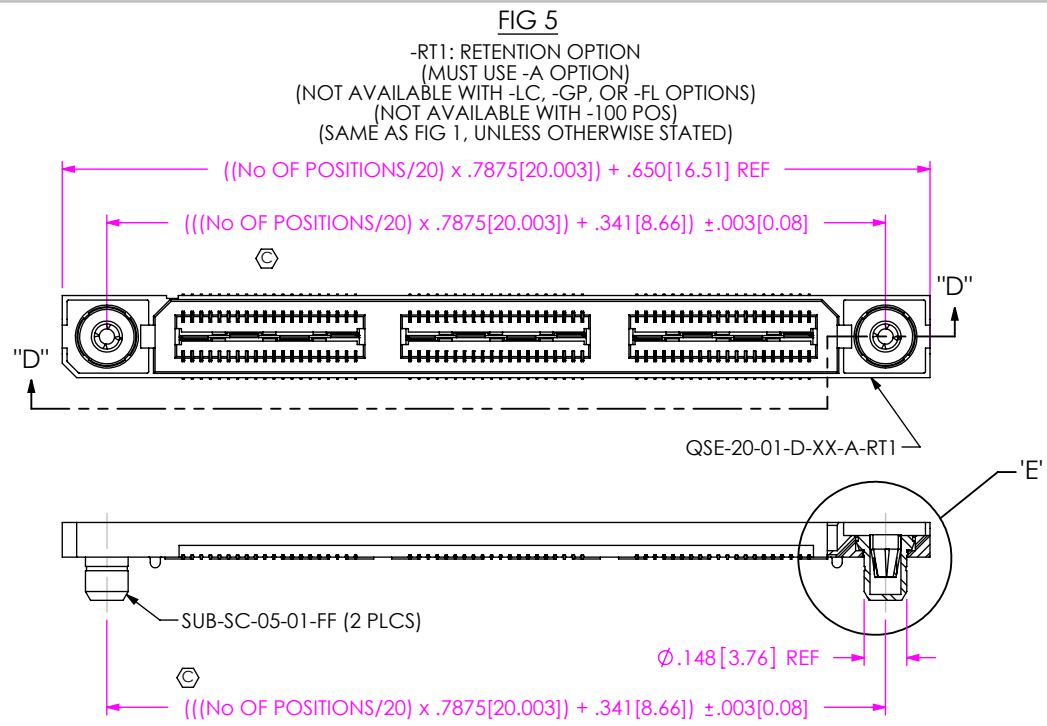
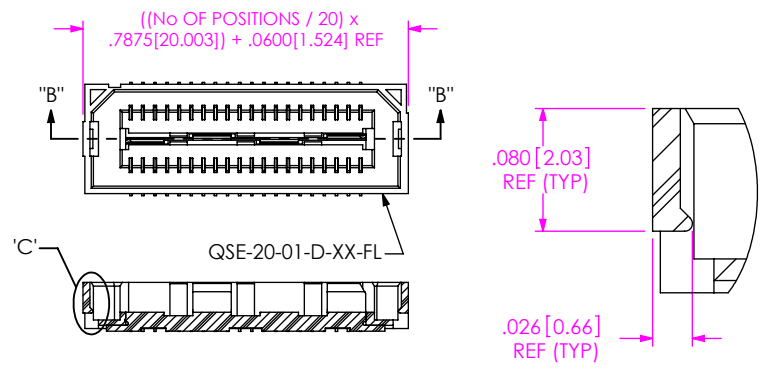

FIG 5  
-RT1: RETENTION OPTION  
(MUST USE -A OPTION)  
(NOT AVAILABLE WITH -LC, -GP, OR -FL OPTIONS)  
(NOT AVAILABLE WITH -100 POS)  
(SAME AS FIG 1, UNLESS OTHERWISE STATED)



SECTION "B"-"B"

DETAIL 'C'  
SCALE 8:1

FIG 4  
-FL: FRICTION LOCKS  
(NOT AVAILABLE WITH -GP OPTION)  
(SAME AS FIG 1, UNLESS OTHERWISE STATED)

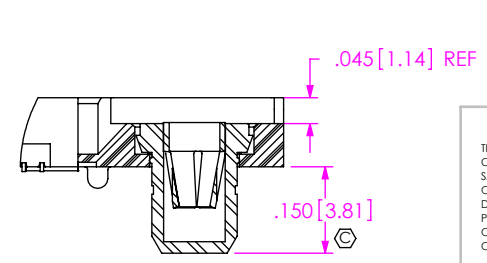

DETAIL 'E'  
SCALE 3:1

SECTION "D"-"D"  
SCALE 1.5:1

F:\DWG\MISC\MKTG\QSE-XXX-01-XXX-D-XXX-MKT.SLDDRW

PROPRIETARY NOTE  
THIS DOCUMENT CONTAINS INFORMATION  
CONFIDENTIAL AND PROPRIETARY TO  
SAMTEC, INC. AND SHALL NOT BE REPRODUCED  
OR TRANSFERRED TO OTHER DOCUMENTS OR  
DISCLOSED TO OTHERS OR USED FOR ANY  
PURPOSE OTHER THAN THAT WHICH IT WAS  
OBTAINED WITHOUT THE EXPRESSED WRITTEN  
CONSENT OF SAMTEC, INC.

DO NOT SCALE DRAWING

SHEET SCALE: 2:1



520 PARK EAST BLVD, NEW ALBANY, IN 47150  
PHONE: 812-944-6733 FAX: 812-948-5047  
e-Mail info@SAMTEC.com code 55322

DESCRIPTION:	.8mm DOUBLE ROW HS SOCKET ASSEMBLY	
DWG. NO.	QSE-XXX-01-XXX-D-XXX	
BY: ERIC M	05/20/1999	SHEET 2 OF 3

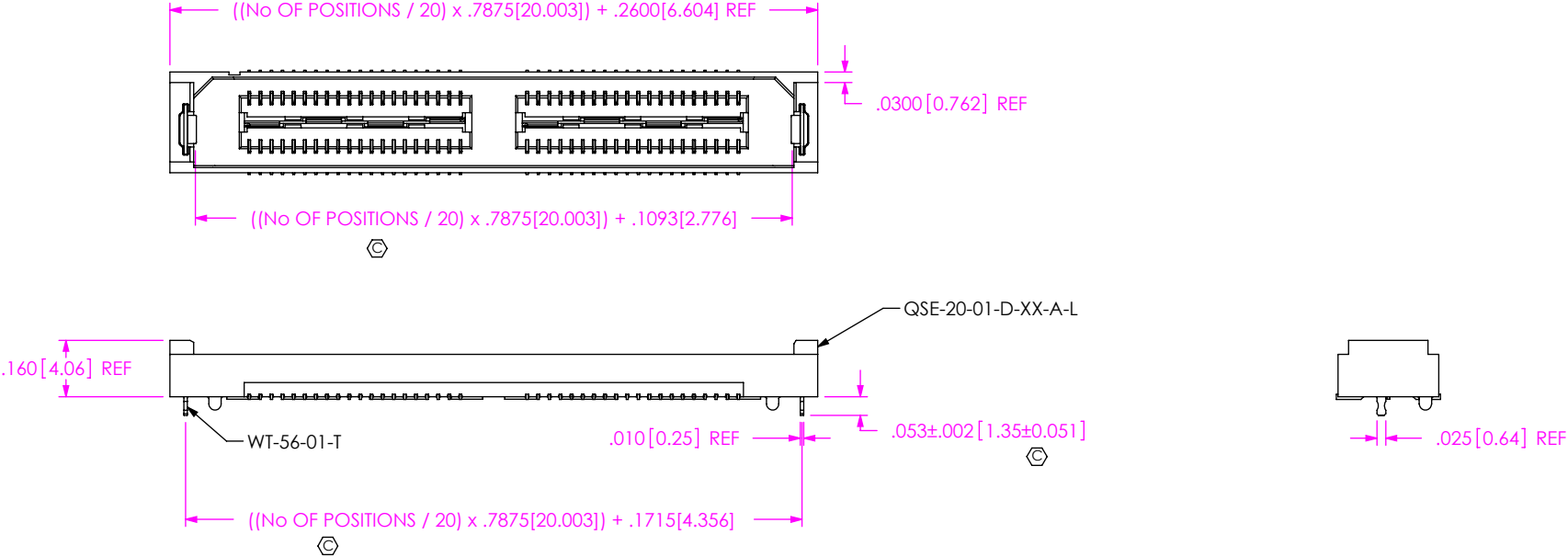

FIG 6  
-L: LATCHING OPTION  
(MUST USE -A OPTION)  
(SAME AS FIG 1, UNLESS OTHERWISE STATED)  
(NOT AVAILABLE WITH -LC, -GP, -FL, OR -RT1)  
(MAXIMUM 40 POS)

AY

CRITICAL DIMENSION INSPECTION INSTRUCTION TABLE	
ASSEMBLY OPERATION	IN-PROCESS INSPECTION
FILL C-126-21	C1, C2, C3
ADD -RT1 OPTION	C4, C5, C6
ADD -L OPTION	C7, C8, C9

**PROPRIETARY NOTE**  
THIS DOCUMENT CONTAINS INFORMATION  
CONFIDENTIAL AND PROPRIETARY TO  
SAMTEC, INC. AND SHALL NOT BE REPRODUCED  
OR TRANSFERRED TO OTHER DOCUMENTS OR  
DISCLOSED TO OTHERS OR USED FOR ANY  
PURPOSE OTHER THAN THAT WHICH IT WAS  
OBTAINED WITHOUT THE EXPRESSED WRITTEN  
CONSENT OF SAMTEC, INC.

DO NOT SCALE DRAWING

SHEET SCALE: 2:1

520 PARK EAST BLVD, NEW ALBANY, IN 47150  
PHONE: 812-944-6733 FAX: 812-948-5047  
e-Mail info@SAMTEC.com code 55322

DESCRIPTION: .8mm DOUBLE ROW HS SOCKET ASSEMBLY

DWG. NO. QSE-XXX-01-XXX-D-XXX

BY: ERIC M 05/20/1999 SHEET 3 OF 3