

Federleisten Socket connectors

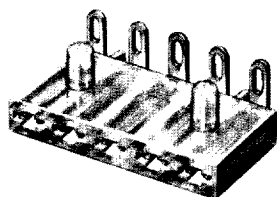

Serie MGF 4400 mit Lötäugen*
Series MGF 4400 with solder tags*

Polzahl Positions	Artikel-Nummer Part number	Abmessungen C Dimensions C	Abmessungen D Dimensions D	Abmessungen E Dimensions E
1	MGF 4401 - 6 - 0 - 101	4,8	-	-
2	MGF 4402 - 6 - 0 - 202	9,8	5	-
3	MGF 4403 - 6 - 0 - 303	14,8	10	7,5
4	MGF 4404 - 6 - 0 - 404	19,8	15	10,0
5	MGF 4405 - 6 - 0 - 505	24,8	20	15,0
6	MGF 4406 - 6 - 0 - 606	29,8	25	20,0
7	MGF 4407 - 6 - 0 - 707	34,8	30	25,0
9	MGF 4409 - 6 - 0 - 909	44,8	40	35,0

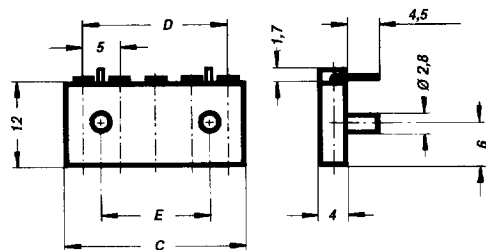

* für Kontaktstifte Ø 1,3 mm, Seite 23.
* for contact pins Ø 1.3 mm, page 23.

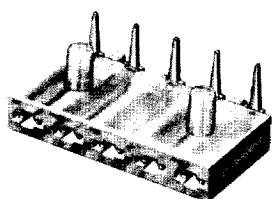

Serie MGF 4400 mit Einlötfstiften*
Series MGF 4400 with solder pins*

Polzahl Positions	Artikel-Nummer Part number	Abmessungen C Dimensions C	Abmessungen D Dimensions D	Abmessungen E Dimensions E
1	MGF 4401 - 6 - 1 - 101	4,8	-	-
2	MGF 4402 - 6 - 1 - 202	9,8	5	-
3	MGF 4403 - 6 - 1 - 303	14,8	10	7,5
4	MGF 4404 - 6 - 1 - 404	19,8	15	10,0
5	MGF 4405 - 6 - 1 - 505	24,8	20	15,0
6	MGF 4406 - 6 - 1 - 606	29,8	25	20,0
7	MGF 4407 - 6 - 1 - 707	34,8	30	25,0
9	MGF 4409 - 6 - 1 - 909	44,8	40	35,0

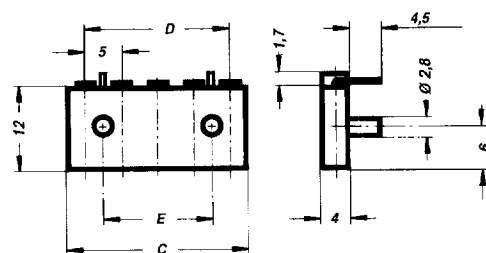

* für Kontaktstifte Ø 1,3 mm, Seite 23.
* for contact pins Ø 1.3 mm, page 23.