

VERTICAL D-SUB DSM-VT SERIES

SPECIFICATIONS

For complete specifications see www.samtec.com?DSM-VT

Insulator Material:
Black High Temperature Thermoplastic

Pin Material:
Copper Alloy

Socket Material:
Phosphor Bronze

Shell Material:
Steel

Plating:
Gold on Contacts, Nickel on Shell, Tin-Lead on Tails

Operating Temp Range:
-55°C to +105°C

Current Rating:
1 A per contact

Voltage Rating:
40 VAC

Contact Resistance:
20 mΩ max

Minimum Cycles:
1000

ALSO AVAILABLE

Metric Jackscrews.
Call Samtec.

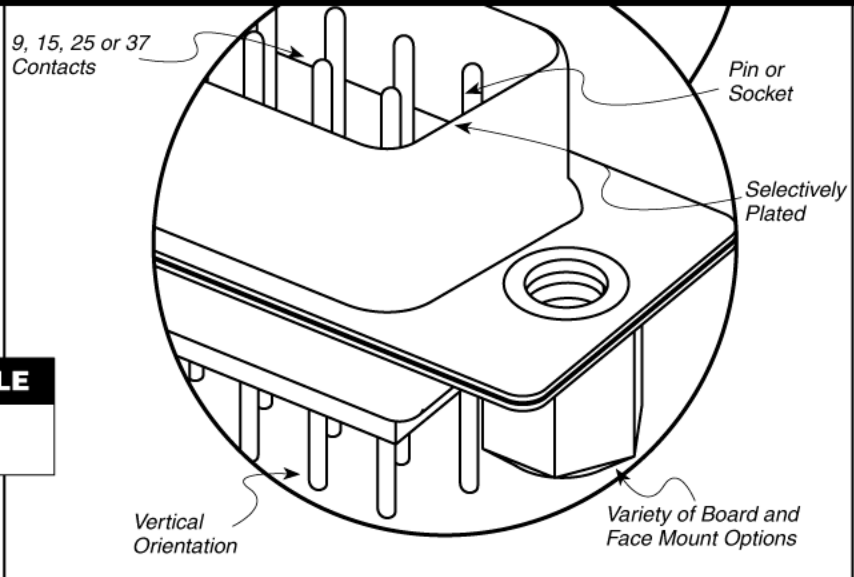

9, 15, 25 or 37 Contacts

Pin or Socket

Selectively Plated

Vertical Orientation

Variety of Board and Face Mount Options

Processing:

Suggested PCB Layouts:
For reference only. Please contact Samtec or go to www.samtec.com?DSM-VT for recommended PCB layout.

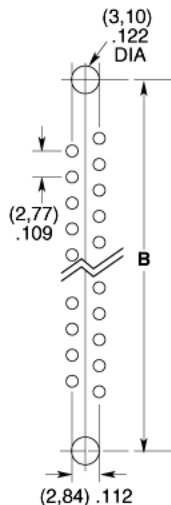

| DSM | VT | SHELL SIZE-POSITIONS | GENDER | PLATING | BOARD MOUNT | FACE MOUNT |
|-------|----|----------------------|----------------|--|---------------------------|---|
| -E-09 | | = 9 Positions | -P = Pin | -F = Gold Flash on Mating Area, Tin-Lead on Tails | -BL = Board Locks | (Leave Blank for no face mount option) |
| -A-15 | | = 15 Positions | -S = Socket | -L = 10μ" (0,25μm) Gold on Mating Area, Tin-Lead on Tails | -TB = Threaded Bushing | -RJ = #4-40 Removable Jackscrews in #4-40 Threaded Inserts |
| -B-25 | | = 25 Positions | | -S = 30μ" (0,76μm) Gold on Mating Area, Tin-Lead on Tails | | |
| -C-37 | | = 37 Positions | | | | |

| SHELL SIZE-POSITIONS | A | B | C (-P) | C (-S) |
|----------------------|---------------|---------------|---------------|---------------|
| | ± (0,25) .010 | ± (0,25) .010 | ± (0,25) .010 | ± (0,25) .010 |
| -E-09 | (30,81) 1.213 | (24,99) .984 | (16,92) .666 | (16,33) .643 |
| -A-15 | (39,14) 1.541 | (33,32) 1.312 | (25,25) .994 | (24,66) .971 |
| -B-25 | (53,04) 2.088 | (47,04) 1.852 | (38,96) 1.534 | (38,38) 1.511 |
| -C-37 | (69,32) 2.729 | (63,50) 2.500 | (55,43) 2.182 | (54,84) 2.159 |

Due to technical progress, all designs, specifications and components are subject to change without notice.

WWW.SAMTEC.COM