

PROD NO  
SEE SHEET 2/2

1 | 2

3

4

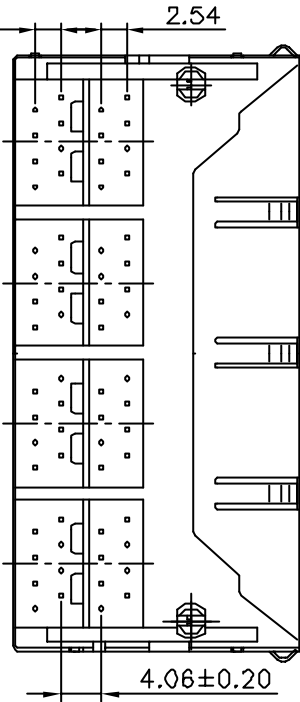
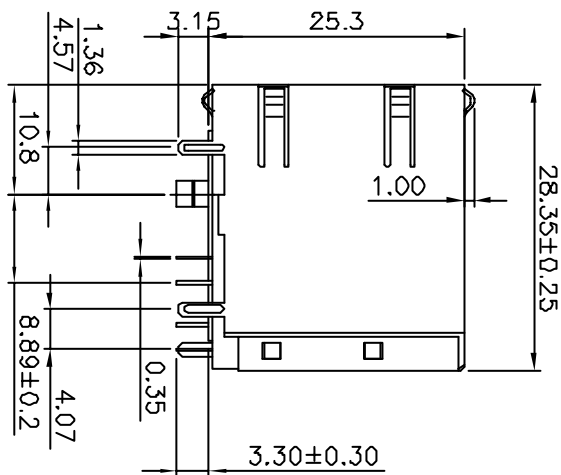
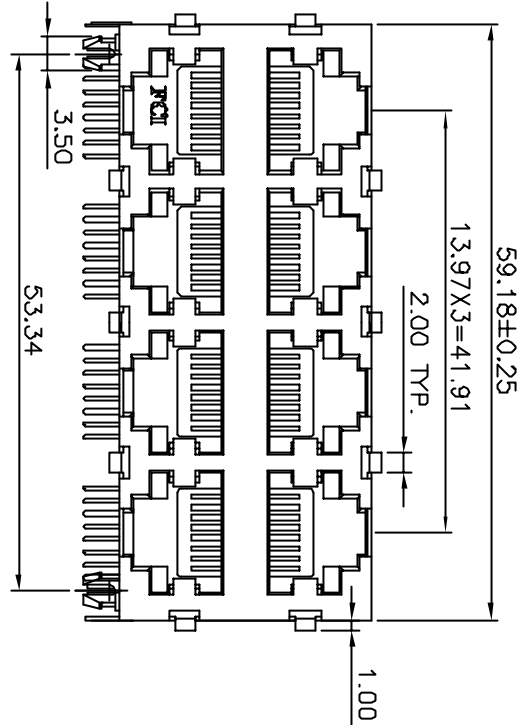

mat'l. code				tolerances unless otherwise specified				CUSTOMER COPY		title	
lbr	ecn no	dr	date	linear	.XX ±.30	.XX ±.15	.XX ±.05	projection	MM	product family	code
A	103-0533	J.C	12/04/03							R/A CAT5 D/D G/J ASSY	
				angles	0° ±5°					8POS SHIELDED (2x4)	
				dr	JASMINE CHANG	10/6/03				product family	code
				engr	ALLEN CHANG	10/6/03				size	dwg no
				chr	ROGER LIN	10/6/03				scale	sheet
				appd	JAMES HSU	10/6/03				N/A	1 of 2
sheet	revision	A	A								
index	sheet	1	2								

1 | 2

3

4

ACAD

code code  
22526

A

5

PROD NO
SEE NOTES

NOTES :

### MATERIALS :

1. HOUSING : GLASS FILLED POLYESTER U94V-0  
COLOR : BLACK.  
2. CONTACT : COPPER ALLOY.  
3. SHIELD : COPPER ALLOY.

FINISH:

1. CONTACT : SELECTIVE GOLD PLATED ON CONTACT AREA.  
150U" TIN-LEAD PLATED ON SOLDER TAILS AREA AND 50U" MIN  
NICKEL UNDERPLATED ALL OVER.
2. SHIELD : NICKEL PLATED.

OTHERS

1. PRODUCT SPEC : GS-12-271.  
2. PACKAGING SPEC : GS-14-891.

PART NUMBER:

10034935-G5R12X

- Gold Thickness:  
1-3u      2-5u      3-15u  
4-30u      5-50u

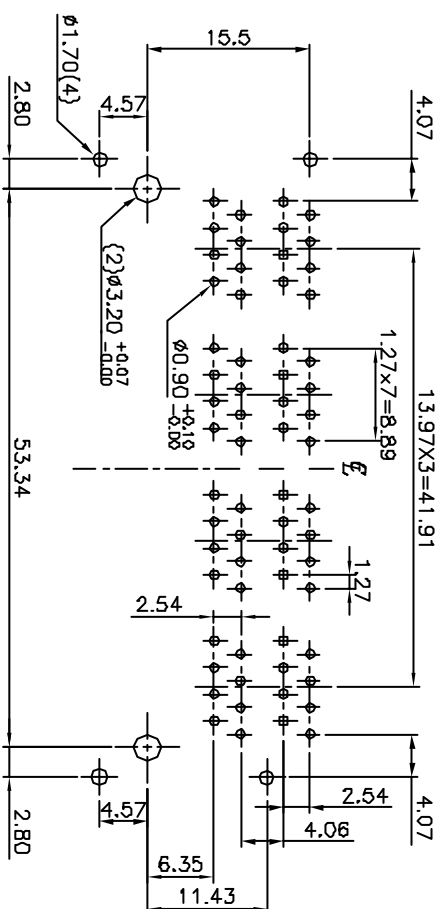

T=1.60mm

## PC Board Layout

Component Side Shown

General Tolerance  $\pm 0.05$

mat'l. code		tolerances unless otherwise specified		CUSTOMER COPY		A FCI www.fciconnect.com	
ltr	can no	dr	date	linear		title	
A				.XX ± .15		R/A CAT5 D/D G/I ASS'Y	
				.XXX ± 0.05		BPOS SHIELDED (2x4)	
				0 ± .3		product family Modular Jacks	
				angles		size dwg no	
				USMME CHANG10/6/03		code	
				brgr ALEN CHANG 10/6/03		-	
				citr ROGER LIN 10/6/03		sheet	
				qnpd JAMES HSU 10/6/03		2 of 2	
sheet	revision						
index	sheet						

✓

