



Series 8XXX Collet Elevator Sockets on .300 [7.62] and .600 [15.24] Centers

FEATURES:

- Ideal for elevating devices (displays, switches, etc.) to desired level with .240 to 1.250 [6.10 to 31.75] height extension.

SPECIFICATIONS:

- Standard socket body is black UL 94-HB Glass-filled Nylon.
- Spacer is red UL 94-HB Glass-filled Nylon.
- High temp socket board and spacer are black UL 94V-0 4/6 Nylon.
- Pin body is Brass Alloy 360 1/2 hard per UNS C36000 ASTM-B16-85.
- Pin body plating is 200 μ [1.27 μ m] min. 93/7 Tin/Lead per MIL-P-81728 over 100 μ [2.54 μ m] min. Nickel per QQ-N-290. Gold plating also available (consult factory).
- 4-fingered collet contact is Beryllium Copper Alloy per UNS C17200 ASTM-B194-92.
- Contact plating is 30 μ [.76 μ m] min. Gold per MIL-G-45204 over 50 μ [1.27 μ m] min. Nickel per QQ-N-290.
- Contact current rating=3 Amps.
- Operating temperature=221°F [105°C].
- Insertion Force=180 grams/pin; Withdrawal Force=90 grams/pin; Normal Force=140 grams/pin; based on a .018 [.46] diameter test lead.
- Accepts leads .015-.025 [.38-.64] in diameter, .110-.150 [2.79-3.81] long.

MOUNTING CONSIDERATIONS:

- Suggested PCB hole size=.035 \pm .002 [.89 \pm .05] dia.

ALL DIMENSIONS: INCHES [MILLIMETERS]

All tolerances \pm .005 [.13] unless otherwise specified

"W"=NO. OF PINS PER ROW X .100 [2.54]

"X"=(NO. OF PINS PER ROW - 1) X .100 [2.54]

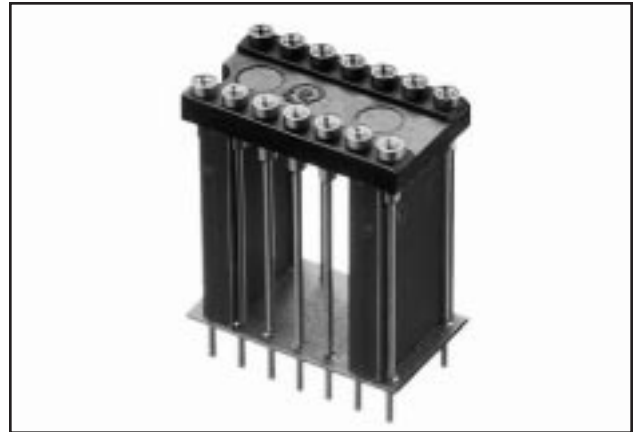
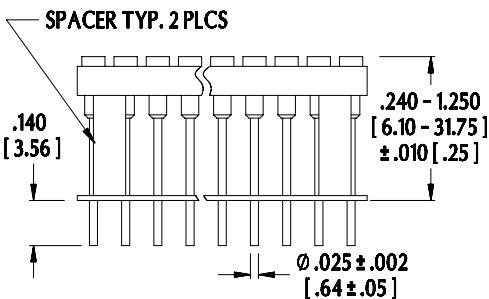
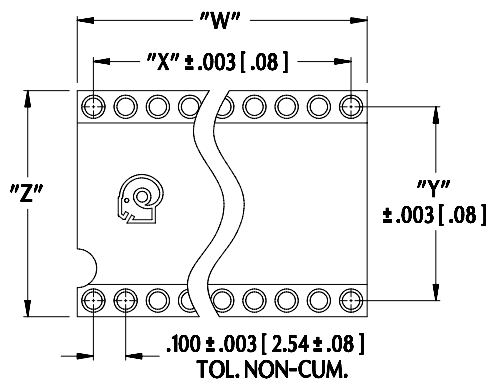

Note: Aries specializes in custom design and production. In addition to the standard products shown on this page, special materials, platings, sizes, and configurations can be furnished, depending on quantities. Aries reserves the right to change product specifications without notice.

ORDERING INFORMATION

XX-8XXXX-X10CXX

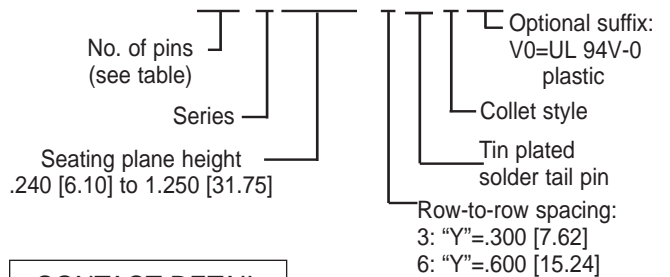

CONTACT DETAIL

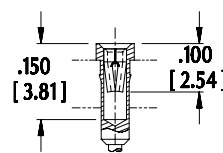

Consult Data Sheet No. 13007 for collet elevator sockets on .200 [5.08] centers.

Consult Data Sheet No. 13006 for elevator sockets with bifurcated contacts.

Centers "Y"	Dim. "Z"	Body Style	Available Sizes
.300 [7.62]	.400 [10.16]	C	6 thru 20
		B	22 thru 40
.600 [15.24]	.700 [17.78]	C	6 thru 40
		B	42 thru 48

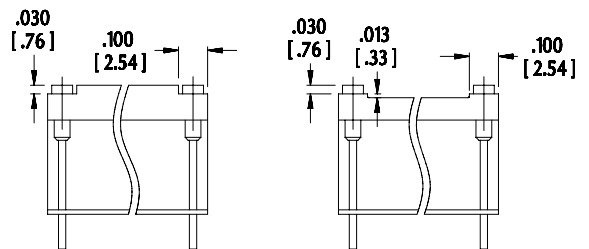

BODY STYLE B

BODY STYLE C

ARIES
ELECTRONICS, INC.
http://www.arieselec.com • info@arieselec.com

NORTH AMERICA
Frenchtown, NJ USA
TEL: (908) 996-6841
FAX: (908) 996-3891



UK/IRELAND/GB
TEL: +44 870 240 0249
FAX: +44 1653 600493
uking@arieselec.com

EUROPE/MAINLAND/HOLLAND
TEL: +31 78 615 94 65
FAX: +31 78 615 43 11
europe@arieselec.com

13008
REV.C