

Description

- Low resistance
- Low profile 0603/1608 design
- Pb-free and RoHS Compliant
- High inrush withstand capability
- Polymer matrix design
- One time positive disconnect
- Ampere rating marked on both sides, dual orientation
- Compatible with leaded and lead-free reflow and wave solder

| ELECTRICAL CHARACTERISTICS | |
|----------------------------|-------------------|
| % of Amp Rating | Opening Time |
| 100% | 4 Hours Minimum |
| 200% | 5 Seconds Maximum |

Agency Information

- UL Recognition Card: JDYX2, E19180

Environmental Data

- Life Test: MIL-STD-202, Method 108A, Test Condition C
- Load Humidity: MIL-STD-202, Method 103B
- Moisture Resistance: MIL-STD-202, Method 106G
- Thermal Shock: MIL-STD-202, Method 107D
- Solderability: ANSI/J-STD-002, Test B
- Mechanical Shock: MIL-STD-202, Method 213B, Condition A
- High Frequency Vibration: MIL-STD-202, Method 204D, Condition D

Packaging & Ordering Information

- 5,000 pieces; paper tape; 178mm (7 inch) reel; per EIA Standard 481-1
- Order by Product Code (no prefix or suffix necessary)



Dimensions mm/(inches)

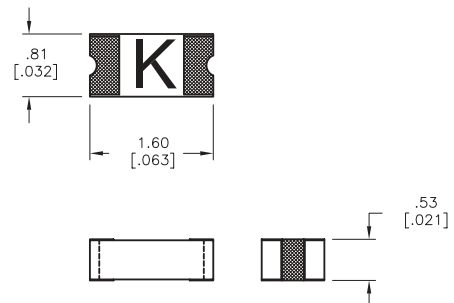

Land Pattern

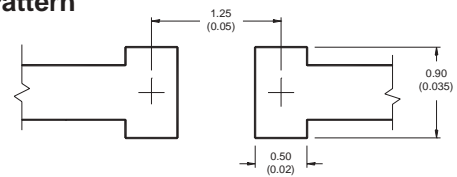

Soldering Method

- Wave Solder: 260°C, 10 sec max.
- Infrared: 260°C, 30 sec max.

| SPECIFICATIONS | | | | | |
|----------------|----------------------|--------------------------------------|-------------------------------------|-----------------------------|------------|
| Product Code | Voltage Rating AC/DC | Interrupting Rating @ Rated Voltage* | Typical DC Cold Resistance (ohms)** | Typical Melting Pt (A²s)*** | Alpha Code |
| PC06F500MA | 32V | 50A | 0.143 | 0.00128 | F |
| PC06F750MA | 32V | 50A | 0.088 | 0.00291 | G |
| PC06F1A | 32V | 50A | 0.065 | 0.00616 | H |
| PC06F1.5A | 32V | 50A | 0.042 | 0.02565 | K |
| PC06F2A | 32V | 50A | 0.027 | 0.03968 | N |
| PC06F2.5A | 32V | 50A | 0.021 | 0.10139 | O |
| PC06F3A | 32V | 50A | 0.018 | 0.15778 | P |
| PC06F3.5A | 32V | 50A | 0.014 | 0.25844 | R |
| PC06F4A | 32V | 50A | 0.012 | 0.27034 | S |

* DC Interrupting Rating is measured at designated voltage, time constant of less than 50 microseconds, battery source.

** DC cold resistance is measured at less than 10% of rated current.

*** Melting Pt is measured with a battery back at rated DC voltage, at the lesser of either 10 times rated current or the interrupting rating with a time constant of less than 50 microseconds.

TIME CURRENT CURVE

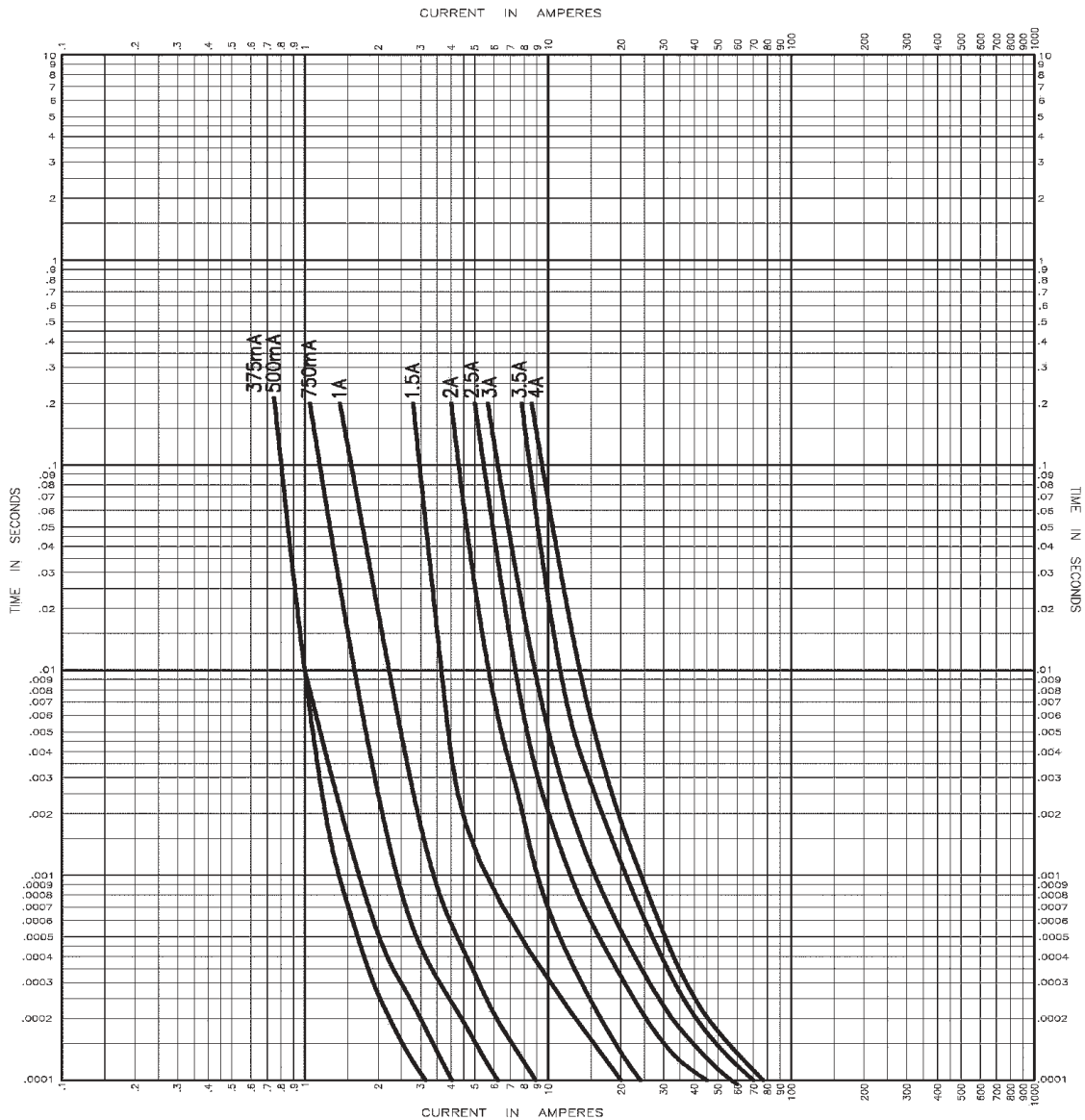

North America

Cooper Electronic Technologies
3601 Quantum Boulevard
Boynton Beach, FL 33426-8638
Tel: 1-561-752-5000
Fax: 1-561-742-0134
Toll Free: 1-888-414-2645

Cooper Bussmann
P.O. Box 14460
St. Louis, MO 63178-4460
Tel: 1-636-394-2877
Fax: 1-800-544-2570

Europe

Cooper Electronic Technologies
Cooper (UK) Limited
Burton-on-the-Wolds
Leicestershire • LE12 5TH UK
Tel: +44 (0) 1509 882 737
Fax: +44 (0) 1509 882 786

Asia Pacific

Cooper Electronic Technologies
1 Jalan Kilang Timor
#06-01 Pacific Tech Centre
Singapore 159303
Tel: +65 278 6151
Fax: +65 270 4160